

GRACE MARTON PARK PRELIMINARY DESIGN

LOCATION MAP

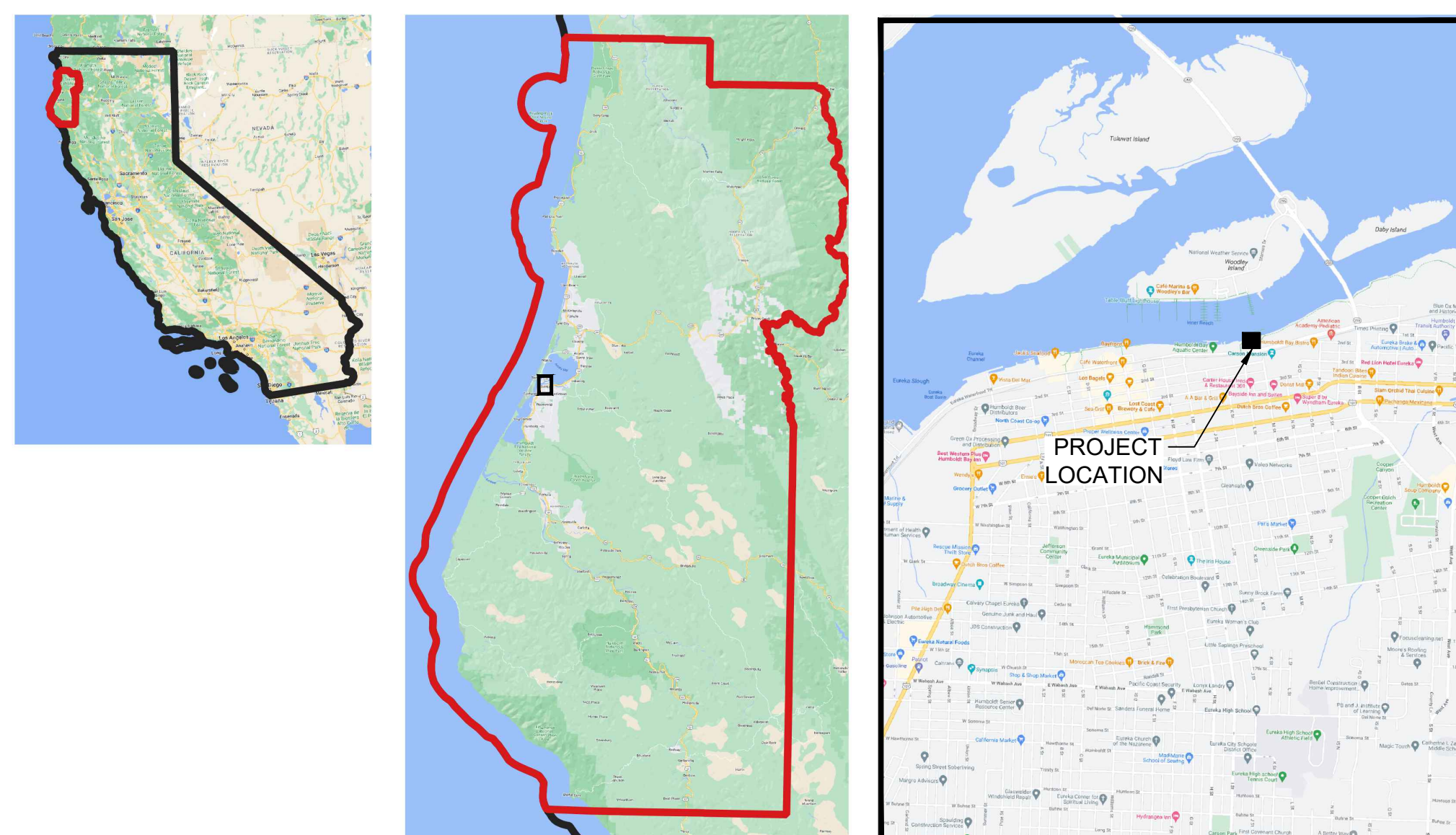

PROJECT DATA

PROJECT INFORMATION

Park Name: Grace Marton Park
 Owner: City of Eureka
 Owner's Representative: Robin Praszker,
 Project Address:
 Assessor's Parcel Number: Portions of 001-161-015-000,
 002-241-015-000, 002-241-006-000
 Zone: CWFC, WFC, WD
 General Plan:
 Coastal Zone: YES
 Flood Zone: Partial, 100-Yr Flood Zone (VE)
 Tsunami Hazard Zone: YES
 Area of Potential Liquefaction: Partial
 Sea Level Rise 1m

PROJECT STATISTICS

Parcel Size (AC): 10.62 AC
 Project Size (AC): 0.48 AC (20,840 SF)

Development Within Project Boundary

	SF	AC
Existing Impervious Area :	6,941	0.16
Existing Pervious Area:	13,259	0.30
Proposed Impervious Area	13,620	0.31
Proposed Pervious Area:	6,580	0.15

SHEET INDEX

- G-000 COVER SHEET
- G-001 EXISTING CONDITIONS & CONSTRUCTION STAGING
- L-001 SITE PLAN
- L-002 PARK RENDERINGS
- L-003 SITE AMENITIES
- L-004 PLAY AREA
- L-005 PRELIMINARY GRADING

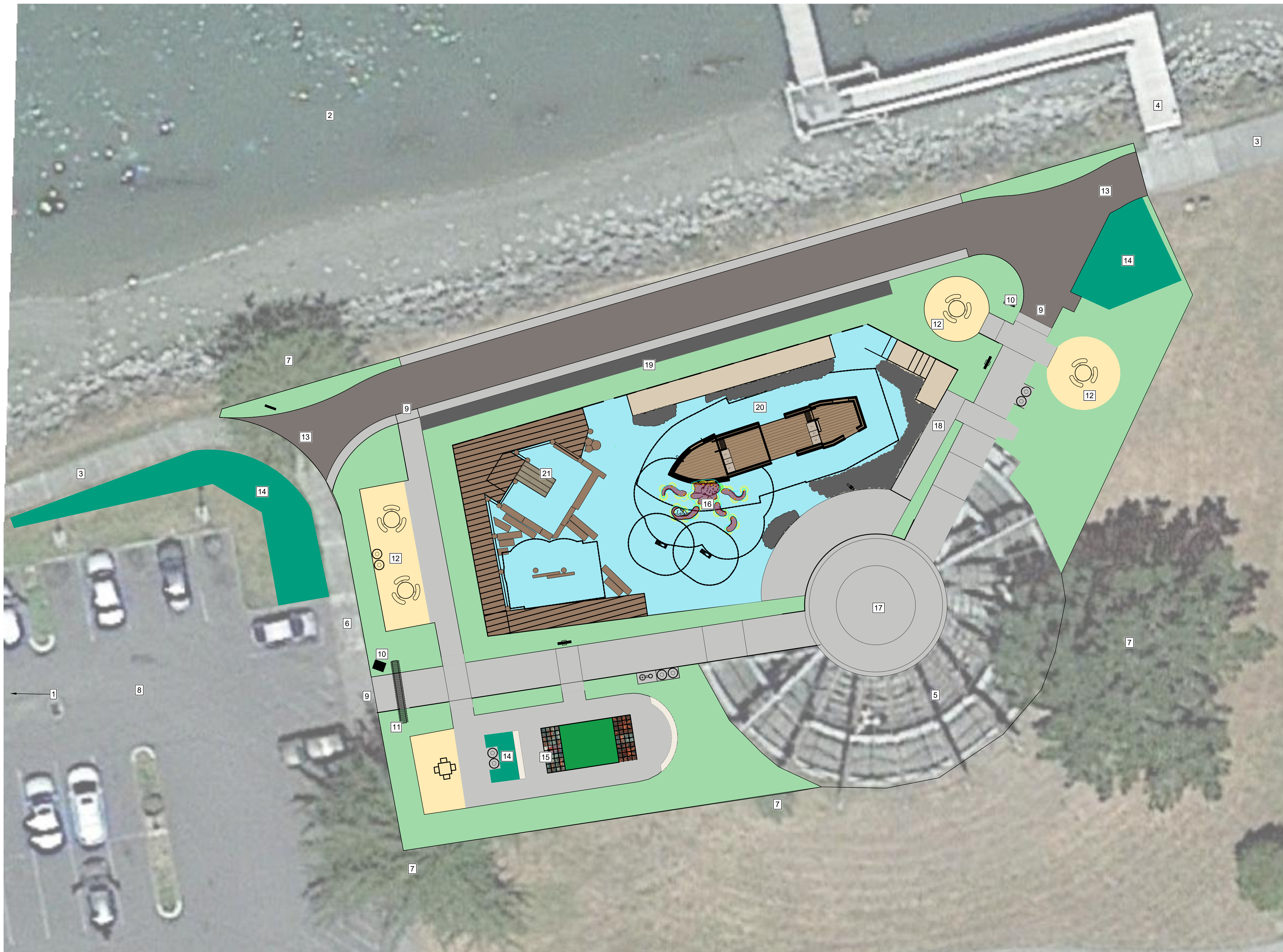

LEGEND

EXISTING SITE

- 1 ADORNI CENTER
- 2 HUMBOLDT BAY
- 3 EXISTING WATERFRONT TRAIL
- 4 BOONIE GOOL DOCKS
- 5 SACCO AMPHITHEATER (TO BE RENOVATED)
- 6 EXISTING SIDEWALK
- 7 EXISTING TREE TO REMAIN, TYP
- 8 EXISTING PARKING

PARK IMPROVEMENTS

- 9 PARK ENTRY
- 10 ENTRY SCULPTURE, SEE L-003
- 11 PLANTING AREA, TYP, SEE L-006
- 12 LUNCH TABLES, SEE L-003
- 13 WATERFRONT TRAIL EXTENSION
- 14 LOW IMPACT DEVELOPMENT PLANTER
- 15 GAME AREA, SEE L-004
- 16 PLAYGROUND, SEE L-004
- 17 PLAYGROUND VIEWING AND GATHERING
- 18 RAMPED ACCESSIBLE WALKWAY
- 19 VEGETATED & ROCK LANDSCAPE BUFFER

PLAY AREA

- 20 CROSSING THE BAR THEMED AREA:
- 21 WORKING WATERFRONT THEMED AREA:

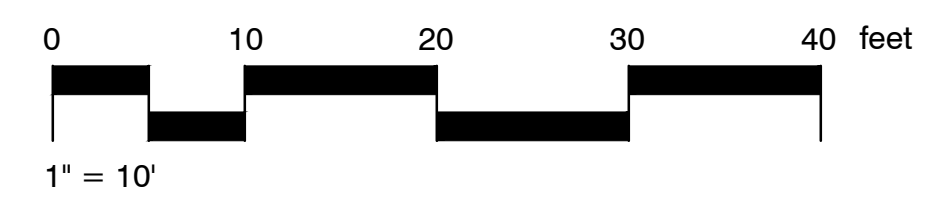



WATERFRONT TRAIL EXTENSION LOOKING EAST

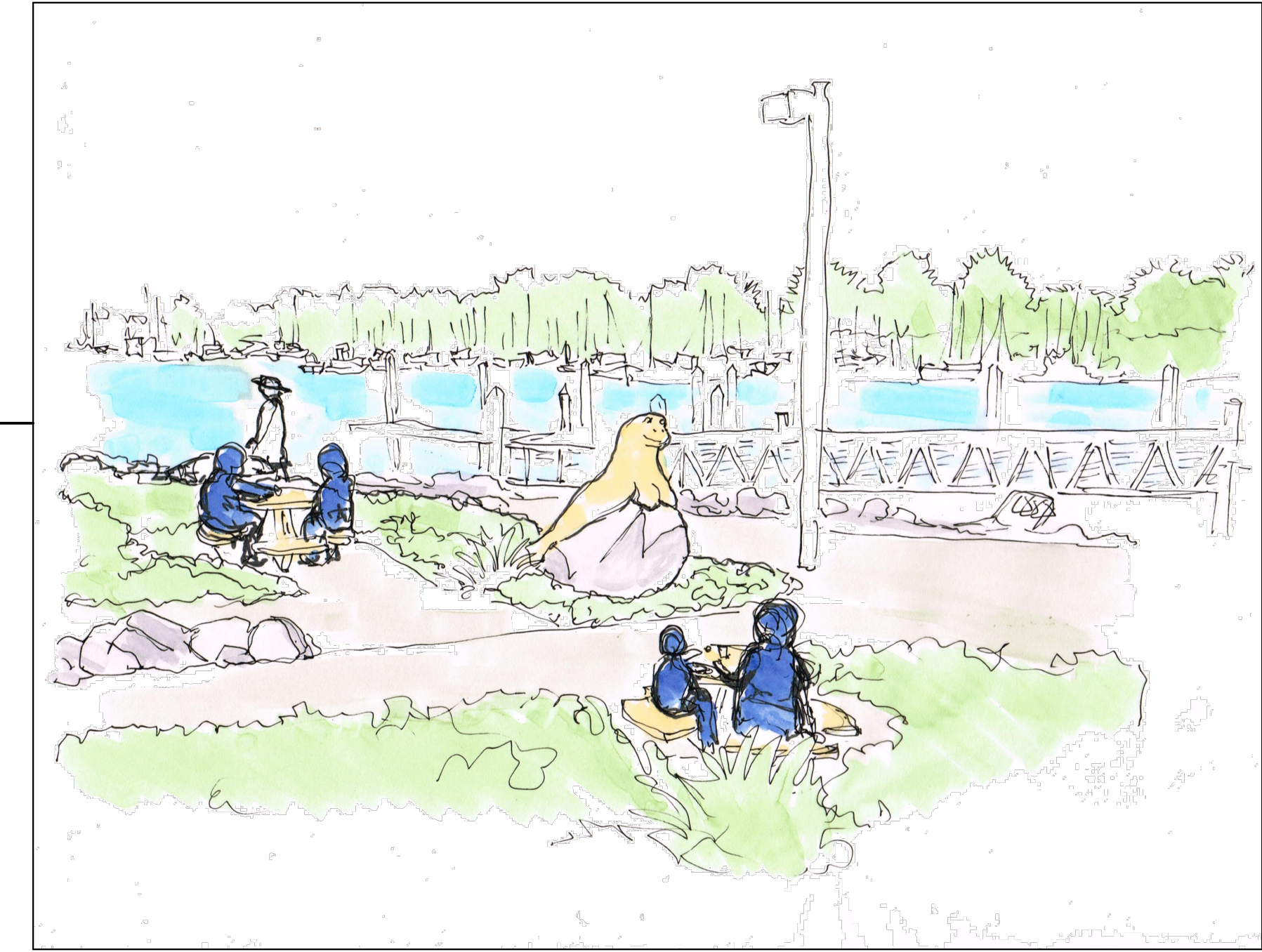

HARBOR SEAL "GREETER" & LUNCH AREAS
EAST END OF PARK, NEAR CONNECTION TO
WATERFRONT TRAIL



GRACE MARTON PARK ENTRY

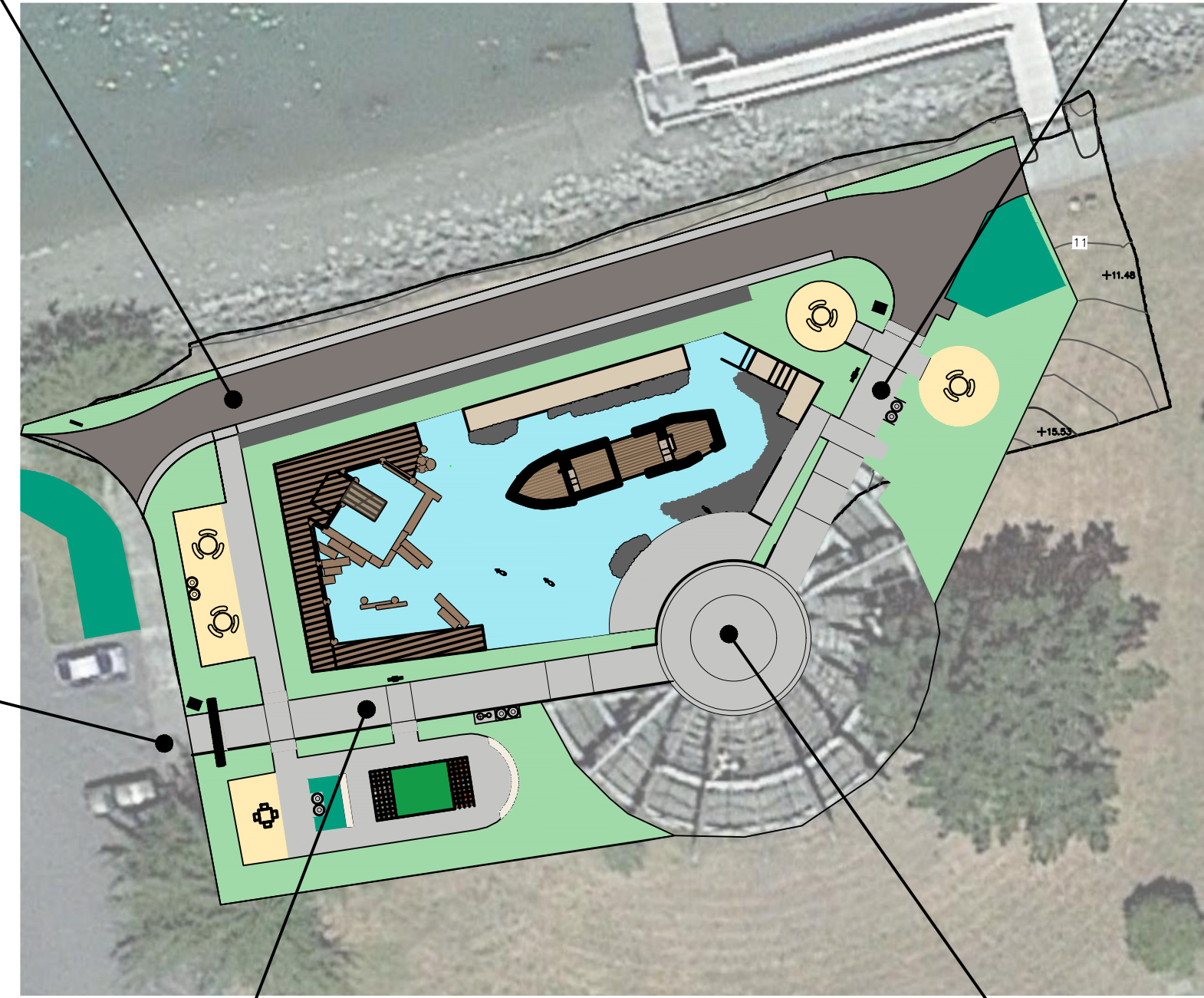

GRACE MARTON PARK WALKWAY
GAME AREA TO LEFT, PLAYGROUND TO RIGHT

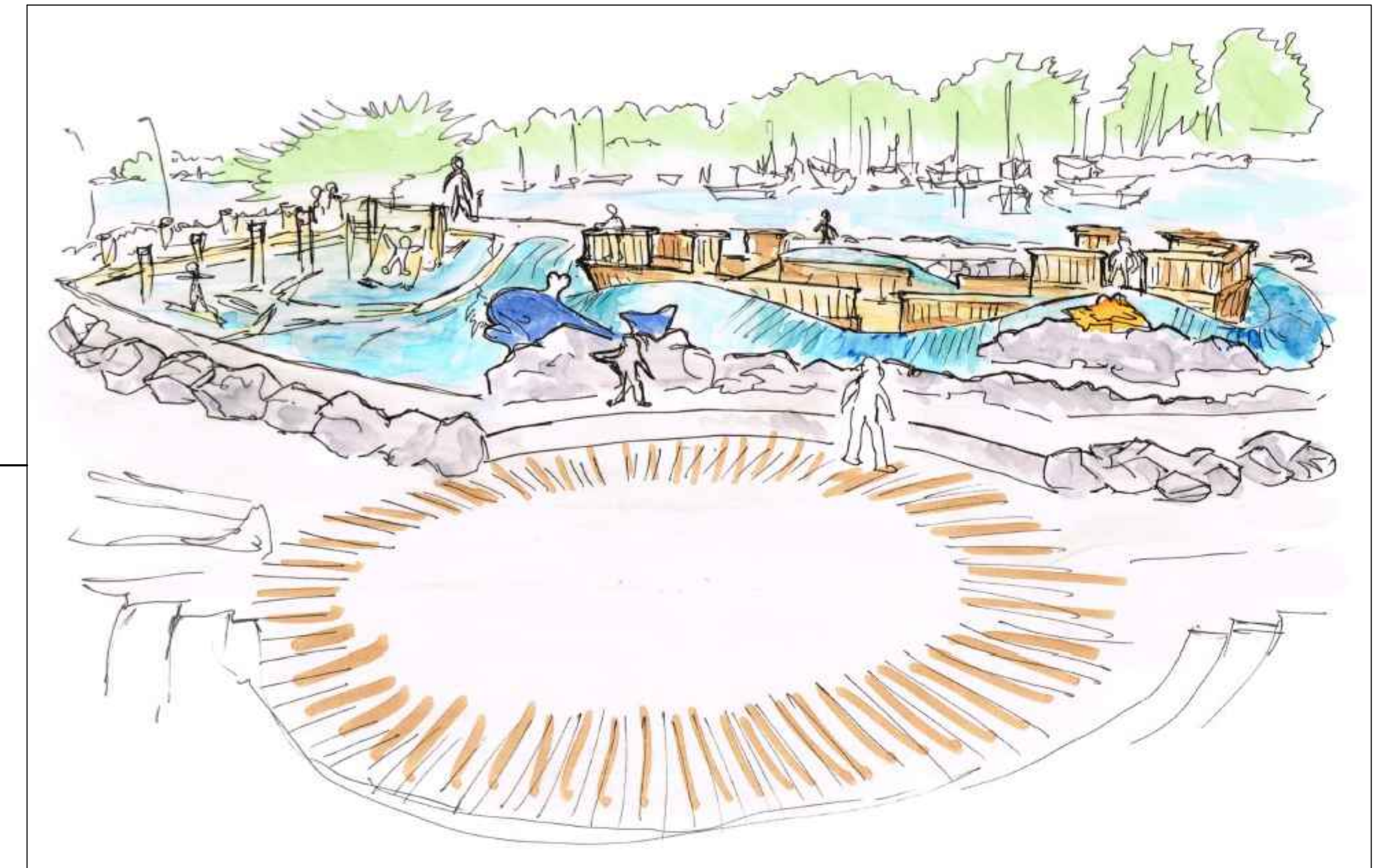

MARINE & WATERFRONT THEMED PLAYGROUND
PLAY SURFACE GRADED TO MIMIC WAVES

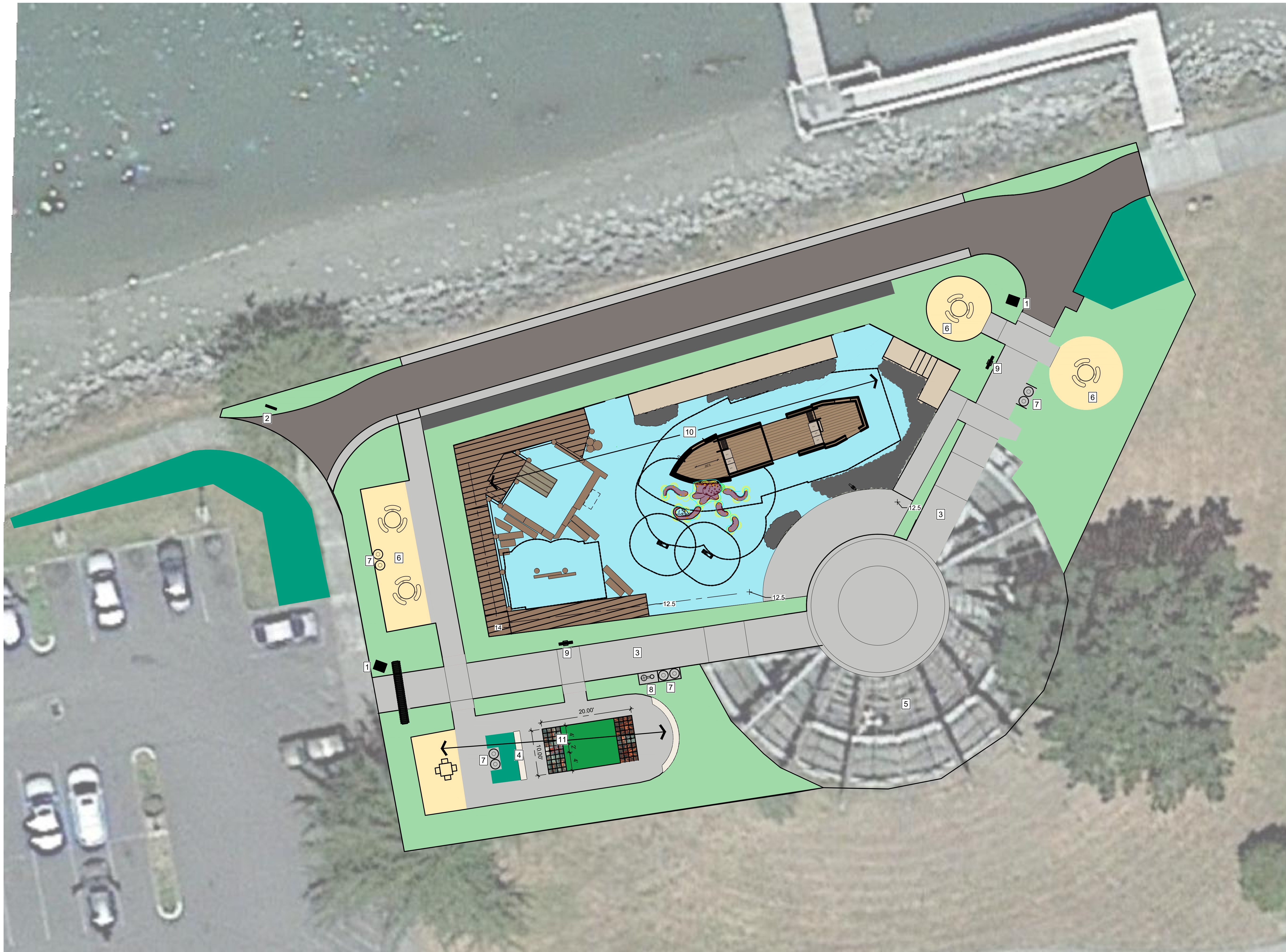

SITE AMENITIES LEGEND

- 1 PARK ENTRY GREETER & ARCHWAY
- 2 WATERFRONT TRAIL ENTRY SIGN
- 3 PAVED WALKWAY
- 4 BENCH
- 5 AMPHITHEATER SEATING
- 6 LUNCH TABLES
- 7 WASTE RECEPTACLES
- 8 DRINKING FOUNTAIN
- 9 INTERPRETIVE SIGNAGE
- 10 PLAY AREA, SEE L-004
- 11 GAME AREA, SEE L-004

PRELIMINARY CONCEPTUAL AMENITIES EXAMPLES

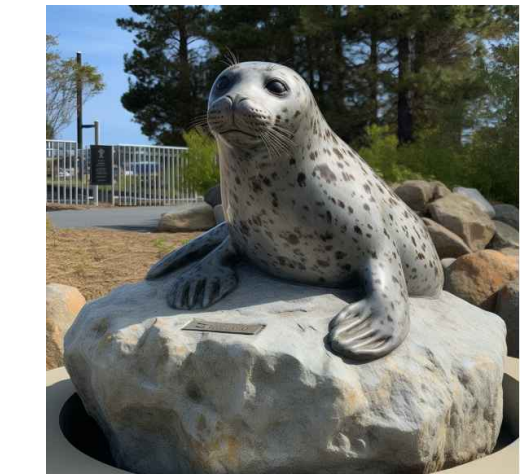

PARK ENTRY GREETER



PARK ENTRY ARCH/PERGOLA



WATERFRONT TRAIL LANDSCAPING



WATERFRONT TRAIL ENTRY SIGN



LUNCH TABLES



BENCH



AMPHITHEATER SEATING/
AMPHITHEATER UPDATE (NIC)



DRINKING FOUNTAIN

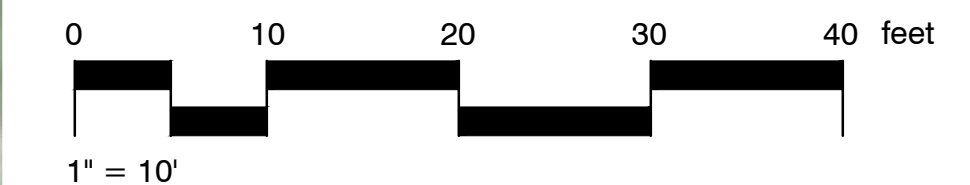



LEGEND

PLAY AREA

- 1 ACCESSIBLE ROUTE
- 2 TRANSFER STATION
- 3 RESILIENT (PIP) PAVEMENT

CROSSING THE BAR THEMED AREA:

- 4 JETTY ACCESSIBLE WALKWAY
- 5 WOOD REPLICA SCHOONER
- 6 CAPTAIN'S SPYGLASS
- 7 OCTOPUS CLIMBING STRUCTURE
- 8 SEA CREATURE ROCKER

WORKING WATERFRONT THEMED AREA:

- 9 DOCK ACCESSIBLE WALKWAY
- 9 TIMBER SLIDE
- 10 "LOG RAFT" EDGING
- 11 "LOG ROLL" BALANCE BEAM

GAME AREA

- 12 CHESS TABLE
- 13 CORNHOLE COURT W/MARINE THEMED DECOR

■ ACCESSIBLE PATH

CONCEPT INSPIRATION: HISTORICAL WORKING WATERFRONT & CROSSING HUMBOLDT BAY BAR

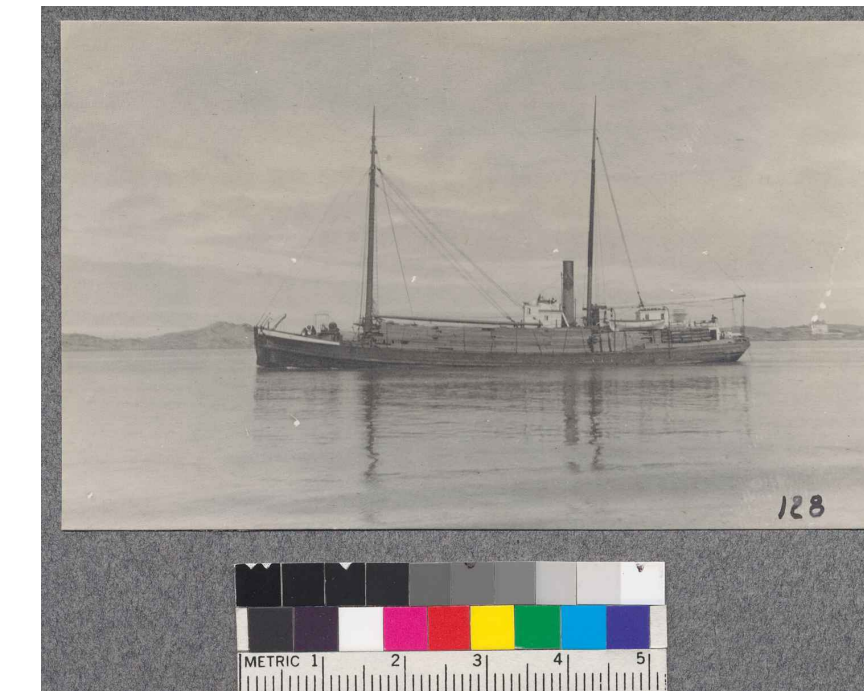

IMAGES: HUMBOLDT STATE POLYTECHNIC UNIVERSITY: BOYLE, FITZ-METCALF, PALMQUIST, SWANLUND-BAKER PHOTOGRAPHIC COLLECTIONS

PRELIMINARY CONCEPTUAL PLAY CHARACTER EXAMPLES



CAPTAIN'S SPYGLASS



WOOD REPLICA SCHOONER



OCTOPUS CLIMBING STRUCTURE



CHESS/CHECKERS TABLE



CORNHOLE





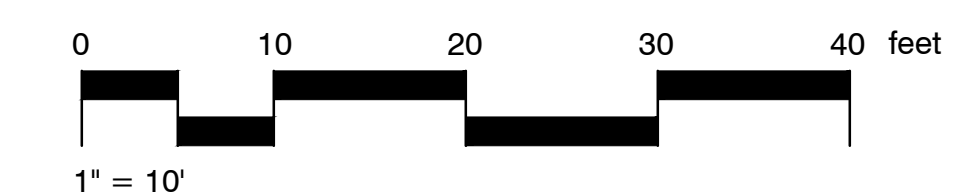

STAMPED CONCRETE "DOCK" PLAY TEXTURE

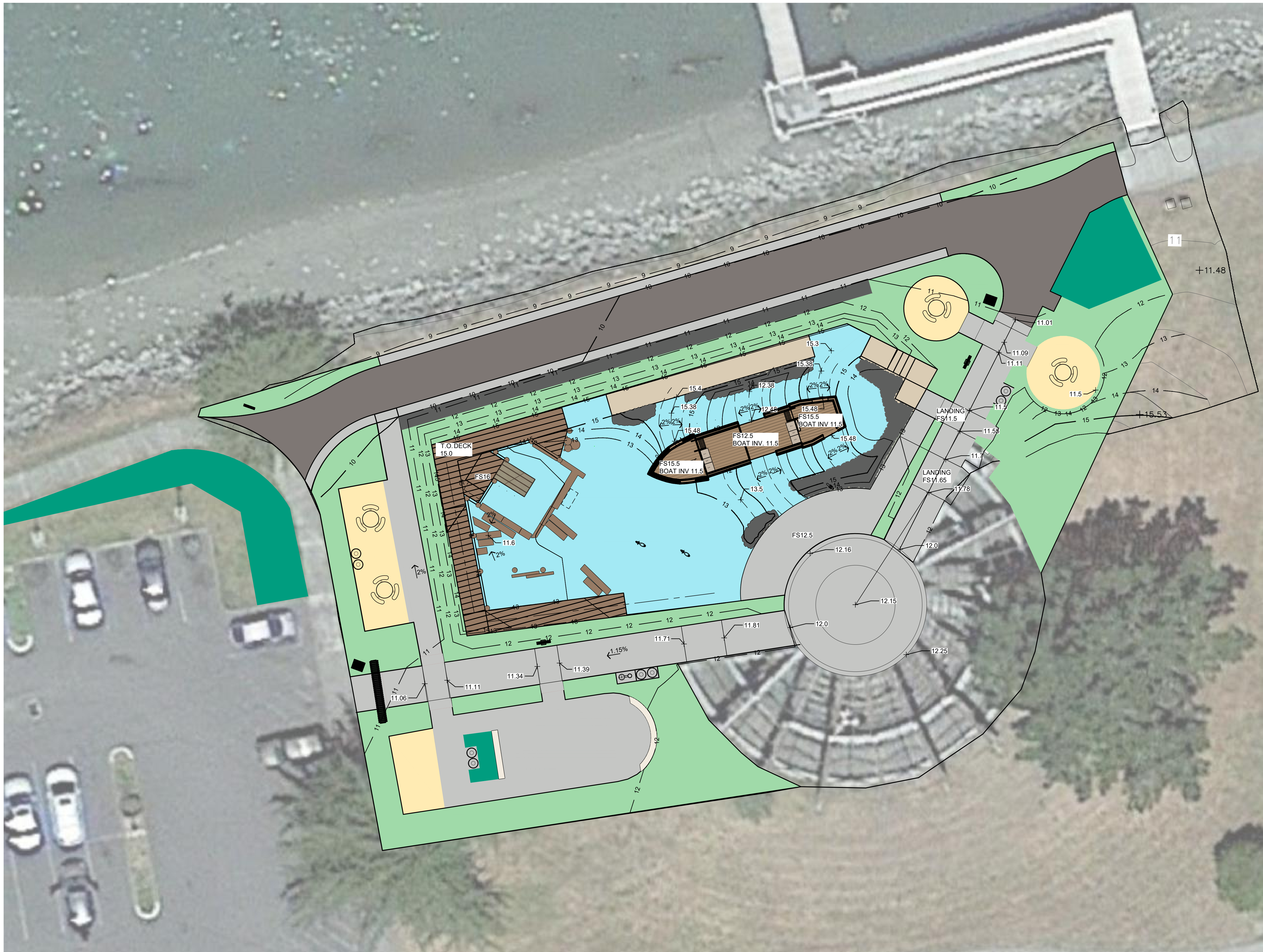

NORTH

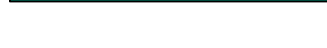

LEGEND

	PROPOSED A/C PAVEMENT
	PROPOSED CONCRETE PAVEMENT
	PROPOSED LANDSCAPE AREAS
	PROPOSED LOW IMPACT DEVELOPMENT (LID)/BIORETENTION
	PROPOSED RESILIENT PLAY SURFACE
	EXISTING MAJOR CONTOUR
	EXISTING MINOR CONTOUR
	PROPOSED MAJOR CONTOUR
	PROPOSED MINOR CONTOUR
	PROPOSED SPOT ELEVATIONS
	SLOPE AND FLOW DIRECTION

