

VICINITY MAP  
No Scale

# CITY OF EUREKA ENGINEERING DIVISION HALVORSEN PARK IMPROVEMENTS BID NO. TBD

Bid Opening Date: TBD  
2:00 PM, 1st Floor Lobby, Eureka City Hall



LOCATION MAP  
No Scale

## DRAWING INDEX

SHT	DWG	DESCRIPTION
1	G-001	TITLE AND INDEX
2	C-101	IMPROVEMENT PLAN 1
3	C-102	IMPROVEMENT PLAN 2
4	C-103	IMPROVEMENT PLAN 3
5	C-501	CIVIL DETAILS

PREPARED BY:

**DRAFT**

Albert Figueroa, E.I.T. Date  
City of Eureka, Assistant Engineer  
EIT No. xxxxxxx

APPROVED:

**DRAFT**

Jesse J. Willor, P.E. Date  
City of Eureka, City Engineer  
RCE No. C81744

### DO NOT COPY

These Plans may not be reproduced unless they are original copies signed in ink by the Engineer. The Engineer preparing these Plans will not be responsible or liable for unauthorized changes or uses of these Plans. All changes to the Plans must be in writing and must be approved by the Engineer.

Designed By:	Drawn By:	Checked By:	Graphic Scale	Measures one inch on Full Size Drawings
JJW	AJF	JJW		

**DRAFT**

**EUREKA** CALIFORNIA  
Public Works Dept., Engineering Division  
531 K Street, Eureka, CA 95501  
(707) 441-4194 ph, (707) 441-4202 fax

TITLE AND INDEX  
HALVORSEN PARK IMPROVEMENTS  
BID NO. 2024-XX

Scale:	AS SHOWN
Drawing:	G-001
Sheet	1 of 5

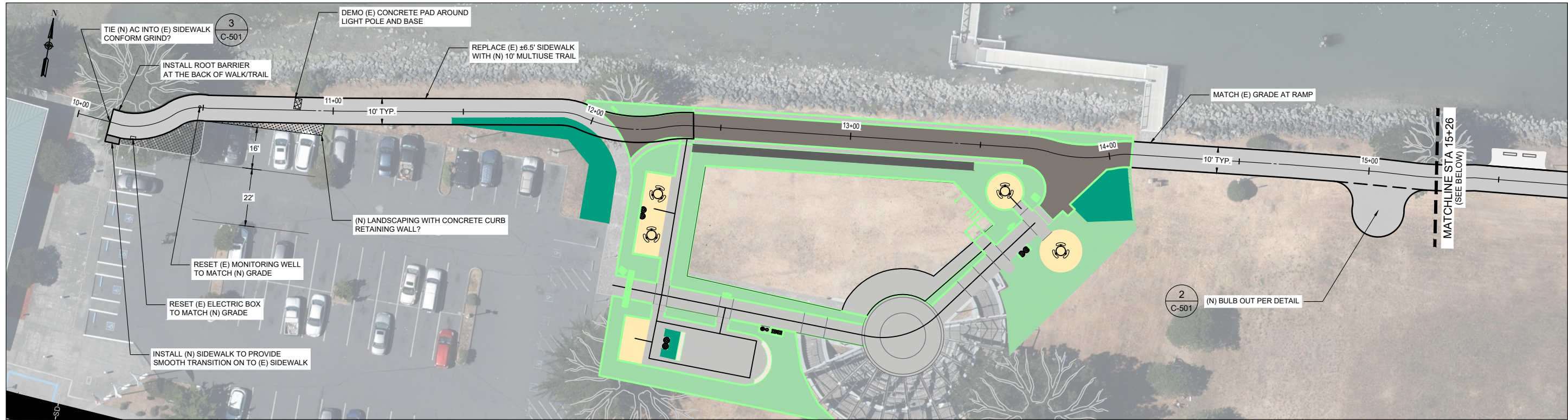

**TRAIL ALIGNMENT**  
STA 10+13 (START) - STA 15+26



**TRAIL ALIGNMENT**  
STA 15+26 - STA 20+69

**DO NOT COPY**

These Plans may not be reproduced unless they are original copies signed in ink by the Engineer. The Engineer preparing these Plans will not be responsible or liable for unauthorized changes or uses of these Plans. All changes to the Plans must be in writing and must be approved by the Engineer.

LEGEND		PER DETAIL
	(N) 0.2' AC	
	PULVERIZE (E) ASPHALT	

**SCALE**  
1:10 - FULL SIZE (22" x 34")  
1:20 - HALF SIZE (11" x 17")

No.	Date	Revisions	By	App.

Designed By: JJJ  
 Drawn By: AJF  
 Checked By: JJJ  
 Graphic Scale  
 Measures one inch on Full Size Drawings

**DRAFT**

**CITY OF EUREKA**  
 CALIFORNIA  
 Public Works Dept., Engineering Division  
 531 K Street, Eureka, CA 95501  
 (707) 441-4194 ph, (707) 441-4202 fax

**IMPROVEMENT PLAN 1**  
**HALVORSEN PARK IMPROVEMENTS**  
 BID NO. 2024-XX

Scale: AS SHOWN  
 Drawing: **C-101**  
 Sheet 2 of 5



**TRAIL ALIGNMENT**  
STA 20+69 - STA 26+17

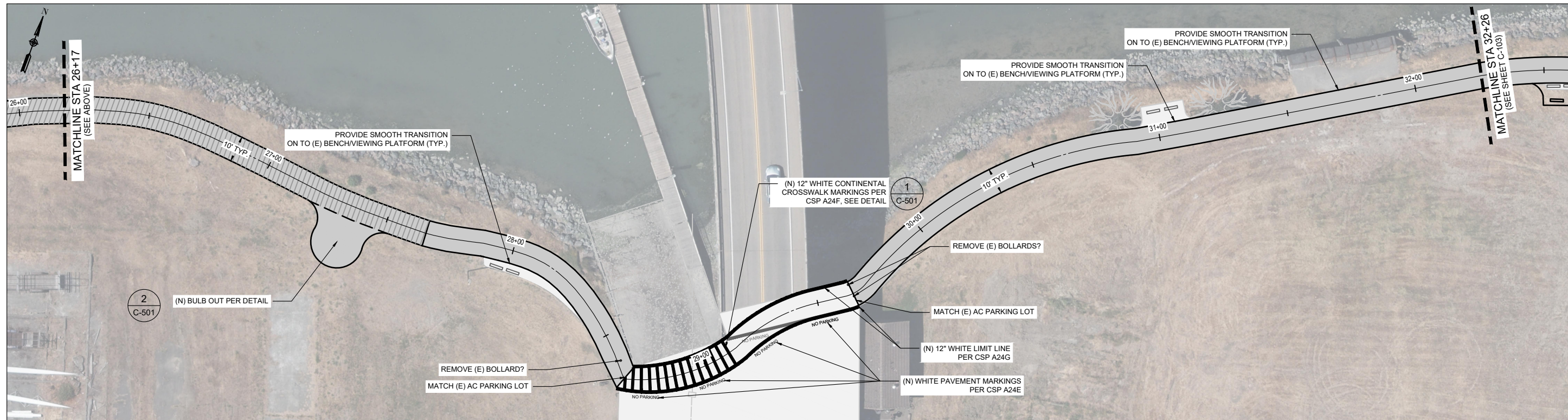

**TRAIL ALIGNMENT**  
STA 26+17 - STA 32+26

LEGEND	
	(N) 0.2' AC
	PULVERIZE (E) ASPHALT
	PER DETAIL

**SCALE**  
1:10 - FULL SIZE (22" x 34")  
1:20 - HALF SIZE (11" x 17")

**DO NOT COPY**

These Plans may not be reproduced unless they are original copies signed in ink by the Engineer. The Engineer preparing these Plans will not be responsible or liable for unauthorized changes or uses of these Plans. All changes to the Plans must be in writing and must be approved by the Engineer.

Designed By: JJJ	By: App.
Drawn By: AJF	Date
Checked By: JJJ	No.
Graphic Scale	Revisions
Measures one inch on Full Size Drawings	

**DRAFT**



**CITY OF EUREKA**  
CALIFORNIA  
Public Works Dept., Engineering Division  
531 K Street, Eureka, CA 95501  
(707) 441-4194 ph, (707) 441-4202 fax

**IMPROVEMENT PLAN 2**  
**HALVORSEN PARK IMPROVEMENTS**  
BID NO. 2024-XX

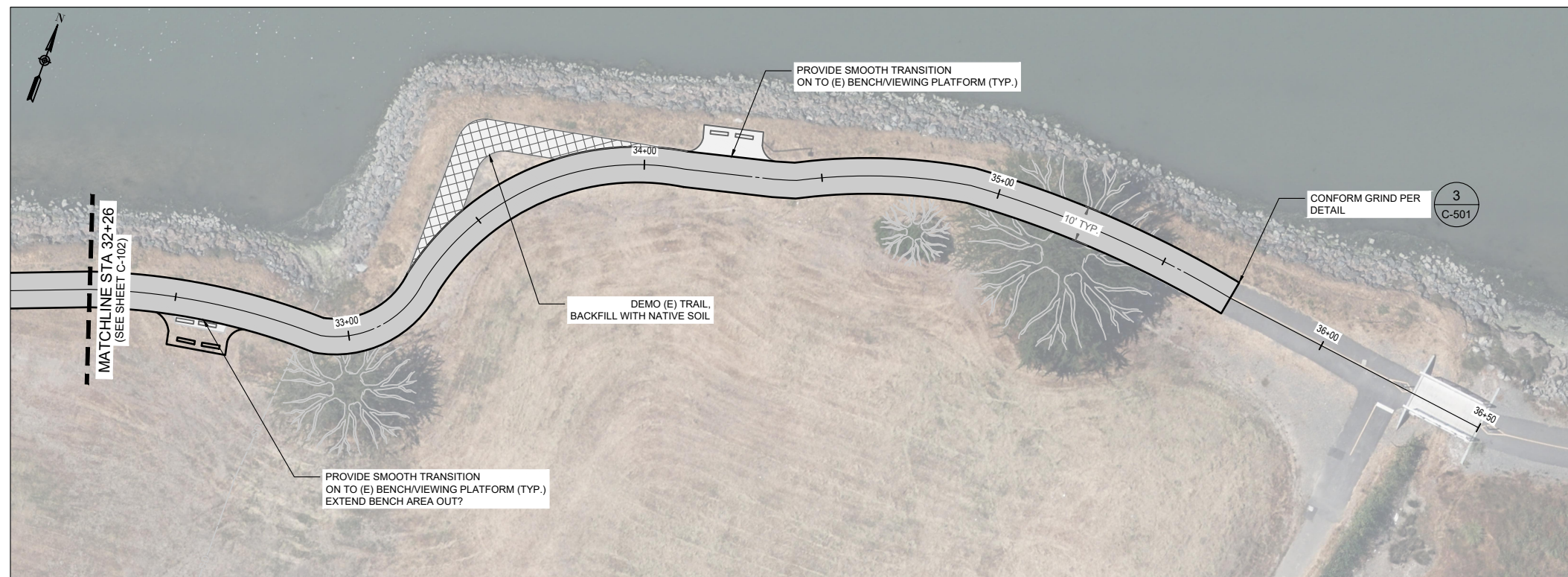
Scale: AS SHOWN
Drawing: C-102
Sheet 3 of 5

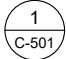

**TRAIL ALIGNMENT**  
STA 32+26 - STA 35+71 (END)

LEGEND	
	(N) 0.2' AC
	PULVERIZE (E) ASPHALT
	PER DETAIL
	

**SCALE**  
1:10 - FULL SIZE (22" x 34")  
1:20 - HALF SIZE (11" x 17")

**DO NOT COPY**  
These Plans may not be reproduced unless they are original copies signed in ink by the Engineer. The Engineer preparing these Plans will not be responsible or liable for unauthorized changes or uses of these Plans. All changes to the Plans must be in writing and must be approved by the Engineer.

Designed By: JJJ	
Drawn By: AJF	
Checked By: JJJ	
Graphic Scale	
Measures one inch on Full Size Drawings	

**DRAFT**

**CITY OF EUREKA**  
CALIFORNIA  
Public Works Dept., Engineering Division  
531 K Street, Eureka, CA 95501  
(707) 441-4194 ph, (707) 441-4202 fax

IMPROVEMENT PLAN 3  
HALVORSEN PARK IMPROVEMENTS  
BID NO. 2024-XX

Scale:	AS SHOWN
Drawing:	C-103
Sheet	4 of 5

No.	Date	Revisions	By	App.

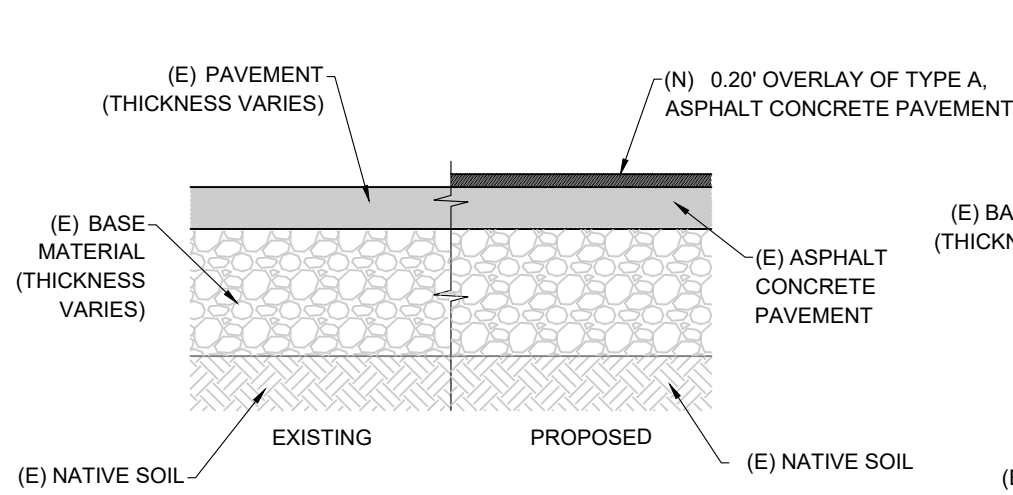

**OVERLAY**

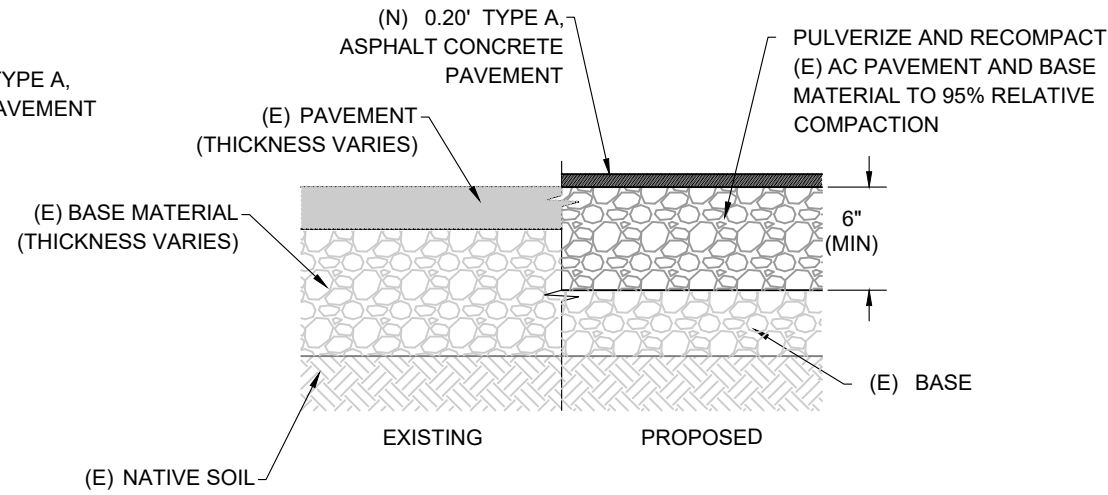

**PULVERIZED SECTION**

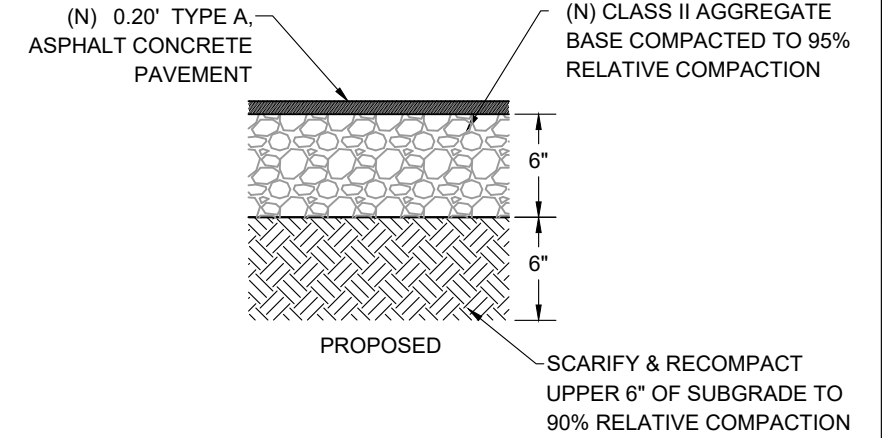

**BULB OUT SECTION**

**1 ASPHALT CONCRETE SECTION DETAILS**  
SCALE: NTS

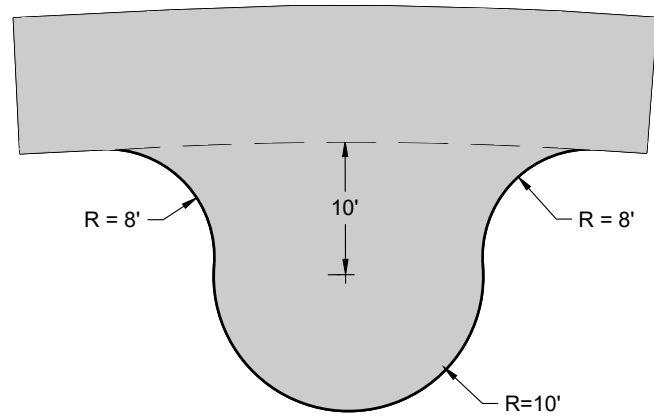

**2 TRAIL BULB OUT DETAIL**  
SCALE: NTS

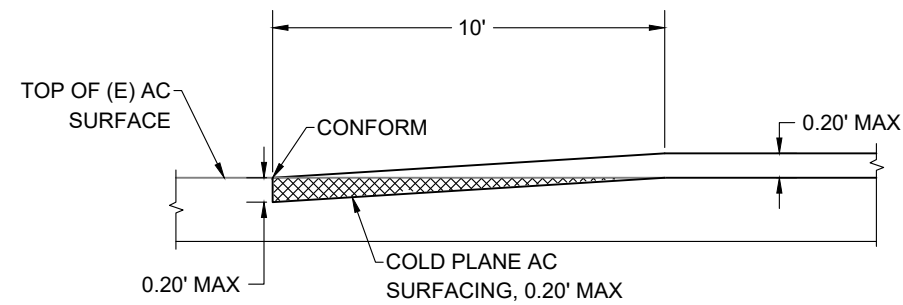

**3 CONFORM GRIND DETAIL**  
SCALE: NTS

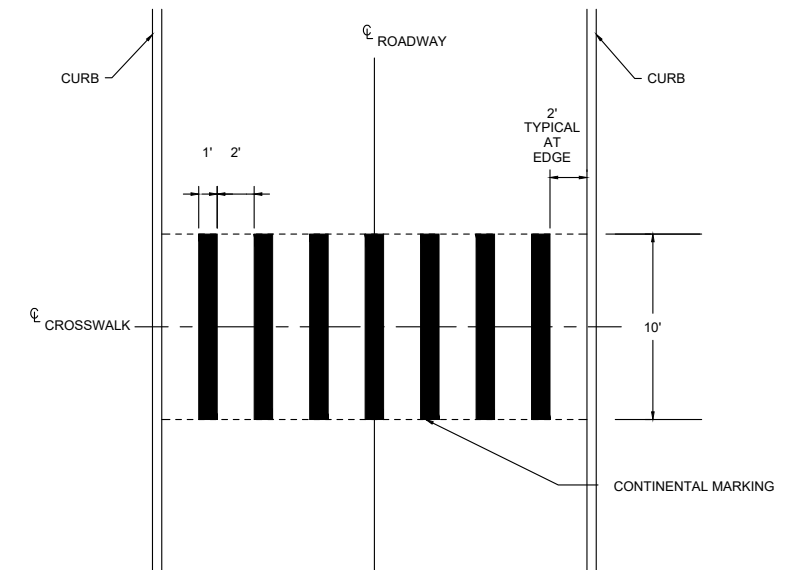

**4 TYPICAL CONTINENTAL CROSSWALK DETAIL**  
SCALE: NTS

**DO NOT COPY**

These Plans may not be reproduced unless they are original copies signed in ink by the Engineer. The Engineer preparing these Plans will not be responsible or liable for unauthorized changes or uses of these Plans. All changes to the Plans must be in writing and must be approved by the Engineer.

App.	
By	
Revisions	
Date	
No.	
Graphic Scale	Measures one inch on Full Size Drawings
Designed By: JJJ	
Drawn By: AJF	
Checked By: JJJ	

**DRAFT**

**CITY OF EUREKA**  
CALIFORNIA  
Public Works Dept., Engineering Division  
531 K Street, Eureka, CA 95501  
(707) 441-4194 ph, (707) 441-4202 fax

**CIVIL DETAILS**  
HALVORSEN PARK IMPROVEMENTS  
BID NO. 2024-XX