



VICINITY MAP
NOT TO SCALE

DIRECTIONS TO SITE:

- FROM EUREKA, CA
- HEAD EAST ON CA-299
- TURN RIGHT AT MARTIN DRIVE
- CONTINUE UP SLOPE TO COUNTY RTE 8L100
- TURN RIGHT ONTO STATON LANE
- CONTINUE STRAIGHT FOR 0.4 MILES

PROJECT DESCRIPTION:

NEW EARTH FARMS, LLC IS PROPOSING TO PERMIT NEW CANNABIS CULTIVATION ACTIVITIES IN ACCORDANCE WITH THE COUNTY OF HUMBOLDT'S (COUNTY) COMMERCIAL CANNABIS LAND USE ORDINANCE (CCLUO), ORDINANCE NO. 2554. THE EXISTING OPERATION INCLUDES APPROXIMATELY 10,000 SQUARE FEET (SF) OF APPROVED MIXED-LIGHT CULTIVATIONS AREA (APP. NO. 12260). THE APPLICANT IS PROPOSING THE ADDITION OF 32,500 SF OF MIXED-LIGHT CULTIVATION FOR A TOTAL OF 42,500 SF OF MIXED-LIGHT CULTIVATION AREA.

GENERAL NOTES:

1. DRAWING SCALE AS NOTED. WRITTEN DIMENSIONS SHALL TAKE PRECEDENCE OVER SCALED DIMENSIONS.
2. THIS IS NOT A BOUNDARY SURVEY. BOUNDARY INFORMATION DEPICTED HAS BEEN OBTAINED FROM HUMBOLDT COUNTY 2015 GIS DATA. NORTHPOINT CONSULTING GROUP, INC. HAS NOT VERIFIED THIS PROPERTY BOUNDARY.
3. THERE ARE NO NEARBY SCHOOLS, SCHOOL BUS STOPS, PLACES OF WORSHIP, PUBLIC PARKS OR TRIBAL RESOURCES WITHIN 600 FEET OF THE PROPOSED CULTIVATION AREA.

PLOT PLAN

22x34 SHEET: 1"=100'
11x17 SHEET: 1"=200'

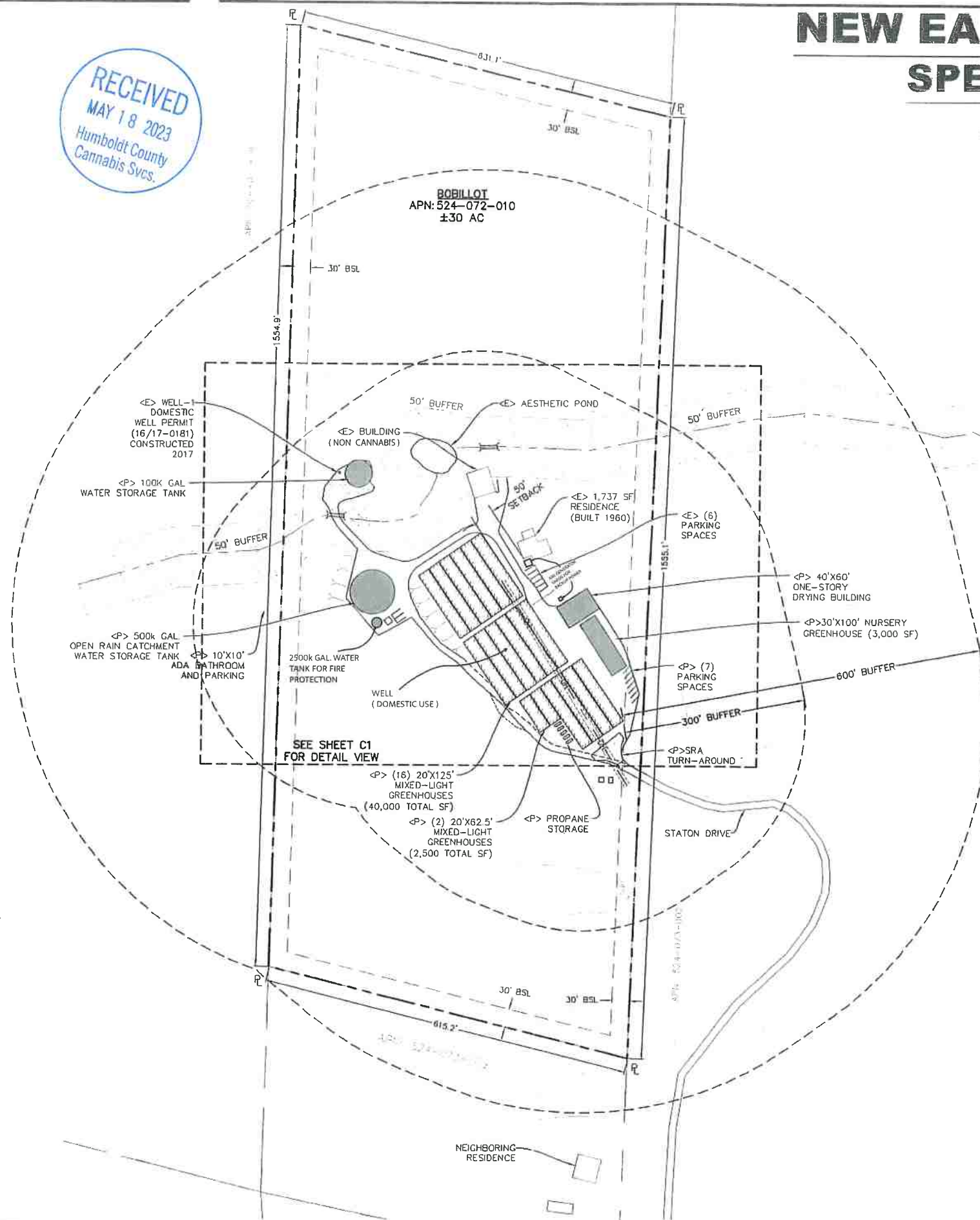

NEW EARTH FARMS, LLC SPECIAL PERMIT

APN: 524-072-010

PROJECT INFORMATION:

APPLICANT:

NEW EARTH FARMS, LLC
P.O. BOX 153
WILLOW CREEK, CA 95573

PROPERTY OWNER:

SECOND 707 REALTY, LLC
P.O. BOX 153
WILLOW CREEK, CA 95573

APPLICANTS AGENT:

NORTHPOINT CONSULTING GROUP, INC
1117 SAMOA BLVD.
ARCATA, CA 95521
(707) 798-6438

SITE ADDRESS:

APN: 524-072-010
600 STATON LANE
WILLOW CREEK, CA 95573

EXISTING MIXED LIGHT CULTIVATION AREA = 10,000 SF
PROPOSED MIXED LIGHT CULTIVATION AREA = 42,500 SF

EARTH WORK QUANTITIES = TBD

WATER = PRIVATE
SEWER = PRIVATE

PROPERTY SIZE (WEBGIS) = ±21.74 ACRES
PROPERTY SIZE (ASSESSED) = ±30 ACRES
ZONING = U (UNCLASSIFIED)
GENERAL PLAN DESIGNATION = RA40

BUILDING SETBACK

	U	SRA
FRONT	20'	30'
SIDE	5'	30'
REAR	10'	30'

SRA AREA = YES
IN COASTAL ZONE = NO
IN 100 YR FLOOD ZONE = NO



SHEET INDEX:

- C0 - SPECIAL PERMIT SITE PLAN, VICINITY MAP, & PROJECT NOTES
- C1 - SITE PLAN DETAIL

NEW EARTH FARMS, LLC - SPECIAL PERMIT
600 STATON LN. WILLOW CREEK, CA 95537 / APN: 524-072-010
SPECIAL PERMIT - SITE PLAN

PROJECT NO: PS
DRAWN BY: CJC
DATE: 08/18/22
SCALE: AS SHOWN

SHEET
C0



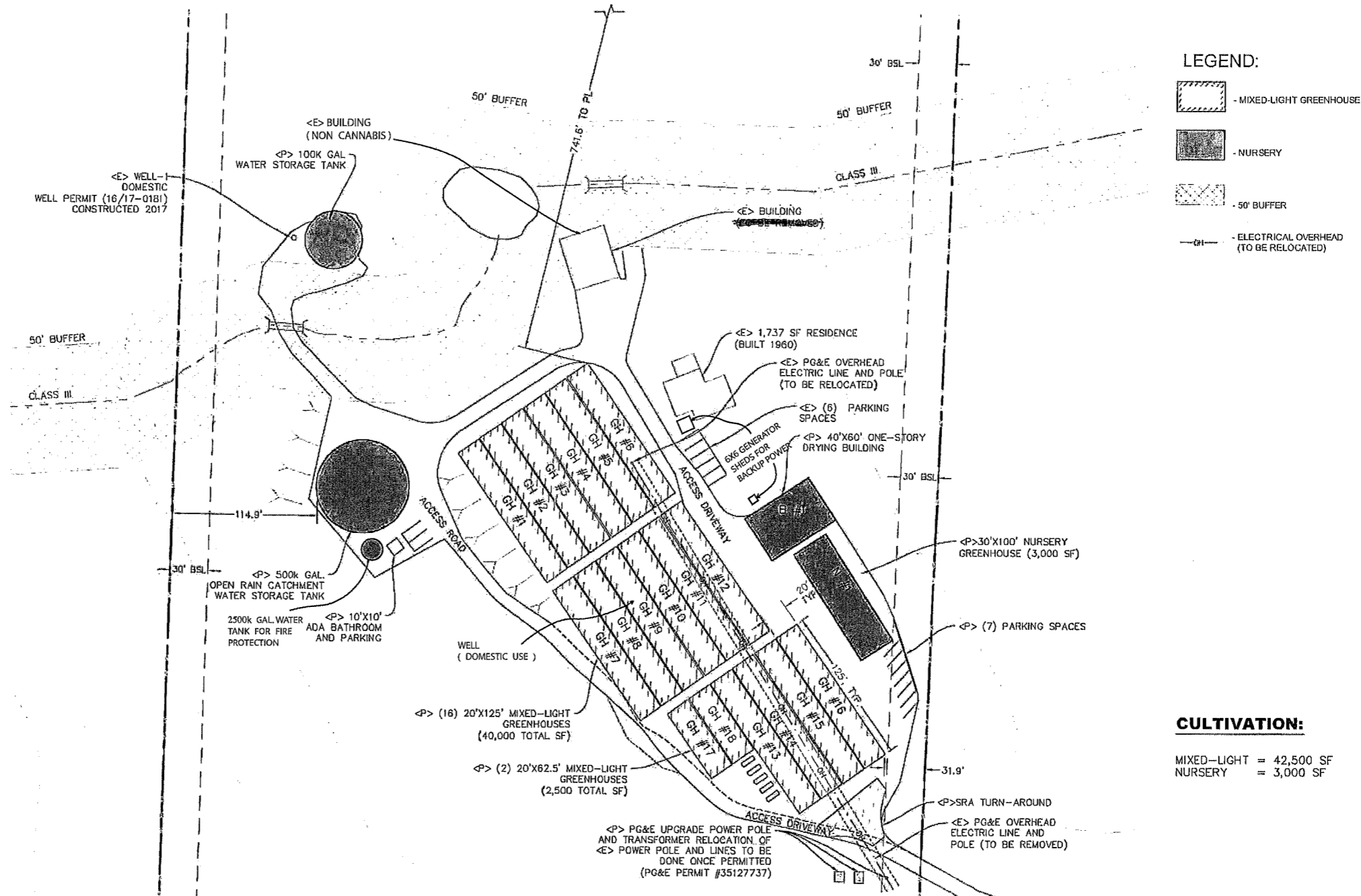

18-124

NEW EARTH FARMS, LLC SPECIAL PERMIT

APN: 524-072-010



LEGEND:

-  - MIXED-LIGHT GREENHOUSE
-  - NURSERY
-  - 50' BUFFER
-  - ELECTRICAL OVERHEAD (TO BE RELOCATED)

CULTIVATION:

MIXED-LIGHT = 42,500 SF
NURSERY = 3,000 SF

SITE PLAN DETAIL

22x34 SHEET: 1"=50'
11x17 SHEET: 1"=100'

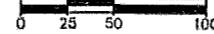

NEW EARTH FARMS, LLC - SPECIAL PERMIT
600 STATON LN. WILLOW CREEK, CA 95537 / APN: 524-072-010
SPECIAL PERMIT - SITE PLAN DETAIL (OPTION 1)

PROJECT NO:	PS
DESIGNED BY:	CJS
DATE:	08/18/23
SCALE:	AS SHOWN
SHEET	
C1	
18-124	

December 21, 2022 - 15:30 Date Stamp: 2/18/2023, Michael - New Earth Farms - Station Ln, Willow Creek, CA 95537 - 524-072-010 - 18-124