



TABLE 17-5: PROJECTING AND SUSPENDED SIGNS:

| Standard [1] | Zone District | |
|---------------------------------------|--|--------------------------------|
| | CN, CW, OR | CS, MC, MG, ML |
| Max. number | 1 per tenant frontage | 1 per tenant frontage |
| Max. area | 18 sq. ft. per tenant frontage | 24 sq. ft. per tenant frontage |
| Max. height | Height of building to which it is attached | |
| Maximum projection from building wall | 8 ft. | |

Notes:
 [1] Standards apply only to ground-floor tenants and uses. See 10-5.1708.3 (Multi-story buildings).
 [2] The Building Code may require a projection less than eight feet

TABLE 17-6: AWNING / CANOPY SIGNS:

| Standard | Zone District | |
|---------------------------------------|---|--|
| | CN, CW, ML, OR | CS, MC, MG |
| Max. number | No max. | |
| Max. area | 25 sq. ft. or area of awning or canopy fascia, whichever is less | 35 sq. ft. or area of awning or canopy fascia, whichever is less |
| Max. height (awning signs) | Height of awning area | |
| Max. height (canopy signs) | Height of canopy fascia; 3 ft. for signs atop canopy | Height of canopy fascia; 4 ft. for signs atop canopy |
| Max. width | The building wall to which it is attached or the tenant space it identifies | |
| Maximum projection from building wall | No max. | |

Note: Standards apply only to ground-floor tenants and uses. See 10-5.1708.3 (Multi-story buildings).

MASTER SIGN PLAN NOTES:
 THIS MASTER SIGN PLAN IS SUBMITTED IN ORDER TO GAIN APPROVAL OF THE TWO SIGNS SERVING THE 4th FLOOR TENANT SPACE PER PER EMC §10-5.1707.3, IN ACCORDANCE WITH CITY OF EUREKA TITLE 10, CHAPTER 5, ARTICLE 17: SIGNS, WHICH WAS UPDATED EFFECTIVE LATE 2022. NOTE EXISTING SIGNS FOR GROUND FLOOR TENANTS WHERE PREVIOUSLY APPROVED ADMINISTRATIVELY.

- VERIFY ALL DIMENSIONS WITH INSTALLATION CONDITIONS.
- TENANTS ARE RESPONSIBLE FOR ALL GRAPHICS & FINAL SIGN DESIGN DETAILS. LOGOS INCLUDED IN THESE DRAWINGS MAY BE SUBJECT TO COPYRIGHT AND ARE SHOWN FOR REFERENCE ONLY.
- NO INTERNALLY ILLUMINATED SIGNAGE.
- PROVIDE STREET ADDRESS NUMBERS PER PUBLIC WORKS AND CBC SECTION 502.
- COMPLY WITH CITY OF EUREKA LAND USE CODE TITLE 10 CHAPTER 5, REVISED LATE 2022.
- TOTAL STREET FRONTAGE = 230 LF, TIMES 2 SF / LF = 460 SF MAX. FOR PARCEL ON-PREMISES SIGN AREA. NOTE THERE ARE BONUS SIGN AREAS ALLOWABLE PER SIGN REGULATION ITEM E.
- NO SIGN ABOVE ROOF LINE.
- SEE REGULATIONS FOR INTERIOR WINDOW SIGNS AND OTHER SIGNS NOT INCLUDED HERE.

TENANT SIGNAGE SUMMARY
 THE FOLLOWING SIGNS WERE ADMINISTRATIVELY APPROVED AND ARE NOT CHANGED:

| SIGN ID | SIGN TYPE | DRAWING | AWNING FASCIA AREA (SF) | MAX. SIGN AREA (SF) | NOTES |
|---------|--------------|---------|-------------------------|---------------------|-------|
| A1 | AWNING FRAME | 1/A7.6 | 10.13 SF | 10 SF | |
| A2 | BLADE | 1/A7.10 | N/A | 18 SF | |
| B1 | AWNING FRAME | 1/A7.7 | 8.24 SF | 6.75 SF | |
| C1 | AWNING FRAME | 1/A7.8 | 10.39 SF | 10 SF | |
| C2 | BLADE | 3/A7.10 | N/A | 18 SF | |

THE FOLLOWING SIGNS ARE NEW, PROPOSED UNDER THIS MASTER SIGN PLAN, AND SERVE TENANT ABOVE GROUND FLOOR LEVEL:

| SIGN ID | SIGN TYPE | DRAWING | AWNING FASCIA AREA (SF) | MAX. SIGN AREA (SF) | NOTES |
|---------|------------|---------|-------------------------|---------------------|-----------|
| R1 | WALL SIGN | 6/A7.10 | N/A | 9 SF | |
| R2 | BLADE SIGN | 5/A7.10 | N/A | 18 SF | TWO-SIDED |



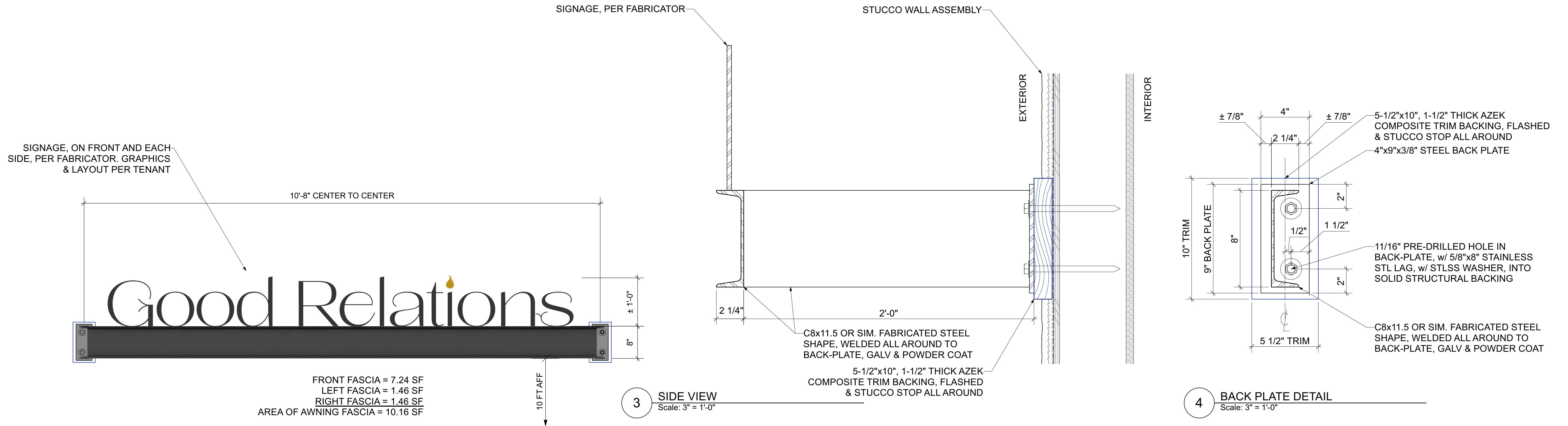

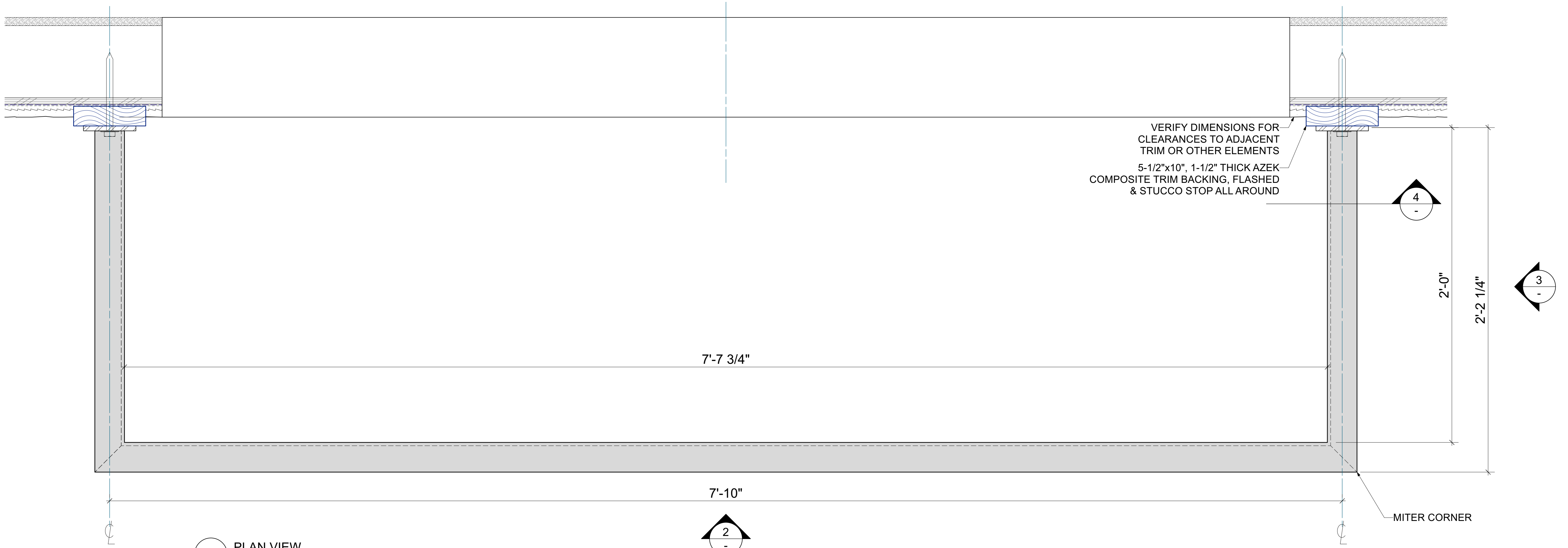
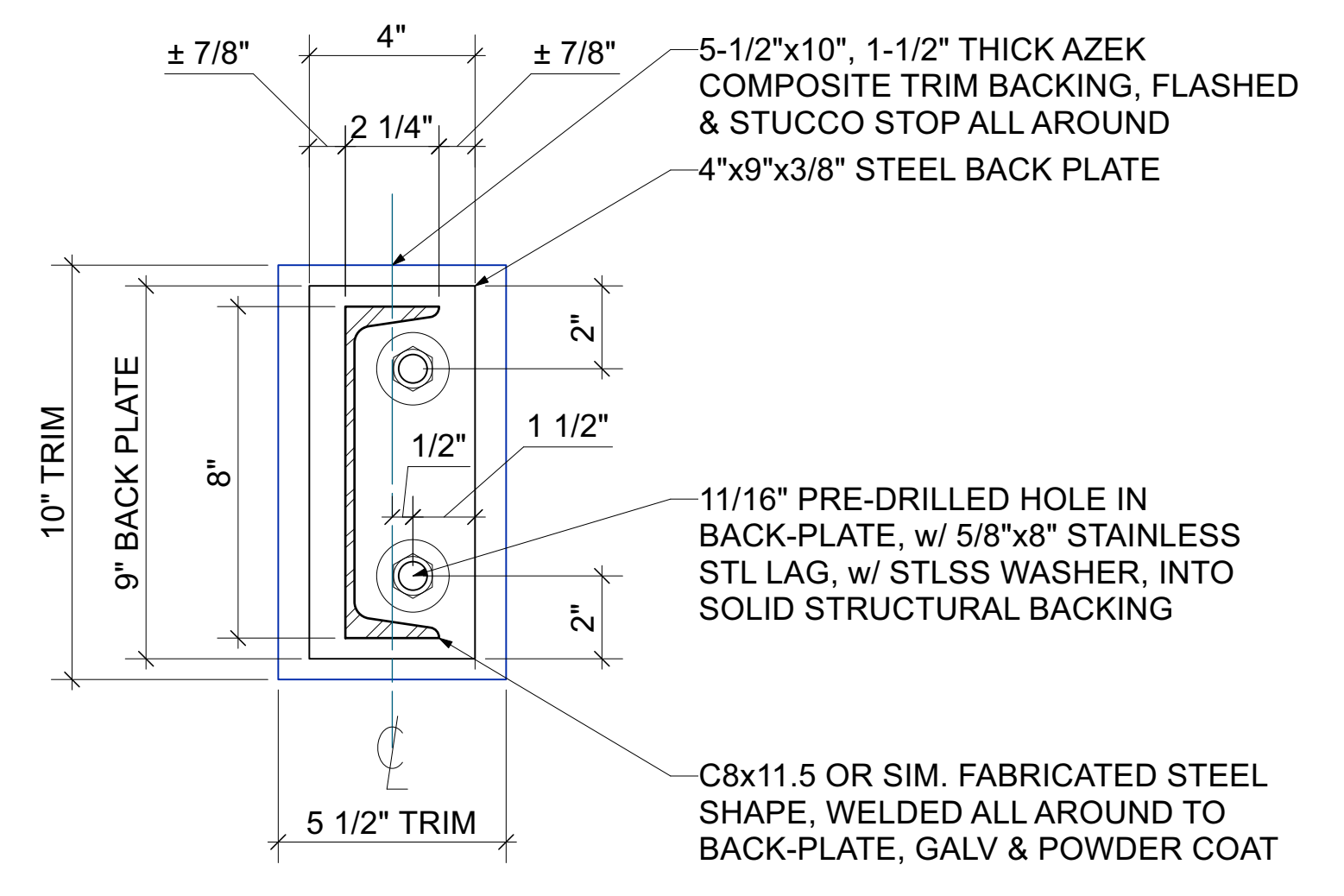
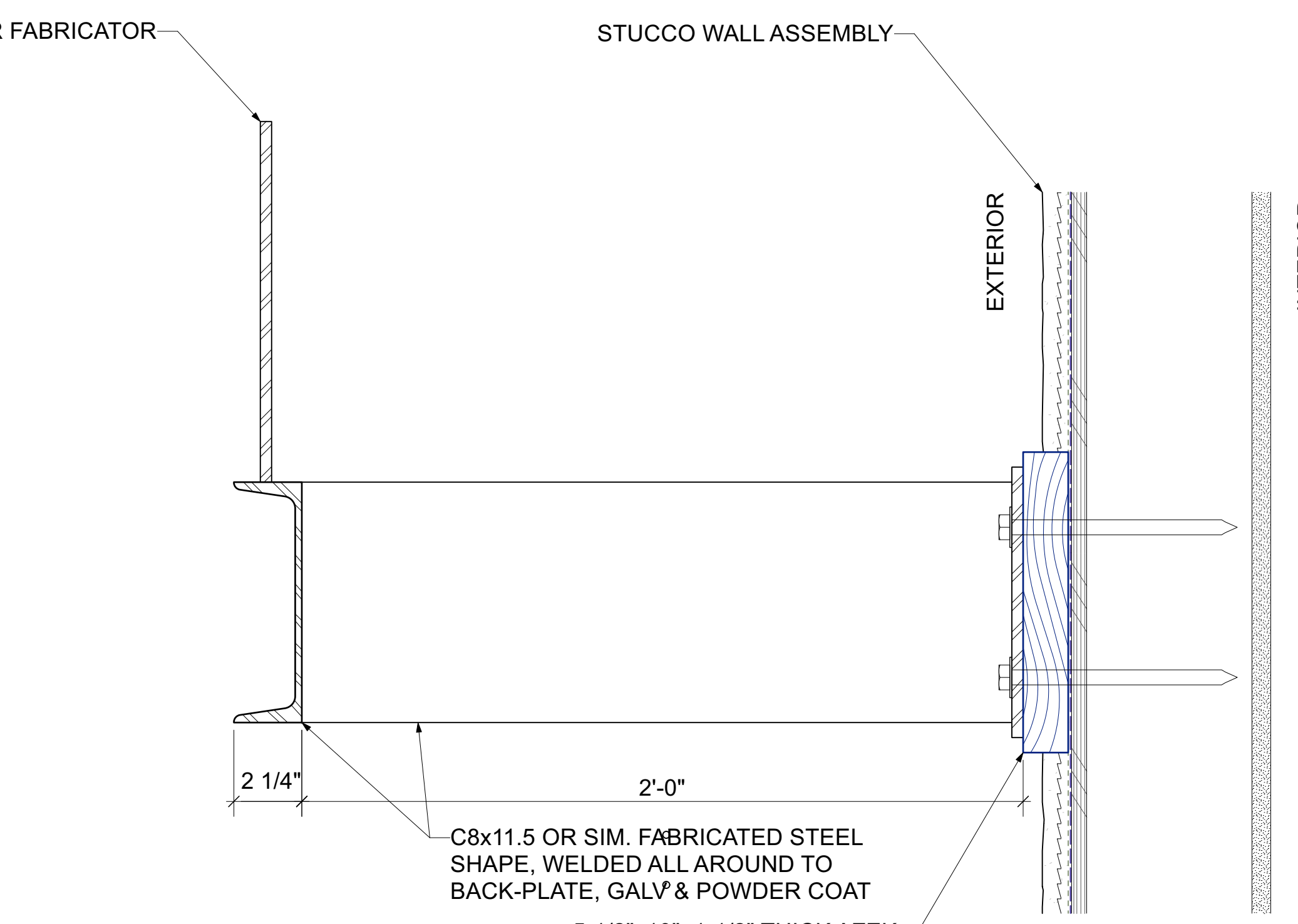
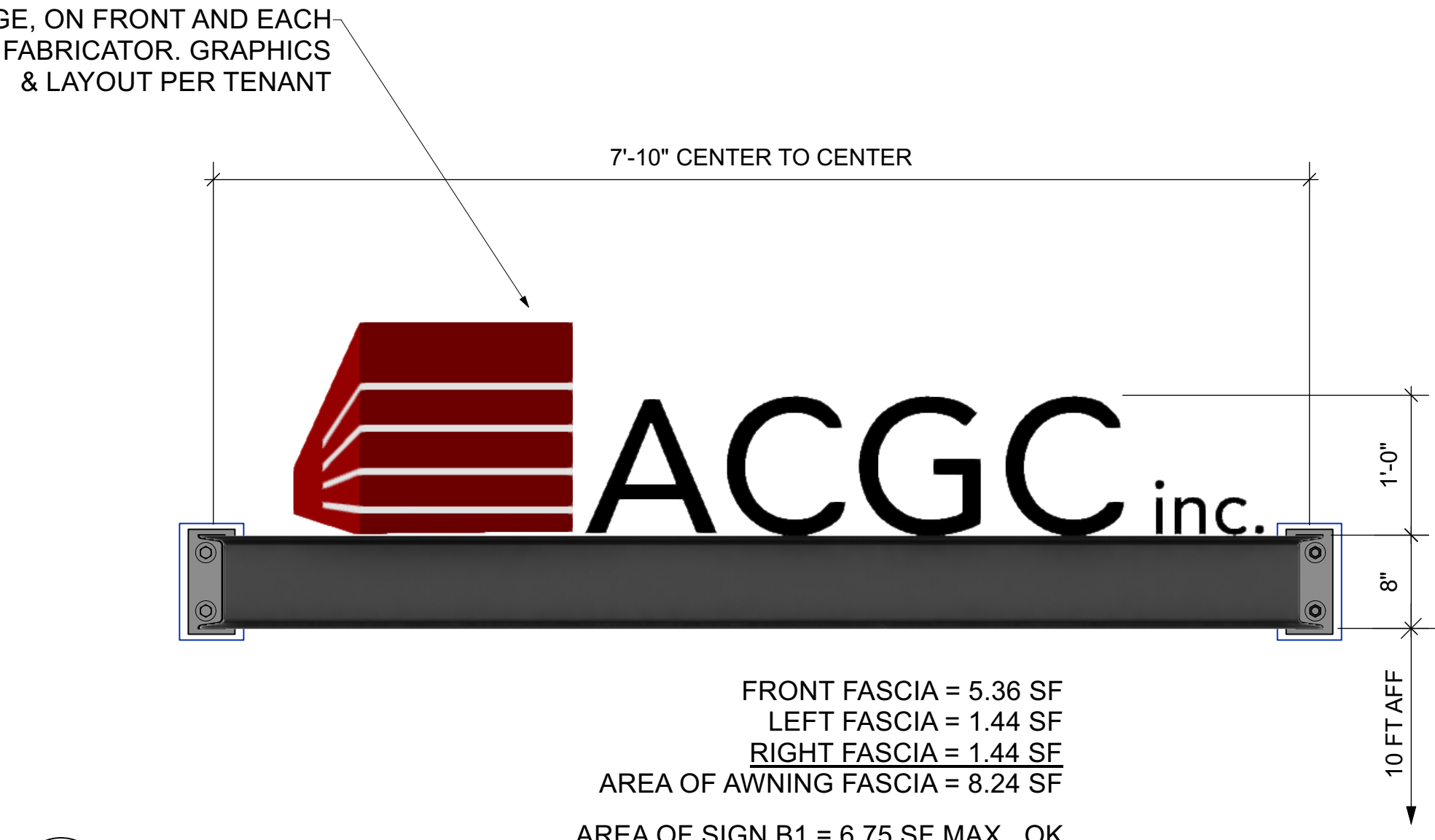
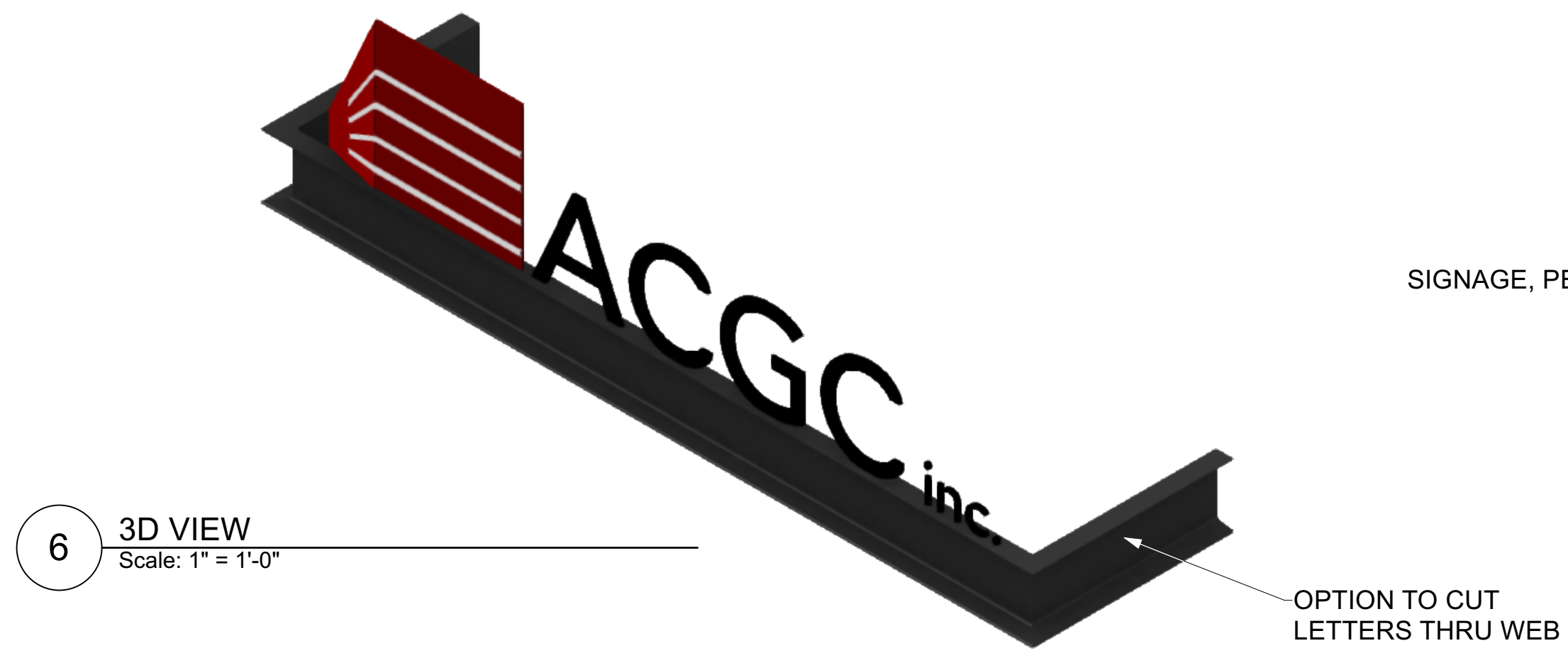

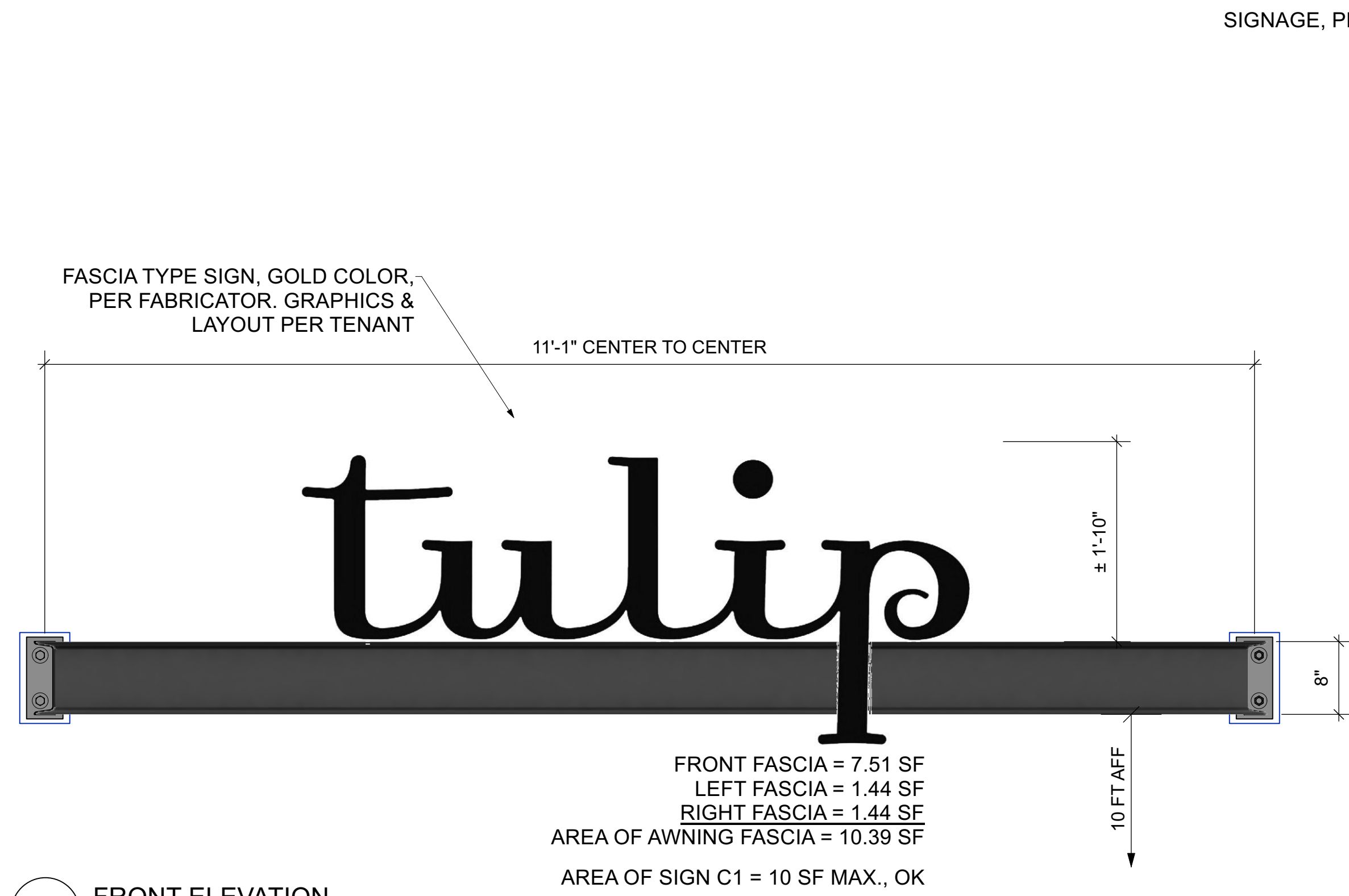

2 FRONT ELEVATION
 Scale: 1" = 1'-0"

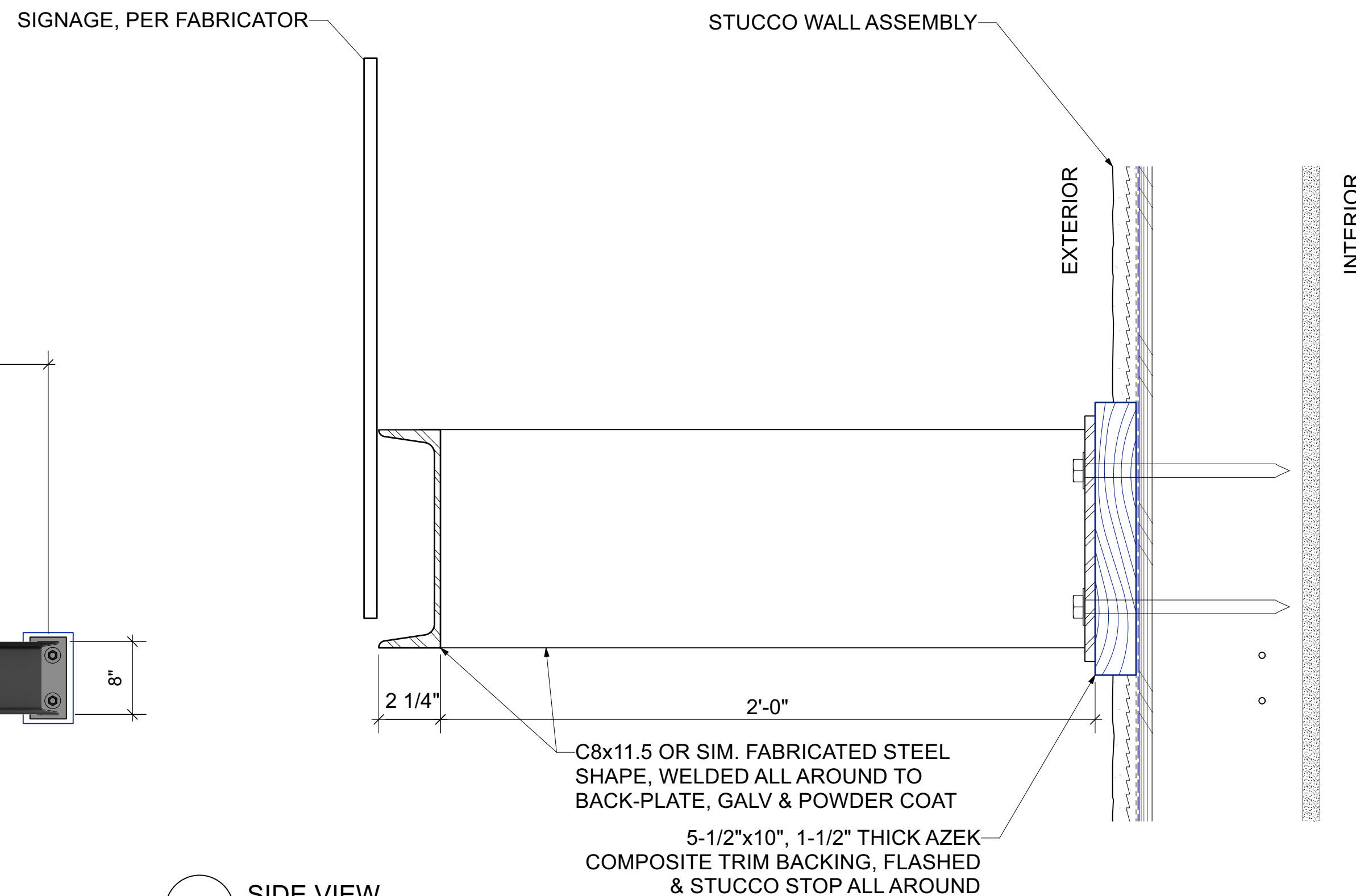

3 SIDE VIEW
 Scale: 3" = 1'-0"

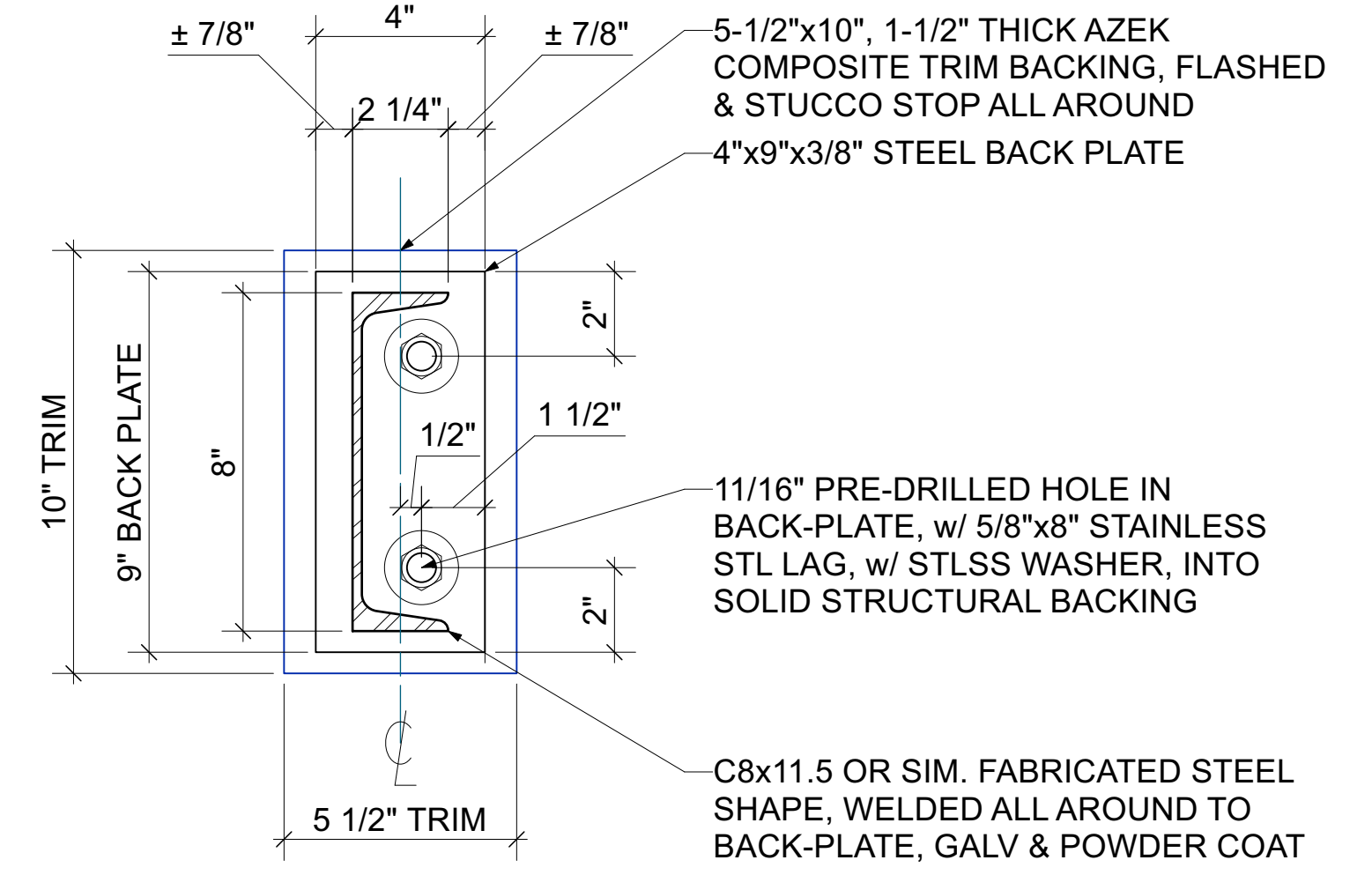

4 BACK PLATE DETAIL
 Scale: 3" = 1'-0"

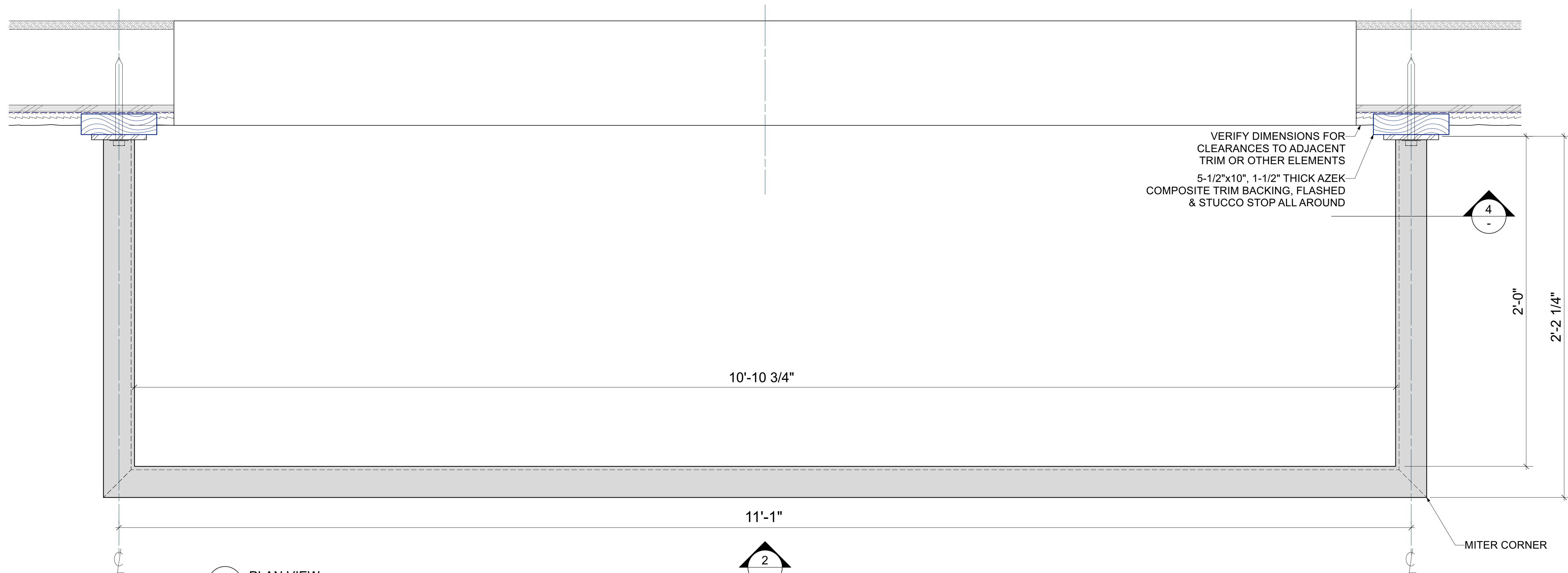

1 PLAN VIEW
 Scale: 3" = 1'-0"

NOTE: ALL SIGNS ARE EXTERNALLY ILLUMINATED. NO INTERNAL LIGHTING IS PROPOSED.

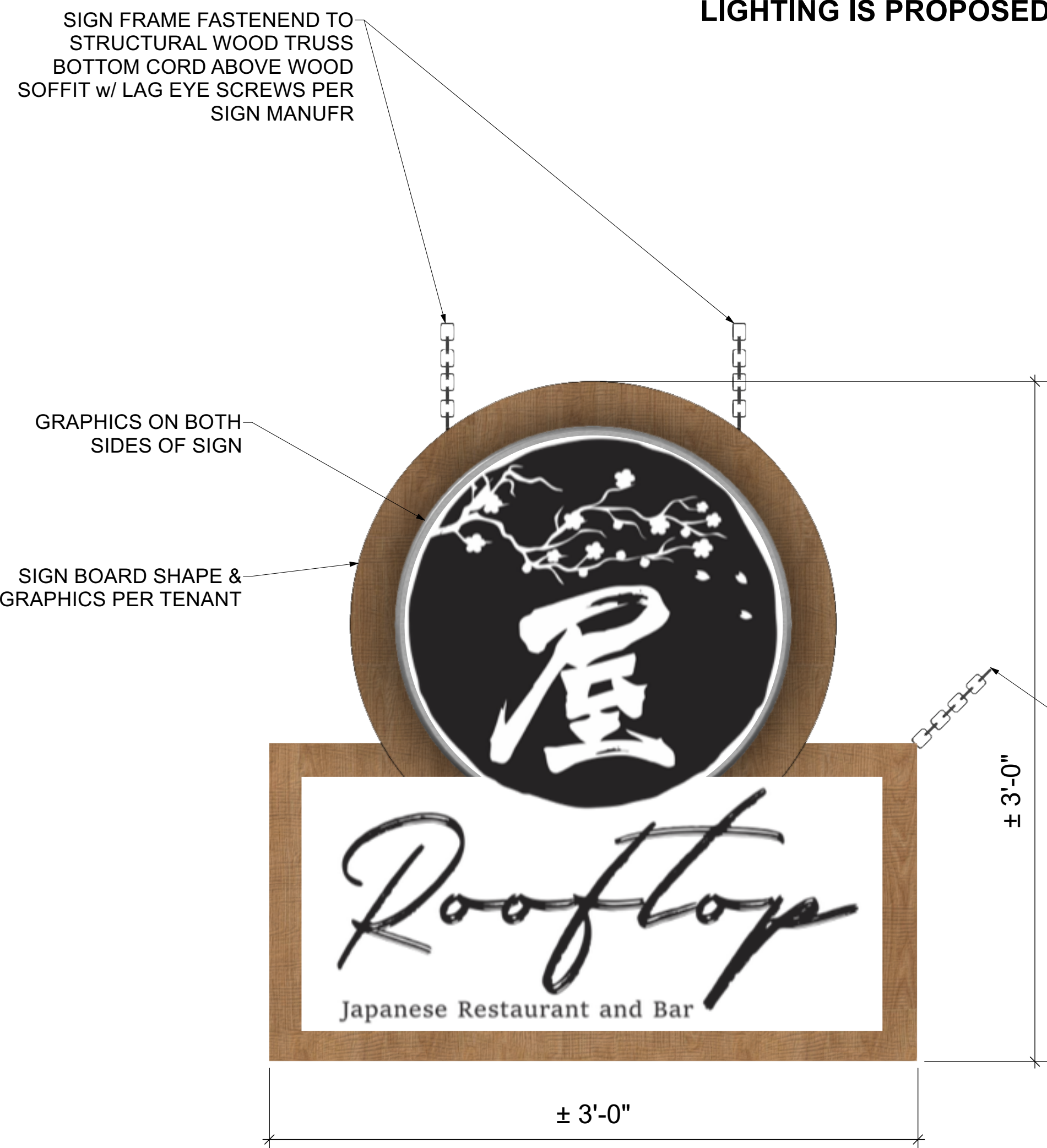

5 BLADE SIGN ELEVATION - ROOFTOP
Scale: ACTUAL SIZE

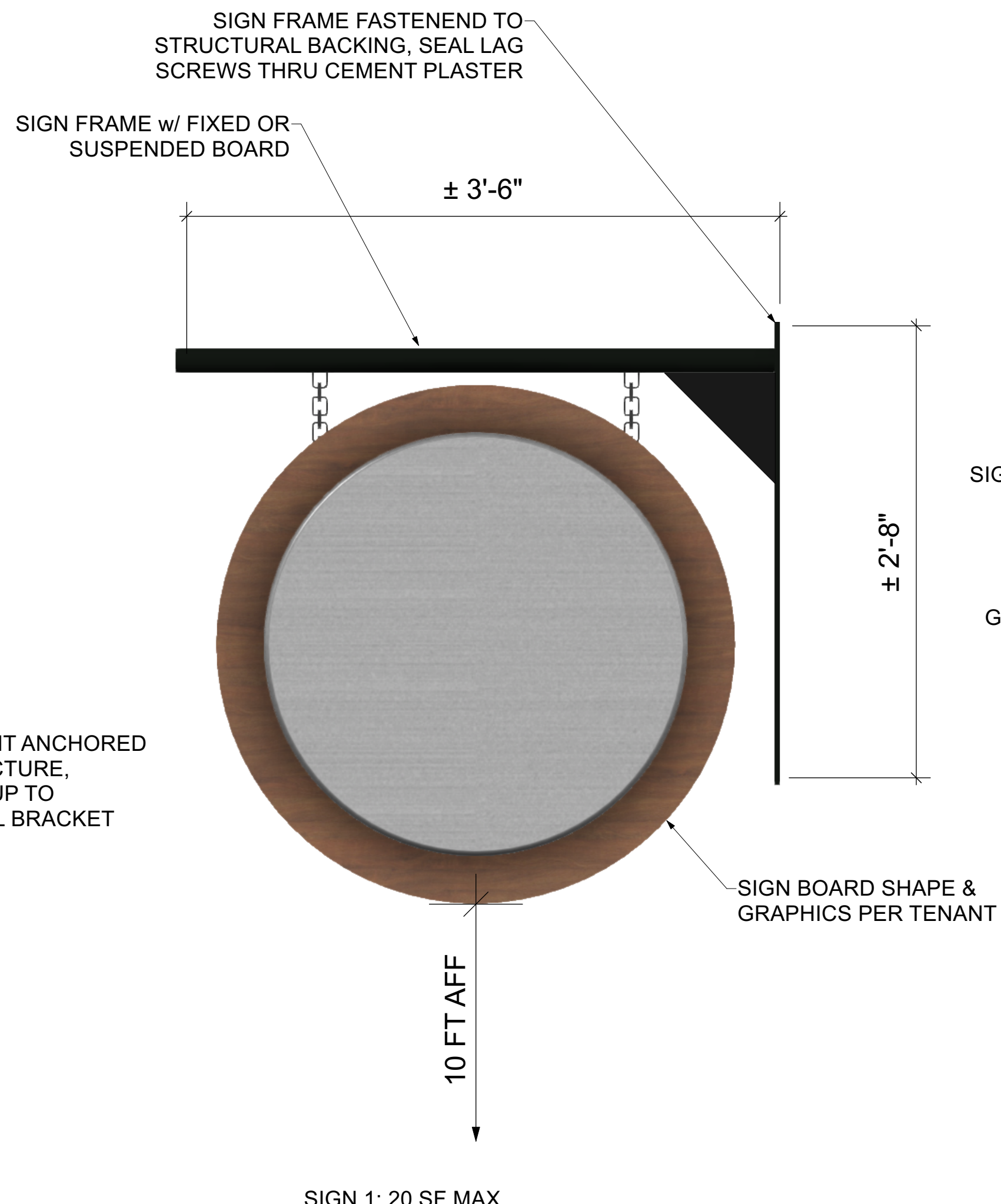

1 BLADE SIGN ELEVATION 1
Scale: 1 1/2" = 1'-0"

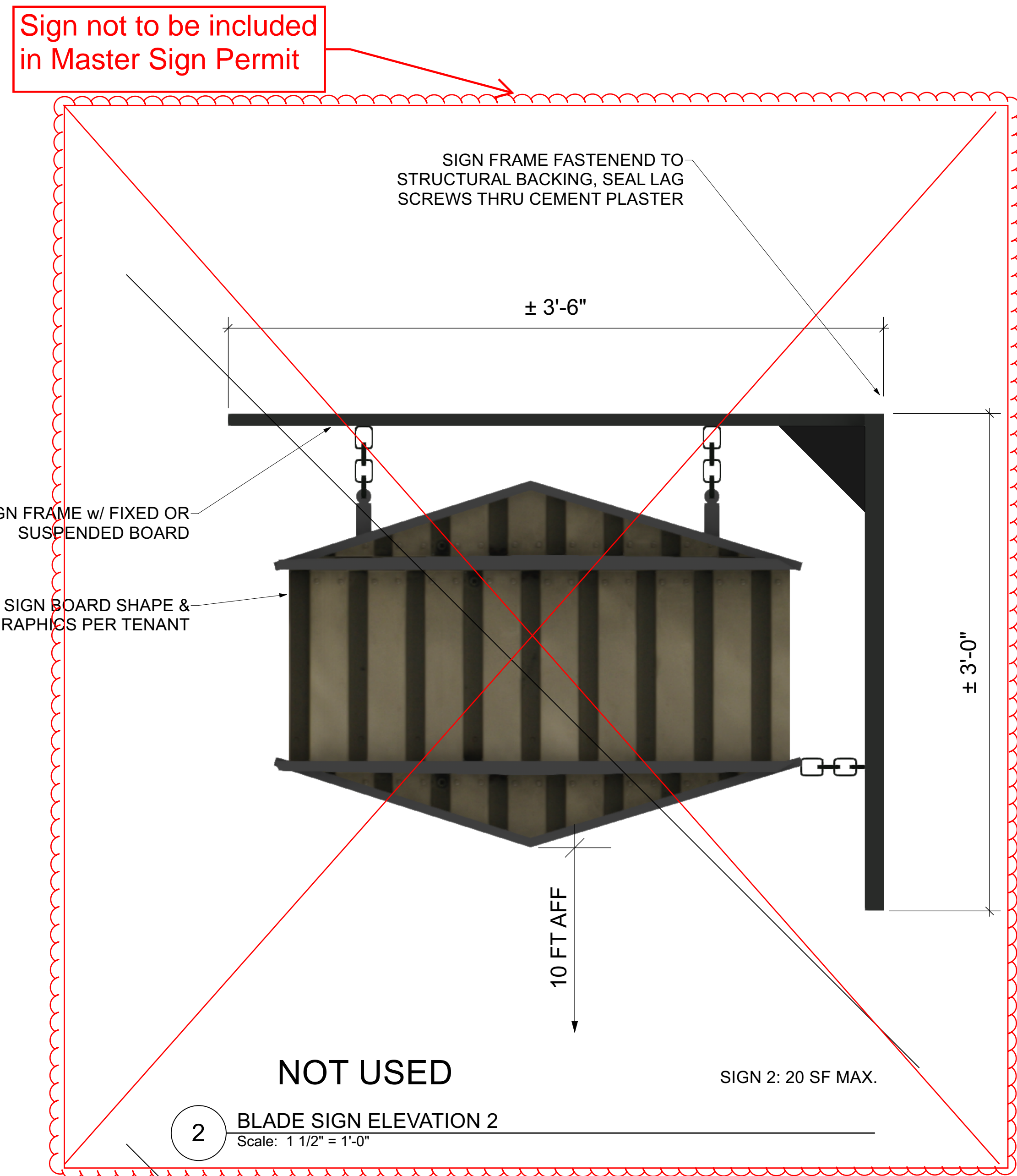

2 BLADE SIGN ELEVATION 2
Scale: 1 1/2" = 1'-0"



6 WALL SIGN ELEVATION - ROOFTOP
Scale: ACTUAL SIZE

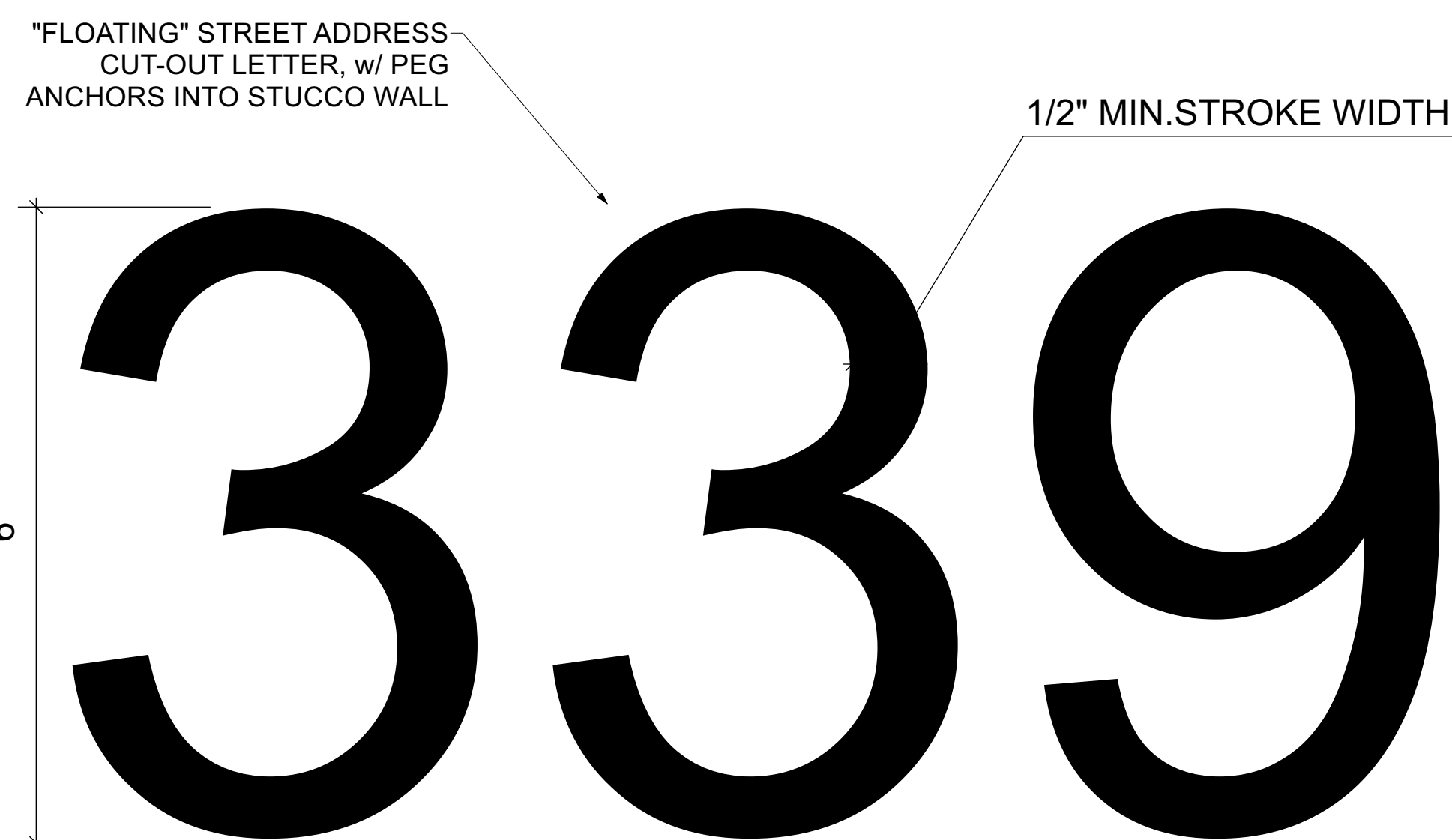

4 SITE ADDRESS LETTER SIGN
Scale: ACTUAL SIZE

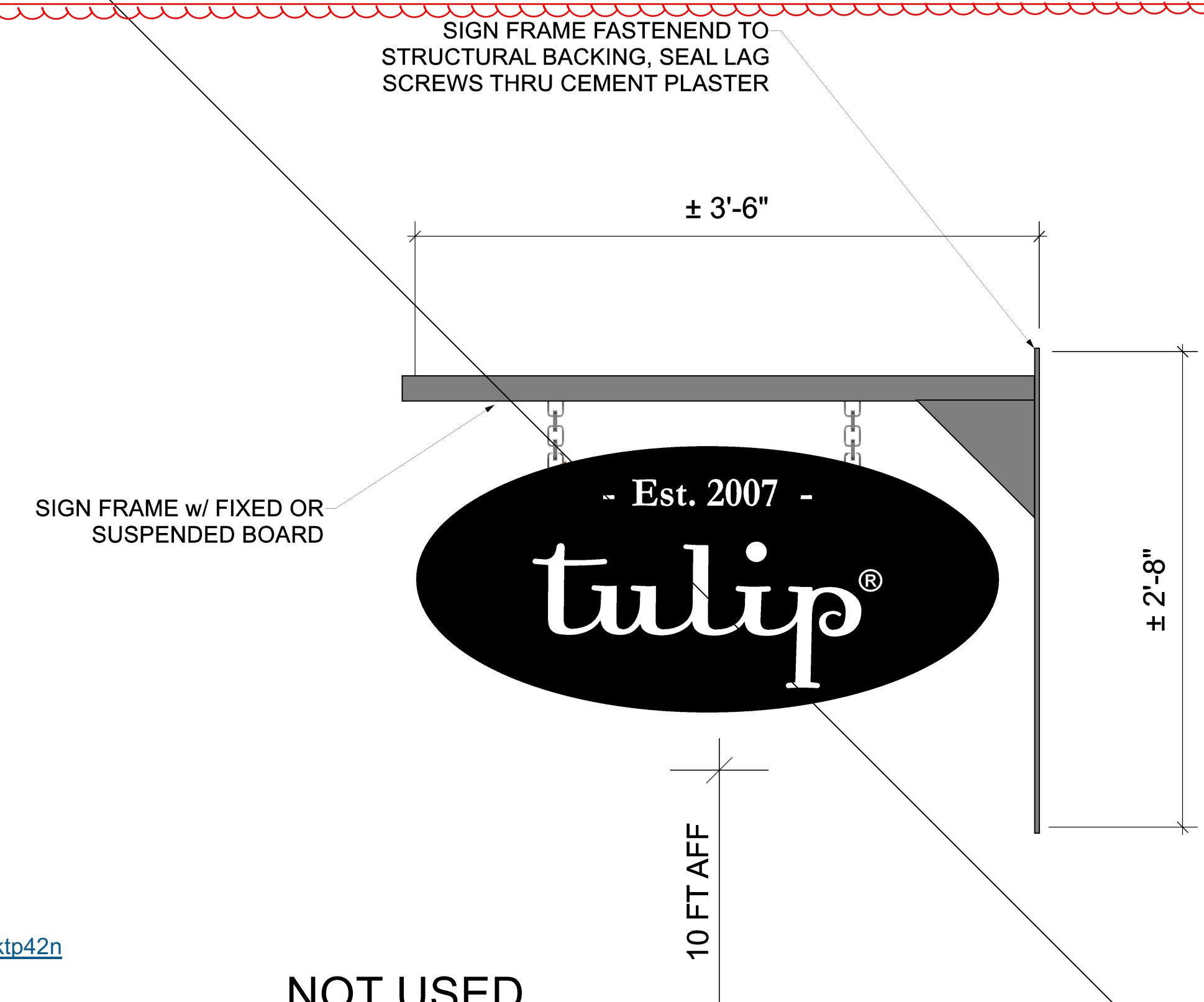

3 BLADE SIGN ELEVATION - TULIP
Scale: 1 1/2" = 1'-0"

LINK TO WEBSITE: <https://a.co/d/8ktp42n>