

HAPPY VALLEY FARMS LLC

APN: 210-051-081 APPS 12166



VICINITY MAP

1:10,000

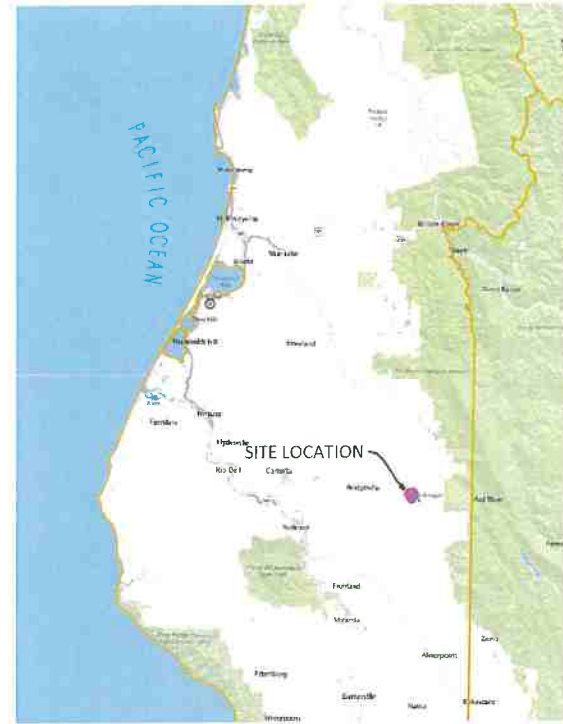

IMAGE SOURCE: BING 2020

PROJECT DIRECTIONS

- FROM: EUREKA, CA
- HEAD SOUTH ON US-101 (19.9 MI)
- TAKE EXIT 685 FOR CA-36E (0.3 MI)
- TURN LEFT ONTO CA-36E (33.4 MI)
- TURN LEFT ONTO LARABEE VALLEY RD (1.2 MI)
- CONTINUE STRAIGHT ONTO COYOTE RIDGE RD(9 MI)

TRAVEL TIME

APPROXIMATELY: 1 H 20 MIN (56 MI)

SHEET INDEX

- CP-COVER PAGE
- C1-PARCEL OVERVIEW

PROPERTY LINES, DISTANCES, AND BUILDING LOCATIONS ARE APPROXIMATE AND BASED ON AERIAL MAPS AND GPS DATA TAKEN IN THE FIELD.

PROJECT INFORMATION

LAT/LONG: 40.4574, -123.6845
 APN: 210-051-081
 APPLICANT: HAPPY VALLEY FARMS, LLC
 PARCEL SIZE: ± 160 ACRES
 ZONING: FIND ON INFO PAGE
 APPLICATION TYPE:

COASTAL ZONE: N
 100 YEAR FLOOD: N

AERIAL MAP



IMAGE SOURCE: BING 2020



PROJECT INFORMATION

PROPERTY OWNER: HAPPY VALLEY FARMS
 ADDRESS: APN: 210-051-081
 SHEET INFO: COVER PAGE

REVISIONS

NO	NOTES	DATE
1	REVISIONS	08-08-23
2	REVISIONS	08-08-23
3	REVISIONS	08-08-23
4	REVISIONS	08-08-23
5	REVISIONS	08-08-23
6	REVISIONS	08-08-23

DATE: 8/2/23
 DRAFTER: XX
 SCALE: AS SHOWN

SHEET
CP

PARCEL OVERVIEW

APN: 210-051-081

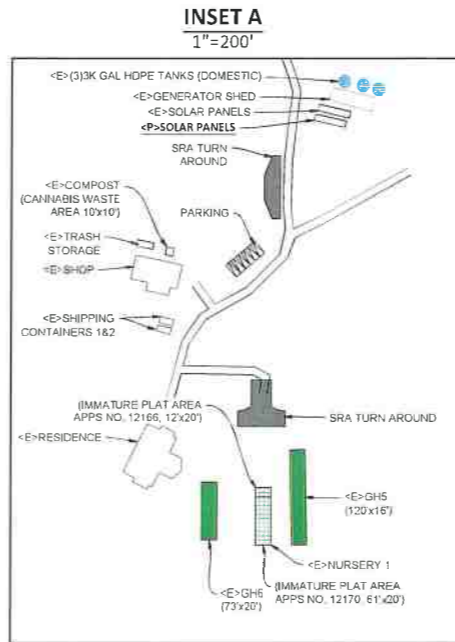
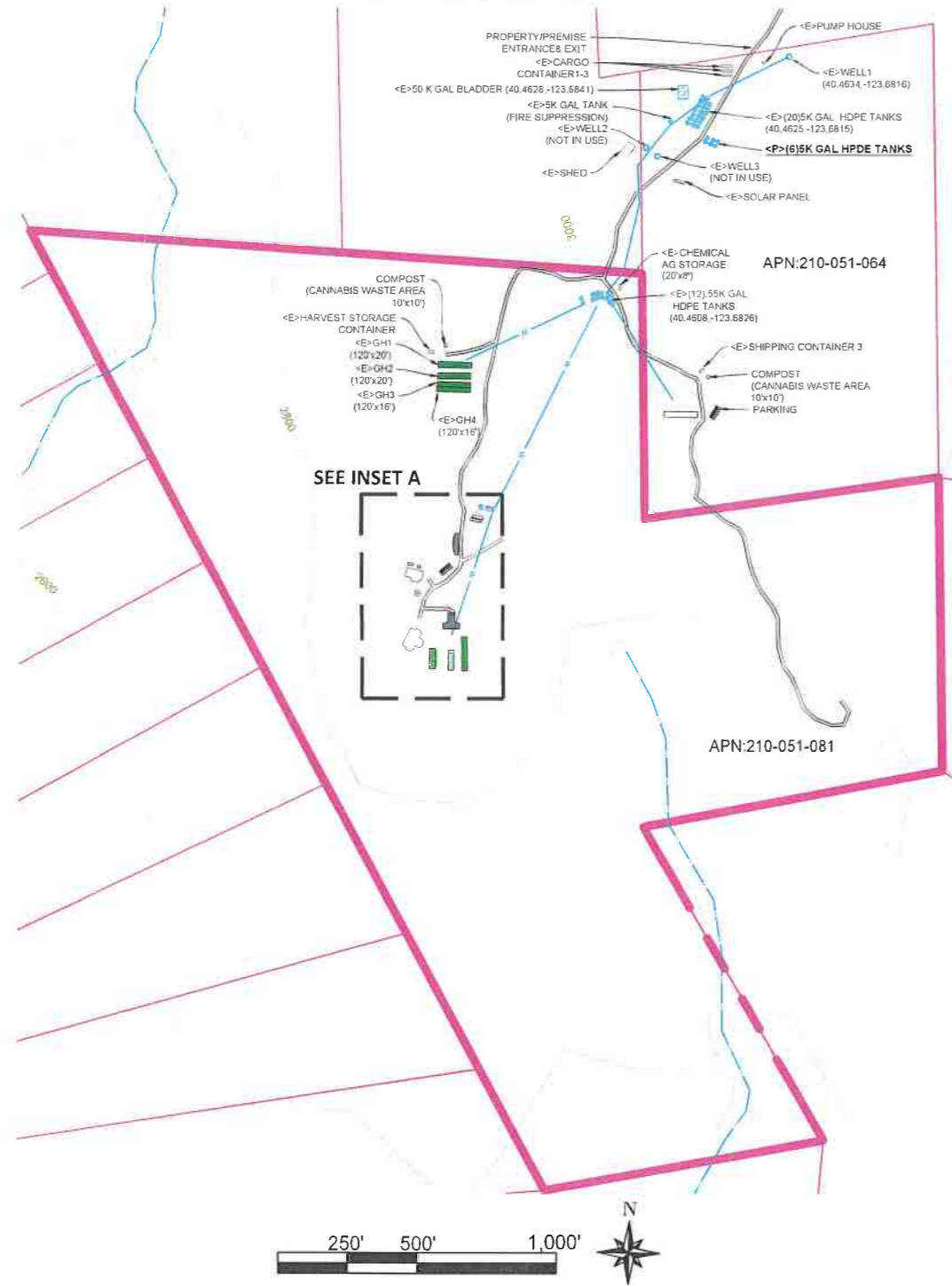

LEGEND

- UNNAMED CLASS III WATERCOURSE WITH REQUIRED 50 FT BUFFER
- PROJECT PARCEL LINE
- ADJACENT PARCEL LINE
- SEASONAL ROAD
- WATERLINE

CULTIVATION INFORMATION

LIGHT DEPRIVATION (OUTDOOR) CULTIVATION

GH	LENGTH	WIDTH	SQ FT
1	120	X 20	2,400
2	120	X 20	2,400
3	120	X 16	1,920
4	120	X 16	1,920
5	120	X 20	2,400
6	73	X 20	1,460

TOTAL CULTIVATION AREA = 12,500 SQ FT

IMMATURE PLANT AREA

NURSERY	LENGTH	WIDTH	SQ FT
1	61	X 20	1,220

TOTAL IMMATURE AREA = 1,220 SQ FT

CULTIVATION BUILDINGS AND USE

BUILDINGS	USE	SIZE	YEAR
SHOP	IMMATURE PLANT AREA	SEE SPECS	1980
SHIPPING CONTAINER 1	CHEMICAL AG STORAGE/HARVEST STORAGE/ FUEL STORAGE	20'x8'	1980
SHIPPING CONTAINER 2	CHEMICAL AG STORAGE/HARVEST STORAGE/ FUEL STORAGE	20'x8'	UNKNOWN
SHIPPING CONTAINER 3	CHEMICAL AG STORAGE/HARVEST STORAGE/ FUEL STORAGE	20'x8'	2009
GENERATOR SHED	GENERATOR STORAGE	56'x18'	UNKNOWN
CARGO CONTAINER 1	HARVEST STORAGE	40'x8'	2020
CARGO CONTAINER 2	HARVEST STORAGE	40'x8'	2020
CARGO CONTAINER 3	HARVEST STORAGE	40'x8'	2020
CHEMICAL AG STORAGE CONTAINER	CHEMICAL AG STORAGE	20'x8'	2020
HARVEST STORAGE CONTAINER	HARVEST STORAGE	20'x8'	2020

DOMESTIC BUILDINGS AND USE

BUILDINGS	USE	SIZE	YEAR
RESIDENCE	SEASONAL DWELLING	3,986 FT ²	1980

WATER STORAGE AND USE (EXISTING)

TYPE	QUANTITY	GALLONS	TOTAL GALLONS
HDPE TANK	20	5,000	100,000
HDPE TANK	12	550	6,600
HDPE TANK	2	3,000	6,000
BLADDER	1	50,000	50,000

TOTAL AMOUNT OF WATER STORAGE = 162,600 GALLONS

WATER STORAGE AND USE (PROPOSED)

TYPE	QUANTITY	GALLONS	TOTAL GALLONS
HDPE TANK	6	5,000	30,000

TOTAL AMOUNT OF WATER STORAGE = 30,000 GALLONS

WATER SOURCE
 TYPE: WELL 1
 BENEFICIAL USE: CANNABIS & DOMESTIC IRRIGATION

POWER SOURCE
 GENERATOR/SOLAR (ADDITIONAL PROPOSED) / WIND POWER

PLEASE NOTE
 PROCESSING PACKAGING & LABELING WILL OCCUR OFFSITE



PROJECT INFORMATION

PROPERTY OWNER: HAPPY VALLEY FARMS
 ADDRESS: APN: 210-051-081
 SHEET INFO: PARCEL OVERVIEW

REVISIONS

NO	NOTES	DATE
1	REVISION	06-06-23
2	REVISION	06-06-23
3	REVISION	06-06-23
4	REVISION	06-06-23
5	REVISION	06-06-23
6	REVISION	06-06-23

DATE: 6/2/23
 DRAFTER: [Signature]
 SCALE: AS SHOWN

SHEET
C1

4/7/2024 C:\Users\jward\OneDrive\Documents\BCC\0403\051-081-081_Parcel_Overview.dwg 4:54 PM 4/24/24