

ATTACHMENT 2B

Phasing Plan

NOTES:
 1. SEE SHEET 1 FOR GENERAL NOTES
 2. SEE SHEET 6 FOR TYPICAL STREET SECTIONS AND DETAILS
 [Symbol] INDICATED OFF-STREET PARKING FOR LOTS WITH INSUFFICIENT STREET FRONTAGE

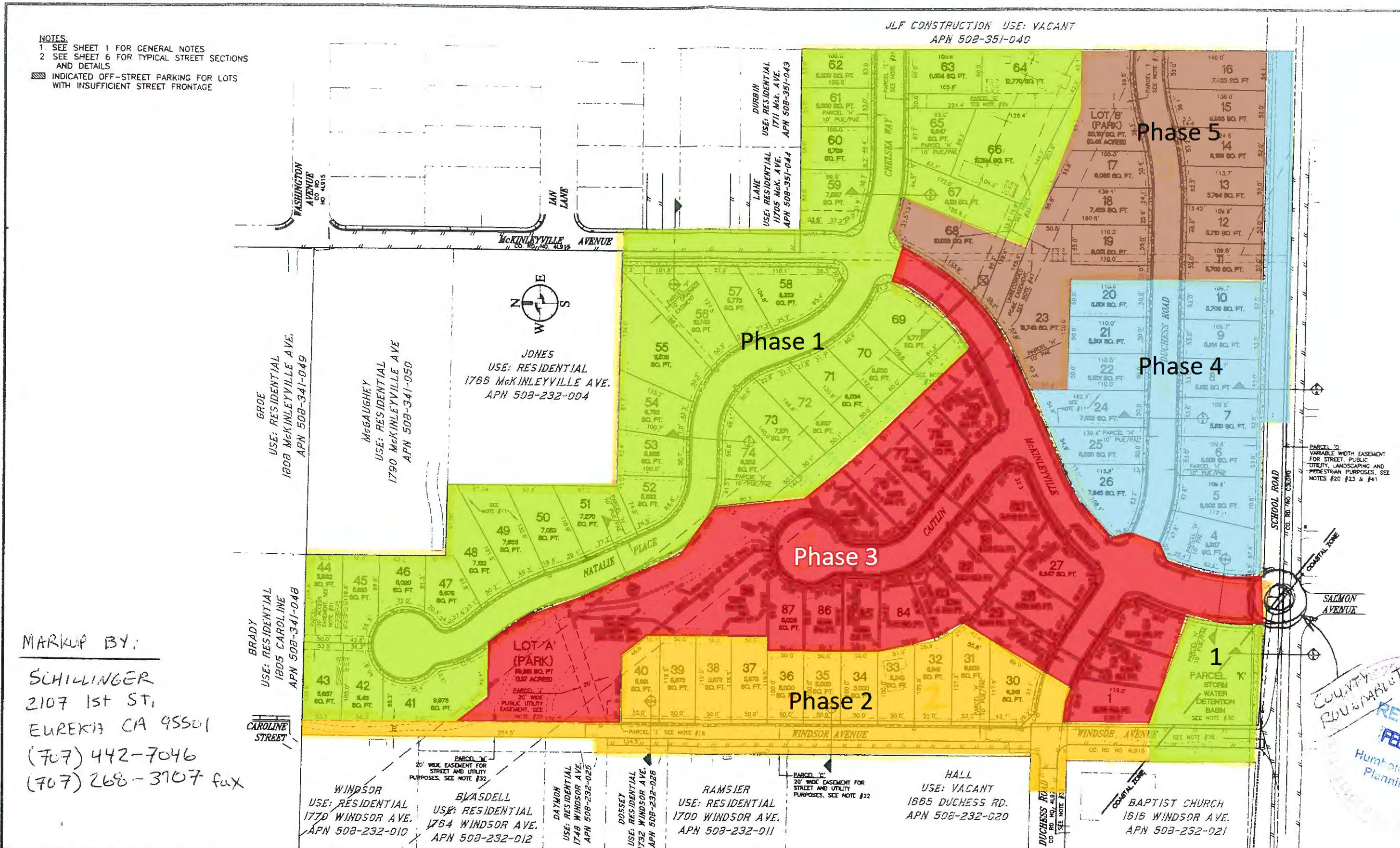

MARKUP BY:
 SCHILLINGER
 2107 1st ST,
 EUREKA CA 95501
 (707) 442-7046
 (707) 268-3107 fax

COUNTY OF HUMBOLDT
 RECEIVED
 FEB 2011
 Humboldt County
 Planning Div

SPENCER ENGINEERING & CONSTRUCTION MANAGEMENT, INC. 1500 NEARWOOD DRIVE, SUITE 770, WINDSORVILLE, LA 70786 TELEPHONE: (707) 442-4356 FAX: (707) 442-4342	Drawn: P. CUTIERRIZ Check: P. CUTIERRIZ Date: T.S. KELLY	PREPARED FOR: DOMINGO & MARY SANTOS	VERSION: 1 DATE: MARCH 7, 2006 DESCRIPTION: TENTATIVE MAP 1, SUBMITTAL	VERSION: 2 DATE: OCTOBER 20, 2006 DESCRIPTION: SECOND SUBMITTAL	VERSION: 3 DATE: MAY 18, 2007 DESCRIPTION: REV. PER REVISED CONDITIONS	SCALE: 1" = 60' 03511.2 TRACT MAP SHEET 3	SITE PLAN - TENTATIVE TRACT MAP SANTOS SUBDIVISION A.P.N. 508-232-003 & 508-351-039 MCKINLEYVILLE, CALIFORNIA
	1/3004/McKinleyville/03511-Santos Subdivision/CAD Project 03511/Map 03511/Tract Map She 3/06p. 1/28/2009 2:10:31 PM						

THIS IS THE PHASING MAP APPROVED
 BY THE PLANNING COMMISSION ON 09/01/2011
 (SEE DPW MEMO DATED 3/21/2011)
 -RUB 10/02/2012