

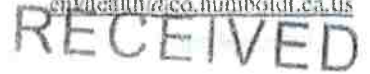

17/18-1912



MAY 23 2018

WATER WELL APPLICATION

CONSTRUCTION – REPAIR – DESTRUCTION

The Well Permit will be returned to the property owner when approved by
Humboldt County Division of Environmental Health (DEH)

HUMBOLDT CO. DIVISION
OF ENVIRONMENTAL HEALTH

Instructions:

1. Complete both sides and submit the Water Well Application with required fee. Include Well Driller's signature and property owner's signature.
2. Work on a well shall not be started prior to approval of the Water Well Application by DEH.
3. Any changes made to the location of a new well shall be approved by DEH prior to commencement of drilling.
4. Well Driller shall notify DEH a minimum of 24 hours prior to sealing the annular space.

Site Address	9320 Wilder Ridge Rd.	APN	108-023-008
City/State/Zip	Garberville, CA 95542	CA	
Directions to Site	Southbound on US-101 (approx. 63 mi.), take exit 642 Redwood Dr., continue on Redwood Dr. (approx. 1.8 mi.), turn right onto Briceland Thorn Rd. (approx. 10 mi.), straight onto Ettensburg Rd. (approx. 5.9 mi.), straight onto Wilder Ridge Rd., site on left		
Applicant	Yordans Peshunov	Contact	
Mailing Address	5145 Black Oak Rd.	Work Phone	
City/State/Zip	Concord, CA 94521	Cell Phone	415-656-6601
Property Owner	Wilder Ridge, LLC	Home Phone	
Mailing Address	403 Rifle Camp Rd.	Work Phone	
City/State/Zip	Woodland Park, NJ 07424	Cell Phone	973-247-1015, 973-454-1455
I hereby grant 'right-of-entry' for inspection purposes			
Drilling		C-57	
Contractor	Watson Well Drilling Inc.	License #	1014048
I hereby agree to comply with all laws and regulations of the County of Humboldt and the State of California Department of Water Resources Bulletin 74 pertaining to water well construction. I will contact Humboldt County Division of Environmental Health (DEH) when I commence work. Within 30 days after completion of work, I will furnish DEH a report of the work performed.			
Well Driller Signature:			
Would driller like a copy of approved application? <input checked="" type="checkbox"/> Yes <input type="checkbox"/> No			
<input type="checkbox"/> U.S. Mail address: _____			
<input checked="" type="checkbox"/> Email address: <u>Admin@watsonwelldrillinginc.com</u>			
Type of Application:	Construction:	Intended Use:	
<input checked="" type="checkbox"/> Construction	Estimated Depth (ft.) _____	<input type="checkbox"/> Domestic - private	
<input type="checkbox"/> Destruction	Diameter (in.) _____	<input type="checkbox"/> Community Supply	
<input checked="" type="checkbox"/> Repair/Modification	Depth of Seal (ft.) _____	<input type="checkbox"/> Irrigation	
	Sealing Material _____	<input checked="" type="checkbox"/> Other <u>50' seal</u> <u>20' seal</u>	



BIG RIVER FARM, LLC. CONDITIONAL USE PERMIT APPLICATION

APN: 108-023-008



PROJECT DESCRIPTION:

THE BIG RIVER FARM, LLC IS PROPOSING TO PERMIT EXISTING MEDICAL CLINIC CLINIC (CIVIC) IN THE COUNTY OF HUMBOLDT COUNTY, CALIFORNIA. THE PROJECT WILL BE USED FOR MEDICAL CLINIC, GENERAL PRACTICE, AND SPECIALTY CARE. THE PROJECT WILL BE USED FOR MEDICAL CLINIC, GENERAL PRACTICE, AND SPECIALTY CARE. THE PROJECT WILL BE USED FOR MEDICAL CLINIC, GENERAL PRACTICE, AND SPECIALTY CARE. THE PROJECT WILL BE USED FOR MEDICAL CLINIC, GENERAL PRACTICE, AND SPECIALTY CARE.

GENERAL NOTES:

- DRAWING SCALE AS NOTED. WRITTEN DIMENSIONS SHALL TAKE PRECEDENCE OVER SCALED DIMENSIONS.
- THIS IS NOT A HIGHWAY SURVEY. BOUNDARY INFORMATION IS BASED ON RECORD DRAWINGS AND FIELD SURVEY DATA DATED 10/15/10. THE BOUNDARY INFORMATION IS NOT TO BE USED FOR ANY OTHER PURPOSE.
- THE PROJECT SITE IS LOCATED WITHIN THE ZONING DISTRICT OF R-1. THE PROJECT SITE IS LOCATED WITHIN THE ZONING DISTRICT OF R-1. THE PROJECT SITE IS LOCATED WITHIN THE ZONING DISTRICT OF R-1.
- THE PROJECT SITE IS LOCATED WITHIN THE ZONING DISTRICT OF R-1. THE PROJECT SITE IS LOCATED WITHIN THE ZONING DISTRICT OF R-1. THE PROJECT SITE IS LOCATED WITHIN THE ZONING DISTRICT OF R-1.

NCRWCB ORDER NUMBER R1-2015-0023
THE SUBJECT PARCEL HAS BEEN ENROLLED IN THE HUMBOLDT COUNTY WATER METERING AND INSPECTION REGISTRATION PROGRAM. MORE NUMBER INFORMATION.

- DIRECTIONS TO SITE:**
FROM EUREKA, CA
-SOUTHBOUND ON US-101 (APPROX. 4.5 MILES)
-TAKE EXIT 642 FOR REDWOOD BR
-CONTINUE ON REDWOOD BR (APPROX. 3.0 MILES)
-TURN RIGHT ONTO BRIGELAND THORN RD (APPROX. 1.0 MILES)
-STAY STRAIGHT ONTO ETTERSBURG RD (APPROX. 5.5 MILES)
-ETTERSBURG RD TURNS INTO WILDER RIDGE RD (APPROX. 3.8 MILES)
-PROJECT SITE ON LEFT

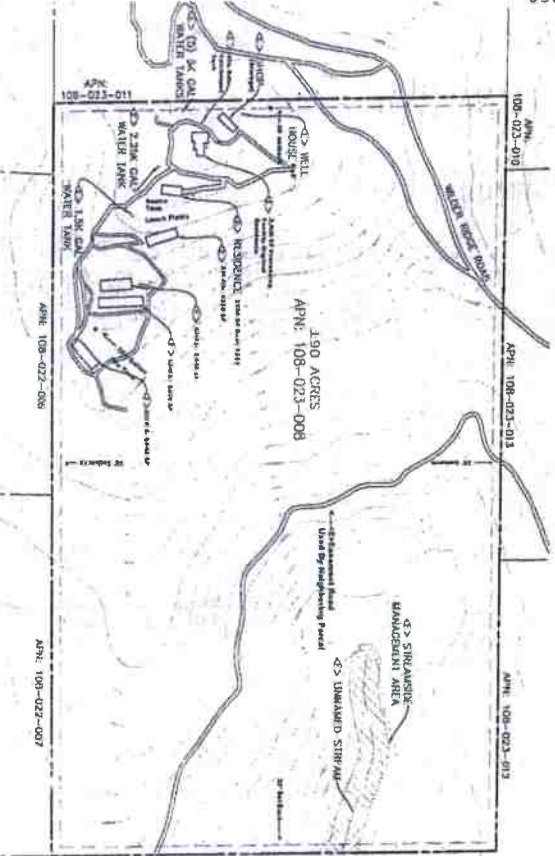

PROJECT INFORMATION:

PROJECT NAME: BIG RIVER FARM, LLC
PROJECT ADDRESS: 403 891E CAMP RD WOODLAND, CA 95694
OWNER: BIG RIVER FARM, LLC
PROJECT NO.: 108-023-008
DATE: 10/15/10

SITE ADDRESS: 403 891E CAMP RD WOODLAND, CA 95694
PROJECT NO.: 108-023-008
DATE: 10/15/10

EXISTING WILDER LIGHT CULIVATION AREA = 27,800 SQ. FT.

WATER: PUBLIC

SEWER: PUBLIC

PROJECT SIZE: 480 ACRES

ZONING: R-1 (RESIDENTIAL SINGLE-FAMILY)

GENERAL PLAN DESIGNATION: R-1 (RESIDENTIAL SINGLE-FAMILY)

EXISTING ZONING: R-1 (RESIDENTIAL SINGLE-FAMILY)

MAX. BLDG. HGT.: 35 FT.

SETBACKS: 10 FT. FRONT, 10 FT. SIDE, 10 FT. REAR

BLDG. SETBACKS: 10 FT. FRONT, 10 FT. SIDE, 10 FT. REAR

BLDG. SETBACKS:	FRONT	SIDE	REAR	SETBACKS:
FRONT	30'	20'	30'	FRONT
SIDE	30'	20'	30'	SIDE
REAR	30'	20'	30'	REAR

SHEET INDEX:

01 - ZONING PLOT PLAN, VICINITY MAP, & PROJECT NOTES

BIG RIVER FARM, LLC / APN: 108-023-008
9320 WILDER RIDGE RD, ETTERSBURG, CA
CUP PLOT PLAN, VICINITY MAP AND PROJECT NOTES

Manhard CONSULTING
1000 S. HUMBOLDT AVENUE, SUITE 100, EUREKA, CA 95501
TEL: 916.443.9333 FAX: 916.443.9334
WWW.MANHARDCONSULTING.COM

NO.	DESCRIPTION	DATE

<u>Estimated Work Dates:</u> Start _____ Completion _____	<u>Casing:</u> Diameter (in.) _____ Material _____	<u>Type of Sewage System:</u> <input type="checkbox"/> Community Sewer <input type="checkbox"/> OWTS (Septic) Distance from well site to OWTS _____
<u>Special Requirements/Comments:</u> _____ _____ _____ _____		
<p>PLOT PLAN</p> <div style="text-align: right; font-size: 2em; margin-top: 100px;">17/18-1912</div>		

FOR OFFICE USE ONLY

Fee: <u>373</u> * Date: <u>5/23/18</u> * Receipt: <u>2134</u> * Project #: _____ Paid by: <u>Watson Well Drilling</u> *	Site Approved by: <u>J. Whittaker</u> Site Approved Date: <u>6/5/18</u> Sealed to Depth of: _____ Seal observed: <input type="checkbox"/> Yes <input type="checkbox"/> No Final Approved Date: _____
---	--

RECEIVED

MAY 23 2018