

BOARD OF SUPERVISORS, COUNTY OF HUMBOLDT, STATE OF CALIFORNIA
Certified copy of portion of proceedings, Meeting of August 25, 2015

RESOLUTION NO. 15-89

**RESOLUTION AUTHORIZING THE HUMBOLDT COUNTY SHERIFF'S OFFICE TO
SUBMIT AN APPLICATION AND PROPOSAL FOR SB 863 CONSTRUCTION OF ADULT
LOCAL CRIMINAL JUSTICE FACILITIES**

WHEREAS, the Humboldt County Board of Supervisors is the approving body to receive the Board of State and Community Corrections (BSCC) funding administered by the State of California; and

WHEREAS, the County of Humboldt has a critical need to expand its jail and other criminal justice facilities and is ready to seek competitive bidding; and

WHEREAS, there is a significant cost to the County of Humboldt to provide a detention facility for those detained by City and County law enforcement entities; and

WHEREAS, Senate Bill 863 appropriates \$500,000,000 in state lease-revenue bond financing authority for acquisition, design and construction, including expansion or renovation, of adult local criminal justice facilities in California; and

WHEREAS, the BSCC, pursuant to the provisions of SB 863, issued a Request for Proposals related to the Construction of Adult Local Criminal Justice Facilities on June 10, 2015; and

WHEREAS, the County of Humboldt will be submitting their Response to the BSCC's Request for Proposals for Construction of Adult Local Criminal Justice Facilities by August 28, 2015; and

WHEREAS, the BSCC's Request for Proposals requires confirmation via a Resolution of the Humboldt County Board of Supervisors of the County's commitment to and provision for taking certain actions and preparations as part of the County's Proposal; and

WHEREAS, the County of Humboldt is willing and able to take the following actions and preparations as part of its Proposal in response to the BSCC's Request for Proposals for Construction of Adult Local Criminal Justice Facilities; and

WHEREAS, receipt of the funding will enhance the ability of Humboldt County to protect the lives and property of the citizens of the County of Humboldt.

NOW, THEREFORE, BE IT RESOLVED AND ORDERED by the Board of Supervisors of the County of Humboldt, State of California that in consideration for significant financial assistance for the Humboldt Community Corrections Reentry Resource Center, the County will or does hereby take the following actions and make the following assurances:

- A. The County of Humboldt is seeking funding for its proposed project within the Adult Local Criminal Justice Facilities Construction Financing Program (the "SB 863 Financing Program"). As such, the Board of Supervisors of Humboldt County does hereby represent, warrant and covenant as follows:



**SENATE BILL 863, ADULT LOCAL
CRIMINAL JUSTICE FACILITIES
CONSTRUCTION FINANCING PROGRAM
PROPOSAL FORM**

This document is not to be reformatted.

SECTION 1: PROJECT INFORMATION

A. APPLICANT INFORMATION AND PROPOSAL TYPE				
COUNTY NAME Humboldt		STATE FINANCING REQUESTED \$ 20,000,000		
SMALL COUNTY (200,000 and UNDER GENERAL COUNTY POPULATION) <input checked="" type="checkbox"/>	MEDIUM COUNTY (200,001 - 700,000 GENERAL COUNTY POPULATION) <input type="checkbox"/>	LARGE COUNTY (700,001 + GENERAL COUNTY POPULATION) <input type="checkbox"/>		
TYPE OF PROPOSAL – INDIVIDUAL COUNTY FACILITY /REGIONAL FACILITY PLEASE CHECK ONE (ONLY):				
INDIVIDUAL COUNTY FACILITY <input checked="" type="checkbox"/>		REGIONAL FACILITY <input type="checkbox"/>		
B: BRIEF PROJECT DESCRIPTION				
FACILITY NAME Humboldt County Correctional Facility (HCCF)				
PROJECT DESCRIPTION Humboldt Community Corrections Reentry Resource Center				
STREET ADDRESS 826 4 th Street				
CITY Eureka		STATE CA	ZIP CODE 95501	
C. SCOPE OF WORK – INDICATE FACILITY TYPE AND CHECK ALL BOXES THAT APPLY.				
FACILITY TYPE (II, III or IV) II	<input checked="" type="checkbox"/> NEW STAND-ALONE FACILITY	<input type="checkbox"/> RENOVATION/ REMODELING	<input type="checkbox"/> CONSTRUCTING BEDS OR OTHER SPACE AT EXISTING FACILITY	
D. BEDS CONSTRUCTED – Provide the number of BSCC-rated beds and non-rated special use beds that will be subject to construction as a result of the project, whether remodel/renovation or new construction.				
	A. MINIMUM SECURITY BEDS	B. MEDIUM SECURITY BEDS	C. MAXIMUM SECURITY BEDS	D. SPECIAL USE BEDS
Number of beds constructed	38			6
TOTAL BEDS (A+B+C+D)	44			

E. APPLICANT'S AGREEMENT

By signing this application, the authorized person assures that: a) the County will abide by the laws, regulations, policies, and procedures governing this financing program; and, b) certifies that the information contained in this proposal form, budget, narrative, and attachments is true and correct to the best of his/her knowledge.

PERSON AUTHORIZED TO SIGN AGREEMENT

NAME Michael Downey

TITLE Sheriff

AUTHORIZED PERSON'S SIGNATURE

DATE

8/25/15

F. DESIGNATED COUNTY CONSTRUCTION ADMINISTRATOR

This person shall be responsible to oversee construction and administer the state/county agreements. (Must be county staff, not a consultant or contractor, and must be identified in the Board of Supervisors' resolution.)

COUNTY CONSTRUCTION ADMINISTRATOR

NAME Tyler Holmes

TITLE Deputy Public Works Director

DEPARTMENT

Facilities Management

TELEPHONE NUMBER

707-445-7491

STREET ADDRESS

1106 2nd Street

CITY

Eureka

STATE

CA

ZIP CODE

95501

E-MAIL ADDRESS

tholmes@co.humboldt.ca.us

G. DESIGNATED PROJECT FINANCIAL OFFICER

This person is responsible for all financial and accounting project related activities. (Must be county staff, not a consultant or contractor, and must be identified in the Board of Supervisors' resolution.)

PROJECT FINANCIAL OFFICER

NAME Josielyn Gilbaugh

TITLE Deputy Public Works Director

DEPARTMENT

General Services

TELEPHONE NUMBER

707-445-7491

STREET ADDRESS

1106 2nd Street

CITY

Eureka

STATE

CA

ZIP CODE

95501

E-MAIL ADDRESS

Jgilbaugh@co.humboldt.ca.us

H. DESIGNATED PROJECT CONTACT PERSON

This person is responsible for project coordination and day-to-day liaison work with the BSCC. (Must be county staff, not a consultant or contractor, and must be identified in the Board of Supervisors' resolution.)

PROJECT CONTACT PERSON

NAME Ed Wilkinson

TITLE Captain

DEPARTMENT

Humboldt County Sheriff's Office

TELEPHONE NUMBER

707-441-5100

STREET ADDRESS

826 4th Street

CITY

Eureka

STATE

CA

ZIP CODE

95501

E-MAIL ADDRESS

ewilkinson@co.humboldt.ca.us

E. APPLICANT'S AGREEMENT

By signing this application, the authorized person assures that: a) the County will abide by the laws, regulations, policies, and procedures governing this financing program; and, b) certifies that the information contained in this proposal form, budget, narrative, and attachments is true and correct to the best of his/her knowledge.

PERSON AUTHORIZED TO SIGN AGREEMENT

NAME Michael Downey TITLE Sheriff

AUTHORIZED PERSON'S SIGNATURE DATE
 8/25/15

F. DESIGNATED COUNTY CONSTRUCTION ADMINISTRATOR

This person shall be responsible to oversee construction and administer the state/county agreements. (Must be county staff, not a consultant or contractor, and must be identified in the Board of Supervisors' resolution.)

COUNTY CONSTRUCTION ADMINISTRATOR

NAME Tyler Holmes TITLE Deputy Public Works Director

DEPARTMENT TELEPHONE NUMBER
Facilities Management 707-445-7491

STREET ADDRESS
1106 2nd Street

CITY STATE ZIP CODE E-MAIL ADDRESS
Eureka CA 95501 tholmes@co.humboldt.ca.us

G. DESIGNATED PROJECT FINANCIAL OFFICER

This person is responsible for all financial and accounting project related activities. (Must be county staff, not a consultant or contractor, and must be identified in the Board of Supervisors' resolution.)

PROJECT FINANCIAL OFFICER

NAME Josielyn Gilbaugh TITLE Deputy Public Works Director

DEPARTMENT TELEPHONE NUMBER
General Services 707-445-7491

STREET ADDRESS
1106 2nd Street

CITY STATE ZIP CODE E-MAIL ADDRESS
Eureka CA 95501 Jgilbaugh@co.humboldt.ca.us

H. DESIGNATED PROJECT CONTACT PERSON

This person is responsible for project coordination and day-to-day liaison work with the BSCC. (Must be county staff, not a consultant or contractor, and must be identified in the Board of Supervisors' resolution.)

PROJECT CONTACT PERSON

NAME Ed Wilkinson TITLE Captain

DEPARTMENT TELEPHONE NUMBER
Humboldt County Sheriff's Office 707-441-5100

STREET ADDRESS
826 4th Street

CITY STATE ZIP CODE E-MAIL ADDRESS
Eureka CA 95501 ewilkinson@co.humboldt.ca.us

Humboldt County

Board of State and Community Corrections
SB 863 Adult Local Criminal Justice Facilities
Construction Program

Humboldt Community Corrections
Reentry Resource Center

August 28, 2015



Humboldt County Correctional Facility (HCCF), 826 4th Street, Eureka, CA



Submitted by:
Humboldt County Sheriff's Office
Jail Custody Division
Eureka, CA

SECTION 2: BUDGET SUMMARY

Budget Summary Instructions

Definitions of total project costs for purposes of this program (state reimbursed, county cash contribution, and county in-kind contribution) can be found in the “Budget Considerations” page 22 of the Senate Bill (SB) 863, Construction of Adult Local Criminal Justice Facilities (ALCJF’s) Request for Proposals (RFP). The county cash and in-kind contributions are collectively the county contribution. Those defined costs in the RFP shall be the guide for accurately completing this budget summary section.

In the Budget Summary Table that follows in part D of this section, indicate the amount of state financing requested and the amount of cash and/or in-kind contributions allotted to each budget line-item, in total defining the total project costs. It is necessary to fully include each eligible project cost for state-reimbursed, county cash, and county in-kind contribution amounts.

The in-kind contribution line items represent only county staff salaries and benefits, needs assessment costs, transition planning costs and/or current fair market value of land. An appraisal of land value will only be required after conditional award and only if land value is included as part of the county’s contribution.

The total amount of state financing requested cannot exceed 90 percent of the total project costs. The county contribution must be a minimum of 10 percent of the total project costs (unless the applicant is a small county petitioning for a reduction in the county contribution amount). County contributions can be any combination of cash or in-kind project costs. Small counties requesting a reduction in county contribution must state so in part A of this section. The County contribution must include all costs directly related to the project necessary to complete the design and construction of the proposed project, except for those eligible costs for which state reimbursement is being requested.

State financing limits (maximums) for all county proposals are as follows. For proposed regional ALCJF’s, the size of the lead county determines the maximum amount of funds to be requested for the entire project:

- **\$80,000,000** for large counties;
- **\$40,000,000** for medium counties; and,
- **\$20,000,000** for small counties.

A. Under 200,000 Population County Petition for Reduction in Contribution

Counties with a population below 200,000 may petition the Board of State and Community Corrections (BSCC) for a reduction in its county contribution. This proposal document will serve as the petition and the BSCC Board's acceptance of the county's contribution reduction, provided the county abides by all terms and conditions of this SB 863 RFP and Proposal process and receives a conditional award. The county (below 200,000 population) may request to reduce the required match to an amount not less than the total non-state reimbursable projects cost as defined in Title 15, Division 1, Chapter 1, Subchapter 6, Construction Financing Program section 1712.3. If requesting a reduction in match contribution, check the box below to indicate the county's petition.

By checking this box the county hereby petitions for a contribution reduction request as reflected in the proposal budget.

B. Readiness to Proceed Preference

In order to attest that the county is seeking the readiness to proceed with the proposed project, the county included a Board of Supervisors' resolution doing the following: 1) identifying and authorizing an adequate amount of available matching funds to satisfy the counties' contribution, 2) approving the forms of the project documents deemed necessary, as identified by the board to the BSCC, to effectuate the financing authorized in SB 863 3) and authorizing the appropriate signatory or signatories to execute those documents at the appropriate times. The identified matching funds in the resolution shall be compatible with the state's lease revenue bond financing. Additionally see Section 6 "Board of Supervisors' Resolution" for further instructions.

This proposal includes a Board of Supervisors' Resolution that is attached and includes language that assures funding is available and compatible with state's lease revenue bond financing. See below for the description of compatible funds.

County Cash Contribution Funds Are Legal and Authorized. The payment of the county cash contribution funds for the proposed adult local criminal justice facility project (i) is within the power, legal right, and authority of the County; (ii) is legal and will not conflict with or constitute on the part of the County a material violation of, a material breach of, a material default under, or result in the creation or imposition of any lien, charge, restriction, or encumbrance upon any property of the County under the provisions of any charter instrument, bylaw, indenture, mortgage, deed of trust, pledge, note, lease, loan, installment sale agreement, contract, or other material agreement or instrument to which the County is a party or by which the County or its properties or funds are otherwise subject or bound, decree, or demand of any court or governmental agency or body having jurisdiction over the County or any of its activities, properties or funds; and (iii) have been duly authorized by all necessary and appropriate action on the part of the governing body of the County.

No Prior Pledge. The county cash contribution funds and the Project are not and will not be mortgaged, pledged, or hypothecated by the County in any manner or for any purpose and have not been and will not be the subject of a grant of a security interest by the County. In addition, the county cash contribution funds and the

Project are not and will not be mortgaged, pledged, or hypothecated for the benefit of the County or its creditors in any manner or for any purpose and have not been and will not be the subject of a grant of a security interest in favor of the County or its creditors. The County shall not in any manner impair, impede or challenge the security, rights and benefits of the owners of any lease-revenue bonds sold by the State Public Works Board for the Project (the "Bonds") or the trustee for the Bonds.

Authorization to Proceed with the Project. The Project proposed in the County's SB 863 Financing Program proposal is authorized to proceed in its entirety when and if state financing is awarded for the Project within the SB 863 Financing Program.

C. California Environmental Quality Act (CEQA) compliance

Has the county completed the CEQA compliance for the project site?

Yes. If so, include documentation evidencing the completion (preference points).

Refer to the final Notice of Determination and letter from Humboldt County Counsel certifying the associated statute of limitations has expired and no challenges were filed.

No. If no, describe the status of the CEQA certification.

D. Budget Summary Table (Report to Nearest \$1,000)

LINE ITEM	STATE REIMBURSED	CASH CONTRIBUTION	IN-KIND CONTRIBUTION	TOTAL
1. Construction	\$ 17,133,000	\$		\$17,133,000
2. Additional Eligible Costs*	\$ 1,099,000	\$		\$1,099,000
3. Architectural	\$ 1,768,000	\$ 117,000		\$ 1,885,000
4. Project/Construction Management	\$	\$514,000		\$ 514,000
5. CEQA	\$	\$ 89,000		\$89,000
6. State Agency Fees**	\$	\$ 91,000		\$ 91,000
7. Audit		\$10,000	\$	\$ 10,000
8. Needs Assessment		\$39,000	\$	\$ 39,000
9. Transition Planning		\$	\$ 300,000	\$ 300,000
10. County Administration			\$ 62,000	\$62,000
11. Land Value			\$325,000	\$ 325,000
TOTAL PROJECT COSTS	\$ 20,000,000	\$ 860,000	\$687,000	\$21,547,000
PERCENT OF TOTAL	92.8%	4.0%	3.2%	100.00 %

* Additional Eligible Costs: This line item is limited to specified fees and moveable equipment and moveable furnishings (eligible for state reimbursement or cash contribution), and public art (eligible for cash contribution only)

** For State Agency Fees: State reimbursable costs include Real Estate Due Diligence only. State Fire Marshal fees may only be claimed as cash match.

Provide an explanation below of how the dollar figures were determined for each of the budget categories above that contain dollar amounts. Every cash contribution (match) line item shall be included with a reporting of the full amount budgeted unless a line item is not an actual cash contribution project cost for the county. (In that case, indicate so below.) For each budget category explanation below, include how state financing and the county contribution dollar amounts have been determined and calculated (be specific).

1. **Construction (includes fixed equipment and furnishings) (state reimbursement/cash match):** \$17,133,000 represents construction bid costs. The construction cost was prepared by a professional cost estimator and included escalation costs as prescribed by the State.
2. **Additional Eligible Costs (specified allowable fees, moveable equipment and furnishings, and public art)**
 - a) **Define each allowable fee types and the cost of each:** Plan Check: \$65,000; Special Testing/Geotech: \$90,000; Commissioning: \$50,000; Fees and Permits: \$170,000.

- b) **Moveable equipment and moveable furnishings total amount:** \$724,000.
- c) **Public art total amount:** \$0

3. Architectural(state reimbursement/cash match):

- a) **Describe the county's current stage in the architectural process:** The County has completed conceptual designs and programming to respond to the program space and bed needs identified in the 2015 Needs Assessment Update. If awarded, the County will proceed with schematic designs utilizing the cash contribution allocated for architectural.
- b) **Given the approval requirements of the State Public Works Board (SPWB) and associated state reimbursement parameters (see "State Lease Revenue Bond Financing" section in the RFP), define which portions/phases of the architectural services the county intends to seek state dollar reimbursement:** The County will be seeking reimbursement of architectural/engineering (A/E) services and fees beginning after the project is established by the SPWB.
- c) **Define the budgeted amount for what is described in b) above:** A/E Fees: \$1,885,000; (State Reimbursed: \$1,768,000; Cash Contribution: \$117,000).
- d) **Define which portion/phases of the architectural services the county intends to cover with county contribution dollars:** Validate programming, prepare schematic design and outline specifications, and site adapt building.

Define the budgeted amount for what is described in d) above: Validate programming: \$15,000; schematic design, site adapt, and outline specifications: \$102,000.

- 4. **Project/Construction Management - Describe which portions/phases of the construction management services the county intends to claim as:**
 - a) **Cash** \$514,000
 - b) **In-Kind**
- 5. **CEQA – may be state reimbursement (consultant or contractor) or cash match** \$89,000 (Cash Match).
- 6. **State Agency Fees – Counties should consider approximate costs for the SFM review which may be county cash contribution (match). \$16,000 for the due diligence costs which may be county cash contribution (match) or state reimbursement. \$16,000 for due diligence cost (Cash Match); \$75,000 State Fire Marshal (Cash Match).**
- 7. **Audit of Grant - Define whether the county is intending to use independent county auditor (in-kind) or services of contracted auditor (cash) and amount budgeted:** County will employ an independent auditor, \$10,000 (Cash Match).
- 8. **Needs Assessment - Define work performed by county staff (in-kind), define hired contracted staff services specifically for the development of the needs assessment (cash match) :** \$39,000 prepared by professional consultant for this SB 863 Project (Cash Match).

9. **Transition Planning – Define work performed by county staff (in-kind), define the staff hired specifically for the proposed project (cash match):** \$300,000 In-Kind for salaries and benefits for Sheriff's team members to lead the facility design needs, monitor construction for security risks, prepare policies and procedures, conduct facility systems training, conduct operational training for staff, stage phase occupancy of the building.
10. **County Administration – Define the county staff salaries/benefits directly associated with the proposed project.** \$62,000 for salaries and benefits to administer the contract from award to project closeout.
11. **Site Acquisition - Describe the cost or current fair market value (in-kind):** \$325,000 (In-Kind) for County-owned vacant property adjacent to the County Jail and Courthouse. Appraisal prepared by Nilsen Appraisal Services.

SECTION 3: PROJECT TIMETABLE

Prior to completing this timetable, the county must consult with all appropriate county staff (e.g., county counsel, general services, public works, county administrator) to ensure that dates are achievable. Please consult the “State Public Works Board (State Capital Outlay Process)/Board of State and Community Corrections Processes and Requirements” section, page 30 of the RFP for further information. Complete the table below indicating start and completion dates for each key event, including comments if desired. Note the required time frames for specific milestone activities in this process. The BSCC Board intends to make conditional awards at its November 2015 board meeting.

KEY EVENTS	START DATES	COMPLETION DATES	COMMENTS
Site assurance/comparable long-term possession <u>within 90 days of award</u>	11/12/2015	10 2/12/2016	County Owned Property
Real estate due diligence package submitted <u>within 120 days of award</u>	11/12/2015	3/1/2016	
SPWB meeting – Project established <u>within 18 months of award</u>	11/12/2015	3/15/2016	
Schematic Design with Operational Program Statement <u>within 24 months of award</u> (design-bid-build projects)	1/1/2016	3/30/2016	
Performance criteria with Operational Program Statement <u>within 30 months of award</u> (design-build projects)			
Design Development (preliminary drawings) with Staffing Plan	4/18/2016	5/10/2016	
Staffing/Operating Cost Analysis approved by the Board of Supervisors	1/1/2016	2/28/2016	
Construction Documents (working drawings)	5/15/2016	8/1/2016	
Construction Bids or Design-Build Solicitation	8/9/2016	9/20/2016	
Notice to Proceed <u>within 42 months of award</u>	10/15/2016	10/15/2016	
Construction (maximum three years to complete)	11/15/2016	6/15/2018	
Staffing/Occupancy <u>within 90 days of completion</u>	6/15/2018	9/14/2018	9-13 of 2015/1

SECTION 4: FACT SHEET

To capture key information from Section 5: Narrative, applicants must complete this Fact Sheet. Minimal information is requested. Narrative information or explanations are not to be included on this Fact Sheet nor as part of the tables in this section. Explanations of what is provided in these tables may be included in the Narrative section of the Proposal Form. Proposal narratives may include reference back to one or more of these specific tables (e.g., refer to Table 4 in Section 4 Fact Sheet).

Table 1: Provide the following information

1.	County general population	136,779
2.	Number of detention facilities	1
3.	BSCC-rated capacity of jail system (multiple facilities)	417
4.	ADP (Secure Detention) of system	349
5.	ADP (Alternatives to Detention) of system	266
6.	Percentage felony inmates of system	90.0%
7.	Percentage non-sentenced inmates of system	60.7%
8.	Arrests per month	669
9.	Bookings per month of system	837
10.	"Lack of Space" releases per month	76

*Covers calendar year 2014

Table 2: Provide the name, BSCC-rated capacity (RC) and ADP of the adult detention facilities (type II, III, and IV) in your jurisdiction (county)

	Facility Name	RC	ADP*
1.	Humboldt County Correctional Facility (Type II)	417	349
2.			
3.			
4.			
5.			
6.			
7.			
8.			

*Average daily population for 2014.

Table 3: List the current offender programming in place and the ADP in each program

Pre-Trial Program		ADP
1.	Educational/GED	3
2.	Framework For Recovery	3
3.	Spirit of Freedom	2
4.	Narcotics Anonymous	6
5.	Alcoholics Anonymous	6
6.	Celebrate Recovery	3
Sentences Offender Program		ADP
1.	Educational/GED	15
2.	Seeking Safety (Substance Abuse)	13
3.	Getting Started With Computers	15
4.	High School Equivalency Test Preparation	15
5.	Anger Management	15
6.	Ready, Set, Go to College!	10

Table 4: List of the offender assessments used for determining programming

Assessment tools		Assessments per Month
1.	Static Risk Assessment (STR 2.0, Part of STRONG)	15
2.	Offender Needs Guide	20
3.	In-House Sheriff's Work Alternative Program Assessment	47
4.		
5.		
6.		

1. STATEMENT OF NEED

What are the safety, efficiency, and offender programming and/or treatment needs addressed by this construction proposal? Please cite findings from the needs assessment (through 2019) submitted with this proposal.

Summary Overview

The County's 2015 Needs Assessment Update has identified several space needs Humboldt County should immediately consider and use to request SB 863 funding to help the Sheriff's Office correct the deficiencies. The consultants specifically identified a need to develop (1) mental health treatment beds and staff support space that is devoted to support functions and service activities for HCCF's mental health and substance abuse clinical staff assigned to the facility, and (2) construct a reentry housing unit with adjacent program space which would be used for implementing a new Jail transitional reentry program for both male and female inmates about to transfer back to the community after being incarcerated in the County Jail. With the shift which has occurred under the AB 109 Realignment Act which is bringing multi-year sentenced felony inmates to County Jail, additional specialized reentry housing with multiple programs / support spaces would provide a greater degree of flexibility in being able to assist offenders with employment, housing, drug use, or other problems who are about to be transitioned from HCCF to the community. This reentry housing would provide a "step down" short-term, highly structured and service focused custody environment for this population of detainees and could also make available these services across the various inmate security classifications. Correcting these space deficiencies clearly aligns with the legislature's approach and intent in SB

863 and expectations for how counties should handle and process the AB 109 Realignment inmates and other high-risk offender populations. The SB 863 funding would be the first State lease revenue bond financing the Sheriff's Office has received under the State's Adult Local Criminal Justice Facilities Construction Program.

Humboldt County Jail System

The Humboldt County Sheriff's Office operates the County's only Type II jail facility located in downtown Eureka. The jail (Humboldt County Correctional Facility) was built in two phases, in 1996 and 1997. The Main Jail has a Board of State and Community Corrections (BSCC) rated capacity for 417 inmates. Since October 2011, the jail houses AB 109 Public Safety Realignment Act County Jail Prison (N3), 3056 PC parolees, Post-Release Community Supervision (PRCS) offenders, and flash incarceration Probation Department offenders.

The jail is the central booking point for all regional law enforcement agencies for adult males and females arrested in Humboldt County. The jail is a full service adult detention facility containing space for (a) vehicle sallyport, (b) intake and release, (c) inmate housing and dayrooms, (d) visiting, (e) medical / mental health services, (f) inmate programs, (g) food services, (h) laundry, (i) visitor and staff circulation, (j) Central Control operations, (k) maintenance and storage, (l) outdoor recreation, and (m) jail administration. The Humboldt County Correctional Facility (HCCF) consists of both cells and dormitory housing settings. In 2014, HCCF had an average daily population of 349 pretrial and sentenced inmates.

Humboldt County Correctional Facility (HCCF)	
Correctional Facility Profile	Correctional Facility
Physical Plant Characteristics:	
Year Initially Constructed Phase I	1996
Construction Type	Mid-rise Building
Number of Stories	4
Exterior Walls	CMU / Concrete
Interior Walls	CMU / Concrete / Gypsum
Year Initially Constructed Phase II	1997
Construction Type	High-rise Building
Number of Stories	6
Exterior Walls	CMU / Concrete
Interior Walls	CMU / Concrete / Gypsum
Custody Housing Classifications:	Maximum / Medium / Minimum Security
Type of Inmate Cells:	Single & Double Occupancy Cells and Dormitory Units
Bed Inventory:	
BSCC Rated Capacity	417
Operating Capacity (80% of rated bunks)	334
Average Daily Inmate Population (ADP):	349 (2014)
Males	301
Females	48

Humboldt County has taken significant steps to maximize use of recognized pretrial and post-sentence alternatives to incarceration programs and innovative case processing practices in an effort to avoid detention system overcrowding. The Sheriff's Office has developed three major alternatives to incarceration programs and early release protocols for incarcerated inmates. The programs are being implemented in response to the impact the AB 109 Realignment legislation is having on the County's only jail facility. The three alternative programs being stressed include (1) *Jail Citation Release*, (2) *Sheriff's Work Alternative Program (SWAP)*, and (3) *Probation/Sheriff Pretrial OR and Supervised Release (with GPS Monitoring)*.

The expanded use of citation release allows misdemeanants to remain in the community, and eliminates an unnecessary burden on the jail. Low- and medium-risk

sentenced offenders (including AB 109 inmates) who are incarcerated have the ability to complete their sentence through the SWAP Program regardless of the length of confinement time. The Probation/Sheriff's Pretrial OR and Supervised Release Program allows local incarcerated offenders to participate in the GPS electronically monitored (EM) alternative to incarceration program. The Pretrial/OR Program consists of a whole range of options, from no EM and a Court date reminder call all the way to very restrictive GPS – all based on risk level to reoffend/FTA per the ORAS-PAT tool. Additionally, Probation utilizes EM/GPS as an intermediate sanction in lieu of jail booking on technical violations to reserve jail space for the highest risk offenders. The program is considered a constructive custody alternative. Participants are accountable for all of their time 24-hours a day, seven-days-a-week and may only leave their residence for work, school, and other pre-approved appointments.

In addition, the local justice system has implemented intensive supervision programs and Probation Day Reporting Center (DRC) which has been designed around national best practice research. All of these program modifications have allowed qualified offenders to fulfill their sentences without occupying jail beds. The Probation Department has also adopted the practice of recommending split sentences for AB 109 offenders under Section 1170(h) of the Penal Code as often as possible, which further reduces the need for long-term bed space in the County Jail which allows offenders to spend a significant portion of their custodial time out in the community. Probation also utilizes flash incarceration to ensure continued compliance with probation terms. Since flash incarceration is limited to a maximum of ten days in the jail, this program operates as an alternative to incarceration by providing a graduated intermediate sanction

process to encourage compliance rather than simply rebooking offenders who are failing probation into the jail to serve the remainder of their terms. *Through these alternatives to incarceration programs and population management policies, the Sheriff's Office and Humboldt County's criminal justice system have been able to avoid overcrowding in HCCF.*

Jail Needs Assessment Update Findings

Based on their physical plant assessment and operational evaluation, the Needs Assessment consultant team has shown that the HCCF facility has some important and critical needs with respect to custody beds and program services support space. The major space deficiencies include:

1. Mental Health Staff Support Space – HCCF does have a small area that is devoted to staff support functions and related service activities for the Jail's Department of Health and Human Services (DHHS) mental health and alcohol / drug clinical staff assigned to the detention facility. The current space and area configuration barely meets the current needs of the staff who work in this area. As the AB 109 longer term sentenced offender population continues to be housed in the facility, mental health and substance abuse service requests have increased. As DHHS and the Jail bring on additional staff and other personnel to provide these types of services and any expanded programming at the facility, the space these support staff currently occupy will increasingly become more inadequate.
2. Jail Community Reentry Housing Unit – With changing inmate populations involving longer term sentenced AB 109 Realignment offenders being housed

in HCCF and in light of the local criminal justice system's clear commitment to expand evidence-based treatment programs, the Jail has a new and high priority need for a small number of different custody beds with dedicated program space. Specifically, the facility lacks any housing and adjacent program space which could be used for implementing a transitional reentry housing unit for male and female inmates about to be released from jail.

The only transitional housing currently available in HCCF involves one small dormitory of outside inmate workers which is located inside the Jail's secured perimeter. These workers complete community work assignments six days a week and return to the Jail as part of the Sheriff's Cal-Trans Program. The location of the dormitory creates a continual problem for contraband trafficking into the facility. In order for the Jail to expand the community transitional process for more inmates and be able to offer a structured "best practice" assessments and supportive reentry service programming - more counseling, education, and other adjacent program space is needed.

Best practices suggest that reentry services should begin when someone is still in jail and continue when they return to the community. Currently, the AB 109 incarcerated inmate population and other local inmates will leave the Jail facility with little or no follow-up assistance. Most need assistance with employment, housing, drug use, or other problems before they were booked into the Jail and most still have service needs when released from detention. Implementation of a Jail Reentry Services Program

must take place simultaneously with the development, expansion, and implementation of in-custody cognitive behavioral counseling, drug treatment, and employment preparation assistance services.

3. Mental Health Treatment Beds – With the implementation of the AB 109 legislation, HCCF has a critical need to add specialized mental health treatment beds for incarcerated offenders with serious psychiatric disorders. Currently, HCCF has an average daily population on the last day of each month of 152 inmates being seen by the facility’s clinical staff as a open mental health case. On the average, mental health staff assigned to the jail are opening 79 new cases each month and an average of 67 inmates are receiving psychotropic medications on the last day of each month.

Humboldt County Correctional Facility (HCCF) Average Monthly Number of Jail Inmates Receiving Mental Health Services 2012 - 2014				
Mental Health Services	2012	2013	2014	2012-14
Number of Mental Health cases open on last day of month	115	162	178	152
Number of new Mental Health cases opened during month	95	85	57	79
Number of inmates receiving psychotropic medications on last day of month	67	74	59	67

HumboldtNA2015/Tables&Chits/Table17

With nearly half of the jail’s pretrial and sentenced inmate population receiving mental health screenings, crisis counseling services, or psychotropic medications, the detention facility has a significant need for dedicated mental health treatment beds for inmates showing more serious

psychiatric disorders. Such beds would allow the mental health clinicians to better monitor, observe, and interact at a higher level compared to what currently takes place in the facility because of the lack of mental health treatment beds and specialized programming and support areas.

Areas to be Improved With SB 863 Proposed Construction Project

Based on the Needs Assessment Update work, the consultant team recommended that because all of these needs clearly meet the funding criteria contained in SB 863, the Sheriff's Office make application to the BSCC for construction funding to help the County address these critical space needs in its jail detention system. The consultants, along with HCCF staff, believe these changes at the County Jail would improve the secure operations and conditions at the facility and provide a greater and more comprehensive array of available programming for local incarcerated inmates. Other improvements the SB 863 construction project will make include the following:

- Sheriff's Reentry / Mental Health Treatment Housing and Inmate Program Space – Operationally, the proposed Community Corrections Reentry Resource Center will allow the Humboldt County criminal justice system to consolidate the community's limited, but essential, mental health, drug counseling, employment assistance, life skills, and other important resources for assisting offenders into one primary prominent downtown location. This will bring about a more cost-effective and efficient use of these types of important resources for the Sheriff, Probation Department, and the Courts. The space will also allow for expanded growth and integration of other "best

practices” services at this site. By co-locating the core justice agencies and offender service programs together as the project will accomplish, there will be even greater opportunity to supervise offenders and address pressing problems including substance abuse, transitional housing, benefit eligibility assistance, transportation, and employment preparation needs of both local probationers, AB 109 in-custody inmates, and out-of-custody offenders.

The reentry custody beds will work for both pretrial and sentenced inmates who can benefit from “step down” reentry assessments and services in preparation for returning to the community. The reentry transitional housing component will provide offenders with skills and resources necessary to make the transition from an institutional setting to independent and responsible living in the community. The adjacent new programming space will allow the Sheriff’s Office to also begin providing a wide range of evidence-based programs and life skills assistance for inmates acclimating to the community prior to release.

- Humboldt County Department of Health and Human Services Mental Health Suite – The construction project will also add a mental health treatment housing unit with staff support space and program area. These beds will allow DHHS mental health clinicians and substance abuse counselors to better monitor, observe, and interact at a higher level compared to what currently takes place in the facility because of the lack of mental health treatment beds and specialized programming and support areas. The mental health function included within the Center will supplement and replace

portions of the existing areas at the adjacent County Jail. The current mental health area at the Jail is extremely undersized to serve the current population. The adjacency of the new mental health treatment unit provides the opportunity for provider staff to serve both facilities.

- Humboldt County Probation Day Reporting Center (DRC) - The Probation Department's Day Reporting Center, currently located in an older leased facility in downtown Eureka, will be moved into the new building. The Day Reporting Center currently supervises the Department's high-risk PRCS and local probationer populations. The Probation Department works with DHHS in providing needed mental health and substance abuse assessments, counseling services, and other related programming for these offender groups. DHHS staff also are responsible for providing employment assistance and job placement services to these local offenders. The conceptual design for the Center provides a variety of spaces to accommodate the various agencies and functions collaborating with the DRC with the flexibility required to carry out current and future offender supervision and programmatic needs. The DRC will be located on the site where probationers and the public have clearly identified access and distinct separation from any secure portions of the new building. There are primarily two distinct functional areas the Center provides for the DRC including an administrative staff area and program areas for supervision activities, treatment, and intervention services to be carried out.

- Sheriff's Office's Alternatives to Incarceration Programs - The Sheriff's Office's SWAP Program will also have the ability to expand programming and needed services to their out-of-custody offenders participating in the alternative work program. The Reentry Resource Center will serve these out-of-custody offenders from this same location.

The project also accommodates secure staff parking, reduces traffic and deliveries to the Main Jail, and more clearly defines the public and secure areas surrounding the jail site. This will simplify the overall management and security of site-related issues. Utilizing the SB 863 funding source to co-locate and construct the Probation Day Reporting Center and Sheriff's Department's Work Release Program and other alternatives to incarceration will improve program completion rates and generally enhance public safety.

2. SCOPE OF WORK

Describe the areas, if any, of the current facility to be replaced or renovated, and the nature of the renovation, including the number of cells, offices, classrooms or other programming / treatment spaces to be replaced or added and the basic design of the new or renovated units.

Summary Overview

With SB 863 funding, the County will be able to construct a new, stand-alone Community Corrections Resource Center at the North end of HCCF. The Reentry Resource Center will serve both in-custody and alternative custody male and female offenders supervised in the community. The multi-functional Center would co-locate the Sheriff's Office's Jail alternative programs, the Probation Department's Day Reporting Center, and Department of Health and Human Services (DHHS) Behavioral Health clinical mental health and substance abuse

counseling staff. The facility would include a new 38-bed community transitional reentry inmate housing unit with expanded dedicated programming spaces specifically arranged to accommodate evidence-based service programming. The Center would also include a dedicated six-bed mental health treatment housing unit with adjacent program space and support areas for counselors assigned to the new unit for a 44-bed total. Construction of the Center will fulfill a critical need of the County's criminal justice system and provide a safe, highly-structured and service-focused environment where offenders of all security classifications can receive services and participate in expanded mental health, education, drug counseling, life skills development, and inmate reentry services / programming space.

Scope of Project Construction

The Humboldt County Community Corrections Reentry Resource Center Project is a 23,712 SF multi-purpose facility that will accommodate a variety of functional uses. Although the facility will be located adjacent to HCCF (see site plan on following page) and primarily operated by the Sheriff's Office, overall management of the new Center is a collaborative partnership with Probation, DHHS, contracted services providers, and the Courts. The conceptual design provides the spaces to accommodate the various agencies and functions with the flexibility to address current and future offender program/service needs.

The building will consist of two stories. The first floor will respond primarily to out-of-custody offenders and will contain public areas, shared reception, toilet rooms, elevator, conference rooms, officer's work stations, classrooms, group rooms, storage,

janitor's closet, electrical room, IT space, break room, interview rooms, and circulation corridors.

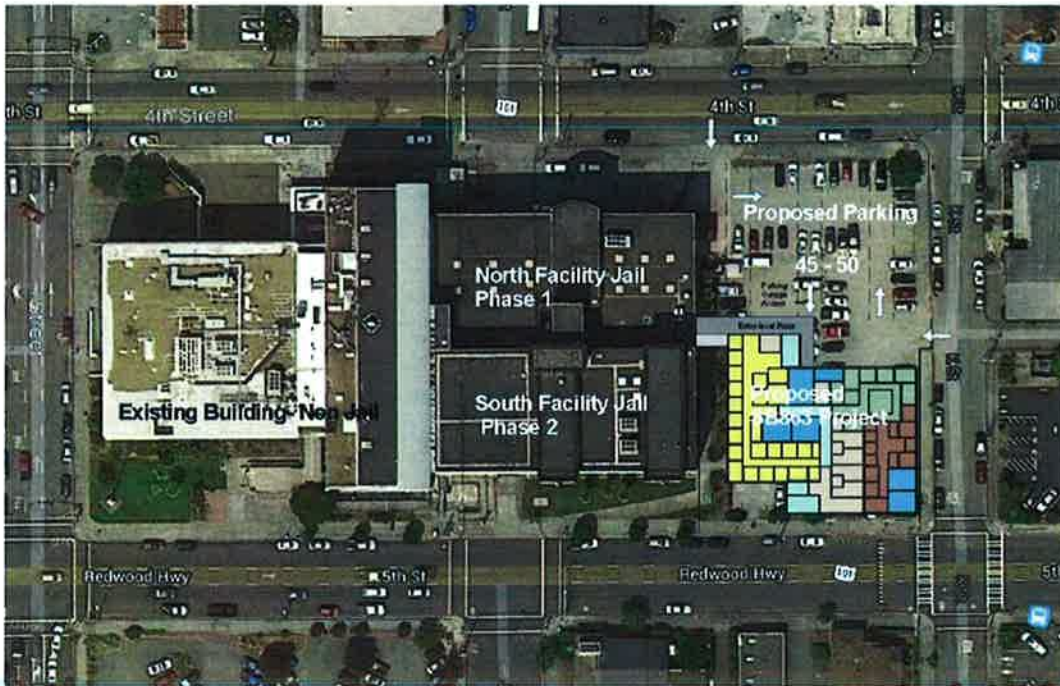

The second floor will house community reentry offenders during non-work hour work programs and includes a separate mental health treatment unit with dedicated program and staff support space which will accommodate six inmates with identified serious psychiatric disorders. The housing is designed for flexible separation of inmate populations.

The housing area will include outdoor exercise, dayrooms, showers and toilets, program rooms, medical screening room, mental health offices, work room, reception, break room, dental space, and medication storage room. The outdoor exercise yards will be covered and fresh air louvered to allow year-around activities during all seasons. The building will be primarily independent of the existing jail and all services and

systems will be new and dedicated to this project. A secure circulation bridge will connect the new facility to the existing jail facility for laundry and meal service. The building will be served by a parking garage and adjacent lot with approximately 74 parking spaces.

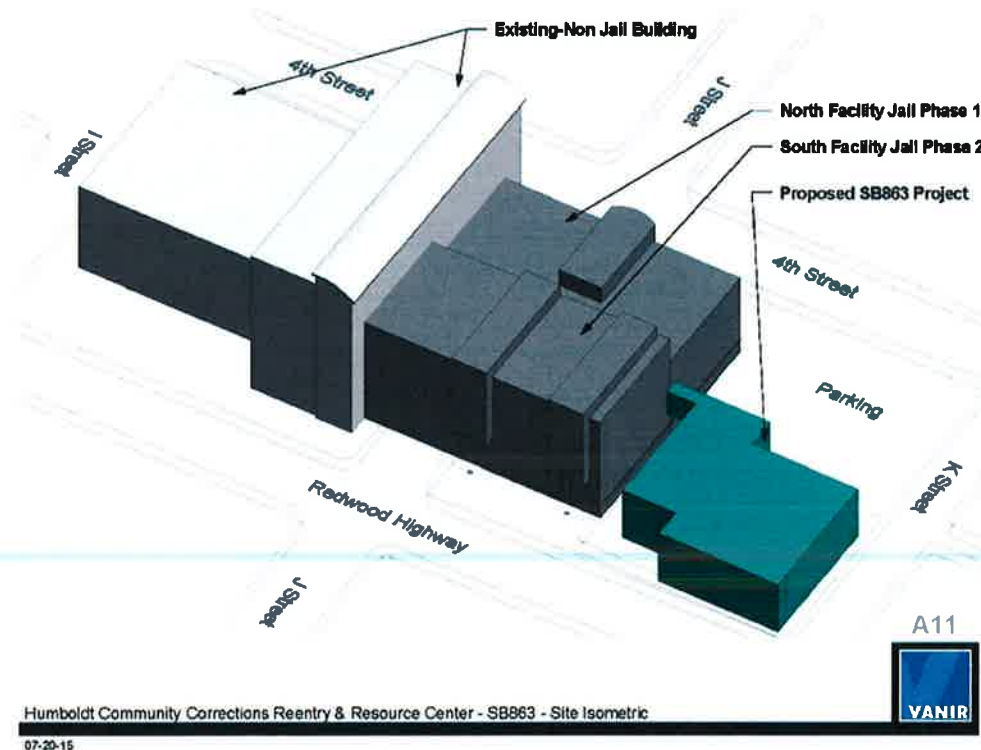

The adjacency of the Center to the existing Jail provides the opportunity to serve the campus and reduce current problems with contraband control. The Mental Health function included within the expansion concept will also supplement and replace portions of the existing areas at the adjacent Main Jail. The current mental health area at the Jail is extremely undersized to serve the current population. There is relatively little to no administrative space at the existing facility. The adjacency of this new project provides the opportunity for provider staff to serve both facilities. The proposed design provides spaces to accommodate the various functions of a mental health suite.

Probation's Day Reporting Center (DRC) will be located on the site where out-of-custody offenders and public have clearly identified access and distinct separation from any secure portions of the campus. There are primarily two distinct functional uses in the DRC including an administration area for staff and programs for out-of-custody treatment. A critical component of the new building is the Sheriff's project area for assigned offenders to receive their work assignment and is conveniently located on site with separate entry. The space is intended to consolidate administration and monitoring of all criminal justice alternative programs the agencies are managing.

A primary area within the new facility is the Reentry component and support services. The new expansion includes beds/bunks, but particular transitional beds that accommodate a specific inmate profile who can benefit from structured programs prior to returning to the community. The in-custody beds can also be used for additional classifications. There is one 28-bed and one-10-bed dormitory style housing units mirrored in plan to each other. The plan is to utilize a indirect supervision model at a fixed position for staff efficiency. The podular dormitory design of the housing will provide the facility segregated dormitories with additional flexibility for security and classification purposes. Multiple program rooms (3) are currently envisioned to allow a variety of intense and structured programs be implemented. *(See Attachments 1 - 4: Aerial Site Plan, Overlay, and Space Layout for the Humboldt County Community Corrections Reentry Resource Center)*

A key component of the proposed construction (multiple program space and classrooms) will allow the Sheriff's Office to begin providing a continuum of reentry services that starts in the County Jail when AB 109 and other local inmates transition

into the community. Currently, inmates leave the jail facility with little or no follow-up assistance. Most need assistance with employment, housing, drug use or other problems before they were booked into the jail and most still have service needs when released from detention. The planned construction will give the Sheriff's Office its very first opportunity to develop and implement a "step down" housing arrangement with appropriate program space for reentry services. The housing and new program areas will provide an extraordinary amount of flexibility in addressing identified offender service needs. The services will target factors that are linked to reoffending such as substance abuse, anti-social personality and hostility or anger. The discharge process would begin at least 30 – 45 days prior to release. The discharge interventions would include assessments, employment preparation classes, assistance with transportation, housing, and securing the identification documents which will aid in determining eligibility for other key financial support services.

Consolidating the various programs and alternatives into one central location and making a one-stop-shop approach available for inmates, agencies, and service providers will improve service delivery, inmate supervision, and will be cost-effective over time. Integrating justice agency support staff in one location and facility is more efficient to operate, particularly in minimizing Sheriff's operational costs.

The proposed project also clearly aligns with the legislature's approach in SB 863 and expectations for how counties should handle and process the new AB 109 Realignment offender populations. *A total of five varying-sized program areas and classrooms will be located on the first floor and three program areas will be included on*

the second floor of the Center. Other space that is planned for the two-story building is shown in the following Table.

Humboldt Community Corrections Reentry Resource Center	
Area Description	Square Feet
Area Summary – First Floor	11,856
1. Sheriff's Work Alternatives Program	3,948
2. Department of Health and Human Services	2,728
3. Probation	5,181
Area Summary Second Floor	11,856
1. Mental Health	1,850
2. Offender Program Rooms	1,905
3. Female Housing	2,585
4. Male Housing	5,516
Total Area	23,712

The programming and inmate support spaces designed for the Center incorporates what criminal justice research is showing will aid in reducing offender recidivism and controlling crime in local jurisdictions. The Center will also will provide the County's Court system with more options, intermediate sentencing sanctions, and alternatives involving both pretrial and sentenced offenders.

3. PROGRAMMING AND SERVICES

Describe the programming and/or treatment services currently provided in your facility. Provide the requested data on pretrial inmates and risk-based pretrial release services. Describe the facilities or services to be added as a result of the proposed construction; the objective of the facilities and services; and the staffing and changes in staffing required to provide the services.

Summary Overview

Currently, offender programming in HCCF takes place in relatively small single classrooms attached to each housing unit. The multi-purpose space can only hold approximately 10 – 15 individuals at a time, which restricts the number of inmates who can take part. The Jail's inmate programs are offered and delivered on a scheduled basis seven-day-a-week. All classes are available on a first

come, first serve basis, but may not be available based on an inmate's classification level. When new and expanded program space becomes available in the new Community Corrections Reentry Resource Center, the specific best practice program components the Sheriff's Office wants to use and will develop involve evidence-based, cognitive behavioral counseling, and other rehabilitative programming and services. The added program rooms will also permit the Sheriff to develop new vocational training programs which will allow inmates to learn trades, thereby increasing their chances for employment whether they are incarcerated or supervised in the community in one of the alternative programs the County has developed. With increased programming and service space, the Sheriff's Office will also direct staff resources to identifying and working with community and correctional programs that can assist with post-release services and coordinate individual offender Jail exit transition plans to ensure implementation and avoid service gaps in treatment that is initiated while incarcerated in HCCF.

Current Programs and Services

In-custody programming is extremely limited by the population classification system and the overall lack of reentry programming space in the current jail footprint. The ability to isolate a group that could do programming in a single part of the jail is made far more complicated because of the current layout. It is difficult to isolate a specific housing unit for transitional reentry programming, for example, because of the classification barriers. The shortage of jail space also leads to a lack of efficacy in the classes/services as well as an inability to maintain a consistent programming schedule.

Current available classes and programs include (a) *Spirit of Freedom Ministry*, (b) *Arcata Interfaith Choir*, (c) *Full Gospel Choir*, (d) *GED classes*, (e) *Effective Parenting*, (f) *Job Readiness*, (g) *Substance Abuse Prevention and Anger Management*, (h) *AA/NA*, (i) *Celebrate Recovery Ministry*, (j) *Framework for Recovery*, and (k) *Drug Court Groups*. These core services are available to both male and female detainees. The anger management and substance abuse prevention services are provided by trained clinical staff assigned to the Jail through the Humboldt County Department of Health and Human Services (DHHS). HCCF's educational services are provided through the Adult Education / High School Diploma Program which is offered at the detention facility through Eureka Adult Education.

One of the key evidence-based programs the jail is currently offering is called "Seeking Safety." The counseling program is designed to help individuals attain safety from trauma and/or substance abuse. It directly addresses both trauma and addiction. The program model is highly flexible and can be conducted in group or individual formats for both men and women. The "Seeking Safety" curriculum offers 25 topics that can be conducted in any order as time allows that include: *Introduction/Case Management*, *Safety*, *PTSD: Taking Back Your Power*, *When Substances Control You*, *Honesty*, *Asking for Help*, *Setting Boundaries in Relationships*, *Getting Others to Support Your Recovery*, *Healthy Relationships*, and *Recovery Thinking*. One of the Sheriff's Office's new partnering agencies for inmate programs and services is the College of the Redwoods Adult Education Programs. The Sheriff's Office and the College are offering new classes that inmates are signing up for based on postings in

the facility's housing units. The programs include (a) *Getting Started With Computers*, (b) *High School Equivalency Test Preparation*, and (c) *Ready, Set, Go to College*.

Pretrial Inmates and Risk-Based Pretrial Release Services

Over the period January 1, 2013 through December 31, 2013, the Humboldt County Jail had an average daily population (ADP) of 370 inmates. The ADP of inmates on pretrial status over this period was 239. As the data indicated, the percentage of inmates on pretrial status for this time period was 64.6%.

In response to impacts on HCCF resulting from the AB 109 Realignment Act, the CCP funded the development and implementation of a new jail Pretrial OR Release and Supervised Release Program targeting pretrial detainees. The Program is staff by both Sheriff's Office and Probation personnel who are located at the downtown Main Jail and Day Reporting Center Program. The staff provide five days a week pretrial screening of detainees booked into HCCF. The Program staff screen bookings using the Ohio Pretrial Release Evidence-based Assessment Tool. The validated Ohio Risk Assessment System – Pretrial Assessment Tool (ORAS-PAT) Instrument is also currently being used by the Jail to screen all fresh arrests to identify individuals who can be released on their own recognizance (OR) pending an arraignment. The Court also has given the Sheriff the authority to adjust the release cut-off on the Assessment Tool when the jail population rises above or falls below 90.0% of the Board of State and Community Corrections (BSCC) rated capacity (gender specific) for the Humboldt County Correctional Facility.

Currently, the Jail's Pretrial OR Release Program is completing an average of 543 assessments each month at HCCF. Based on the Assessment work, the Superior

Court is approving an average of 44 pre-arraigned and Court-arraigned defendants for an OR release from the detention facility. In July 2015, the Probation Department, for example, was supervising 63 OR released defendants and six other individuals who were on pre-sentenced supervision through the Electronic Monitoring component of the program.

Facilities and Services to be Added as a Result of the Proposed Construction

Analysis of local offender risk and needs assessment data shows education levels, work history, job readiness, drug and alcohol abuse history, and physical/mental health issues vary widely. What the analysis shows, however, is that two out of five jail inmates have not earned a high school diploma or a General Education Development (GED) certificate. Three of every four offenders released have a substance abuse problem and more than one out of three report some form of physical or mental disability. Fifth-five percent have children under the age of 18 who often depend on them for some financial support. Only one out of five have had sustained employment. These deficits and limitations create substantial challenges for people who are released from jail into the community. Other data also shows the level of programming and services at the jail is continually encountering pretrial and sentenced inmates needing mental health and healthcare services.

In total, the data clearly demonstrates offenders placed in local County Jail custody, community supervision, and treatment programs have high needs in the area of (a) substance abuse, (b) mental health issues, (c) lack of vocation/educational skills, (d) post-release homelessness, (e) job development and supportive employment, (f) medical issues, (g) psychotropic medication management and monitoring, and (h) help

in accessing and completing eligibility documentation for Federal/State financial assistance programs.

The proposed Community Corrections Reentry Resource Center with multiple in-custody and out-of-custody program rooms would provide much needed educational and reentry program opportunities for the entire jail population and out-of-custody offenders and probationers living in the community. By adding additional vocational training space and combining the administration of existing alternative programs in one centralized building, these new program spaces will serve a much greater portion of the local offender population with expanded offerings and many more hours of program participation.

The overall operational goal and objective for building the new Center is to bring about an appropriate blending of criminal justice supervision and evidence-based treatment strategies that maintain, but then improve, community public safety through recidivism rate reductions that ultimately lead to long-term crime rate reductions. A key element that Humboldt's jail system currently lacks concerns jail reentry services for inmates transitioning from incarceration back to their community. The Sheriff's Office and the local CCP have consistently expressed a strong interest to develop and implement when additional dedicated inmate program space becomes available to the jail system, a structured jail reentry housing unit and services program as proposed in this application.

The future programming that will be conducted in the proposed spaces includes *evidence-based (1) Thinking-For-a-Change, (2) Moral Reconation Therapy (MRT), (3) mental health and suicide prevention, (4) a life skills program, (5) employment*

preparation and job assistance, (6) substance abuse treatment and counseling, (7) anger management, (8) child abuse and parenting, (9) computer literacy, and (10) a victim impact program. In addition, the proposal includes a plan to provide offenders with access to housing stabilization services and assistance with obtaining public assistance and other benefit eligibility services. Out-of-custody offenders requiring mental health treatment, individual/group therapy and counseling as well as other supportive services will also be able to be served in the new programming space. One of Probation's cognitive behavioral interventions that will also be used is "Effective Practices in Community Supervision (EPICS). Local DHHS and Probation staff have been trained by the University of Cincinnati in their cognitive behavioral therapy substance abuse program.

The Sheriff's Office's Custody Division has also been working for the past year to put together an agreement on a broad range of future program classes which can be carried out in the facility when additional program space becomes available through the College of the Redwoods. The programming would include health education, parenting / family education, vocational training, and other adult education curriculum that would offer inmates basic to advanced certificate classes. This specific planning which is taking place focuses on being able to offer through the College of the Redwoods the following future classes:

- Health Education – including classes that cover (a) health and wellness, (b) nutrition basics, (c) health benefits of music, (d) substance abuse/addiction studies, and (e) anger management.

- Parenting/Family Education – including classes that cover parenting strategies / family relationships, and (b) fathering skills.
- Vocational – including classes that cover (a) plant cultivation, (b) landscape construction, (c) introduction to basic landscaping, (d) gardening with specialty plants, (e) introduction to animal care, (f) orientation to food services, (g) institutional food preparation, (h) career planning / marketing for the artist / designer or the business of art, and (i) custodian maintenance.

The cost of existing program services is being provided by the agencies and public / private organizations who are delivering the programming / services in the County Jail. The College of the Redwoods has also agreed to continue providing ongoing funding for future classes and vocational training programs offered through the proposed SB 863 Reentry Resource Center.

Staffing For Jail Programming, Treatment Services and Housing

The Jail's compliment of community service providers including the County Department of Health and Human Services (DHHS) will continue to support programming needs at the detention facility. DHHS's Behavioral Health Division will work with the Sheriff's Office to develop and implement the new mental health treatment services provided in the jail. Both Departments will work to identify the needed resources for the increase in programs because of the additional space in the stand-alone facility. Existing revenue sources including funding from the Community Corrections Partnership (CCP), Mental Health Services Act and County General Fund will support the enhanced programming. The Sheriff's Office has prepared an estimate of staffing needs for the new facility. The analysis was completed using the workbook

provided by the National Institute of Corrections (NIC). The resulting analysis shows that to accommodate the proposed construction for the SB 863 Application, the Sheriff's Office will need a net increase of 20 staff. As the following Tables shows, the year one salaries and benefits cost will be \$1,773,850. Both the County Administrator and Board of Supervisors have agreed to fund these positions within 90 days of occupancy of the Community Corrections Reentry Resource Center.

Humboldt County Jail New SB 863 Facility Staffing Allocation and Annual Personnel Costs			
<u>Position</u>	<u>Salaries & Benefits</u>	<u># New Staff Required</u>	<u>Year One Personnel Costs</u>
Correctional Deputy	\$87,416	15	\$1,311,246
Sr. Correctional Deputy	<u>\$92,520</u>	<u>5</u>	<u>\$462,604</u>
Total New Staff Positions/Cost		20	\$1,773,850

4. ADMINISTRATIVE WORK PLAN

Describe the steps required to accomplish this project. Include a project schedule, and list the division/offices including personnel that will be responsible for each phase of the project, and how it will be coordinated among responsible officials both internally and externally.

Summary Overview

Humboldt County has developed and will utilize a project management, construction and administrative work plan specifically intended to address local and State building requirements for the new Humboldt Community Corrections Reentry Resource Center. The County will use a design / bid / build delivery construction method. The project will be handled from the start by a highly experienced project team supplemented with a construction management (CM) consultant and contract architectural / engineering firm. The project management

team will include executives from County administration, Sheriff's Office, and General Services Department. The County's designated Project Manager will be the Deputy Public Works Director for Facilities Management who will be responsible for ensuring all phases of the construction work are coordinated throughout the project delivery process and the scope of work is accomplished within the allotted time. The County's project administration system utilizes both proven monitoring and cost control protocols. Designated County staff will respond to the BSCC and the selected project design architect will respond to all Minimum Title 15 and 24 Jail Standards issues.

Management Approach For Proposed Construction Project

Humboldt County has an experienced in-house construction planning and administration team that has the ability to successfully manage this capital expenditure project. The County will supplement their staff with the contract services of a construction management (CM) firm. The County's Construction Manager will be *Tyler Holmes, Deputy Public Works Director – Facilities Management*, who will serve as the County's designated Project Manager and will be responsible for ensuring that all phases of the construction work are coordinated throughout the project delivery process. *Josielyn Gilbaugh, Deputy Public Works Director – General Services*, will be the project Fiscal Officer, who will manage fiscal expenditures, reporting, and ensure the building construction remains within set budget. *Captain Ed Wilkinson of the Humboldt County Sheriff's Office*, will be the designated SB 863 contact person.

County staff have developed a project administration system that utilizes both proven monitoring and control protocols. Each project is constructed using qualified staff

consultants in a “team approach” throughout its development. The County and its consultants have extensive experience with projects, including detention facilities funded through the State’s revenue bond process, and will use a management approach similar to other successful major construction projects. The County also has scheduling, budgeting, and cost accounting software in place to aid with the project.

Designated County staff will respond to the BSCC on all contract matters and the selected Project Design Architect will respond to all Minimum Title 15/24 Jail Standards issues. An integrated project delivery process will be used for programmatic and quality control delivery in which the County, construction management team, consultants, and all stakeholders (Sheriff, Probation, and Department of Health and Human Services) are involved to review the drawings and the performance of all consultants retained for the project. In addition, the construction management firm will monitor, schedule, and coordinate activities on behalf of the County and Sheriff’s Office.

A single General Contractor will be responsible to organize the construction workforce, order materials, establish a quality control program, and schedule the work of all trades including mechanical, plumbing, and electrical, in a logical order. The Construction Manager, jail transition team personnel, on-site Inspector, construction management firm, and Project Architect will observe and inspect all completed construction work. Following substantial completion, Sheriff’s Custody, Probation, and Department of Health and Human Services (DHHS) personnel will transition into the functional spaces and train staff. The local fire department will inspect and verify operation of the fire safety equipment. Upon completion of any corrective work, inspections, and audits, final payment will be made to the General Contractor.

Humboldt County has completed the initial programming, conceptual site design, and layout for the Sheriff's Office, Probation Department, and DHHS components of the SB 863 Humboldt Community Corrections Reentry Resource Center Project. The County staff and project transition team essential for the successful completion of the Humboldt Community Corrections Reentry Resource Center are also in place.

Project Schedule

Upon notification of the BSCC Conditional Award, the County will work quickly to finalize the Real Estate Due Diligence, Site Assurance documents, and complete the contract process to hire a construction management (CM) firm and design group. The required documentation will be presented to the California Department of General Services (DGS) for review and then to the State Public Works Board (SPWB) for the Project Establishment by March 2016. The Schematic Design and Operational Program Statement will be submitted to BSCC/CSFM for review in March 2016. SPWB Plan Approval is scheduled for completion in May 2016 with the SPWB Consent to Ground Lease occurring in June 2016. BSCC/SFM Final Approval is scheduled for July 2016, and the Pooled Money Investment Board Loan Request in September 2016. The Department of Finance Action to Approve Drawings and Proceed to Bid will be finalized in September 2016. Bids will be received in September 2016, construction will commence in October 2016, and be completed by June 2018. Occupancy and move-in will occur in September 2018.

5. BUDGET NARRATIVE

Describe the amounts and types of funding proposed and why each element is required to carry out the proposed project. Describe how the county will meet its funding contribution (match) requirements for all project costs in excess of the

amount of state financing requested and how operational costs (including programming costs) for the facility will be sustained.

Summary Overview

The \$20 million SB 863 Funding Application request to develop Humboldt County's Community Corrections Reentry Resource Center will provide much needed transitional "step-down" housing for both male and female inmates that can support offender reentry efforts along with other special need mental health treatment housing for offenders with serious psychiatric disorders. The dedicated multiple programming rooms also contained in the project will allow the County's criminal justice system to consolidate the community's limited, but essential mental health, drug counseling, employment assistance, life skills, and other important resources for assisting both in-custody detainees including the longer term Realignment sentenced / revoked inmates and alternative supervised offenders into one primary prominent downtown location. This will bring about a more cost-effective and efficient use of these important resources for the Sheriff, Probation Department, Courts, and local community. While the County is able to make available \$1,547,000 cash and in-kind match funding for support of the project, without the State funding, the Resource Center will likely not be constructed for many years.

Project Construction Budget

Humboldt County is requesting \$20 million in State funding and will provide \$860,000 as a cash contribution and \$687,000 in-kind matching funds to construct a stand-alone facility at the North end of the existing Humboldt County Correctional Facility (HCCF). The Reentry Resource Center would serve both in-custody and

alternative out-of-custody male and female offenders. A new multi-function building is a primary component of the proposed project. The building would co-locate the Sheriff's Office's Jail alternative programs, the Probation Department's Day Reporting Center, and Department of Health and Human Services (DHHS) Behavioral Health clinical mental health and substance abuse counseling staff. The facility would include a new 38-bed community transitional reentry inmate housing unit with expanded dedicated programming spaces specifically arranged to accommodate evidence-based service programming. The Center would also include a dedicated six-bed mental health treatment housing unit with adjacent program space and support areas for counselors assigned to the new unit. The expansion provides transitional beds that accommodate a specific inmate profile who can benefit from structured programs prior to community reentry. The types and amounts of funding requested include the following:

- Construction – Includes all costs associated with fixed construction costs for the new facility, parking garage/lot, and associated site improvements. The County is requesting \$20,000,000 in construction funding and will contribute an additional \$860,000 in cash match and \$687,00 in-kind match for total anticipated construction costs of \$21,547,000 million. The estimated cost of construction was determined in 2015 dollars and then escalated to the mid-point of construction based on the anticipated project schedule. Included in the construction (bid) costs are (a) fixed equipment and furnishings, (b) 5% change order contingency, and (c) a geographic location factor (2.5%). Construction cost estimates were provided by Vanir, Inc. and based on a conceptual building and site layout plan.

- Additional Eligible Costs – Includes cost for non-fixed moveable items necessary to operate the facility and outfit program and treatment areas such as furniture, shelving, fixtures and equipment, inmate management systems, video storage systems, and video visitation equipment (\$724,000). This item also includes construction support activities such as inspections, testing, equipment commissioning, and plan check services (\$375,000). The County is requesting \$1,099,000 million for additional eligible costs.
- Architectural – The County will solicit proposals and contract with an A/E to develop schematic design, design development, construction, and bid specification documents. The County is requesting \$1,768,000 million for A/E services and will contribute \$117,000 in cash match for a total of \$1,885,000.
- Project/Construction Management – The County will contract with a P/CM to assist with management of contractor construction activities. The County will contribute \$514,000.
- CEQA / State Agency Fees / Audit & Needs Assessment –The County has contributed \$89,000 for CEQA preparation and has allocated \$16,000 for Due Diligence expense. The County will also contribute \$91,000 towards the cost of State agency fees. Additionally, the County will contribute an estimated \$10,000 for an outside audit to be performed at the close of the project and has contributed \$39,000 for a Needs Assessment Update.
- County Administration – The County has found that close oversight and coordination by County staff of contractors as well as communication and coordination within the County results in higher quality, lower cost projects.

While a number of County staff will be actively involved in the project (see Administrative Work Plan), the project administration in-kind contribution will primarily consist of a Project Manager in the County's General Services Department who will serve as design and construction project management lead, coordinating the entire facility development process – planning, design and construction activities. The total County Administration in-kind contribution is anticipated to be \$62,000.

- Transition Planning – The Sheriff's Office will lead the transition planning for the project. This will initially be primarily the work of a single part-time staff and as the project moves closer to completion this will expand to include the planning, development, and implementation of the new facility's operations. Total transition planning in-kind contribution is anticipated to be \$300,000.
- Land Value – The appraised value of the site of the new facility is \$325,000 and will be a portion of the County's in-kind match.

Cash Match Requirements

The County's contribution to the project as approved by the Board of Supervisors totals \$1,547,000, 7.2% of the project costs. The County will meet the required contribution through a combination of cash and in-kind match. The \$860,000 in cash contribution will be provided from two existing funding sources including \$500,00 from the Humboldt County Community Corrections Partnership (HCCCP) and the County intends to pursue the issuance of Certificates of Participation. The County also currently has \$1,000,000 available in the criminal justice fund that could be applied to the project if the COPs are not issued. In-kind contributions totaling \$687,000 will be provided

through staff time for County Administration and transition planning and the appraised value of the project site.

Sustaining Operational Costs

The Sheriff's Office and County construction staff are seeking building designs with minimum staffing cost that will translate into the lowest long-term lifecycle cost expense to community taxpayers. The County intends on not only minimizing capital construction costs, but is specifically mindful of the need to minimize lifecycle cost including, annual staffing and operations cost of the new housing, medical and mental health services space, and expanded program areas. The programming and inmate services spaces designed for the project incorporates what research is showing will aid in reducing recidivism and controlling crime. The project specifically provides much needed program and vocational training opportunities for male and female inmates that can support offender reentry efforts. This will also give the County's Jail the ability to implement more varied inmate programming options and deliver programs and services efficiently and cost effectively.

The Sheriff's Office has prepared an estimate of staffing needs for the new facility. The staffing allocation for this building will require an additional 20 Deputies positions. The Sheriff's Office's financial staff has projected this additional annual cost for Correctional Deputies and Senior Correctional Deputies at \$1,773,814. This estimate includes the new staff positions identified above in addition to the cost for services, food, supplies and energy. The County, through their submittal of this SB 863 funding proposal, is committing to the staffing and operations of the new facility. With a

conditional funding award the County will commit through its budgetary practices and long-range financial planning the funding to operate the new facility.

The Day Reporting Center staffing of 14 Probation Officers, Supervisor, and administrative staff is funded through the County's General Fund budgeting process and will continue as a Board-approved appropriation into the future. Department of Health and Human Services staffing costs will also continue as a Board-approved appropriation in the County's annual budget development process. There will continue to be a planning effort of the County CCP to fund the necessary staffing and support for evidence-based programs and mental health treatment.

6. READINESS TO PROCEED

Summary Overview

Humboldt County owns the SB 863 site located in downtown Eureka. The County has a recent independent appraisal of the site's value. Documentation has been secured providing CEQA compliance including a final Notice of Determination and a letter from County Counsel certifying that the statute of limitations has expired and no challenges were filed. The Board of Supervisors has approved a Resolution which authorizes an adequate amount of available match funds, approves the project document forms necessary for financing, and authorizes an appropriate signatory to execute these documents. Conceptual planning, programming, and design work for the proposed construction project have been completed by the Sheriff's Office and partnering agencies.

Board of Supervisor's Resolution

On August 25, 2015, the Humboldt County Board of Supervisors approved Resolution #15-89 authorizing the County to participate in the SB 863 process. The Resolution stipulates the County will adhere to State requirements in terms of the agreement between the County, the Board of State and Community Corrections (BSCC), and the State Public Works Board (SPWB) including all forms of the project documents and in the expenditure of State funds and County match funds. The County will appropriate the amount of matching funds (cash and in-kind match) identified by the County on the Funding Proposal Form submitted by BSCC. The identified matching funds will be compatible with the State's lease revenue bond funding. The County Board agrees to fully and safely staff and operate the project consistent with Title 15 California Code of Regulations within 90 days after project completion. *(See attached Board of Supervisors Resolution)*

California Environmental Quality Act Compliance

On August 24, 2015 the Humboldt County Office of County Counsel issued a Certification Letter confirming that the Board of Supervisors approved the Initial Study and Mitigated Negative Declaration for the project and filed a Notice of Determination on July 16, 2015. The letter further indicates the statute of limitations expired on August 17, 2015 and the County has not received notice of a lawsuit challenging the Board's approval. In addition, County Counsel searched the Superior Court filing records which has also not indicated that any actions pertaining to the project were filed on or before August 17, 2015. *(See Notice of Determination and County Counsel's Letter included in separate Application documentation)*



A13



Humboldt Community Corrections Reentry & Resource Center-Site Plan - SB863 - Existing

07-20-15

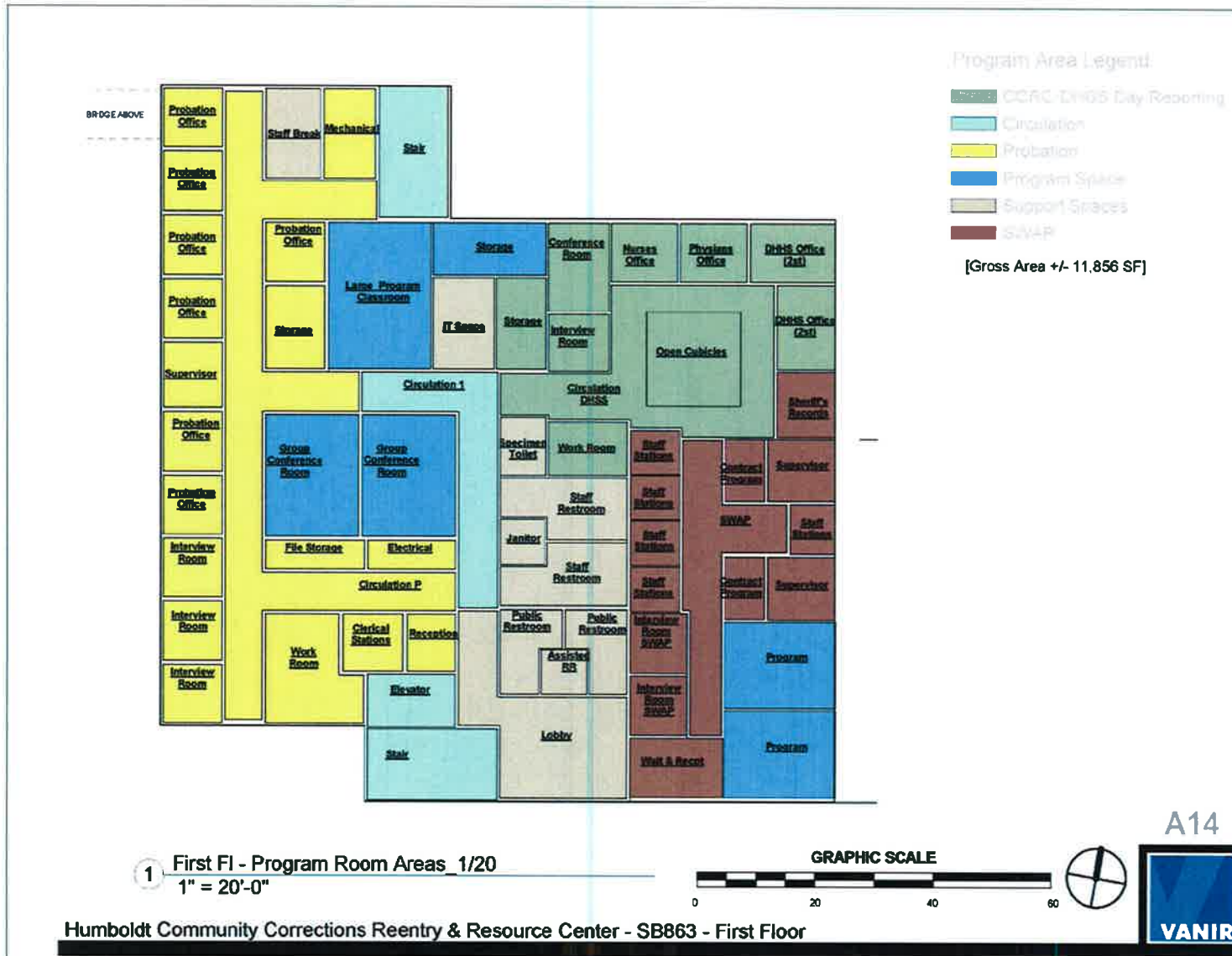

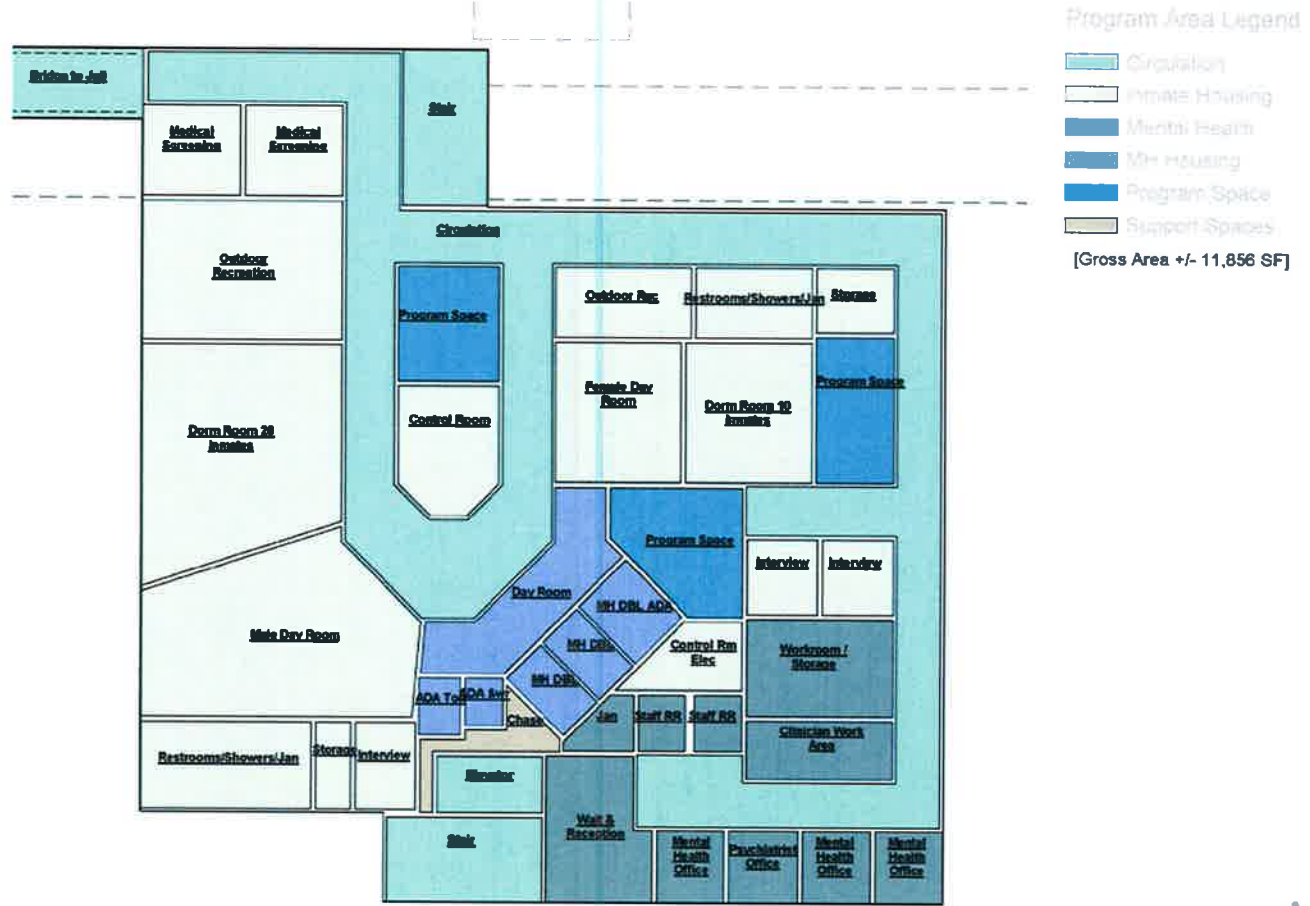

1 Second Fl - Program Room Areas_1/20
1" = 20'-0"

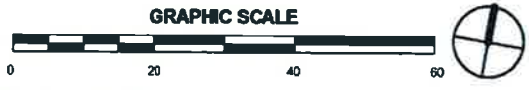

A15
VANIR

Humboldt Community Corrections Reentry & Resource Center - SB863 - Second Floor

8-7-15

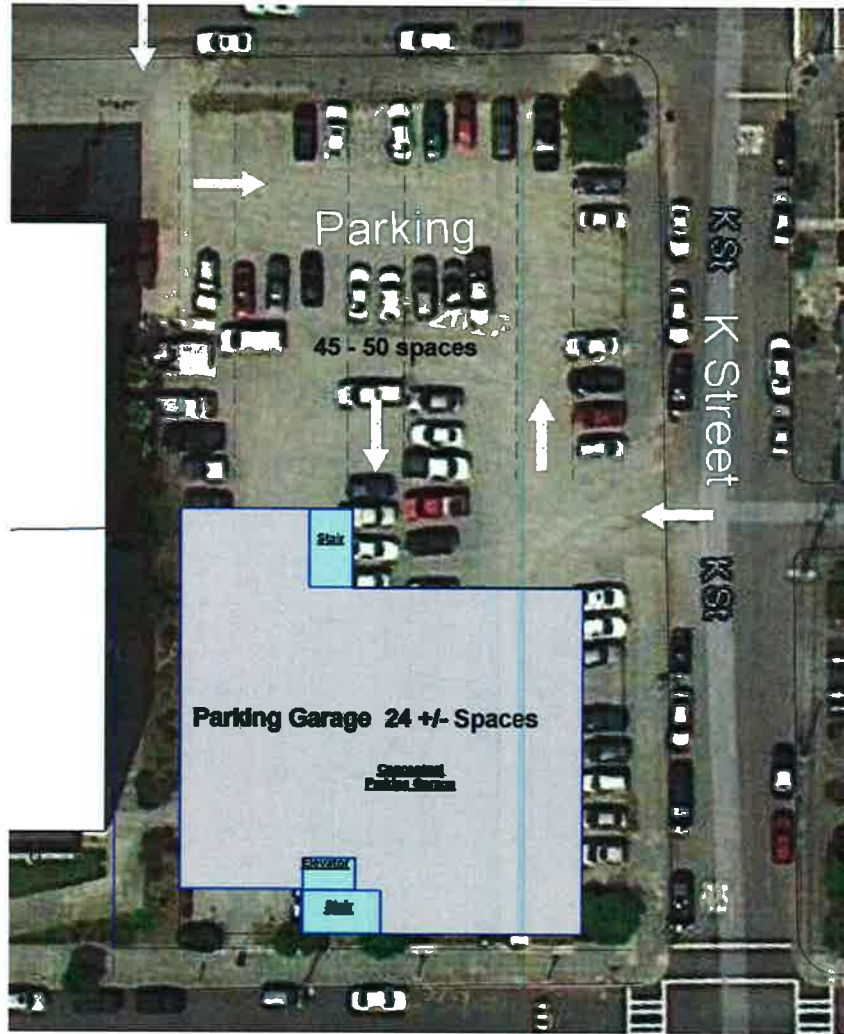

1 Parking Garage
1" = 40'-0"
[Gross Area +/- 11,856 SF]



A16

Humboldt Community Corrections Reentry & Resource Center- SB863 - Garage Floor

8-7-15

BOARD OF SUPERVISORS, COUNTY OF HUMBOLDT, STATE OF CALIFORNIA

Certified copy of portion of proceedings, Meeting of August 25, 2015

RESOLUTION NO. 15-89

**RESOLUTION AUTHORIZING THE HUMBOLDT COUNTY SHERIFF'S OFFICE TO
SUBMIT AN APPLICATION AND PROPOSAL FOR SB 863 CONSTRUCTION OF ADULT
LOCAL CRIMINAL JUSTICE FACILITIES**

WHEREAS, the Humboldt County Board of Supervisors is the approving body to receive the Board of State and Community Corrections (BSCC) funding administered by the State of California; and

WHEREAS, the County of Humboldt has a critical need to expand its jail and other criminal justice facilities and is ready to seek competitive bidding; and

WHEREAS, there is a significant cost to the County of Humboldt to provide a detention facility for those detained by City and County law enforcement entities; and

WHEREAS, Senate Bill 863 appropriates \$500,000,000 in state lease-revenue bond financing authority for acquisition, design and construction, including expansion or renovation, of adult local criminal justice facilities in California; and

WHEREAS, the BSCC, pursuant to the provisions of SB 863, issued a Request for Proposals related to the Construction of Adult Local Criminal Justice Facilities on June 10, 2015; and

WHEREAS, the County of Humboldt will be submitting their Response to the BSCC's Request for Proposals for Construction of Adult Local Criminal Justice Facilities by August 28, 2015; and

WHEREAS, the BSCC's Request for Proposals requires confirmation via a Resolution of the Humboldt County Board of Supervisors of the County's commitment to and provision for taking certain actions and preparations as part of the County's Proposal; and

WHEREAS, the County of Humboldt is willing and able to take the following actions and preparations as part of its Proposal in response to the BSCC's Request for Proposals for Construction of Adult Local Criminal Justice Facilities; and

WHEREAS, receipt of the funding will enhance the ability of Humboldt County to protect the lives and property of the citizens of the County of Humboldt.

NOW, THEREFORE, BE IT RESOLVED AND ORDERED by the Board of Supervisors of the County of Humboldt, State of California that in consideration for significant financial assistance for the Humboldt Community Corrections Reentry Resource Center, the County will or does hereby take the following actions and make the following assurances:

- A. The County of Humboldt is seeking funding for its proposed project within the Adult Local Criminal Justice Facilities Construction Financing Program (the "SB 863 Financing Program"). As such, the Board of Supervisors of Humboldt County does hereby represent, warrant and covenant as follows:

BOARD OF SUPERVISORS, COUNTY OF HUMBOLDT, STATE OF CALIFORNIA
Certified copy of portion of proceedings, Meeting of August 25, 2015

RESOLUTION NO. 15-89

1. Lawfully Available Funds. The county cash contribution funds, as described in the documentation accompanying the County's SB 863 Financing Program Proposal Form, have been derived exclusively from lawfully available funds of the County.

County Cash Contribution Funds Are Legal and Authorized. The payment of the county cash contribution funds for the proposed adult local criminal justice facility project (the "Project") (i) is within the power, legal right, and authority of the County; (ii) is legal and will not conflict with or constitute on the part of the County a material violation of, a material breach of, a material default under, or result in the creation or imposition of any lien, charge, restriction, or encumbrance upon any property of the County under the provisions of any charter instrument, bylaw, indenture, mortgage, deed of trust, pledge, note, lease, loan, installment sale agreement, contract, or other material agreement or instrument to which the County is a party or by which the County or its properties or funds are otherwise subject or bound, decree, or demand of any court or governmental agency or body having jurisdiction over the County or any of its activities, properties or funds; (iii) and have been duly authorized by all necessary and appropriate action on the part of the governing body of the County. The County ensures the funds are compatible with lease revenue bond financing. The County intends to pursue the issuance of Certificates of Participation to fund this project and currently has \$1 million available in the Criminal Justice fund that could be applied to the project if COPs are not issued. In addition, the County has identified \$500,000 cash contribution from the Humboldt County Community Corrections Partnership (HCCCP).

2. No Prior Pledge. The county cash contribution funds and the Project are not and will not be mortgaged, pledged, or hypothecated by the County in any manner or for any purpose and have not been and will not be the subject of a grant of a security interest by the County. In addition, the county cash contribution funds and the Project are not and will not be mortgaged, pledged, or hypothecated for the benefit of the County or its creditors in any manner or for any purpose and have not been and will not be the subject of a grant of a security interest in favor of the County or its creditors. The County shall not in any manner impair, impede or challenge the security, rights and benefits of the owners of any lease-revenue bonds sold by the State Public Works Board for the Project (the "Bonds") or the trustee for the Bonds.
3. Authorization to Proceed with the Project. The Project proposed in the County's SB 863 Financing Program proposal is authorized to proceed in its entirety when and if state financing is awarded for the Project within the SB 863 Financing Program.

- B. The County provides assurance that the submittal of documentation evidencing that compliance with CEQA has been fully completed for the proposed project and further is certifying that all related statutes of limitation have expired without challenge.

BOARD OF SUPERVISORS, COUNTY OF HUMBOLDT, STATE OF CALIFORNIA
Certified copy of portion of proceedings, Meeting of August 25, 2015

RESOLUTION NO. 15-89

- C. The Board of Supervisors of Humboldt County does hereby approve the forms of the project documents deemed necessary, as identified by the State Public Works Board to the BSCC to effectuate the financing authorized by the SB 863 legislation including, but not limited to, Project Delivery and Construction Agreement, the Board of State and Community Corrections Agreement, the Ground Lease, the Right of Entry for Construction and Operation, and the Facility Sublease. Each of the Chair of the Board of Supervisors, County Executive Officer and the Chief Financial Officer of the County, or their designees (collectively, the "Authorized Officers"), acting alone, is hereby authorized for and in the name of the County to execute, and the Clerk to the Board of Supervisors is authorized to attest, the Project Delivery and Construction Agreement, the Board of State and Community Corrections Agreement, the Ground Lease, the Right of Entry for Construction and Operation, and the Facility Sublease, in substantially the form hereby approved, with such additions thereto and changes therein as required by the BSCC or the State Public Works Board to effectuate the SB 863 Financing Program and as condition to the issuance of the Bonds. Approval of such changes shall be conclusively evidenced by the execution and delivery thereof by any one of the Authorized Officers each of whom, acting alone, is authorized to approve such changes.

Each of the Authorized Officers is authorized to execute these respective agreements at such time and in such manner as is necessary within the SB 863 Financing Program. Each of the Authorized Officers is further authorized to execute, acknowledge and deliver any and all documents required to consummate the transactions contemplated by the Project Delivery and Construction Agreement, the Board of State and Community Corrections Agreement, the Ground Lease, the Right of Entry for Construction and Operation, and the Facility Sublease.

- D. The contact people for the SB 863 Adult Local Criminal Facilities Construction Project shall be as follows:

County Construction Administrator - Tyler Holmes, Deputy Public Works Director-
Facilities Management.

Project Financial Officer- Josielyn Gilbaugh, Deputy Public Works Director - General
Services.

Project Contact - Ed Wilkinson, Captain, Humboldt County Sheriff's Office.

The Humboldt County Sheriff, or his designee, is hereby authorized to create and submit a proposal for SB 863 Adult Local Criminal Facilities Construction Project, on behalf of the COUNTY OF HUMBOLDT, a political subdivision of the State of California, and to do and perform everything necessary to carry out the purpose of this Resolution including any necessary non-monetary changes, modifications, or amendments.

BOARD OF SUPERVISORS, COUNTY OF HUMBOLDT, STATE OF CALIFORNIA

Certified copy of portion of proceedings, Meeting of August 25, 2015

RESOLUTION NO. 15-89

- E. The Humboldt County Board of Supervisors has reviewed the SB 863 Adult Local Criminal Facilities Construction Financing Program Proposal requirements issued through the BSCC and provides the following Assurances for the Proposal.
1. The County of Humboldt assures it will adhere to state requirements and terms of the agreements between the County, the Board of State and Community Corrections and the State Public Works Board in the expenditure of any state financing allocation and county contribution funds.
 2. The County of Humboldt assures it will safely staff and operate the facility that is being constructed (consistent with Title 15, California Code of Regulations) within ninety (90) days after project completion.
 3. The County of Humboldt certifies that it is not and will not be leasing housing capacity in this SB 863 financed adult local criminal justice facility to any other public or private entity for a period of 10 years beyond the completion date of the adult local criminal justice facility.
 4. The County of Humboldt assures it has project site control through either fee simple ownership of the site or comparable long-term possession of the site, and right of access to the project sufficient to assure undisturbed use and possession of the site, and will not dispose of, or modify the use of, or change the terms of the real property title, or other interest in the site of facility subject to construction, or lease the facility for operation to other entities, without permission and instructions from the Board of State and Community Corrections.
 5. The County of Humboldt attests to \$325,000 as the current fair market land value for the proposed new or expanded jail facility as reflected in the independent appraisal acquired by the County.

Dated: August 25, 2015



ESTELLE FENNELL, Chair
Humboldt County Board of Supervisors

Adopted on motion by Supervisor Bass, seconded by Supervisor Sundberg, and the following vote:

AYES:	Supervisors	Sundberg, Lovelace, Fennell, Bohn, Bass
NAYS:	Supervisors	--
ABSENT:	Supervisors	--
ABSTAIN:	Supervisors	--

BOARD OF SUPERVISORS, COUNTY OF HUMBOLDT, STATE OF CALIFORNIA
Certified copy of portion of proceedings, Meeting of August 25, 2015

RESOLUTION NO. 15-89

STATE OF CALIFORNIA)
County of Humboldt)

I, KATHY HAYES, Clerk of the Board of Supervisors, County of Humboldt, State of California, do hereby certify the foregoing to be an original made in the above-entitled matter by said Board of Supervisors at a meeting held in Eureka, California.

The within instrument is a full, true and correct copy of the original on file in this office.

ATTEST:

KATHY HAYES
Clerk of the Board of Supervisors
of the County of Humboldt,
State of California

By 

IN WITNESS WHEREOF, I have hereunto set my hand and affixed the Seal of said Board of Supervisors.

By ANA HARTWELL
Deputy Clerk of the Board of Supervisors of the
County of Humboldt, State of California

POSTED THROUGH
AUG 19 2015
Humboldt County Clerk

Print Form

Notice of Determination

Appendix D

To:
 Office of Planning and Research
U.S. Mail: P.O. Box 3044
Sacramento, CA 95812-3044
Street Address: 1400 Tenth St., Rm 113
Sacramento, CA 95814

From:
Public Agency: Humboldt County Public Works
Address: 1106 Second Street
Eureka, CA 95501
Contact: Hank Seemann
Phone: 707-445-7741

County Clerk
County of: Humboldt
Address: 825 Fifth Street, Eureka, CA 95501

Lead Agency (if different from above):
Address:
Contact:
Phone:

SUBJECT: Filing of Notice of Determination in compliance with Section 21108 or 21152 of the Public Resources Code.

State Clearinghouse Number (if submitted to State Clearinghouse): 2015042046

Project Title: Proposed Humboldt Community Corrections Reentry Resource Center and New County Office

Project Applicant: County of Humboldt

Project Location (include county): APN 001-191-005, K Street and 4th/5th Streets, Eureka, Humboldt County

Project Description:
The County of Humboldt proposes to develop an approximately 0.79-acre site in two phases. Phase One would be an approximately 26,500 sf building for the Humboldt County Community Corrections Reentry Resource Center, funded through Senate Bill 863. Phase Two would be a building addition of approximately 54,000 sf of program area to house County government offices or new courtroom space. Funding or financing for Phase Two has not been secured. The Site is currently used as a temporary parking lot for the existing courthouse and jail complex.

This is to advise that the Humboldt County Board of Supervisors Lead Agency or Responsible Agency has approved the above

described project on July 14, 2015 (date) and has made the following determinations regarding the above described project.

- 1. The project will will not have a significant effect on the environment.
- 2. An Environmental Impact Report was prepared for this project pursuant to the provisions of CEQA. A Negative Declaration was prepared for this project pursuant to the provisions of CEQA.
- 3. Mitigation measures were were not made a condition of the approval of the project.
- 4. A mitigation reporting or monitoring plan was was not adopted for this project.
- 5. A statement of Overriding Considerations was was not adopted for this project.
- 6. Findings were were not made pursuant to the provisions of CEQA.

This is to certify that the final EIR with comments and responses and record of project approval or the negative Declaration, is available to the General Public at:
Humboldt County Public Works, 1106 Second Street, Eureka, CA 95501
KELLY E. SANDERS
Humboldt County Clerk

Signature (Public Agency): Hank Seemann Title: Deputy-Director JUL 16 2015

Date: July 14, 2015 Date Received for filing at OPR:

BY: [Signature] 12-2015-029

Authority cited: Sections 21083, Public Resources Code.
Reference Section 21000-21174, Public Resources Code.

Revised 2011

FILED

Summary Form for Electronic Document Submittal**Form F**

Lead agencies may include 15 hardcopies of this document when submitting electronic copies of Environmental Impact Reports, Negative Declarations, Mitigated Negative Declarations, or Notices of Preparation to the State Clearinghouse (SCH). The SCH also accepts other summaries, such as EIR Executive Summaries prepared pursuant to CEQA Guidelines Section 15123. Please include one copy of the Notice of Completion Form (NOC) with your submission and attach the summary to each electronic copy of the document.

SCH #: _____

Project Title: Proposed Humboldt Community Corrections Reentry Resource Center and New County Office Facility

Lead Agency: County of Humboldt

Contact Name: Hank Seemann

Email: hseemann@co.humboldt.ca.us

Phone Number: 707-445-7741

Project Location: Eureka, Humboldt Co.

City

County

Project Description (Proposed actions, location, and/or consequences).

Humboldt County proposes to develop an approximately 0.79-acre site (Assessor's Parcel Number 001-191-005) located at 826 4th Street, Eureka, in two phases. The first phase would consist of an approximately 26,000 square feet building to be used for the Humboldt County Community Corrections Reentry Resource Center. The County anticipates applying to the Board of State and Community Corrections in August 2015 for funding to construct this facility through the funding program established by Senate Bill 863. If funding is secured, construction is expected to be complete by approximately 2019. The second phase would be a building addition of approximately 54,000 square feet of program area to house County government offices or new courtroom space. Funding or financing for the second phase has not been secured and there is no current projected timeframe. In order to retain flexibility regarding final design and provide adequate environmental review, this Initial Study includes analysis of the two phases and multiple options for parking, building heights, and footprint within each phase. The Site is currently used as a temporary parking lot for the existing county courthouse and jail complex.

Identify the project's significant or potentially significant effects and briefly describe any proposed mitigation measures that would reduce or avoid that effect.

Appendix G contains the proposed Mitigation Monitoring and Reporting Program with mitigation measures for aesthetics, air quality, cultural resources, hazards, hydrology and water quality, noise, and transportation/traffic.

AES-1: Avoid glare onto vehicle traffic

AES-2: Direct outdoor lighting downward

AIR-1: Implement BMPs to reduce emissions during construction

CULT-1: Stop work if archaeological finds are discovered and provide proper reporting and evaluation

CULT-2: Stop work if human remains are discovered and provide proper reporting

CULT-3: Conduct archival research to determine if monitoring for historic era resources is necessary

HAZ-1: Resolve the cleanup and abatement order with the North Coast Regional Water Quality Control Board

HYDRO-1: Prepare and implement an Erosion Control Plan

HYDRO-2: Cover surplus soils

NOISE-1: Notify sensitive receptors of potential impacts from noise and vibration

NOISE-2: Work hours will be limited

NOISE-3: Construction equipment shall be equipped with noise control devices

NOISE-4: Design the building to reduce interior noise levels

TRAFFIC-1: Conduct a signal warrant analysis prior to Phase 2 to determine if signalization is appropriate to mitigation delays experienced at the 4th and K Street, 4th and L Street, and 5th and K Street intersections

If applicable, describe any of the project's areas of controversy known to the Lead Agency, including issues raised by agencies and the public.

1. A parking study (Appendix E) was prepared in response to concerns expressed by the City of Eureka regarding off-site parking capacity.
2. A traffic study (Appendix F) was prepared to address potential impacts related to traffic and circulation.
3. The North Coast Regional Water Quality Control Board has an open case on the project site associated with the property's historic use as a service station and dry cleaner. In February 2015, the U.S. EPA approved funding under its Targeted Brownfields Assessment Program to assist the County in assessing and characterizing the potential presence of residual on-site contamination. Collection of soil boring samples for laboratory testing is currently scheduled for May 2015.

Provide a list of the responsible or trustee agencies for the project.

County of Humboldt is the only responsible agency. Encroachment permits (ministerial) may be required from City of Eureka and Caltrans. The project is an urban in-fill project and the site does not contain biological habitat, so trust resources will not be affected.

Appendix G
Mitigation Monitoring and Reporting Program
Humboldt County Community Correction Reentry Resource
Center and Future Government Facility

Impact	Mitigation Measure	Implementation Responsibility	Monitoring/Reporting Responsibility	Timing
Aesthetics	<p>AES-1: If the final building design includes windows that have the potential to produce glare onto vehicle traffic, these windows shall be treated or tinted to reduce glare.</p> <p>AES-2: All outdoor lighting shall be directed downward on the Site to prevent illumination of adjacent parcels.</p>	<p>County of Humboldt</p>	<p>County of Humboldt</p>	<p>During design and construction</p>
Air Quality	<p>AIR-1: During construction of the HCCCRRC and New County Office Facility and associated site improvements, the contractor will:</p> <ul style="list-style-type: none"> • Spray exposed soils with water during grading on a daily basis • Suspend earthmoving and trenching activities when winds exceed 20 mph • Cover haul-truck loads • Immediately after grading, plant ground cover in disturbed areas or otherwise cover exposed disturbed areas in a manner preventing windblown dust from leaving the project site. 	<p>County of Humboldt</p>	<p>County of Humboldt and NCUAQMD</p>	<p>During construction</p>
Cultural Resources	<p>CULT-1: If cultural materials (e.g., chipped or ground stone, historic debris, building foundations, or bone) are discovered during ground-disturbance activities, work within 20 meters (66 feet) of the discovery shall be stopped, per the requirements of CEQA (Title 14 CCR 15064.5 [f]). Work near the archaeological find(s) shall not resume until a professional archaeologist, who meets the Secretary of the Interior's Standards and Guidelines, has evaluated the materials and offered recommendations for further action. Any identified cultural resources will be recorded on DPR 523 historic resource recordation forms, from the Office of Historic Preservation.</p>	<p>County of Humboldt</p>	<p>County of Humboldt</p>	<p>During construction</p>

	<p>If Native American archaeological remains are inadvertently encountered, the Tribal Historic Preservation Officers (THPOs) of the three recognized Wiyot-area Tribes (Blue Lake Rancheria, Bear River Band of Rohnerville Rancheria, and Wiyot Tribe) will be immediately notified, permitted to observe the findings in the field, and afforded the opportunity to make recommendations for avoiding, minimizing, or mitigating impacts from the proposed development.</p>			
	<p>CULT-2: If human remains are discovered during project construction, work within 20 meters (66 feet) of the discovery location, and within any nearby area reasonably suspected to overlie human remains, will cease (Public Resources Code, Section 7050.5). The Humboldt County Coroner will be contacted to determine if the cause of death must be investigated. If the coroner determines that the remains are of Native American origin, it is necessary to comply with state laws regarding the disposition of Native American burials, which fall within the jurisdiction of the California Native American Heritage Commission (NAHC) (Public Resources Code, Section 5097). In this case, the coroner will contact NAHC. The descendants or most likely descendants of the deceased will be contacted, and work will not resume until they have made a recommendation to the landowner or person responsible for excavation work with direction regarding appropriate means of treatment and disposition, with appropriate dignity, of the human remains and any associated grave goods, as provided in Public Resources Code, Section 5097.98.</p>	County of Humboldt	County of Humboldt	During construction
	<p>CULT-3: A qualified historical resource professional shall conduct Archival research to determine if monitoring for historic era resources is necessary. If deemed necessary, the appropriate locations for monitoring during the removal of gravel, asphalt, concrete or fill shall be determined. The purpose of this monitoring will be to allow a qualified professional to observe any artifacts or evidence of historical settlement, activity, or burials within the project footprint prior to construction activities that may destroy</p>	County of Humboldt	County of Humboldt	Prior to initiating construction, during initial excavations

	them or result in an inadvertent discovery. If the pre-construction monitoring does not yield any artifacts or evidence of historical settlement, activity, or burials, as determined by a qualified professional, construction may commence without further oversight. If artifacts or evidence of historical settlement, activity, or burials are discovered during the pre-construction monitoring, then appropriate actions shall be taken as described in Mitigation Measures CULT-1 and CULT-2.			
Hazards	HAZ-1: Prior to construction the County shall resolve the CAO or otherwise secure construction approval from the RWQCB. Construction approval is expected to require additional site-specific sampling for PCE. If PCE is detected above actionable levels at the project site, the County will develop an appropriate remediation program in consultation with the RWQCB. The soil remediation process ultimately selected will comply with methods approved by the State Water Resources Control Board and the RWQCB.	County of Humboldt	County of Humboldt	Prior to construction
Hydrology and Water Quality	HYDRO-1: Prior to the start of grading on the Site, the Project proponent shall require the construction contractor to prepare and implement an Erosion Control Plan (ECP). The ECP shall identify Best Management Practices (BMPs) in accordance with the California Stormwater Best Management Practices Handbook, such as the use of silt fences, straw mats, and other techniques as appropriate, to be used during grading and construction activities to control erosion, sedimentation, and deposition of pollutants.	County of Humboldt	County of Humboldt	Prior to construction
	HYDRO-2: If surplus soils are stockpiled from site excavations and utility trenching, the piles shall be covered if rains or strong winds are forecasted. This requirement shall be included in the construction plans and specifications, and the construction contractor(s) shall comply with the requirement.	County of Humboldt	County of Humboldt	During construction
Noise	NOISE-1: The County shall notify sensitive receptors (all property owners within 350 feet) of potential impacts from noise and vibration prior to initiating each construction phase. The notice shall describe construction activities and anticipated noise and/or	County of Humboldt	County of Humboldt	During construction

	<p>vibrations from these activities, and the duration and operational hours of construction activities. The notice will also include a contact that sensitive receptors may call to report noise or vibration concerns. The notice will include a request that property owners share the notice with any employee or tenants working within 350 feet of the project site.</p> <p>NOISE-2: To reduce the possibility of the construction noise and vibrations becoming an annoyance to sensitive receptors near the Project, exterior construction activity shall be confined to the weekday hours of 7:00 am to 7:00 pm or until sunset, whichever is later, and weekend hours of 8:00 am to 6:00 pm or until sunset, whichever is later. No heavy equipment related construction activities shall be allowed on Sundays or holidays.</p> <p>NOISE-3: Construction equipment shall be properly maintained and equipped with noise control devices, such as mufflers and shrouds, in accordance with manufacturers' specifications.</p> <p>NOISE-4: The new building will contain design elements, and be constructed with materials that will reduce the interior noise levels to acceptable levels as defined by the County of Humboldt's General Plan.</p> <p>Traffic-1: Prior to initiating Phase 2 of the project, a signal warrant analysis shall be conducted to determine if signalization is the appropriate method to mitigate delays experienced at the following</p> <ul style="list-style-type: none"> • Intersection 4 (4th Street and K Street) • Intersection 5 (4th Street and L Street); and, • Intersection 9 (5th Street and K Street) <p>If, in consultation with the City of Eureka and Caltrans, signalization is determined to be the appropriate method to address increased vehicle delays, the project shall contribute the fair share contribution to these signals. Currently estimated at 2.8% under existing plus project Phase Two conditions and 7.7% under cumulative plus project conditions.</p>			
		County of Humboldt	County of Humboldt	During construction
		County of Humboldt	County of Humboldt	During construction
		County of Humboldt	County of Humboldt	During design and construction
Transportation/ Traffic		County of Humboldt	County of Humboldt	Prior to occupancy of Phase Two



COUNTY COUNSEL
COUNTY OF HUMBOLDT

825 FIFTH STREET

EUREKA, CALIFORNIA 95501

PHONE: (707) 445-7236 FAX: (707) 445-6297

August 24, 2015

Board of State and Community Corrections
County Facilities Construction Program
Attention: Magi Work, Deputy Director
2590 Venture Oaks Way, Suite 200
Sacramento, CA 95833

Re: Humboldt Community Corrections Reentry Resource Center Project – Certification of Compliance with the California Environmental Quality Act

Dear Ms. Work:

This office represents the County of Humboldt (“County”), which has submitted an application and proposal for Senate Bill 863 financing to design and build an adult criminal justice facility as part of the Humboldt Community Correction Reentry Resource Center Project (“Project”). In support of the above-referenced application and proposal, this office certifies the following:

On July 14, 2015, the Humboldt County Board of Supervisors (“Board”) approved the Initial Study and Mitigated Negative Declaration for the Project pursuant to section 15074 of Title 14 of the California Code of Regulations.¹ The County subsequently filed a Notice of Determination pursuant to section 15075 on July 16, 2015. The filing and posting of the Notice of Determination triggered the 30-day statute of limitations on legal challenges to the Board’s approval under the California Environmental Quality Act (“CEQA”). (§15075(g).) The statute of limitations therefore expired at the latest on August 17, 2015. The County has not received notice of a lawsuit challenging the Board’s approval. In addition, this office has thoroughly searched the Humboldt County Superior Court’s filing records which do not indicate that any actions pertaining to the Project were filed on or before August 17, 2015.

If you have any questions, or require any further information, please feel free to email Deputy Director of Public Works, Hank Seemann at hseemann@co.humboldt.ca.us.

Sincerely,

Scott A. Miles

Deputy County Counsel

Attorney for County of Humboldt

¹ All further statutory references are to Title 14 of the California Code of Regulations unless specified otherwise.

NILSEN REAL ESTATE APPRAISALS

3988 WALNUT DRIVE
EUREKA, CALIFORNIA 95503

MATT NILSEN
LIC. #AG006743

(707) 441-8560
FAX (707) 441-8565

EDWARD NILSEN

August 13, 2015

Mrs. Ronda Kime, Sr. Real Property Agent
Humboldt County Dept. Of Public Works
1106 2nd Street
Eureka, CA 95501

**Re: Gravel Parking Lot
Northwest Corner of 5th and "K" Streets
925 5th Street
Eureka, CA 95501**

Dear Mrs. Kime:

Pursuant to your request, I have made an investigation and analysis of the real property described above. My purpose was to estimate the current market value of the real property as if a lot line adjustment has occurred. This is considered a *hypothetical condition* as the current property is 34,276 square feet in size. The fee simple interest will be shown in this report. Per our agreement, this is an *Appraisal Report* which conforms to the Uniform Standards of Professional Appraisal Practice (USPAP) adopted by the Appraisals Standards Board of the Appraisal Foundation.

The valuation date is August 5, 2015.

By reason of my investigation and by virtue of my experience, I am of the opinion the estimated market value of the appraisal property, with the assumptions made herein, is the sum of

THREE HUNDRED TWENTY FIVE THOUSAND DOLLARS

(\$ 325,000)

Following you will find a brief report of my findings, conclusions, and information upon which my value conclusions are partially predicated. Should additional information be requested, please contact me.

Very truly yours,



Matt Nilsen, #AG006743

MN:klr

CRIMINAL JUSTICE RESEARCH FOUNDATION
P. O. Box 60566
Sacramento, CA 95860
(916) 488-4757 (916) 488-2227 FAX
EMAIL: crimjust@jps.net

LETTER OF TRANSMITTAL



To: **Captain Ed Wilkinson**
Humboldt County Sheriff's Office

Date: 8/27/2015
RE: SB 863

- We are sending you: Attached Under separate cover via _____ the following items:
- Shop Drawings Prints Plans Samples Specifications
- Copy of Letter Change Order _____

COPIES	DATE	DESCRIPTION

THESE ARE TRANSMITTED as check below:

- For approval Approved as submitted Resubmit _____ copies for approval
- For your use Approved as noted Submit _____ copies for distribution
- As requested Returned for corrections Return _____ corrected prints
- For Review and Comment FOR BIDS DUE _____, 19_____

REMARKS:

Please find enclosed one copy of the 2015 Jail Needs Assessment Update and CD with the Report in Word and .pdf formats. Also enclosed one original copy with the Sheriff's signature of the SB 863 Application for your permanent files. A second copy is also enclosed for your use as well as the SB 863 application on CD.

Copy to: File
 CC:

Signed: Fred Campbell

Humboldt County

Board of State and Community Corrections
SB 863 Adult Local Criminal Justice Facilities
Construction Program

Humboldt Community Corrections
Reentry Resource Center

August 28, 2015



Humboldt County Correctional Facility (HCCF), 826 4th Street, Eureka, CA



Submitted by:
Humboldt County Sheriff's Office
Jail Custody Division
Eureka, CA



**SENATE BILL 863, ADULT LOCAL
CRIMINAL JUSTICE FACILITIES
CONSTRUCTION FINANCING PROGRAM
PROPOSAL FORM**

This document is not to be reformatted.

SECTION 1: PROJECT INFORMATION

A. APPLICANT INFORMATION AND PROPOSAL TYPE				
COUNTY NAME Humboldt		STATE FINANCING REQUESTED \$ 20,000,000		
SMALL COUNTY (200,000 and UNDER GENERAL COUNTY POPULATION) <input checked="" type="checkbox"/>	MEDIUM COUNTY (200,001 - 700,000 GENERAL COUNTY POPULATION) <input type="checkbox"/>	LARGE COUNTY (700,001 + GENERAL COUNTY POPULATION) <input type="checkbox"/>		
TYPE OF PROPOSAL – INDIVIDUAL COUNTY FACILITY /REGIONAL FACILITY PLEASE CHECK ONE (ONLY):				
INDIVIDUAL COUNTY FACILITY <input checked="" type="checkbox"/>		REGIONAL FACILITY <input type="checkbox"/>		
B: BRIEF PROJECT DESCRIPTION				
FACILITY NAME Humboldt County Correctional Facility (HCCF)				
PROJECT DESCRIPTION Humboldt Community Corrections Reentry Resource Center				
STREET ADDRESS 826 4 th Street				
CITY Eureka		STATE CA	ZIP CODE 95501	
C. SCOPE OF WORK – INDICATE FACILITY TYPE <u>AND</u> CHECK ALL BOXES THAT APPLY.				
FACILITY TYPE (II, III or IV)	<input checked="" type="checkbox"/> NEW STAND-ALONE FACILITY	<input type="checkbox"/> RENOVATION/ REMODELING	<input type="checkbox"/> CONSTRUCTING BEDS OR OTHER SPACE AT EXISTING FACILITY	
D. BEDS CONSTRUCTED – Provide the number of BSCC-rated beds and non-rated special use beds that will be subject to construction as a result of the project, <u>whether remodel/renovation or new construction.</u>				
	A. MINIMUM SECURITY BEDS	B. MEDIUM SECURITY BEDS	C. MAXIMUM SECURITY BEDS	D. SPECIAL USE BEDS
Number of beds constructed	38			6
TOTAL BEDS (A+B+C+D)	44			

E. APPLICANT'S AGREEMENT

By signing this application, the authorized person assures that: a) the County will abide by the laws, regulations, policies, and procedures governing this financing program; and, b) certifies that the information contained in this proposal form, budget, narrative, and attachments is true and correct to the best of his/her knowledge.

PERSON AUTHORIZED TO SIGN AGREEMENT

NAME Michael Downey TITLE Sheriff

AUTHORIZED PERSON'S SIGNATURE  DATE 8/25/15

F. DESIGNATED COUNTY CONSTRUCTION ADMINISTRATOR

This person shall be responsible to oversee construction and administer the state/county agreements. (Must be county staff, not a consultant or contractor, and must be identified in the Board of Supervisors' resolution.)

COUNTY CONSTRUCTION ADMINISTRATOR

NAME Tyler Holmes TITLE Deputy Public Works Director

DEPARTMENT TELEPHONE NUMBER
Facilities Management 707-445-7491

STREET ADDRESS
1106 2nd Street

CITY STATE ZIP CODE E-MAIL ADDRESS
Eureka CA 95501 tholmes@co.humboldt.ca.us

G. DESIGNATED PROJECT FINANCIAL OFFICER

This person is responsible for all financial and accounting project related activities. (Must be county staff, not a consultant or contractor, and must be identified in the Board of Supervisors' resolution.)

PROJECT FINANCIAL OFFICER

NAME Josielyn Gilbaugh TITLE Deputy Public Works Director

DEPARTMENT TELEPHONE NUMBER
General Services 707-445-7491

STREET ADDRESS
1106 2nd Street

CITY STATE ZIP CODE E-MAIL ADDRESS
Eureka CA 95501 Jgilbaugh@co.humboldt.ca.us

H. DESIGNATED PROJECT CONTACT PERSON

This person is responsible for project coordination and day-to-day liaison work with the BSCC. (Must be county staff, not a consultant or contractor, and must be identified in the Board of Supervisors' resolution.)

PROJECT CONTACT PERSON

NAME Ed Wilkinson TITLE Captain

DEPARTMENT TELEPHONE NUMBER
Humboldt County Sheriff's Office 707-441-5100

STREET ADDRESS
826 4th Street

CITY STATE ZIP CODE E-MAIL ADDRESS
Eureka CA 95501 ewilkinson@co.humboldt.ca.us

SECTION 2: BUDGET SUMMARY

Budget Summary Instructions

Definitions of total project costs for purposes of this program (state reimbursed, county cash contribution, and county in-kind contribution) can be found in the "Budget Considerations" page 22 of the Senate Bill (SB) 863, Construction of Adult Local Criminal Justice Facilities (ALCJF's) Request for Proposals (RFP). The county cash and in-kind contributions are collectively the county contribution. Those defined costs in the RFP shall be the guide for accurately completing this budget summary section.

In the Budget Summary Table that follows in part D of this section, indicate the amount of state financing requested and the amount of cash and/or in-kind contributions allotted to each budget line-item, in total defining the total project costs. It is necessary to fully include each eligible project cost for state-reimbursed, county cash, and county in-kind contribution amounts.

The in-kind contribution line items represent only county staff salaries and benefits, needs assessment costs, transition planning costs and/or current fair market value of land. An appraisal of land value will only be required after conditional award and only if land value is included as part of the county's contribution.

The total amount of state financing requested cannot exceed 90 percent of the total project costs. The county contribution must be a minimum of 10 percent of the total project costs (unless the applicant is a small county petitioning for a reduction in the county contribution amount). County contributions can be any combination of cash or in-kind project costs. Small counties requesting a reduction in county contribution must state so in part A of this section. The County contribution must include all costs directly related to the project necessary to complete the design and construction of the proposed project, except for those eligible costs for which state reimbursement is being requested.

State financing limits (maximums) for all county proposals are as follows. For proposed regional ALCJF's, the size of the lead county determines the maximum amount of funds to be requested for the entire project:

- **\$80,000,000** for large counties;
- **\$40,000,000** for medium counties; and,
- **\$20,000,000** for small counties.

A. Under 200,000 Population County Petition for Reduction in Contribution

Counties with a population below 200,000 may petition the Board of State and Community Corrections (BSCC) for a reduction in its county contribution. This proposal document will serve as the petition and the BSCC Board's acceptance of the county's contribution reduction, provided the county abides by all terms and conditions of this SB 863 RFP and Proposal process and receives a conditional award. The county (below 200,000 population) may request to reduce the required match to an amount not less than the total non-state reimbursable projects cost as defined in Title 15, Division 1, Chapter 1, Subchapter 6, Construction Financing Program section 1712.3. If requesting a reduction in match contribution, check the box below to indicate the county's petition.

By checking this box the county hereby petitions for a contribution reduction request as reflected in the proposal budget.

B. Readiness to Proceed Preference

In order to attest that the county is seeking the readiness to proceed with the proposed project, the county included a Board of Supervisors' resolution doing the following: 1) identifying and authorizing an adequate amount of available matching funds to satisfy the counties' contribution, 2) approving the forms of the project documents deemed necessary, as identified by the board to the BSCC, to effectuate the financing authorized in SB 863 3) and authorizing the appropriate signatory or signatories to execute those documents at the appropriate times. The identified matching funds in the resolution shall be compatible with the state's lease revenue bond financing. Additionally see Section 6 "Board of Supervisors' Resolution" for further instructions.

This proposal includes a Board of Supervisors' Resolution that is attached and includes language that assures funding is available and compatible with state's lease revenue bond financing. See below for the description of compatible funds.

County Cash Contribution Funds Are Legal and Authorized. The payment of the county cash contribution funds for the proposed adult local criminal justice facility project (i) is within the power, legal right, and authority of the County; (ii) is legal and will not conflict with or constitute on the part of the County a material violation of, a material breach of, a material default under, or result in the creation or imposition of any lien, charge, restriction, or encumbrance upon any property of the County under the provisions of any charter instrument, bylaw, indenture, mortgage, deed of trust, pledge, note, lease, loan, installment sale agreement, contract, or other material agreement or instrument to which the County is a party or by which the County or its properties or funds are otherwise subject or bound, decree, or demand of any court or governmental agency or body having jurisdiction over the County or any of its activities, properties or funds; and (iii) have been duly authorized by all necessary and appropriate action on the part of the governing body of the County.

No Prior Pledge. The county cash contribution funds and the Project are not and will not be mortgaged, pledged, or hypothecated by the County in any manner or for any purpose and have not been and will not be the subject of a grant of a security interest by the County. In addition, the county cash contribution funds and the

Project are not and will not be mortgaged, pledged, or hypothecated for the benefit of the County or its creditors in any manner or for any purpose and have not been and will not be the subject of a grant of a security interest in favor of the County or its creditors. The County shall not in any manner impair, impede or challenge the security, rights and benefits of the owners of any lease-revenue bonds sold by the State Public Works Board for the Project (the "Bonds") or the trustee for the Bonds.

Authorization to Proceed with the Project. The Project proposed in the County's SB 863 Financing Program proposal is authorized to proceed in its entirety when and if state financing is awarded for the Project within the SB 863 Financing Program.

C. California Environmental Quality Act (CEQA) compliance

Has the county completed the CEQA compliance for the project site?

Yes. If so, include documentation evidencing the completion (preference points).

Refer to the final Notice of Determination and letter from Humboldt County Counsel certifying the associated statute of limitations has expired and no challenges were filed.

No. If no, describe the status of the CEQA certification.

D. Budget Summary Table (Report to Nearest \$1,000)

LINE ITEM	STATE REIMBURSED	CASH CONTRIBUTION	IN-KIND CONTRIBUTION	TOTAL
1. Construction	\$ 17,133,000	\$		\$17,133,000
2. Additional Eligible Costs*	\$ 1,099,000	\$		\$1,099,000
3. Architectural	\$ 1,768,000	\$ 117,000		\$ 1,885,000
4. Project/Construction Management	\$	\$514,000		\$ 514,000
5. CEQA	\$	\$ 89,000		\$89,000
6. State Agency Fees**	\$	\$ 91,000		\$ 91,000
7. Audit		\$10,000	\$	\$ 10,000
8. Needs Assessment		\$39,000	\$	\$ 39,000
9. Transition Planning		\$	\$ 300,000	\$ 300,000
10. County Administration			\$ 62,000	\$62,000
11. Land Value			\$325,000	\$ 325,000
TOTAL PROJECT COSTS	\$ 20,000,000	\$ 860,000	\$687,000	\$ 21,547,000
PERCENT OF TOTAL	92.8%	4.0%	3.2%	100.00 %

* Additional Eligible Costs: This line item is limited to specified fees and moveable equipment and moveable furnishings (eligible for state reimbursement or cash contribution), and public art (eligible for cash contribution only)

** For State Agency Fees: State reimbursable costs include Real Estate Due Diligence only. State Fire Marshal fees may only be claimed as cash match.

Provide an explanation below of how the dollar figures were determined for each of the budget categories above that contain dollar amounts. Every cash contribution (match) line item shall be included with a reporting of the full amount budgeted unless a line item is not an actual cash contribution project cost for the county. (In that case, indicate so below.) For each budget category explanation below, include how state financing and the county contribution dollar amounts have been determined and calculated (be specific).

1. **Construction (includes fixed equipment and furnishings) (state reimbursement/cash match):** \$17,133,000 represents construction bid costs. The construction cost was prepared by a professional cost estimator and included escalation costs as prescribed by the State.
2. **Additional Eligible Costs (specified allowable fees, moveable equipment and furnishings, and public art)**
 - a) **Define each allowable fee types and the cost of each:** Plan Check: \$65,000; Special Testing/Geotech: \$90,000; Commissioning: \$50,000; Fees and Permits: \$170,000.

- b) **Moveable equipment and moveable furnishings total amount:** \$724,000.
- c) **Public art total amount:** \$0

3. Architectural(state reimbursement/cash match):

- a) **Describe the county's current stage in the architectural process:** The County has completed conceptual designs and programming to respond to the program space and bed needs identified in the 2015 Needs Assessment Update. If awarded, the County will proceed with schematic designs utilizing the cash contribution allocated for architectural.
- b) **Given the approval requirements of the State Public Works Board (SPWB) and associated state reimbursement parameters (see "State Lease Revenue Bond Financing" section in the RFP), define which portions/phases of the architectural services the county intends to seek state dollar reimbursement:** The County will be seeking reimbursement of architectural/engineering (A/E) services and fees beginning after the project is established by the SPWB.
- c) **Define the budgeted amount for what is described in b) above:** A/E Fees: \$1,885,000; (State Reimbursed: \$1,768,000; Cash Contribution: \$117,000).
- d) **Define which portion/phases of the architectural services the county intends to cover with county contribution dollars:** Validate programming, prepare schematic design and outline specifications, and site adapt building.

Define the budgeted amount for what is described in d) above: Validate programming: \$15,000; schematic design, site adapt, and outline specifications: \$102,000.

- 4. **Project/Construction Management - Describe which portions/phases of the construction management services the county intends to claim as:**
 - a) **Cash** \$514,000
 - b) **In-Kind**
- 5. **CEQA – may be state reimbursement (consultant or contractor) or cash match** \$89,000 (Cash Match).
- 6. **State Agency Fees – Counties should consider approximate costs for the SFM review which may be county cash contribution (match). \$16,000 for the due diligence costs which may be county cash contribution (match) or state reimbursement. \$16,000 for due diligence cost (Cash Match); \$75,000 State Fire Marshal (Cash Match).**
- 7. **Audit of Grant - Define whether the county is intending to use independent county auditor (in-kind) or services of contracted auditor (cash) and amount budgeted:** County will employ an independent auditor, \$10,000 (Cash Match).
- 8. **Needs Assessment - Define work performed by county staff (in-kind), define hired contracted staff services specifically for the development of the needs assessment (cash match) :** \$39,000 prepared by professional consultant for this SB 863 Project (Cash Match).

9. **Transition Planning – Define work performed by county staff (in-kind), define the staff hired specifically for the proposed project (cash match):** \$300,000 In-Kind for salaries and benefits for Sheriff's team members to lead the facility design needs, monitor construction for security risks, prepare policies and procedures, conduct facility systems training, conduct operational training for staff, stage phase occupancy of the building.
10. **County Administration – Define the county staff salaries/benefits directly associated with the proposed project.** \$62,000 for salaries and benefits to administer the contract from award to project closeout.
11. **Site Acquisition - Describe the cost or current fair market value (in-kind):** \$325,000 (In-Kind) for County-owned vacant property adjacent to the County Jail and Courthouse. Appraisal prepared by Nilsen Appraisal Services.

SECTION 3: PROJECT TIMETABLE

Prior to completing this timetable, the county must consult with all appropriate county staff (e.g., county counsel, general services, public works, county administrator) to ensure that dates are achievable. Please consult the "State Public Works Board (State Capital Outlay Process)/Board of State and Community Corrections Processes and Requirements" section, page 30 of the RFP for further information. Complete the table below indicating start and completion dates for each key event, including comments if desired. Note the required time frames for specific milestone activities in this process. The BSCC Board intends to make conditional awards at its November 2015 board meeting.

KEY EVENTS	START DATES	COMPLETION DATES	COMMENTS
Site assurance/comparable long-term possession <u>within 90 days of award</u>	11/12/2015	2/12/2016	County Owned Property
Real estate due diligence package submitted <u>within 120 days of award</u>	11/12/2015	3/1/2016	
SPWB meeting – Project established <u>within 18 months of award</u>	11/12/2015	3/15/2016	
Schematic Design with Operational Program Statement <u>within 24 months of award</u> (design-bid-build projects)	1/1/2016	3/30/2016	
Performance criteria with Operational Program Statement <u>within 30 months of award</u> (design-build projects)			
Design Development (preliminary drawings) with Staffing Plan	4/18/2016	5/10/2016	
Staffing/Operating Cost Analysis approved by the Board of Supervisors	1/1/2016	2/28/2016	
Construction Documents (working drawings)	5/15/2016	8/1/2016	
Construction Bids or Design-Build Solicitation	8/9/2016	9/20/2016	
Notice to Proceed <u>within 42 months of award</u>	10/15/2016	10/15/2016	
Construction (maximum three years to complete)	11/15/2016	6/15/2018	
Staffing/Occupancy <u>within 90 days of completion</u>	6/15/2018	9/14/2018	

SECTION 4: FACT SHEET

To capture key information from Section 5: Narrative, applicants must complete this Fact Sheet. Minimal information is requested. Narrative information or explanations are not to be included on this Fact Sheet nor as part of the tables in this section. Explanations of what is provided in these tables may be included in the Narrative section of the Proposal Form. Proposal narratives may include reference back to one or more of these specific tables (e.g., refer to Table 4 in Section 4 Fact Sheet).

Table 1: Provide the following information

1.	County general population	136,779
2.	Number of detention facilities	1
3.	BSCC-rated capacity of jail system (multiple facilities)	417
4.	ADP (Secure Detention) of system	349
5.	ADP (Alternatives to Detention) of system	266
6.	Percentage felony inmates of system	90.0%
7.	Percentage non-sentenced inmates of system	60.7%
8.	Arrests per month	669
9.	Bookings per month of system	837
10.	"Lack of Space" releases per month	76

*Covers calendar year 2014

Table 2: Provide the name, BSCC-rated capacity (RC) and ADP of the adult detention facilities (type II, III, and IV) in your jurisdiction (county)

	Facility Name	RC	ADP*
1.	Humboldt County Correctional Facility (Type II)	417	349
2.			
3.			
4.			
5.			
6.			
7.			
8.			

*Average daily population for 2014.

Table 3: List the current offender programming in place and the ADP in each program

Pre-Trial Program		ADP
1.	Educational/GED	3
2.	Framework For Recovery	3
3.	Spirit of Freedom	2
4.	Narcotics Anonymous	6
5.	Alcoholics Anonymous	6
6.	Celebrate Recovery	3
Sentences Offender Program		ADP
1.	Educational/GED	15
2.	Seeking Safety (Substance Abuse)	13
3.	Getting Started With Computers	15
4.	High School Equivalency Test Preparation	15
5.	Anger Management	15
6.	Ready, Set, Go to College!	10

Table 4: List of the offender assessments used for determining programming

Assessment tools		Assessments per Month
1.	Static Risk Assessment (STR 2.0, Part of STRONG)	15
2.	Offender Needs Guide	20
3.	In-House Sheriff's Work Alternative Program Assessment	47
4.		
5.		
6.		

1. STATEMENT OF NEED

What are the safety, efficiency, and offender programming and/or treatment needs addressed by this construction proposal? Please cite findings from the needs assessment (through 2019) submitted with this proposal.

Summary Overview

The County's 2015 Needs Assessment Update has identified several space needs Humboldt County should immediately consider and use to request SB 863 funding to help the Sheriff's Office correct the deficiencies. The consultants specifically identified a need to develop (1) mental health treatment beds and staff support space that is devoted to support functions and service activities for HCCF's mental health and substance abuse clinical staff assigned to the facility, and (2) construct a reentry housing unit with adjacent program space which would be used for implementing a new Jail transitional reentry program for both male and female inmates about to transfer back to the community after being incarcerated in the County Jail. With the shift which has occurred under the AB 109 Realignment Act which is bringing multi-year sentenced felony inmates to County Jail, additional specialized reentry housing with multiple programs / support spaces would provide a greater degree of flexibility in being able to assist offenders with employment, housing, drug use, or other problems who are about to be transitioned from HCCF to the community. This reentry housing would provide a "step down" short-term, highly structured and service focused custody environment for this population of detainees and could also make available these services across the various inmate security classifications. Correcting these space deficiencies clearly aligns with the legislature's approach and intent in SB

863 and expectations for how counties should handle and process the AB 109 Realignment inmates and other high-risk offender populations. The SB 863 funding would be the first State lease revenue bond financing the Sheriff's Office has received under the State's Adult Local Criminal Justice Facilities Construction Program.

Humboldt County Jail System

The Humboldt County Sheriff's Office operates the County's only Type II jail facility located in downtown Eureka. The jail (Humboldt County Correctional Facility) was built in two phases, in 1996 and 1997. The Main Jail has a Board of State and Community Corrections (BSCC) rated capacity for 417 inmates. Since October 2011, the jail houses AB 109 Public Safety Realignment Act County Jail Prison (N3), 3056 PC parolees, Post-Release Community Supervision (PRCS) offenders, and flash incarceration Probation Department offenders.

The jail is the central booking point for all regional law enforcement agencies for adult males and females arrested in Humboldt County. The jail is a full service adult detention facility containing space for (a) vehicle sallyport, (b) intake and release, (c) inmate housing and dayrooms, (d) visiting, (e) medical / mental health services, (f) inmate programs, (g) food services, (h) laundry, (i) visitor and staff circulation, (j) Central Control operations, (k) maintenance and storage, (l) outdoor recreation, and (m) jail administration. The Humboldt County Correctional Facility (HCCF) consists of both cells and dormitory housing settings. In 2014, HCCF had an average daily population of 349 pretrial and sentenced inmates.

Humboldt County Correctional Facility (HCCF)	
Correctional Facility Profile	Correctional Facility
Physical Plant Characteristics:	
Year Initially Constructed Phase I	1996
Construction Type	Mid-rise Building
Number of Stories	4
Exterior Walls	CMU / Concrete
Interior Walls	CMU / Concrete / Gypsum
Year Initially Constructed Phase II	1997
Construction Type	High-rise Building
Number of Stories	6
Exterior Walls	CMU / Concrete
Interior Walls	CMU / Concrete / Gypsum
Custody Housing Classifications:	Maximum / Medium / Minimum Security
Type of Inmate Cells:	Single & Double Occupancy Cells and Dormitory Units
Bed Inventory:	
BSCC Rated Capacity	417
Operating Capacity (80% of rated bunks)	334
Average Daily Inmate Population (ADP):	349 (2014)
Males	301
Females	48

Humboldt County has taken significant steps to maximize use of recognized pretrial and post-sentence alternatives to incarceration programs and innovative case processing practices in an effort to avoid detention system overcrowding. The Sheriff's Office has developed three major alternatives to incarceration programs and early release protocols for incarcerated inmates. The programs are being implemented in response to the impact the AB 109 Realignment legislation is having on the County's only jail facility. The three alternative programs being stressed include (1) *Jail Citation Release*, (2) *Sheriff's Work Alternative Program (SWAP)*, and (3) *Probation/Sheriff Pretrial OR and Supervised Release (with GPS Monitoring)*.

The expanded use of citation release allows misdemeanants to remain in the community, and eliminates an unnecessary burden on the jail. Low- and medium-risk

sentenced offenders (including AB 109 inmates) who are incarcerated have the ability to complete their sentence through the SWAP Program regardless of the length of confinement time. The Probation/Sheriff's Pretrial OR and Supervised Release Program allows local incarcerated offenders to participate in the GPS electronically monitored (EM) alternative to incarceration program. The Pretrial/OR Program consists of a whole range of options, from no EM and a Court date reminder call all the way to very restrictive GPS – all based on risk level to reoffend/FTA per the ORAS-PAT tool. Additionally, Probation utilizes EM/GPS as an intermediate sanction in lieu of jail booking on technical violations to reserve jail space for the highest risk offenders. The program is considered a constructive custody alternative. Participants are accountable for all of their time 24-hours a day, seven-days-a-week and may only leave their residence for work, school, and other pre-approved appointments.

In addition, the local justice system has implemented intensive supervision programs and Probation Day Reporting Center (DRC) which has been designed around national best practice research. All of these program modifications have allowed qualified offenders to fulfill their sentences without occupying jail beds. The Probation Department has also adopted the practice of recommending split sentences for AB 109 offenders under Section 1170(h) of the Penal Code as often as possible, which further reduces the need for long-term bed space in the County Jail which allows offenders to spend a significant portion of their custodial time out in the community. Probation also utilizes flash incarceration to ensure continued compliance with probation terms. Since flash incarceration is limited to a maximum of ten days in the jail, this program operates as an alternative to incarceration by providing a graduated intermediate sanction

process to encourage compliance rather than simply rebooking offenders who are failing probation into the jail to serve the remainder of their terms. *Through these alternatives to incarceration programs and population management policies, the Sheriff's Office and Humboldt County's criminal justice system have been able to avoid overcrowding in HCCF.*

Jail Needs Assessment Update Findings

Based on their physical plant assessment and operational evaluation, the Needs Assessment consultant team has shown that the HCCF facility has some important and critical needs with respect to custody beds and program services support space. The major space deficiencies include:

1. Mental Health Staff Support Space – HCCF does have a small area that is devoted to staff support functions and related service activities for the Jail's Department of Health and Human Services (DHHS) mental health and alcohol / drug clinical staff assigned to the detention facility. The current space and area configuration barely meets the current needs of the staff who work in this area. As the AB 109 longer term sentenced offender population continues to be housed in the facility, mental health and substance abuse service requests have increased. As DHHS and the Jail bring on additional staff and other personnel to provide these types of services and any expanded programming at the facility, the space these support staff currently occupy will increasingly become more inadequate.
2. Jail Community Reentry Housing Unit – With changing inmate populations involving longer term sentenced AB 109 Realignment offenders being housed

in HCCF and in light of the local criminal justice system's clear commitment to expand evidence-based treatment programs, the Jail has a new and high priority need for a small number of different custody beds with dedicated program space. Specifically, the facility lacks any housing and adjacent program space which could be used for implementing a transitional reentry housing unit for male and female inmates about to be released from jail.

The only transitional housing currently available in HCCF involves one small dormitory of outside inmate workers which is located inside the Jail's secured perimeter. These workers complete community work assignments six days a week and return to the Jail as part of the Sheriff's Cal-Trans Program. The location of the dormitory creates a continual problem for contraband trafficking into the facility. In order for the Jail to expand the community transitional process for more inmates and be able to offer a structured "best practice" assessments and supportive reentry service programming - more counseling, education, and other adjacent program space is needed.

Best practices suggest that reentry services should begin when someone is still in jail and continue when they return to the community. Currently, the AB 109 incarcerated inmate population and other local inmates will leave the Jail facility with little or no follow-up assistance. Most need assistance with employment, housing, drug use, or other problems before they were booked into the Jail and most still have service needs when released from detention. Implementation of a Jail Reentry Services Program

must take place simultaneously with the development, expansion, and implementation of in-custody cognitive behavioral counseling, drug treatment, and employment preparation assistance services.

3. Mental Health Treatment Beds – With the implementation of the AB 109 legislation, HCCF has a critical need to add specialized mental health treatment beds for incarcerated offenders with serious psychiatric disorders. Currently, HCCF has an average daily population on the last day of each month of 152 inmates being seen by the facility’s clinical staff as a open mental health case. On the average, mental health staff assigned to the jail are opening 79 new cases each month and an average of 67 inmates are receiving psychotropic medications on the last day of each month.

Humboldt County Correctional Facility (HCCF) Average Monthly Number of Jail Inmates Receiving Mental Health Services 2012 - 2014				
Mental Health Services	2012	2013	2014	2012-14
Number of Mental Health cases open on last day of month	115	162	178	152
Number of new Mental Health cases opened during month	95	85	57	79
Number of inmates receiving psychotropic medications on last day of month	67	74	59	67

HumboldtNA2015/Tables&Chts/Table17

With nearly half of the jail’s pretrial and sentenced inmate population receiving mental health screenings, crisis counseling services, or psychotropic medications, the detention facility has a significant need for dedicated mental health treatment beds for inmates showing more serious

psychiatric disorders. Such beds would allow the mental health clinicians to better monitor, observe, and interact at a higher level compared to what currently takes place in the facility because of the lack of mental health treatment beds and specialized programming and support areas.

Areas to be Improved With SB 863 Proposed Construction Project

Based on the Needs Assessment Update work, the consultant team recommended that because all of these needs clearly meet the funding criteria contained in SB 863, the Sheriff's Office make application to the BSCC for construction funding to help the County address these critical space needs in its jail detention system. The consultants, along with HCCF staff, believe these changes at the County Jail would improve the secure operations and conditions at the facility and provide a greater and more comprehensive array of available programming for local incarcerated inmates. Other improvements the SB 863 construction project will make include the following:

- Sheriff's Reentry / Mental Health Treatment Housing and Inmate Program Space – Operationally, the proposed Community Corrections Reentry Resource Center will allow the Humboldt County criminal justice system to consolidate the community's limited, but essential, mental health, drug counseling, employment assistance, life skills, and other important resources for assisting offenders into one primary prominent downtown location. This will bring about a more cost-effective and efficient use of these types of important resources for the Sheriff, Probation Department, and the Courts. The space will also allow for expanded growth and integration of other "best

practices” services at this site. By co-locating the core justice agencies and offender service programs together as the project will accomplish, there will be even greater opportunity to supervise offenders and address pressing problems including substance abuse, transitional housing, benefit eligibility assistance, transportation, and employment preparation needs of both local probationers, AB 109 in-custody inmates, and out-of-custody offenders.

The reentry custody beds will work for both pretrial and sentenced inmates who can benefit from “step down” reentry assessments and services in preparation for returning to the community. The reentry transitional housing component will provide offenders with skills and resources necessary to make the transition from an institutional setting to independent and responsible living in the community. The adjacent new programming space will allow the Sheriff’s Office to also begin providing a wide range of evidence-based programs and life skills assistance for inmates acclimating to the community prior to release.

- Humboldt County Department of Health and Human Services Mental Health Suite – The construction project will also add a mental health treatment housing unit with staff support space and program area. These beds will allow DHHS mental health clinicians and substance abuse counselors to better monitor, observe, and interact at a higher level compared to what currently takes place in the facility because of the lack of mental health treatment beds and specialized programming and support areas. The mental health function included within the Center will supplement and replace

portions of the existing areas at the adjacent County Jail. The current mental health area at the Jail is extremely undersized to serve the current population. The adjacency of the new mental health treatment unit provides the opportunity for provider staff to serve both facilities.

- Humboldt County Probation Day Reporting Center (DRC) - The Probation Department's Day Reporting Center, currently located in an older leased facility in downtown Eureka, will be moved into the new building. The Day Reporting Center currently supervises the Department's high-risk PRCS and local probationer populations. The Probation Department works with DHHS in providing needed mental health and substance abuse assessments, counseling services, and other related programming for these offender groups. DHHS staff also are responsible for providing employment assistance and job placement services to these local offenders. The conceptual design for the Center provides a variety of spaces to accommodate the various agencies and functions collaborating with the DRC with the flexibility required to carry out current and future offender supervision and programmatic needs. The DRC will be located on the site where probationers and the public have clearly identified access and distinct separation from any secure portions of the new building. There are primarily two distinct functional areas the Center provides for the DRC including an administrative staff area and program areas for supervision activities, treatment, and intervention services to be carried out.

- Sheriff's Office's Alternatives to Incarceration Programs - The Sheriff's Office's SWAP Program will also have the ability to expand programming and needed services to their out-of-custody offenders participating in the alternative work program. The Reentry Resource Center will serve these out-of-custody offenders from this same location.

The project also accommodates secure staff parking, reduces traffic and deliveries to the Main Jail, and more clearly defines the public and secure areas surrounding the jail site. This will simplify the overall management and security of site-related issues. Utilizing the SB 863 funding source to co-locate and construct the Probation Day Reporting Center and Sheriff's Department's Work Release Program and other alternatives to incarceration will improve program completion rates and generally enhance public safety.

2. SCOPE OF WORK

Describe the areas, if any, of the current facility to be replaced or renovated, and the nature of the renovation, including the number of cells, offices, classrooms or other programming / treatment spaces to be replaced or added and the basic design of the new or renovated units.

Summary Overview

With SB 863 funding, the County will be able to construct a new, stand-alone Community Corrections Resource Center at the North end of HCCF. The Reentry Resource Center will serve both in-custody and alternative custody male and female offenders supervised in the community. The multi-functional Center would co-locate the Sheriff's Office's Jail alternative programs, the Probation Department's Day Reporting Center, and Department of Health and Human Services (DHHS) Behavioral Health clinical mental health and substance abuse

counseling staff. The facility would include a new 38-bed community transitional reentry inmate housing unit with expanded dedicated programming spaces specifically arranged to accommodate evidence-based service programming. The Center would also include a dedicated six-bed mental health treatment housing unit with adjacent program space and support areas for counselors assigned to the new unit for a 44-bed total. Construction of the Center will fulfill a critical need of the County's criminal justice system and provide a safe, highly-structured and service-focused environment where offenders of all security classifications can receive services and participate in expanded mental health, education, drug counseling, life skills development, and inmate reentry services / programming space.

Scope of Project Construction

The Humboldt County Community Corrections Reentry Resource Center Project is a 23,712 SF multi-purpose facility that will accommodate a variety of functional uses. Although the facility will be located adjacent to HCCF (see site plan on following page) and primarily operated by the Sheriff's Office, overall management of the new Center is a collaborative partnership with Probation, DHHS, contracted services providers, and the Courts. The conceptual design provides the spaces to accommodate the various agencies and functions with the flexibility to address current and future offender program/service needs.

The building will consist of two stories. The first floor will respond primarily to out-of-custody offenders and will contain public areas, shared reception, toilet rooms, elevator, conference rooms, officer's work stations, classrooms, group rooms, storage,

janitor's closet, electrical room, IT space, break room, interview rooms, and circulation corridors.

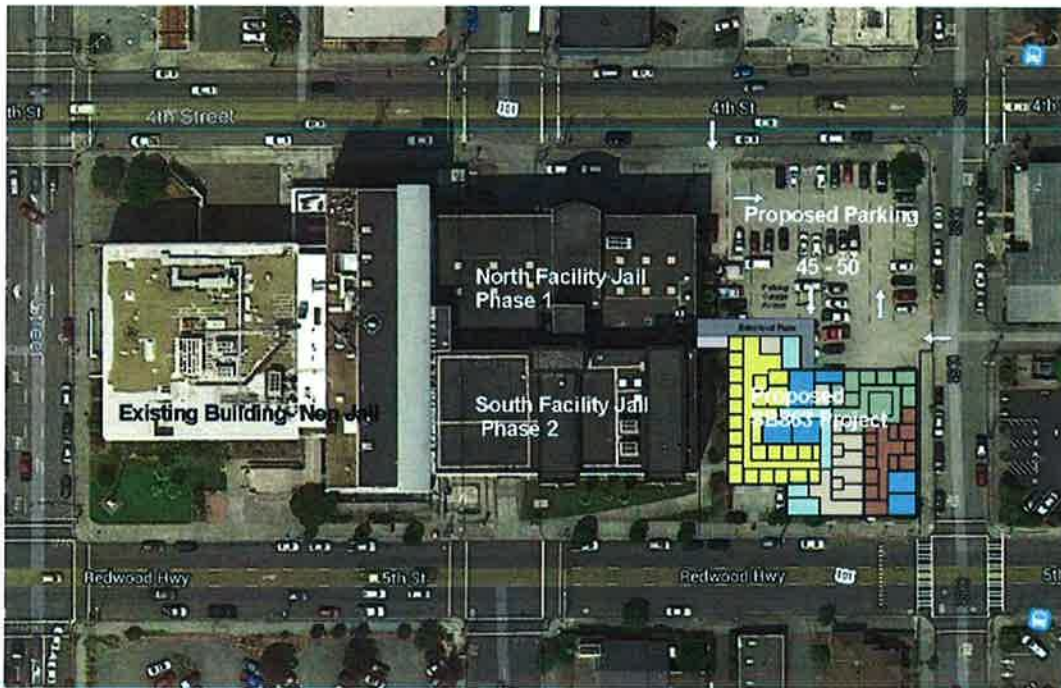

The second floor will house community reentry offenders during non-work hour work programs and includes a separate mental health treatment unit with dedicated program and staff support space which will accommodate six inmates with identified serious psychiatric disorders. The housing is designed for flexible separation of inmate populations.

The housing area will include outdoor exercise, dayrooms, showers and toilets, program rooms, medical screening room, mental health offices, work room, reception, break room, dental space, and medication storage room. The outdoor exercise yards will be covered and fresh air louvered to allow year-around activities during all seasons. The building will be primarily independent of the existing jail and all services and

systems will be new and dedicated to this project. A secure circulation bridge will connect the new facility to the existing jail facility for laundry and meal service. The building will be served by a parking garage and adjacent lot with approximately 74 parking spaces.

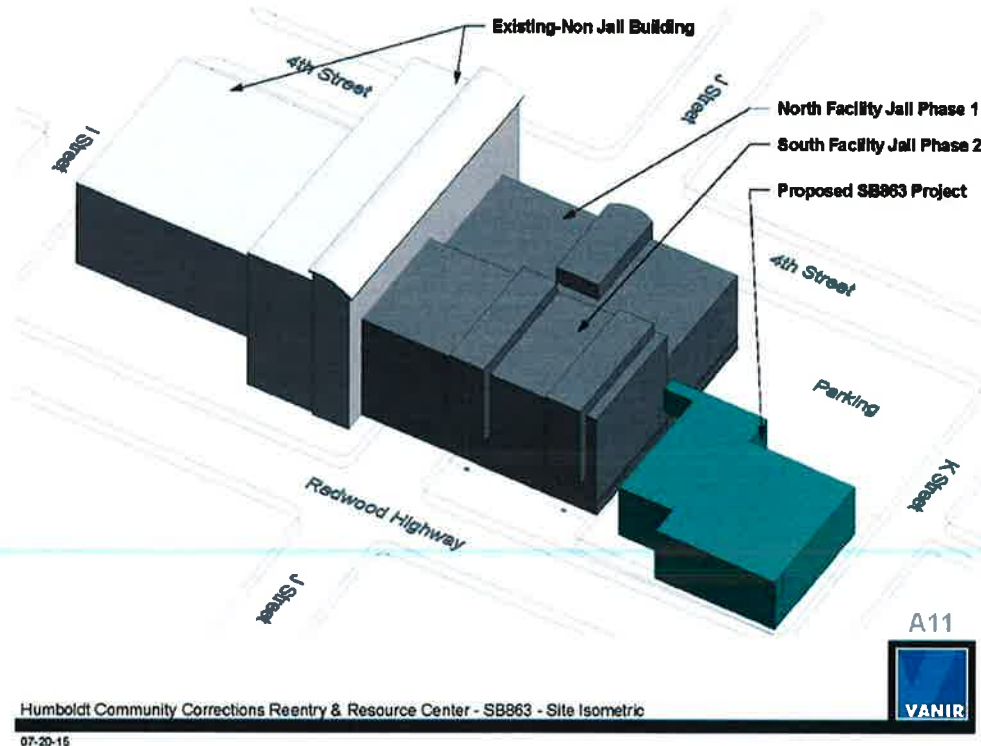

The adjacency of the Center to the existing Jail provides the opportunity to serve the campus and reduce current problems with contraband control. The Mental Health function included within the expansion concept will also supplement and replace portions of the existing areas at the adjacent Main Jail. The current mental health area at the Jail is extremely undersized to serve the current population. There is relatively little to no administrative space at the existing facility. The adjacency of this new project provides the opportunity for provider staff to serve both facilities. The proposed design provides spaces to accommodate the various functions of a mental health suite.

Probation's Day Reporting Center (DRC) will be located on the site where out-of-custody offenders and public have clearly identified access and distinct separation from any secure portions of the campus. There are primarily two distinct functional uses in the DRC including an administration area for staff and programs for out-of-custody treatment. A critical component of the new building is the Sheriff's project area for assigned offenders to receive their work assignment and is conveniently located on site with separate entry. The space is intended to consolidate administration and monitoring of all criminal justice alternative programs the agencies are managing.

A primary area within the new facility is the Reentry component and support services. The new expansion includes beds/bunks, but particular transitional beds that accommodate a specific inmate profile who can benefit from structured programs prior to returning to the community. The in-custody beds can also be used for additional classifications. There is one 28-bed and one-10-bed dormitory style housing units mirrored in plan to each other. The plan is to utilize an indirect supervision model at a fixed position for staff efficiency. The podular dormitory design of the housing will provide the facility segregated dormitories with additional flexibility for security and classification purposes. Multiple program rooms (3) are currently envisioned to allow a variety of intense and structured programs be implemented. *(See Attachments 1 - 4: Aerial Site Plan, Overlay, and Space Layout for the Humboldt County Community Corrections Reentry Resource Center)*

A key component of the proposed construction (multiple program space and classrooms) will allow the Sheriff's Office to begin providing a continuum of reentry services that starts in the County Jail when AB 109 and other local inmates transition

into the community. Currently, inmates leave the jail facility with little or no follow-up assistance. Most need assistance with employment, housing, drug use or other problems before they were booked into the jail and most still have service needs when released from detention. The planned construction will give the Sheriff's Office its very first opportunity to develop and implement a "step down" housing arrangement with appropriate program space for reentry services. The housing and new program areas will provide an extraordinary amount of flexibility in addressing identified offender service needs. The services will target factors that are linked to reoffending such as substance abuse, anti-social personality and hostility or anger. The discharge process would begin at least 30 – 45 days prior to release. The discharge interventions would include assessments, employment preparation classes, assistance with transportation, housing, and securing the identification documents which will aid in determining eligibility for other key financial support services.

Consolidating the various programs and alternatives into one central location and making a one-stop-shop approach available for inmates, agencies, and service providers will improve service delivery, inmate supervision, and will be cost-effective over time. Integrating justice agency support staff in one location and facility is more efficient to operate, particularly in minimizing Sheriff's operational costs.

The proposed project also clearly aligns with the legislature's approach in SB 863 and expectations for how counties should handle and process the new AB 109 Realignment offender populations. *A total of five varying-sized program areas and classrooms will be located on the first floor and three program areas will be included on*

the second floor of the Center. Other space that is planned for the two-story building is shown in the following Table.

Humboldt Community Corrections Reentry Resource Center	
Area Description	Square Feet
Area Summary – First Floor	11,856
1. Sheriff's Work Alternatives Program	3,948
2. Department of Health and Human Services	2,728
3. Probation	5,181
Area Summary Second Floor	11,856
1. Mental Health	1,850
2. Offender Program Rooms	1,905
3. Female Housing	2,585
4. Male Housing	5,516
Total Area	23,712

The programming and inmate support spaces designed for the Center incorporates what criminal justice research is showing will aid in reducing offender recidivism and controlling crime in local jurisdictions. The Center will also will provide the County's Court system with more options, intermediate sentencing sanctions, and alternatives involving both pretrial and sentenced offenders.

3. PROGRAMMING AND SERVICES

Describe the programming and/or treatment services currently provided in your facility. Provide the requested data on pretrial inmates and risk-based pretrial release services. Describe the facilities or services to be added as a result of the proposed construction; the objective of the facilities and services; and the staffing and changes in staffing required to provide the services.

Summary Overview

Currently, offender programming in HCCF takes place in relatively small single classrooms attached to each housing unit. The multi-purpose space can only hold approximately 10 – 15 individuals at a time, which restricts the number of inmates who can take part. The Jail's inmate programs are offered and delivered on a scheduled basis seven-day-a-week. All classes are available on a first

come, first serve basis, but may not be available based on an inmate's classification level. When new and expanded program space becomes available in the new Community Corrections Reentry Resource Center, the specific best practice program components the Sheriff's Office wants to use and will develop involve evidence-based, cognitive behavioral counseling, and other rehabilitative programming and services. The added program rooms will also permit the Sheriff to develop new vocational training programs which will allow inmates to learn trades, thereby increasing their chances for employment whether they are incarcerated or supervised in the community in one of the alternative programs the County has developed. With increased programming and service space, the Sheriff's Office will also direct staff resources to identifying and working with community and correctional programs that can assist with post-release services and coordinate individual offender Jail exit transition plans to ensure implementation and avoid service gaps in treatment that is initiated while incarcerated in HCCF.

Current Programs and Services

In-custody programming is extremely limited by the population classification system and the overall lack of reentry programming space in the current jail footprint. The ability to isolate a group that could do programming in a single part of the jail is made far more complicated because of the current layout. It is difficult to isolate a specific housing unit for transitional reentry programming, for example, because of the classification barriers. The shortage of jail space also leads to a lack of efficacy in the classes/services as well as an inability to maintain a consistent programming schedule.

Current available classes and programs include (a) *Spirit of Freedom Ministry*, (b) *Arcata Interfaith Choir*, (c) *Full Gospel Choir*, (d) *GED classes*, (e) *Effective Parenting*, (f) *Job Readiness*, (g) *Substance Abuse Prevention and Anger Management*, (h) *AA/NA*, (i) *Celebrate Recovery Ministry*, (j) *Framework for Recovery*, and (k) *Drug Court Groups*. These core services are available to both male and female detainees. The anger management and substance abuse prevention services are provided by trained clinical staff assigned to the Jail through the Humboldt County Department of Health and Human Services (DHHS). HCCF's educational services are provided through the Adult Education / High School Diploma Program which is offered at the detention facility through Eureka Adult Education.

One of the key evidence-based programs the jail is currently offering is called "Seeking Safety." The counseling program is designed to help individuals attain safety from trauma and/or substance abuse. It directly addresses both trauma and addiction. The program model is highly flexible and can be conducted in group or individual formats for both men and women. The "Seeking Safety" curriculum offers 25 topics that can be conducted in any order as time allows that include: *Introduction/Case Management*, *Safety*, *PTSD: Taking Back Your Power*, *When Substances Control You*, *Honesty*, *Asking for Help*, *Setting Boundaries in Relationships*, *Getting Others to Support Your Recovery*, *Healthy Relationships*, and *Recovery Thinking*. One of the Sheriff's Office's new partnering agencies for inmate programs and services is the College of the Redwoods Adult Education Programs. The Sheriff's Office and the College are offering new classes that inmates are signing up for based on postings in

the facility's housing units. The programs include (a) *Getting Started With Computers*, (b) *High School Equivalency Test Preparation*, and (c) *Ready, Set, Go to College*.

Pretrial Inmates and Risk-Based Pretrial Release Services

Over the period January 1, 2013 through December 31, 2013, the Humboldt County Jail had an average daily population (ADP) of 370 inmates. The ADP of inmates on pretrial status over this period was 239. As the data indicated, the percentage of inmates on pretrial status for this time period was 64.6%.

In response to impacts on HCCF resulting from the AB 109 Realignment Act, the CCP funded the development and implementation of a new jail Pretrial OR Release and Supervised Release Program targeting pretrial detainees. The Program is staff by both Sheriff's Office and Probation personnel who are located at the downtown Main Jail and Day Reporting Center Program. The staff provide five days a week pretrial screening of detainees booked into HCCF. The Program staff screen bookings using the Ohio Pretrial Release Evidence-based Assessment Tool. The validated Ohio Risk Assessment System – Pretrial Assessment Tool (ORAS-PAT) Instrument is also currently being used by the Jail to screen all fresh arrests to identify individuals who can be released on their own recognizance (OR) pending an arraignment. The Court also has given the Sheriff the authority to adjust the release cut-off on the Assessment Tool when the jail population rises above or falls below 90.0% of the Board of State and Community Corrections (BSCC) rated capacity (gender specific) for the Humboldt County Correctional Facility.

Currently, the Jail's Pretrial OR Release Program is completing an average of 543 assessments each month at HCCF. Based on the Assessment work, the Superior

Court is approving an average of 44 pre-arraigned and Court-arraigned defendants for an OR release from the detention facility. In July 2015, the Probation Department, for example, was supervising 63 OR released defendants and six other individuals who were on pre-sentenced supervision through the Electronic Monitoring component of the program.

Facilities and Services to be Added as a Result of the Proposed Construction

Analysis of local offender risk and needs assessment data shows education levels, work history, job readiness, drug and alcohol abuse history, and physical/mental health issues vary widely. What the analysis shows, however, is that two out of five jail inmates have not earned a high school diploma or a General Education Development (GED) certificate. Three of every four offenders released have a substance abuse problem and more than one out of three report some form of physical or mental disability. Fifth-five percent have children under the age of 18 who often depend on them for some financial support. Only one out of five have had sustained employment. These deficits and limitations create substantial challenges for people who are released from jail into the community. Other data also shows the level of programming and services at the jail is continually encountering pretrial and sentenced inmates needing mental health and healthcare services.

In total, the data clearly demonstrates offenders placed in local County Jail custody, community supervision, and treatment programs have high needs in the area of (a) substance abuse, (b) mental health issues, (c) lack of vocation/educational skills, (d) post-release homelessness, (e) job development and supportive employment, (f) medical issues, (g) psychotropic medication management and monitoring, and (h) help

in accessing and completing eligibility documentation for Federal/State financial assistance programs.

The proposed Community Corrections Reentry Resource Center with multiple in-custody and out-of-custody program rooms would provide much needed educational and reentry program opportunities for the entire jail population and out-of-custody offenders and probationers living in the community. By adding additional vocational training space and combining the administration of existing alternative programs in one centralized building, these new program spaces will serve a much greater portion of the local offender population with expanded offerings and many more hours of program participation.

The overall operational goal and objective for building the new Center is to bring about an appropriate blending of criminal justice supervision and evidence-based treatment strategies that maintain, but then improve, community public safety through recidivism rate reductions that ultimately lead to long-term crime rate reductions. A key element that Humboldt's jail system currently lacks concerns jail reentry services for inmates transitioning from incarceration back to their community. The Sheriff's Office and the local CCP have consistently expressed a strong interest to develop and implement when additional dedicated inmate program space becomes available to the jail system, a structured jail reentry housing unit and services program as proposed in this application.

The future programming that will be conducted in the proposed spaces includes *evidence-based (1) Thinking-For-a-Change, (2) Moral Reconciliation Therapy (MRT), (3) mental health and suicide prevention, (4) a life skills program, (5) employment*

preparation and job assistance, (6) substance abuse treatment and counseling, (7) anger management, (8) child abuse and parenting, (9) computer literacy, and (10) a victim impact program. In addition, the proposal includes a plan to provide offenders with access to housing stabilization services and assistance with obtaining public assistance and other benefit eligibility services. Out-of-custody offenders requiring mental health treatment, individual/group therapy and counseling as well as other supportive services will also be able to be served in the new programming space. One of Probation's cognitive behavioral interventions that will also be used is "Effective Practices in Community Supervision (EPICS). Local DHHS and Probation staff have been trained by the University of Cincinnati in their cognitive behavioral therapy substance abuse program.

The Sheriff's Office's Custody Division has also been working for the past year to put together an agreement on a broad range of future program classes which can be carried out in the facility when additional program space becomes available through the College of the Redwoods. The programming would include health education, parenting / family education, vocational training, and other adult education curriculum that would offer inmates basic to advanced certificate classes. This specific planning which is taking place focuses on being able to offer through the College of the Redwoods the following future classes:

- Health Education – including classes that cover (a) health and wellness, (b) nutrition basics, (c) health benefits of music, (d) substance abuse/addiction studies, and (e) anger management.

- Parenting/Family Education – including classes that cover parenting strategies / family relationships, and (b) fathering skills.
- Vocational – including classes that cover (a) plant cultivation, (b) landscape construction, (c) introduction to basic landscaping, (d) gardening with specialty plants, (e) introduction to animal care, (f) orientation to food services, (g) institutional food preparation, (h) career planning / marketing for the artist / designer or the business of art, and (i) custodian maintenance.

The cost of existing program services is being provided by the agencies and public / private organizations who are delivering the programming / services in the County Jail. The College of the Redwoods has also agreed to continue providing ongoing funding for future classes and vocational training programs offered through the proposed SB 863 Reentry Resource Center.

Staffing For Jail Programming, Treatment Services and Housing

The Jail's compliment of community service providers including the County Department of Health and Human Services (DHHS) will continue to support programming needs at the detention facility. DHHS's Behavioral Health Division will work with the Sheriff's Office to develop and implement the new mental health treatment services provided in the jail. Both Departments will work to identify the needed resources for the increase in programs because of the additional space in the stand-alone facility. Existing revenue sources including funding from the Community Corrections Partnership (CCP), Mental Health Services Act and County General Fund will support the enhanced programming. The Sheriff's Office has prepared an estimate of staffing needs for the new facility. The analysis was completed using the workbook

provided by the National Institute of Corrections (NIC). The resulting analysis shows that to accommodate the proposed construction for the SB 863 Application, the Sheriff's Office will need a net increase of 20 staff. As the following Tables shows, the year one salaries and benefits cost will be \$1,773,850. Both the County Administrator and Board of Supervisors have agreed to fund these positions within 90 days of occupancy of the Community Corrections Reentry Resource Center.

Humboldt County Jail New SB 863 Facility Staffing Allocation and Annual Personnel Costs			
<u>Position</u>	<u>Salaries & Benefits</u>	<u># New Staff Required</u>	<u>Year One Personnel Costs</u>
Correctional Deputy	\$87,416	15	\$1,311,246
Sr. Correctional Deputy	<u>\$92,520</u>	<u>5</u>	<u>\$462,604</u>
Total New Staff Positions/Cost		20	\$1,773,850

4. ADMINISTRATIVE WORK PLAN

Describe the steps required to accomplish this project. Include a project schedule, and list the division/offices including personnel that will be responsible for each phase of the project, and how it will be coordinated among responsible officials both internally and externally.

Summary Overview

Humboldt County has developed and will utilize a project management, construction and administrative work plan specifically intended to address local and State building requirements for the new Humboldt Community Corrections Reentry Resource Center. The County will use a design / bid / build delivery construction method. The project will be handled from the start by a highly experienced project team supplemented with a construction management (CM) consultant and contract architectural / engineering firm. The project management

team will include executives from County administration, Sheriff's Office, and General Services Department. The County's designated Project Manager will be the Deputy Public Works Director for Facilities Management who will be responsible for ensuring all phases of the construction work are coordinated throughout the project delivery process and the scope of work is accomplished within the allotted time. The County's project administration system utilizes both proven monitoring and cost control protocols. Designated County staff will respond to the BSCC and the selected project design architect will respond to all Minimum Title 15 and 24 Jail Standards issues.

Management Approach For Proposed Construction Project

Humboldt County has an experienced in-house construction planning and administration team that has the ability to successfully manage this capital expenditure project. The County will supplement their staff with the contract services of a construction management (CM) firm. The County's Construction Manager will be *Tyler Holmes, Deputy Public Works Director – Facilities Management*, who will serve as the County's designated Project Manager and will be responsible for ensuring that all phases of the construction work are coordinated throughout the project delivery process. *Josielyn Gilbaugh, Deputy Public Works Director – General Services*, will be the project Fiscal Officer, who will manage fiscal expenditures, reporting, and ensure the building construction remains within set budget. *Captain Ed Wilkinson of the Humboldt County Sheriff's Office*, will be the designated SB 863 contact person.

County staff have developed a project administration system that utilizes both proven monitoring and control protocols. Each project is constructed using qualified staff

consultants in a “team approach” throughout its development. The County and its consultants have extensive experience with projects, including detention facilities funded through the State’s revenue bond process, and will use a management approach similar to other successful major construction projects. The County also has scheduling, budgeting, and cost accounting software in place to aid with the project.

Designated County staff will respond to the BSCC on all contract matters and the selected Project Design Architect will respond to all Minimum Title 15/24 Jail Standards issues. An integrated project delivery process will be used for programmatic and quality control delivery in which the County, construction management team, consultants, and all stakeholders (Sheriff, Probation, and Department of Health and Human Services) are involved to review the drawings and the performance of all consultants retained for the project. In addition, the construction management firm will monitor, schedule, and coordinate activities on behalf of the County and Sheriff’s Office.

A single General Contractor will be responsible to organize the construction workforce, order materials, establish a quality control program, and schedule the work of all trades including mechanical, plumbing, and electrical, in a logical order. The Construction Manager, jail transition team personnel, on-site Inspector, construction management firm, and Project Architect will observe and inspect all completed construction work. Following substantial completion, Sheriff’s Custody, Probation, and Department of Health and Human Services (DHHS) personnel will transition into the functional spaces and train staff. The local fire department will inspect and verify operation of the fire safety equipment. Upon completion of any corrective work, inspections, and audits, final payment will be made to the General Contractor.

Humboldt County has completed the initial programming, conceptual site design, and layout for the Sheriff's Office, Probation Department, and DHHS components of the SB 863 Humboldt Community Corrections Reentry Resource Center Project. The County staff and project transition team essential for the successful completion of the Humboldt Community Corrections Reentry Resource Center are also in place.

Project Schedule

Upon notification of the BSCC Conditional Award, the County will work quickly to finalize the Real Estate Due Diligence, Site Assurance documents, and complete the contract process to hire a construction management (CM) firm and design group. The required documentation will be presented to the California Department of General Services (DGS) for review and then to the State Public Works Board (SPWB) for the Project Establishment by March 2016. The Schematic Design and Operational Program Statement will be submitted to BSCC/CSFM for review in March 2016. SPWB Plan Approval is scheduled for completion in May 2016 with the SPWB Consent to Ground Lease occurring in June 2016. BSCC/SFM Final Approval is scheduled for July 2016, and the Pooled Money Investment Board Loan Request in September 2016. The Department of Finance Action to Approve Drawings and Proceed to Bid will be finalized in September 2016. Bids will be received in September 2016, construction will commence in October 2016, and be completed by June 2018. Occupancy and move-in will occur in September 2018.

5. BUDGET NARRATIVE

Describe the amounts and types of funding proposed and why each element is required to carry out the proposed project. Describe how the county will meet its funding contribution (match) requirements for all project costs in excess of the

amount of state financing requested and how operational costs (including programming costs) for the facility will be sustained.

Summary Overview

The \$20 million SB 863 Funding Application request to develop Humboldt County's Community Corrections Reentry Resource Center will provide much needed transitional "step-down" housing for both male and female inmates that can support offender reentry efforts along with other special need mental health treatment housing for offenders with serious psychiatric disorders. The dedicated multiple programming rooms also contained in the project will allow the County's criminal justice system to consolidate the community's limited, but essential mental health, drug counseling, employment assistance, life skills, and other important resources for assisting both in-custody detainees including the longer term Realignment sentenced / revoked inmates and alternative supervised offenders into one primary prominent downtown location. This will bring about a more cost-effective and efficient use of these important resources for the Sheriff, Probation Department, Courts, and local community. While the County is able to make available \$1,547,000 cash and in-kind match funding for support of the project, without the State funding, the Resource Center will likely not be constructed for many years.

Project Construction Budget

Humboldt County is requesting \$20 million in State funding and will provide \$860,000 as a cash contribution and \$687,000 in-kind matching funds to construct a stand-alone facility at the North end of the existing Humboldt County Correctional Facility (HCCF). The Reentry Resource Center would serve both in-custody and

alternative out-of-custody male and female offenders. A new multi-function building is a primary component of the proposed project. The building would co-locate the Sheriff's Office's Jail alternative programs, the Probation Department's Day Reporting Center, and Department of Health and Human Services (DHHS) Behavioral Health clinical mental health and substance abuse counseling staff. The facility would include a new 38-bed community transitional reentry inmate housing unit with expanded dedicated programming spaces specifically arranged to accommodate evidence-based service programming. The Center would also include a dedicated six-bed mental health treatment housing unit with adjacent program space and support areas for counselors assigned to the new unit. The expansion provides transitional beds that accommodate a specific inmate profile who can benefit from structured programs prior to community reentry. The types and amounts of funding requested include the following:

- Construction – Includes all costs associated with fixed construction costs for the new facility, parking garage/lot, and associated site improvements. The County is requesting \$20,000,000 in construction funding and will contribute an additional \$860,000 in cash match and \$687,00 in-kind match for total anticipated construction costs of \$21,547,000 million. The estimated cost of construction was determined in 2015 dollars and then escalated to the mid-point of construction based on the anticipated project schedule. Included in the construction (bid) costs are (a) fixed equipment and furnishings, (b) 5% change order contingency, and (c) a geographic location factor (2.5%). Construction cost estimates were provided by Vanir, Inc. and based on a conceptual building and site layout plan.

- Additional Eligible Costs – Includes cost for non-fixed moveable items necessary to operate the facility and outfit program and treatment areas such as furniture, shelving, fixtures and equipment, inmate management systems, video storage systems, and video visitation equipment (\$724,000). This item also includes construction support activities such as inspections, testing, equipment commissioning, and plan check services (\$375,000). The County is requesting \$1,099,000 million for additional eligible costs.
- Architectural – The County will solicit proposals and contract with an A/E to develop schematic design, design development, construction, and bid specification documents. The County is requesting \$1,768,000 million for A/E services and will contribute \$117,000 in cash match for a total of \$1,885,000.
- Project/Construction Management – The County will contract with a P/CM to assist with management of contractor construction activities. The County will contribute \$514,000.
- CEQA / State Agency Fees / Audit & Needs Assessment –The County has contributed \$89,000 for CEQA preparation and has allocated \$16,000 for Due Diligence expense. The County will also contribute \$91,000 towards the cost of State agency fees. Additionally, the County will contribute an estimated \$10,000 for an outside audit to be performed at the close of the project and has contributed \$39,000 for a Needs Assessment Update.
- County Administration – The County has found that close oversight and coordination by County staff of contractors as well as communication and coordination within the County results in higher quality, lower cost projects.

While a number of County staff will be actively involved in the project (see Administrative Work Plan), the project administration in-kind contribution will primarily consist of a Project Manager in the County's General Services Department who will serve as design and construction project management lead, coordinating the entire facility development process – planning, design and construction activities. The total County Administration in-kind contribution is anticipated to be \$62,000.

- Transition Planning – The Sheriff's Office will lead the transition planning for the project. This will initially be primarily the work of a single part-time staff and as the project moves closer to completion this will expand to include the planning, development, and implementation of the new facility's operations. Total transition planning in-kind contribution is anticipated to be \$300,000.
- Land Value – The appraised value of the site of the new facility is \$325,000 and will be a portion of the County's in-kind match.

Cash Match Requirements

The County's contribution to the project as approved by the Board of Supervisors totals \$1,547,000, 7.2% of the project costs. The County will meet the required contribution through a combination of cash and in-kind match. The \$860,000 in cash contribution will be provided from two existing funding sources including \$500,00 from the Humboldt County Community Corrections Partnership (HCCCP) and the County intends to pursue the issuance of Certificates of Participation. The County also currently has \$1,000,000 available in the criminal justice fund that could be applied to the project if the COPs are not issued. In-kind contributions totaling \$687,000 will be provided

through staff time for County Administration and transition planning and the appraised value of the project site.

Sustaining Operational Costs

The Sheriff's Office and County construction staff are seeking building designs with minimum staffing cost that will translate into the lowest long-term lifecycle cost expense to community taxpayers. The County intends on not only minimizing capital construction costs, but is specifically mindful of the need to minimize lifecycle cost including, annual staffing and operations cost of the new housing, medical and mental health services space, and expanded program areas. The programming and inmate services spaces designed for the project incorporates what research is showing will aid in reducing recidivism and controlling crime. The project specifically provides much needed program and vocational training opportunities for male and female inmates that can support offender reentry efforts. This will also give the County's Jail the ability to implement more varied inmate programming options and deliver programs and services efficiently and cost effectively.

The Sheriff's Office has prepared an estimate of staffing needs for the new facility. The staffing allocation for this building will require an additional 20 Deputies positions. The Sheriff's Office's financial staff has projected this additional annual cost for Correctional Deputies and Senior Correctional Deputies at \$1,773,814. This estimate includes the new staff positions identified above in addition to the cost for services, food, supplies and energy. The County, through their submittal of this SB 863 funding proposal, is committing to the staffing and operations of the new facility. With a

conditional funding award the County will commit through its budgetary practices and long-range financial planning the funding to operate the new facility.

The Day Reporting Center staffing of 14 Probation Officers, Supervisor, and administrative staff is funded through the County's General Fund budgeting process and will continue as a Board-approved appropriation into the future. Department of Health and Human Services staffing costs will also continue as a Board-approved appropriation in the County's annual budget development process. There will continue to be a planning effort of the County CCP to fund the necessary staffing and support for evidence-based programs and mental health treatment.

6. READINESS TO PROCEED

Summary Overview

Humboldt County owns the SB 863 site located in downtown Eureka. The County has a recent independent appraisal of the site's value. Documentation has been secured providing CEQA compliance including a final Notice of Determination and a letter from County Counsel certifying that the statute of limitations has expired and no challenges were filed. The Board of Supervisors has approved a Resolution which authorizes an adequate amount of available match funds, approves the project document forms necessary for financing, and authorizes an appropriate signatory to execute these documents. Conceptual planning, programming, and design work for the proposed construction project have been completed by the Sheriff's Office and partnering agencies.

Board of Supervisor's Resolution

On August 25, 2015, the Humboldt County Board of Supervisors approved Resolution #15-89 authorizing the County to participate in the SB 863 process. The Resolution stipulates the County will adhere to State requirements in terms of the agreement between the County, the Board of State and Community Corrections (BSCC), and the State Public Works Board (SPWB) including all forms of the project documents and in the expenditure of State funds and County match funds. The County will appropriate the amount of matching funds (cash and in-kind match) identified by the County on the Funding Proposal Form submitted by BSCC. The identified matching funds will be compatible with the State's lease revenue bond funding. The County Board agrees to fully and safely staff and operate the project consistent with Title 15 California Code of Regulations within 90 days after project completion. *(See attached Board of Supervisors Resolution)*

California Environmental Quality Act Compliance

On August 24, 2015 the Humboldt County Office of County Counsel issued a Certification Letter confirming that the Board of Supervisors approved the Initial Study and Mitigated Negative Declaration for the project and filed a Notice of Determination on July 16, 2015. The letter further indicates the statute of limitations expired on August 17, 2015 and the County has not received notice of a lawsuit challenging the Board's approval. In addition, County Counsel searched the Superior Court filing records which has also not indicated that any actions pertaining to the project were filed on or before August 17, 2015. *(See Notice of Determination and County Counsel's Letter included in separate Application documentation)*



A13



Humboldt Community Corrections Reentry & Resource Center-Site Plan - SB863 - Existing

07-20-15

Program Area Legend

- CCRC-DHS Day Reporting
- Circulation
- Probation
- Program Space
- Support Spaces
- SNAF

[Gross Area +/- 11,856 SF]

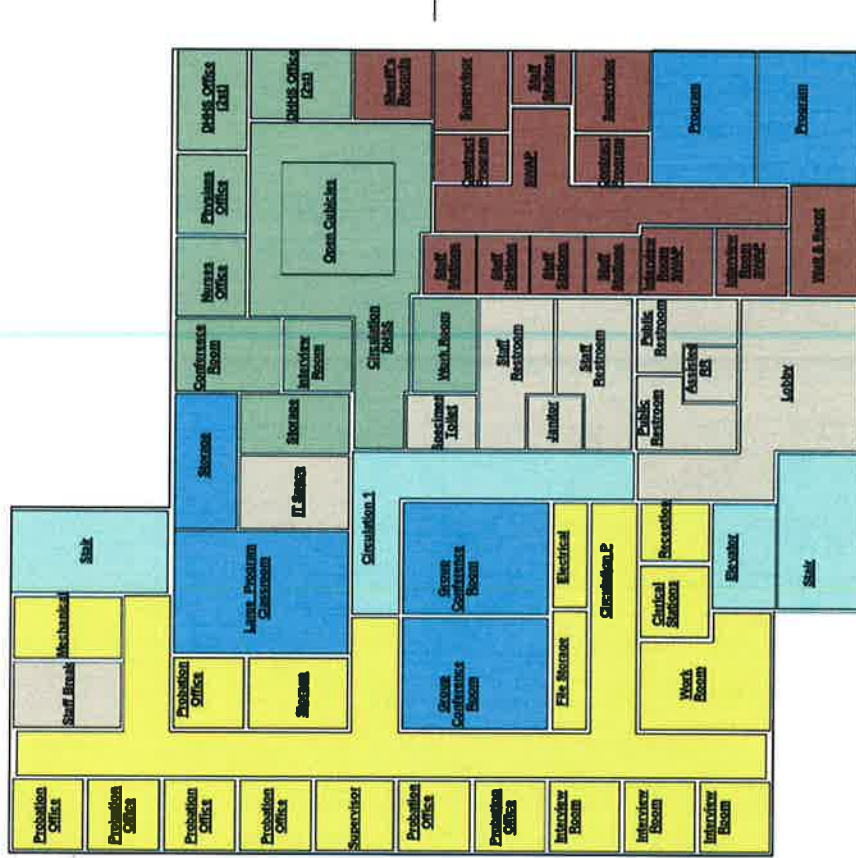

A14



GRAPHIC SCALE

1 First Fl - Program Room Areas 1/20
1" = 20'-0"

Humboldt Community Corrections Reentry & Resource Center - SB863 - First Floor

8-7-15

Program Area Legend:

- Circulation
- Inmate Housing
- Mental Health
- MH Housing
- Program Space
- Support Spaces

[Gross Area +/- 11,856 SF]

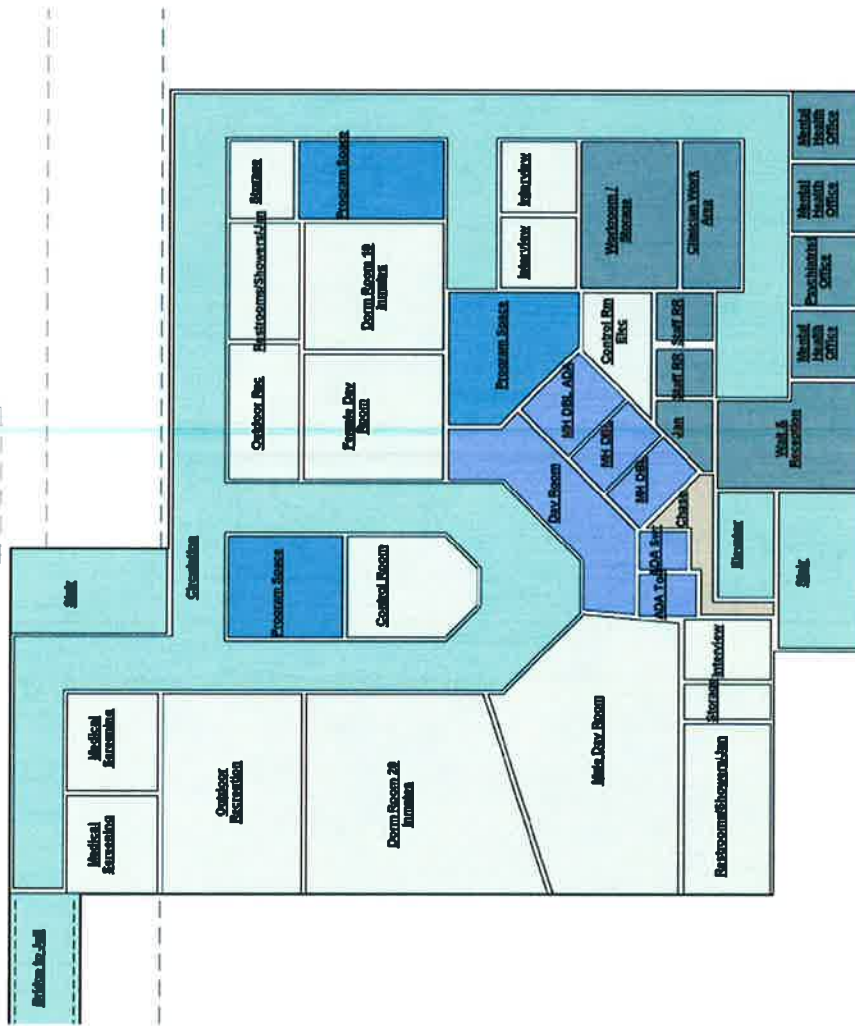

A15



GRAPHIC SCALE



1 Second Fl - Program Room Areas 1/20
 1" = 20'-0"

Humboldt Community Corrections Reentry & Resource Center - SB863 - Second Floor

8-7-15



1 Parking Garage
1" = 40'-0"

[Gross Area +/- 11,856 SF]

A16



Humboldt Community Corrections Reentry & Resource Center- SB863 - Garage Floor

8-7-15

BOARD OF SUPERVISORS, COUNTY OF HUMBOLDT, STATE OF CALIFORNIA
Certified copy of portion of proceedings, Meeting of August 25, 2015

RESOLUTION NO. 15-89

**RESOLUTION AUTHORIZING THE HUMBOLDT COUNTY SHERIFF'S OFFICE TO
SUBMIT AN APPLICATION AND PROPOSAL FOR SB 863 CONSTRUCTION OF ADULT
LOCAL CRIMINAL JUSTICE FACILITIES**

WHEREAS, the Humboldt County Board of Supervisors is the approving body to receive the Board of State and Community Corrections (BSCC) funding administered by the State of California; and

WHEREAS, the County of Humboldt has a critical need to expand its jail and other criminal justice facilities and is ready to seek competitive bidding; and

WHEREAS, there is a significant cost to the County of Humboldt to provide a detention facility for those detained by City and County law enforcement entities; and

WHEREAS, Senate Bill 863 appropriates \$500,000,000 in state lease-revenue bond financing authority for acquisition, design and construction, including expansion or renovation, of adult local criminal justice facilities in California; and

WHEREAS, the BSCC, pursuant to the provisions of SB 863, issued a Request for Proposals related to the Construction of Adult Local Criminal Justice Facilities on June 10, 2015; and

WHEREAS, the County of Humboldt will be submitting their Response to the BSCC's Request for Proposals for Construction of Adult Local Criminal Justice Facilities by August 28, 2015; and

WHEREAS, the BSCC's Request for Proposals requires confirmation via a Resolution of the Humboldt County Board of Supervisors of the County's commitment to and provision for taking certain actions and preparations as part of the County's Proposal; and

WHEREAS, the County of Humboldt is willing and able to take the following actions and preparations as part of its Proposal in response to the BSCC's Request for Proposals for Construction of Adult Local Criminal Justice Facilities; and

WHEREAS, receipt of the funding will enhance the ability of Humboldt County to protect the lives and property of the citizens of the County of Humboldt.

NOW, THEREFORE, BE IT RESOLVED AND ORDERED by the Board of Supervisors of the County of Humboldt, State of California that in consideration for significant financial assistance for the Humboldt Community Corrections Reentry Resource Center, the County will or does hereby take the following actions and make the following assurances:

- A. The County of Humboldt is seeking funding for its proposed project within the Adult Local Criminal Justice Facilities Construction Financing Program (the "SB 863 Financing Program"). As such, the Board of Supervisors of Humboldt County does hereby represent, warrant and covenant as follows:

BOARD OF SUPERVISORS, COUNTY OF HUMBOLDT, STATE OF CALIFORNIA
Certified copy of portion of proceedings, Meeting of August 25, 2015

RESOLUTION NO. 15-89

1. Lawfully Available Funds. The county cash contribution funds, as described in the documentation accompanying the County's SB 863 Financing Program Proposal Form, have been derived exclusively from lawfully available funds of the County.

County Cash Contribution Funds Are Legal and Authorized. The payment of the county cash contribution funds for the proposed adult local criminal justice facility project (the "Project") (i) is within the power, legal right, and authority of the County; (ii) is legal and will not conflict with or constitute on the part of the County a material violation of, a material breach of, a material default under, or result in the creation or imposition of any lien, charge, restriction, or encumbrance upon any property of the County under the provisions of any charter instrument, bylaw, indenture, mortgage, deed of trust, pledge, note, lease, loan, installment sale agreement, contract, or other material agreement or instrument to which the County is a party or by which the County or its properties or funds are otherwise subject or bound, decree, or demand of any court or governmental agency or body having jurisdiction over the County or any of its activities, properties or funds; (iii) and have been duly authorized by all necessary and appropriate action on the part of the governing body of the County. The County ensures the funds are compatible with lease revenue bond financing. The County intends to pursue the issuance of Certificates of Participation to fund this project and currently has \$1 million available in the Criminal Justice fund that could be applied to the project if COPs are not issued. In addition, the County has identified \$500,000 cash contribution from the Humboldt County Community Corrections Partnership (HCCCP).

2. No Prior Pledge. The county cash contribution funds and the Project are not and will not be mortgaged, pledged, or hypothecated by the County in any manner or for any purpose and have not been and will not be the subject of a grant of a security interest by the County. In addition, the county cash contribution funds and the Project are not and will not be mortgaged, pledged, or hypothecated for the benefit of the County or its creditors in any manner or for any purpose and have not been and will not be the subject of a grant of a security interest in favor of the County or its creditors. The County shall not in any manner impair, impede or challenge the security, rights and benefits of the owners of any lease-revenue bonds sold by the State Public Works Board for the Project (the "Bonds") or the trustee for the Bonds.
 3. Authorization to Proceed with the Project. The Project proposed in the County's SB 863 Financing Program proposal is authorized to proceed in its entirety when and if state financing is awarded for the Project within the SB 863 Financing Program.
- B. The County provides assurance that the submittal of documentation evidencing that compliance with CEQA has been fully completed for the proposed project and further is certifying that all related statutes of limitation have expired without challenge.

BOARD OF SUPERVISORS, COUNTY OF HUMBOLDT, STATE OF CALIFORNIA
Certified copy of portion of proceedings, Meeting of August 25, 2015

RESOLUTION NO. 15-89

- C. The Board of Supervisors of Humboldt County does hereby approve the forms of the project documents deemed necessary, as identified by the State Public Works Board to the BSCC to effectuate the financing authorized by the SB 863 legislation including, but not limited to, Project Delivery and Construction Agreement, the Board of State and Community Corrections Agreement, the Ground Lease, the Right of Entry for Construction and Operation, and the Facility Sublease. Each of the Chair of the Board of Supervisors, County Executive Officer and the Chief Financial Officer of the County, or their designees (collectively, the "Authorized Officers"), acting alone, is hereby authorized for and in the name of the County to execute, and the Clerk to the Board of Supervisors is authorized to attest, the Project Delivery and Construction Agreement, the Board of State and Community Corrections Agreement, the Ground Lease, the Right of Entry for Construction and Operation, and the Facility Sublease, in substantially the form hereby approved, with such additions thereto and changes therein as required by the BSCC or the State Public Works Board to effectuate the SB 863 Financing Program and as condition to the issuance of the Bonds. Approval of such changes shall be conclusively evidenced by the execution and delivery thereof by any one of the Authorized Officers each of whom, acting alone, is authorized to approve such changes.

Each of the Authorized Officers is authorized to execute these respective agreements at such time and in such manner as is necessary within the SB 863 Financing Program. Each of the Authorized Officers is further authorized to execute, acknowledge and deliver any and all documents required to consummate the transactions contemplated by the Project Delivery and Construction Agreement, the Board of State and Community Corrections Agreement, the Ground Lease, the Right of Entry for Construction and Operation, and the Facility Sublease.

- D. The contact people for the SB 863 Adult Local Criminal Facilities Construction Project shall be as follows:

County Construction Administrator - Tyler Holmes, Deputy Public Works Director-
Facilities Management.

Project Financial Officer- Josielyn Gilbaugh, Deputy Public Works Director - General
Services.

Project Contact - Ed Wilkinson, Captain, Humboldt County Sheriff's Office.

The Humboldt County Sheriff, or his designee, is hereby authorized to create and submit a proposal for SB 863 Adult Local Criminal Facilities Construction Project, on behalf of the COUNTY OF HUMBOLDT, a political subdivision of the State of California, and to do and perform everything necessary to carry out the purpose of this Resolution including any necessary non-monetary changes, modifications, or amendments.

BOARD OF SUPERVISORS, COUNTY OF HUMBOLDT, STATE OF CALIFORNIA
Certified copy of portion of proceedings, Meeting of August 25, 2015

RESOLUTION NO. 15-89

- E. The Humboldt County Board of Supervisors has reviewed the SB 863 Adult Local Criminal Facilities Construction Financing Program Proposal requirements issued through the BSCC and provides the following Assurances for the Proposal.
1. The County of Humboldt assures it will adhere to state requirements and terms of the agreements between the County, the Board of State and Community Corrections and the State Public Works Board in the expenditure of any state financing allocation and county contribution funds.
 2. The County of Humboldt assures it will safely staff and operate the facility that is being constructed (consistent with Title 15, California Code of Regulations) within ninety (90) days after project completion.
 3. The County of Humboldt certifies that it is not and will not be leasing housing capacity in this SB 863 financed adult local criminal justice facility to any other public or private entity for a period of 10 years beyond the completion date of the adult local criminal justice facility.
 4. The County of Humboldt assures it has project site control through either fee simple ownership of the site or comparable long-term possession of the site, and right of access to the project sufficient to assure undisturbed use and possession of the site, and will not dispose of, or modify the use of, or change the terms of the real property title, or other interest in the site of facility subject to construction, or lease the facility for operation to other entities, without permission and instructions from the Board of State and Community Corrections.
 5. The County of Humboldt attests to \$325,000 as the current fair market land value for the proposed new or expanded jail facility as reflected in the independent appraisal acquired by the County.

Dated: August 25, 2015



ESTELLE FENNELL, Chair
Humboldt County Board of Supervisors

Adopted on motion by Supervisor Bass, seconded by Supervisor Sundberg, and the following vote:

AYES:	Supervisors	Sundberg, Lovelace, Fennell, Bohn, Bass
NAYS:	Supervisors	--
ABSENT:	Supervisors	--
ABSTAIN:	Supervisors	--

BOARD OF SUPERVISORS, COUNTY OF HUMBOLDT, STATE OF CALIFORNIA
Certified copy of portion of proceedings, Meeting of August 25, 2015

RESOLUTION NO. 15-89

STATE OF CALIFORNIA)
County of Humboldt)

I, KATHY HAYES, Clerk of the Board of Supervisors, County of Humboldt, State of California, do hereby certify the foregoing to be an original made in the above-entitled matter by said Board of Supervisors at a meeting held in Eureka, California.

The within instrument is a full, true and correct copy of the original on file in this office.

ATTEST:

KATHY HAYES
Clerk of the Board of Supervisors
of the County of Humboldt,
State of California

By 

IN WITNESS WHEREOF, I have hereunto set my hand and affixed the Seal of said Board of Supervisors.

By ANA HARTWELL

Deputy Clerk of the Board of Supervisors of the
County of Humboldt, State of California

POSTED THROUGH

AUG 19 2015

Humboldt County Clerk

Print Form

Notice of Determination

Appendix D

To:

Office of Planning and Research
U.S. Mail: P.O. Box 3044 Sacramento, CA 95812-3044
Street Address: 1400 Tenth St., Rm 113 Sacramento, CA 95814

County Clerk
County of: Humboldt
Address: 825 Fifth Street, Eureka, CA 95501

From:

Public Agency: Humboldt County Public Works
Address: 1106 Second Street Eureka, CA 95501
Contact: Hank Seemann
Phone: 707-445-7741

Lead Agency (if different from above):

Address:

Contact:

Phone:

SUBJECT: Filing of Notice of Determination in compliance with Section 21108 or 21152 of the Public Resources Code.

State Clearinghouse Number (if submitted to State Clearinghouse): 2015042046

Project Title: Proposed Humboldt Community Corrections Reentry Resource Center and New County Office

Project Applicant: County of Humboldt

Project Location (include county): APN 001-191-005, K Street and 4th/5th Streets, Eureka, Humboldt County

Project Description:

The County of Humboldt proposes to develop an approximately 0.79-acre site in two phases. Phase One would be an approximately 26,500 sf building for the Humboldt County Community Corrections Reentry Resource Center, funded through Senate Bill 863. Phase Two would be a building addition of approximately 54,000 sf of program area to house County government offices or new courtroom space. Funding or financing for Phase Two has not been secured. The Site is currently used as a temporary parking lot for the existing courthouse and jail complex.

This is to advise that the Humboldt County Board of Supervisors has approved the above (X) Lead Agency or () Responsible Agency

described project on July 14, 2015 and has made the following determinations regarding the above described project.

- 1. The project () will (X) will not have a significant effect on the environment.
2. () An Environmental Impact Report was prepared for this project pursuant to the provisions of CEQA. (X) A Negative Declaration was prepared for this project pursuant to the provisions of CEQA.
3. Mitigation measures (X) were () were not made a condition of the approval of the project.
4. A mitigation reporting or monitoring plan (X) was () was not adopted for this project.
5. A statement of Overriding Considerations () was (X) was not adopted for this project.
6. Findings (X) were () were not made pursuant to the provisions of CEQA.

This is to certify that the final EIR with comments and responses and record of project approval, or the negative Declaration, is available to the General Public at: Humboldt County Public Works, 1106 Second Street, Eureka, CA 95501

Signature (Public Agency): Hank Seemann Title: Deputy-Director JUL 16 2015

Date: July 14, 2015 Date Received for filing at OPR:

FILED BY [Signature] 12-2015-029

Authority cited: Sections 21083, Public Resources Code. Reference Section 21000-21174, Public Resources Code.

Revised 2011

If applicable, describe any of the project's areas of controversy known to the Lead Agency, including issues raised by agencies and the public.

1. A parking study (Appendix E) was prepared in response to concerns expressed by the City of Eureka regarding off-site parking capacity.
2. A traffic study (Appendix F) was prepared to address potential impacts related to traffic and circulation.
3. The North Coast Regional Water Quality Control Board has an open case on the project site associated with the property's historic use as a service station and dry cleaner. In February 2015, the U.S. EPA approved funding under its Targeted Brownfields Assessment Program to assist the County in assessing and characterizing the potential presence of residual on-site contamination. Collection of soil boring samples for laboratory testing is currently scheduled for May 2015.

Provide a list of the responsible or trustee agencies for the project.

County of Humboldt is the only responsible agency. Encroachment permits (ministerial) may be required from City of Eureka and Caltrans. The project is an urban in-fill project and the site does not contain biological habitat, so trust resources will not be affected.

Appendix G
Mitigation Monitoring and Reporting Program
Humboldt County Community Correction Reentry Resource
Center and Future Government Facility

Impact	Mitigation Measure	Implementation Responsibility	Monitoring/ Reporting Responsibility	Timing
Aesthetics	<p>AES-1: If the final building design includes windows that have the potential to produce glare onto vehicle traffic, these windows shall be treated or tinted to reduce glare.</p> <p>AES-2: All outdoor lighting shall be directed downward on the Site to prevent illumination of adjacent parcels.</p>	<p>County of Humboldt</p>	<p>County of Humboldt</p>	<p>During design and construction</p>
Air Quality	<p>AIR-1: During construction of the HCCCRRC and New County Office Facility and associated site improvements, the contractor will:</p> <ul style="list-style-type: none"> • Spray exposed soils with water during grading on a daily basis • Suspend earthmoving and trenching activities when winds exceed 20 mph • Cover haul-truck loads • Immediately after grading, plant ground cover in disturbed areas or otherwise cover exposed disturbed areas in a manner preventing windblown dust from leaving the project site. 	<p>County of Humboldt</p>	<p>County of Humboldt and NCUAQMD</p>	<p>During construction</p>
Cultural Resources	<p>CULT-1: If cultural materials (e.g., chipped or ground stone, historic debris, building foundations, or bone) are discovered during ground-disturbance activities, work within 20 meters (66 feet) of the discovery shall be stopped, per the requirements of CEQA (Title 14 CCR 15064.5 [ff]). Work near the archaeological find(s) shall not resume until a professional archaeologist, who meets the Secretary of the Interior's Standards and Guidelines, has evaluated the materials and offered recommendations for further action. Any identified cultural resources will be recorded on DPR 523 historic resource recordation forms, from the Office of Historic Preservation.</p>	<p>County of Humboldt</p>	<p>County of Humboldt</p>	<p>During construction</p>

	<p>If Native American archaeological remains are inadvertently encountered, the Tribal Historic Preservation Officers (THPOs) of the three recognized Wiyot-area tribes (Blue Lake Rancheria, Bear River Band of Rohnerville Rancheria, and Wiyot Tribe) will be immediately notified, permitted to observe the findings in the field, and afforded the opportunity to make recommendations for avoiding, minimizing, or mitigating impacts from the proposed development.</p> <p>CULT-2: If human remains are discovered during project construction, work within 20 meters (66 feet) of the discovery location, and within any nearby area reasonably suspected to overlie human remains, will cease (Public Resources Code, Section 7050.5). The Humboldt County Coroner will be contacted to determine if the cause of death must be investigated. If the coroner determines that the remains are of Native American origin, it is necessary to comply with state laws regarding the disposition of Native American burials, which fall within the jurisdiction of the California Native American Heritage Commission (NAHC) (Public Resources Code, Section 5097). In this case, the coroner will contact NAHC. The descendants or most likely descendants of the deceased will be contacted, and work will not resume until they have made a recommendation to the landowner or person responsible for excavation work with direction regarding appropriate means of treatment and disposition, with appropriate dignity, of the human remains and any associated grave goods, as provided in Public Resources Code, Section 5097.98.</p>	County of Humboldt	County of Humboldt	During construction
	<p>CULT-3: A qualified historical resource professional shall conduct Archival research to determine if monitoring for historic era resources is necessary. If deemed necessary, the appropriate locations for monitoring during the removal of gravel, asphalt, concrete or fill shall be determined. The purpose of this monitoring will be to allow a qualified professional to observe any artifacts or evidence of historical settlement, activity, or burials within the project footprint prior to construction activities that may destroy</p>	County of Humboldt	County of Humboldt	Prior to initiating construction, during initial excavations

	them or result in an inadvertent discovery. If the pre-construction monitoring does not yield any artifacts or evidence of historical settlement, activity, or burials, as determined by a qualified professional, construction may commence without further oversight. If artifacts or evidence of historical settlement, activity, or burials are discovered during the pre-construction monitoring, then appropriate actions shall be taken as described in Mitigation Measures CULT-1 and CULT-2.			
Hazards	HAZ-1: Prior to construction the County shall resolve the CAO or otherwise secure construction approval from the RWQCB. Construction approval is expected to require additional site-specific sampling for PCE. If PCE is detected above actionable levels at the project site, the County will develop an appropriate remediation program in consultation with the RWQCB. The soil remediation process ultimately selected will comply with methods approved by the State Water Resources Control Board and the RWQCB.	County of Humboldt	County of Humboldt	Prior to construction
Hydrology and Water Quality	HYDRO-1: Prior to the start of grading on the Site, the Project proponent shall require the construction contractor to prepare and implement an Erosion Control Plan (ECP). The ECP shall identify Best Management Practices (BMPs) in accordance with the California Stormwater Best Management Practices Handbook, such as the use of silt fences, straw mats, and other techniques as appropriate, to be used during grading and construction activities to control erosion, sedimentation, and deposition of pollutants.	County of Humboldt	County of Humboldt	Prior to construction
	HYDRO-2: If surplus soils are stockpiled from site excavations and utility trenching, the piles shall be covered if rains or strong winds are forecasted. This requirement shall be included in the construction plans and specifications, and the construction contractor(s) shall comply with the requirement.	County of Humboldt	County of Humboldt	During construction
Noise	NOISE-1: The County shall notify sensitive receptors (all property owners within 350 feet) of potential impacts from noise and vibration prior to initiating each construction phase. The notice shall describe construction activities and anticipated noise and/or	County of Humboldt	County of Humboldt	During construction

	vibrations from these activities, and the duration and operational hours of construction activities. The notice will also include a contact that sensitive receptors may call to report noise or vibration concerns. The notice will include a request that property owners share the notice with any employee or tenants working within 350 feet of the project site.	County of Humboldt	County of Humboldt	
	NOISE-2: To reduce the possibility of the construction noise and vibrations becoming an annoyance to sensitive receptors near the Project, exterior construction activity shall be confined to the weekday hours of 7:00 am to 7:00 pm or until sunset, whichever is later, and weekend hours of 8:00 am to 6:00 pm or until sunset, whichever is later. No heavy equipment related construction activities shall be allowed on Sundays or holidays.	County of Humboldt	County of Humboldt	During construction
	NOISE-3: Construction equipment shall be properly maintained and equipped with noise control devices, such as mufflers and shrouds, in accordance with manufacturers' specifications.	County of Humboldt	County of Humboldt	During construction
	NOISE-4: The new building will contain design elements, and be constructed with materials that will reduce the interior noise levels to acceptable levels as defined by the County of Humboldt's General Plan.	County of Humboldt	County of Humboldt	During design and construction
Transportation/ Traffic	<p>Traffic-1: Prior to initiating Phase 2 of the project, a signal warrant analysis shall be conducted to determine if signalization is the appropriate method to mitigate delays experienced at the following</p> <ul style="list-style-type: none"> • Intersection 4 (4th Street and K Street) • Intersection 5 (4th Street and L Street); and, • Intersection 9 (5th Street and K Street) <p>If, in consultation with the City of Eureka and Caltrans, signalization is determined to be the appropriate method to address increased vehicle delays, the project shall contribute the fair share contribution to these signals. Currently estimated at 2.6% under existing plus project Phase Two conditions and 7.7% under cumulative plus project conditions.</p>	County of Humboldt	County of Humboldt	Prior to occupancy of Phase Two



COUNTY COUNSEL
COUNTY OF HUMBOLDT

825 FIFTH STREET

EUREKA, CALIFORNIA 95501

PHONE: (707) 445-7236 FAX: (707) 445-6297

August 24, 2015

Board of State and Community Corrections
County Facilities Construction Program
Attention: Magi Work, Deputy Director
2590 Venture Oaks Way, Suite 200
Sacramento, CA 95833

Re: Humboldt Community Corrections Reentry Resource Center Project – Certification of Compliance with the California Environmental Quality Act

Dear Ms. Work:

This office represents the County of Humboldt (“County”), which has submitted an application and proposal for Senate Bill 863 financing to design and build an adult criminal justice facility as part of the Humboldt Community Correction Reentry Resource Center Project (“Project”). In support of the above-referenced application and proposal, this office certifies the following:

On July 14, 2015, the Humboldt County Board of Supervisors (“Board”) approved the Initial Study and Mitigated Negative Declaration for the Project pursuant to section 15074 of Title 14 of the California Code of Regulations.¹ The County subsequently filed a Notice of Determination pursuant to section 15075 on July 16, 2015. The filing and posting of the Notice of Determination triggered the 30-day statute of limitations on legal challenges to the Board’s approval under the California Environmental Quality Act (“CEQA”). (§15075(g).) The statute of limitations therefore expired at the latest on August 17, 2015. The County has not received notice of a lawsuit challenging the Board’s approval. In addition, this office has thoroughly searched the Humboldt County Superior Court’s filing records which do not indicate that any actions pertaining to the Project were filed on or before August 17, 2015.

If you have any questions, or require any further information, please feel free to email Deputy Director of Public Works, Hank Seemann at hseemann@co.humboldt.ca.us.

Sincerely,

Scott A. Miles
Deputy County Counsel
Attorney for County of Humboldt

¹ All further statutory references are to Title 14 of the California Code of Regulations unless specified otherwise.

NILSEN REAL ESTATE APPRAISALS

3988 WALNUT DRIVE
EUREKA, CALIFORNIA 95503

MATT NILSEN
LIC. #AG006743

(707) 441-8560
FAX (707) 441-8565

EDWARD NILSEN

August 13, 2015

Mrs. Ronda Kime, Sr. Real Property Agent
Humboldt County Dept. Of Public Works
1106 2nd Street
Eureka, CA 95501

**Re: Gravel Parking Lot
Northwest Corner of 5th and "K" Streets
925 5th Street
Eureka, CA 95501**

Dear Mrs. Kime:

Pursuant to your request, I have made an investigation and analysis of the real property described above. My purpose was to estimate the current market value of the real property as if a lot line adjustment has occurred. This is considered a *hypothetical condition* as the current property is 34,276 square feet in size. The fee simple interest will be shown in this report. Per our agreement, this is an *Appraisal Report* which conforms to the Uniform Standards of Professional Appraisal Practice (USPAP) adopted by the Appraisals Standards Board of the Appraisal Foundation.

The valuation date is August 5, 2015.

By reason of my investigation and by virtue of my experience, I am of the opinion the estimated market value of the appraisal property, with the assumptions made herein, is the sum of

THREE HUNDRED TWENTY FIVE THOUSAND DOLLARS

(\$ 325,000)

Following you will find a brief report of my findings, conclusions, and information upon which my value conclusions are partially predicated. Should additional information be requested, please contact me.

Very truly yours,



Matt Nilsen, #AG006743

MN:klr



Humboldt County Community Corrections Partnership – Executive Committee

Date: August 19, 2015

Time: 12:15p – 1:45p

Location: Fifth floor conference room, Humboldt County Courthouse

Required Member Agencies (pursuant to Penal Code Section 1230.1(b): Chief Probation Officer – Chair, Chief of Police, Sheriff, District Attorney, Public Defender, presiding judge of the Superior Court (or designee), and one representative from Mental Health, AOD or Social Services (pursuant to PC1230(b)(2)(G), (H) or (J), as designated by the Board of Supervisors).

Agenda

I. Call to Order

II. Review and approval of minutes – July 17, 2015 meeting

III. Adjustments to the agenda

New Business

**IV. Sheriff's Request for Cash Match for SB863 Construction Proposal – ACTION ITEM
Request for vote regarding one-time funding - \$500,000**

The HSO is preparing a proposal for \$20,000,000 in state funding for Adult Local Criminal Justice Facilities construction (SB863, 2014). The proposed construction would provide appropriate program and office space for the services presently housed in the Community Corrections Resource Center, as well as create additional in-custody re-entry program housing. The present request is for \$500,000 in one-time funds for cash match for the proposal.

V. Four-year report to Board of Supervisors – Discussion item

The CCP Executive Committee last reported to the Board of Supervisors in December 2013 with a two-year report on progress with our CCP plan implementation. The four-year anniversary is approaching. This item begins discussion and planning for a new report to the Board.

Old Business

**VI. Follow up regarding Equine Assisted Learning for AB109 Offenders pilot project –
Discussion Item**

January 21, 2015 the CCP Executive Committee authorized funding for this pilot project. The project concluded on June 2nd and providers and CCRC staff will report their observations regarding the pilot for Executive Committee review.

VII. Update on CCP Plan Implementation – Discussion item

All partner agencies will update on present staffing, hiring and status regarding program implementation, participation and operational considerations. Discussion presented information.

VIII. Update regarding CCP data projects – Discussion item

Discussion progress with CCRP, PPIC and Pretrial Steering data projects associated with CCP programs and services.

Public Comment

IX. Set agenda for next meeting – 1 hour meeting (September 16th, 1 hour meeting) – CPO Damiano will not be present so the group needs to select a chair for this meeting. Future items: New contract funding for CJI to conduct assessment tool validation study and provide additional pretrial program training; discussion Equine Assisted Growth and Learning pilot.

X. Adjourn



Humboldt County Community Corrections Partnership – Executive Committee

Date: August 19, 2015

Time: 12:15p – 1:45p

Location: Fifth floor conference room, Humboldt County Courthouse

Required Member Agencies (pursuant to Penal Code Section 1230.1(b): Chief Probation Officer – Chair, Chief of Police, Sheriff, District Attorney, Public Defender, presiding judge of the Superior Court (or designee), and one representative from Mental Health, AOD or Social Services (pursuant to PC1230(b)(2)(G), (H) or (J), as designated by the Board of Supervisors).

Minutes

I. Call to Order

Chief Bill Damiano called the meeting to order at 12:15pm. In attendance were Barbara LaHaie for DHHS Director Phil Crandall, Billy Honsal for Sheriff Mike Downey, Drew Lund – Superior Court, District Attorney Maggie Fleming, and Chief of Police Tom Chapman (City of Arcata).

II. Review and approval of minutes – July 15, 2015 meeting

Billy Honsal moved to approve the minutes from 7/15/15. Maggie Fleming seconded the motion.

A vote was taken and the votes were as follows:

Aye: Bill Damiano, Barbara LaHaie, Billy Honsal, Maggie Fleming, Tom Chapman

Abstain: Drew Lund

The motion was carried.

III. Adjustments to the agenda

There were no adjustments to the agenda.

New Business

IV. Sheriff's Request for Cash Match for SB863 Construction Proposal – ACTION ITEM Request for vote regarding one-time funding - \$500,000

The HSO is preparing a proposal for \$20,000,000 in state funding for Adult Local Criminal Justice Facilities construction (SB863, 2014). The proposed construction would provide appropriate program and office space for the services presently housed in the Community Corrections Resource Center, as well as create additional in-custody re-entry program housing. The present request is for \$500,000 in one-time funds for cash match for the proposal.

Ed Wilkinson introduced the item and gave some background information. The proposal asks for 1 time funding (of \$500,000) to cover the cash match. Bill talked about our budget and pointed out that we also would have the savings from the current lease of 404 H Street. Ed and Bill clarified how the process of getting the state funding works.

Maggie Fleming moved to accept this proposal; Barbara LaHaie seconded the motion.

A vote was taken and the votes were as follows:

Aye: Bill Damiano, Barbara LaHaie, Billy Honsal, Maggie Fleming, Tom Chapman

Abstain: Drew Lund

The motion was carried.

V. Four-year report to Board of Supervisors – Discussion item

The CCP Executive Committee last reported to the Board of Supervisors in December 2013 with a two-year report on progress with our CCP plan implementation. The four-year anniversary is approaching. This item begins discussion and planning for a new report to the Board.

Bill Damiano reported it's been awhile since our last report to the Board of Supervisors and proposes setting up a workgroup. Billy Honsal liked the idea because it's important to keep them informed. Bill Damiano explained the format of the last report (power point presentation). Drew thought the report should also discuss results. Bill Damiano asked the group to identify people from their departments to participate and he will coordinate a workgroup to put a presentation together.

Old Business

VI. Follow up regarding Equine Assisted Learning for AB109 Offenders pilot project – Discussion Item

January 21, 2015 the CCP Executive Committee authorized funding for this pilot project. The project concluded on June 2nd and providers and CCRC staff will report their observations regarding the pilot for Executive Committee review.

Terri Jennings says she followed up on Director Crandall's concerns regarding the Mental Health Services Act funding restriction on Equine Assisted Therapy. Terri found that, in fact, there are multiple counties implementing equine assisted programming directly linked to the MHSA. It was pointed out that the model of the local pilot was Equine Assisted Learning, not therapy. Bill indicated that the overall assessment of the pilot was positive and that the providers are hoping to be added to our list of contract services, which could be easily done. Barbara asked what the cost per participant was; it worked out to roughly \$1,000 per person. Barbara then suggested that the outcomes for those that completed should be tracked going forward. Bill indicated that could be done, but our small numbers will not likely result in a finding with much statistical significance. Barbara said DHHS would abstain in any vote because it's not an evidence-based practice. Terri talked about their interest in gathering data to establish the evidence of their positive results, thus supporting this as an evidence-based intervention. Tom proposed that future funding for this should be an action item on the agenda for next month.

VII. Update on CCP Plan Implementation – Discussion item

All partner agencies will update on present staffing, hiring and status regarding program implementation, participation and operational considerations. Discussion presented information.

- Asha George/DHHS ~ there is still a vacant Case Manager position. They have seen an increase in the number of clients.
- Ed Wilkinson/Jail ~ they are fully staffed. The data glitch regarding HCCF female numbers in custody has been fixed. The census is 340 today and females are not over population. Bill asked if we could fix the data retroactively, to reflect the correct numbers in the spreadsheet. Ed will look into that.
- Paula Sargent/Probation ~ they are about to start another Thinking for a Change program. SRP is fully staffed. Bill discussed the data.

VIII. Update regarding CCP data projects – Discussion item

Discussion progress with CCRP, PPIC and Pretrial Steering data projects associated with CCP programs and services.

Bill reported that the CCRP contract is still pending. PPIC – they are about to reignite their program. Pretrial Steering – Bill has asked for their proposal to continue. He will bring it to the group when he has something solid.

Public Comment None

- IX. Set agenda for next meeting – 1 hour meeting (September 16th, 1 hour meeting) – CPO Damiano will not be present 9/16 so the group will need to select a chair for this meeting.**
Future items: New contract funding for CJI to conduct assessment tool validation study and provide additional pretrial program training; discussion Equine Assisted Growth and Learning pilot.
Ed would like a discussion item about reducing the suicide attempts in the jail - this will be joint item with DHHS.

- X. Adjourn**
The meeting was adjourned at 12:48pm.



HUMBOLDT COUNTY SHERIFF'S OFFICE

MICHAEL T. DOWNEY, SHERIFF

CIVIL/COURTS
(707) 445-7335

MAIN STATION
826 FOURTH STREET • EUREKA CA 95501-0516
PHONE (707) 445-7251 • FAX (707) 445-7298

CUSTODY SERVICES
(707) 441-5159

June 22, 2015

HCCCP Executive Committee,

Background Information

Senate Bill 863 was passed on June 20, 2014 authorizing up to \$500,000,000 in state lease-revenue bond financing for county jail construction, expansion, or renovations. On June 10, 2015 the Board of State and Community Corrections (BSCC) opened the RFP process.

Under SB 863 the state has divided the counties into "Large", "Medium", & "Small". Humboldt, which is one of 30 "Small" counties competing for a chunk of the \$100,000,000 allotted for the small counties. The state has capped the "Small" county projects at \$20,000,000 each.

The BSCC clearly identifies two important factors in the legislative intent of SB 863. They are;

1. Improved housing with an emphasis on expanding program and treatment space as necessary to manage the adult offender population.
2. Custodial housing, reentry programing, mental health or treatment space necessary to manage the adult offender population.

A recent needs assessment for the Humboldt County Correctional Facility that was completed prior to our proposal for SB 1022 funding showed that the facility desperately lacks treatment, programs, and the space to conduct these.

The proposal submitted for SB 1022 laid out a plan to construct a multi floor 24,911 square foot facility called the Humboldt County Community Corrections Reentry Resource Center. This collaborative project would have created a "One-Stop-Shop" that would contain the Day Reporting Center (Probation, DHHS, & SWAP) on the 1st floor and 40 "Low Security" reentry beds (30 male and 10 female beds) and programing space on the 2nd floor. This HCCCRR would contain ample programing space that would allow for increased programs for both in-custody and out-of-custody offenders.

SB 863 adds more emphasis on Mental Health programs. With that the initial plan for this proposal is to add a small Mental Health unit (6 beds & added programing space for this population). Other than this minor tweak in the plan, the idea is to basically submit an updated version of the 1022 proposal. This proposal is very much in line with the legislative intent of SB 863.

Proposal

Due to initial projected costs of this project to exceed the \$20 million cap by approximately \$1.5 million, it has been proposed that the County identify a hard match contribution of approximately \$1.5 million. The County Administrative Office has identified \$1,000,000 of the \$1.5 million in COPs, leaving \$500,000 unidentified.

The Sheriff's Office (as the lead agency) would like to propose a request for one time funding in the amount of \$500,000 from the CCP to be used towards this hard match for the SB 863 proposal. If approved these monies will be placed in the Humboldt County Capital Project budget unit (1100170) as local match for the SB 863 project.

As a footnote, a successful proposal on our part would relieve the CCP of approximately \$110,000.00 in lease fees for the 404 H St. building and the 555 H St. offices each year.

Sincerely,

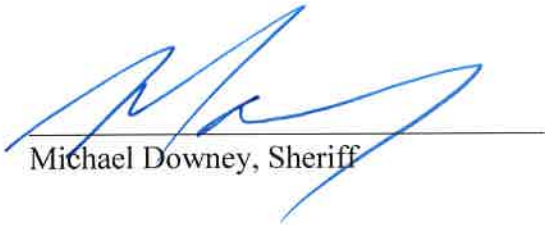

Michael Downey, Sheriff