



TABLE 17-5: PROJECTING AND SUSPENDED SIGNS:

Standard [1]	Zone District	
	CN, CW, OR	CS, MC, MG, ML
Max. number	1 per tenant frontage	1 per tenant frontage
Max. area	18 sq. ft. per tenant frontage	24 sq. ft. per tenant frontage
Max. height	Height of building to which it is attached	
Maximum projection from building wall	8 ft.	

Notes:
[1] Standards apply only to ground-floor tenants and uses. See 10-5.1708.3 (Multi-story buildings).
[2] The Building Code may require a projection less than eight feet

TABLE 17-6: AWNING / CANOPY SIGNS:

Standard	Zone District	
	CN, CW, ML, OR	CS, MC, MG
Max. number	No max.	
Max. area	25 sq. ft. or area of awning or canopy fascia, whichever is less	35 sq. ft. or area of awning or canopy fascia, whichever is less
Max. height (awning signs)	Height of awning area	
Max. height (canopy signs)	Height of canopy fascia; 3 ft. for signs atop canopy	Height of canopy fascia; 4 ft. for signs atop canopy
Max. width	The building wall to which it is attached or the tenant space it identifies	
Maximum projection from building wall	No max.	

Note: Standards apply only to ground-floor tenants and uses. See 10-5.1708.3 (Multi-story buildings).

MASTER SIGN PLAN NOTES:
THIS MASTER SIGN PLAN IS SUBMITTED IN ORDER TO GAIN APPROVAL OF THE TWO SIGNS SERVING THE 4th FLOOR TENANT SPACE PER PER EMC §10-5.1707.3, IN ACCORDANCE WITH CITY OF EUREKA TITLE 10, CHAPTER 5, ARTICLE 17: SIGNS, WHICH WAS UPDATED EFFECTIVE LATE 2022. NOTE EXISTING SIGNS FOR GROUND FLOOR TENANTS WHERE PREVIOUSLY APPROVED ADMINISTRATIVELY.

- VERIFY ALL DIMENSIONS WITH INSTALLATION CONDITIONS.
- TENANTS ARE RESPONSIBLE FOR ALL GRAPHICS & FINAL SIGN DESIGN DETAILS. LOGOS INCLUDED IN THESE DRAWINGS MAY BE SUBJECT TO COPYRIGHT AND ARE SHOWN FOR REFERENCE ONLY.
- NO INTERNALLY ILLUMINATED SIGNAGE.
- PROVIDE STREET ADDRESS NUMBERS PER PUBLIC WORKS AND CBC SECTION 502.
- COMPLY WITH CITY OF EUREKA LAND USE CODE TITLE 10 CHAPTER 5, REVISED LATE 2022.
- TOTAL STREET FRONTAGE = 230 LF, TIMES 2 SF / LF = 460 SF MAX. FOR PARCEL ON-PREMISES SIGN AREA. NOTE THERE ARE BONUS SIGN AREAS ALLOWABLE PER SIGN REGULATION ITEM E.
- NO SIGN ABOVE ROOF LINE.
- SEE REGULATIONS FOR INTERIOR WINDOW SIGNS AND OTHER SIGNS NOT INCLUDED HERE.

TENANT SIGNAGE SUMMARY
THE FOLLOWING SIGNS WERE ADMINISTRATIVELY APPROVED AND ARE NOT CHANGED:

SIGN ID	SIGN TYPE	DRAWING	AWNING FASCIA AREA (SF)	MAX. SIGN AREA (SF)	NOTES
A1	AWNING FRAME	1/A7.6	10.13 SF	10 SF	
A2	BLADE	1/A7.10	N/A	18 SF	
B1	AWNING FRAME	1/A7.7	8.24 SF	6.75 SF	
C1	AWNING FRAME	1/A7.8	10.39 SF	10 SF	
C2	BLADE	3/A7.10	N/A	18 SF	

THE FOLLOWING SIGNS ARE NEW, PROPOSED UNDER THIS MASTER SIGN PLAN, AND SERVE TENANT ABOVE GROUND FLOOR LEVEL:

SIGN ID	SIGN TYPE	DRAWING	AWNING FASCIA AREA (SF)	MAX. SIGN AREA (SF)	NOTES
R1	WALL SIGN	6/A7.10	N/A	9 SF	
R2	BLADE SIGN	5/A7.10	N/A	18 SF	TWO-SIDED



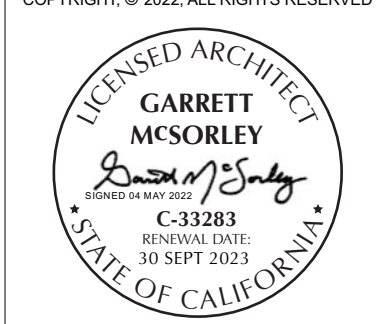

MCSORLEY ARCHITECTURE
garrett.mcsorley@gmail.com
PO Box 2472
McKinleyville, CA 95519
707.633.9283

OWNER:
WILL ADAMS
HUMBOLDT DEVELOPMENT
COMPANY, LLC
217 E STREET
EUREKA, CA 95501
707-443-6000

329 2nd STREET
MIXED-USE
329 2nd STREET
EUREKA, CALIFORNIA, 95501
ASSESSOR PARCEL NUMBER: 001-052-004

**SIGN DETAILS
TENANT A**

Drawing Status:

FOR PERMIT APPROVAL

Issue Date: **04 MAY 2022**

Revisions:

1	24 JUNE 2022	PLAN REVIEW COMMENTS
3	04 OCT 2023	SIGNS: TENANTS A,B,&C
4	06 FEB 2024	SIGNS: TENANT R

Sheet No.

A7.6

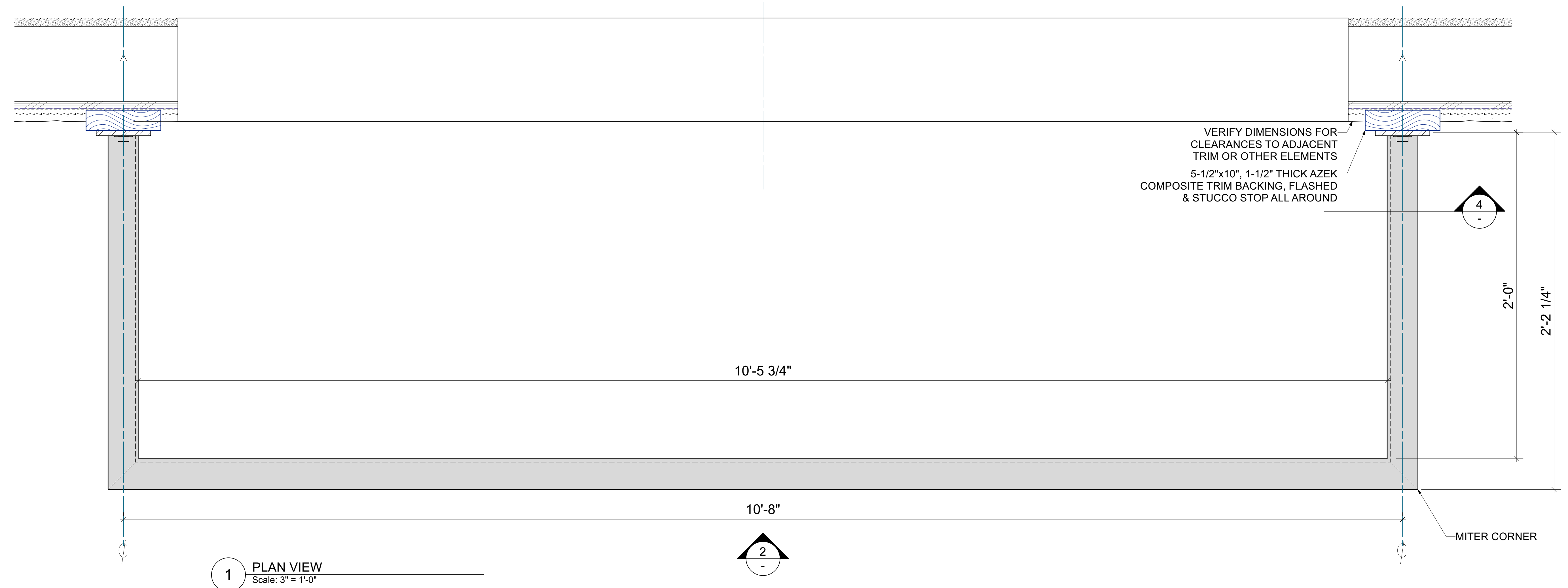
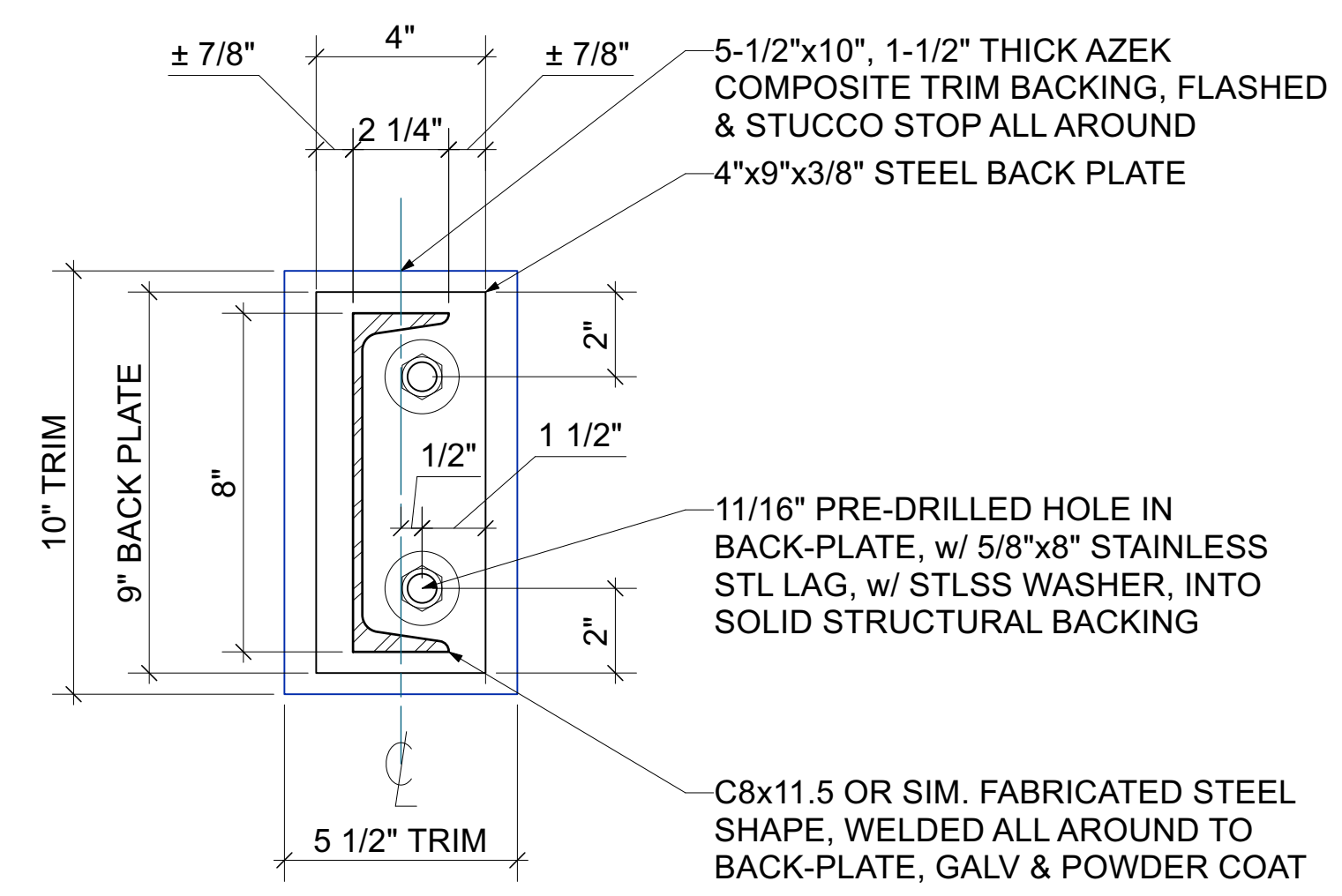
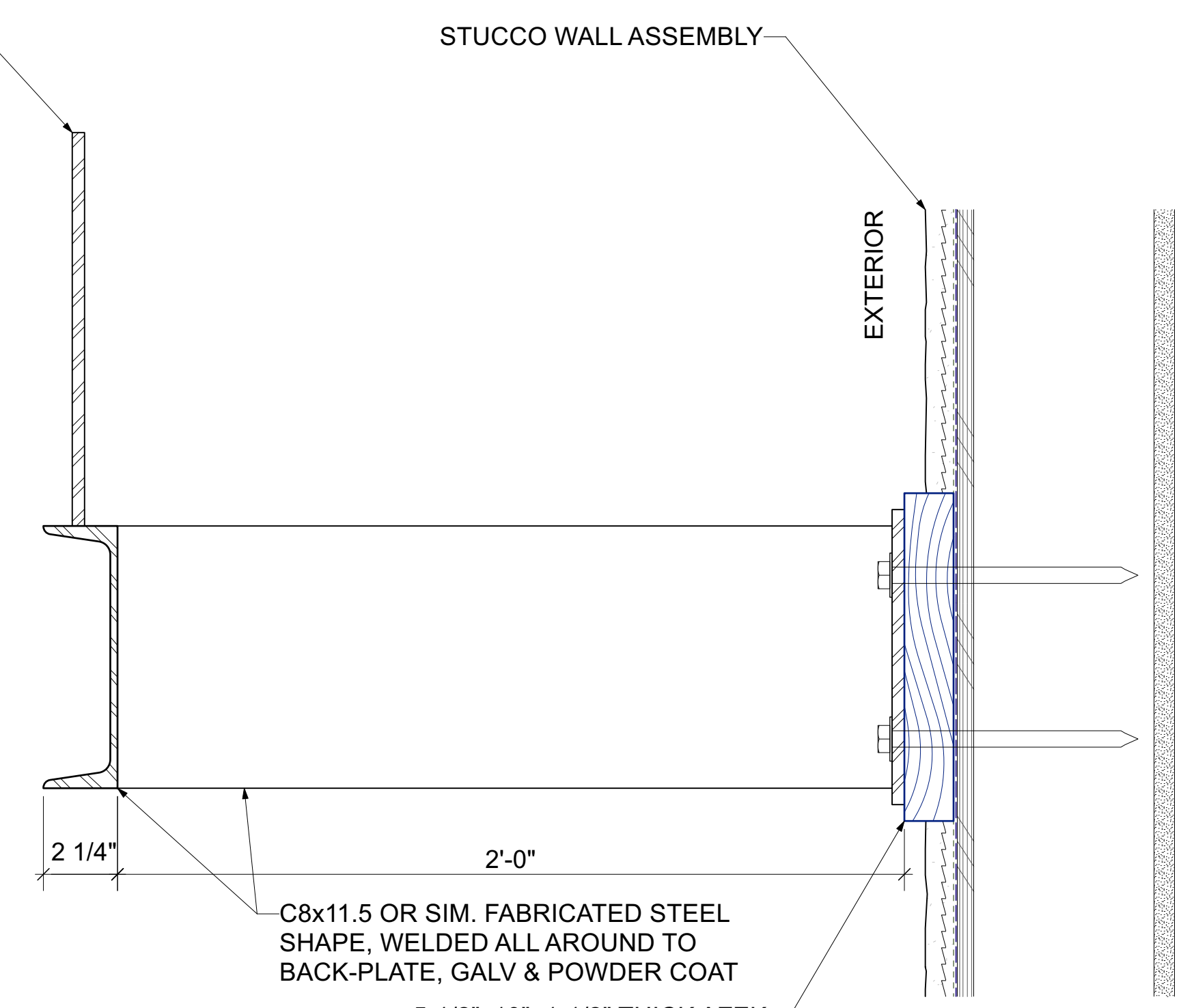
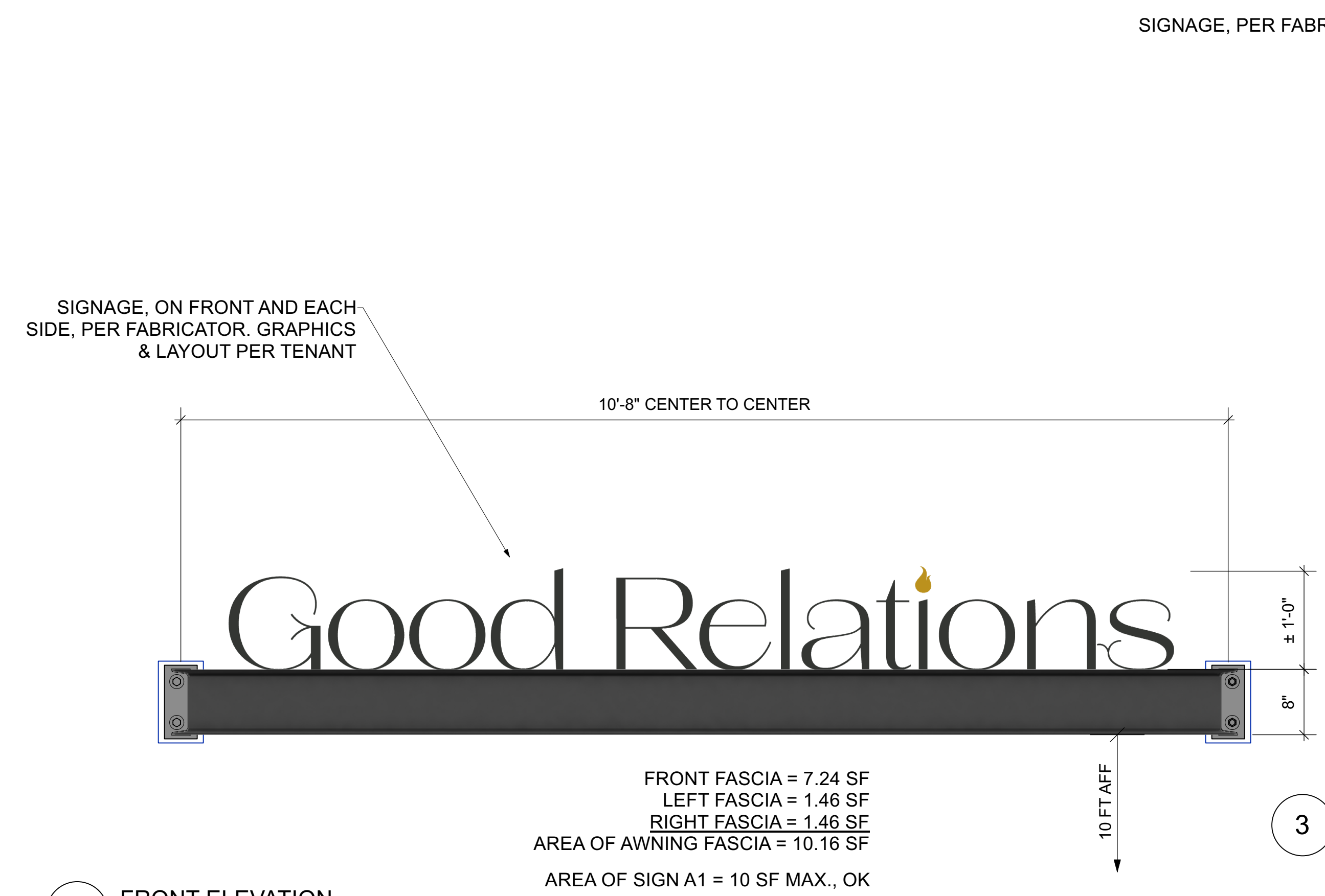

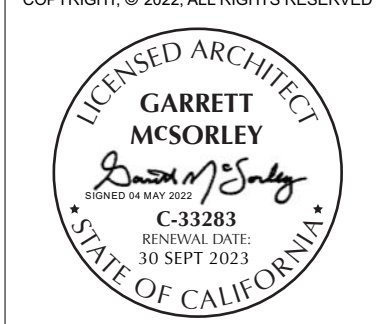

MCSORLEY ARCHITECTURE
garrett.mcsorley@gmail.com
PO Box 2472
McKinleyville, CA 95519
707.633.9283

OWNER:
WILL ADAMS
HUMBOLDT DEVELOPMENT
COMPANY, LLC
217 E STREET
EUREKA, CA 95501
707-443-6000

329 2nd STREET
MIXED-USE
329 2nd STREET
EUREKA, CALIFORNIA, 95501
ASSESSOR PARCEL NUMBER: 001-052-004

SIGN DETAILS TENANT C

Drawing Status: **FOR PERMIT APPROVAL**

Issue Date: **04 MAY 2022**

Revisions:

1	24 JUNE 2022	PLAN REVIEW COMMENTS
3	04 OCT 2023	SIGNS: TENANTS A,B.&C.
4	07 MAR 2024	SIGNS: REVISED TENANT C

Sheet No.

A7.8

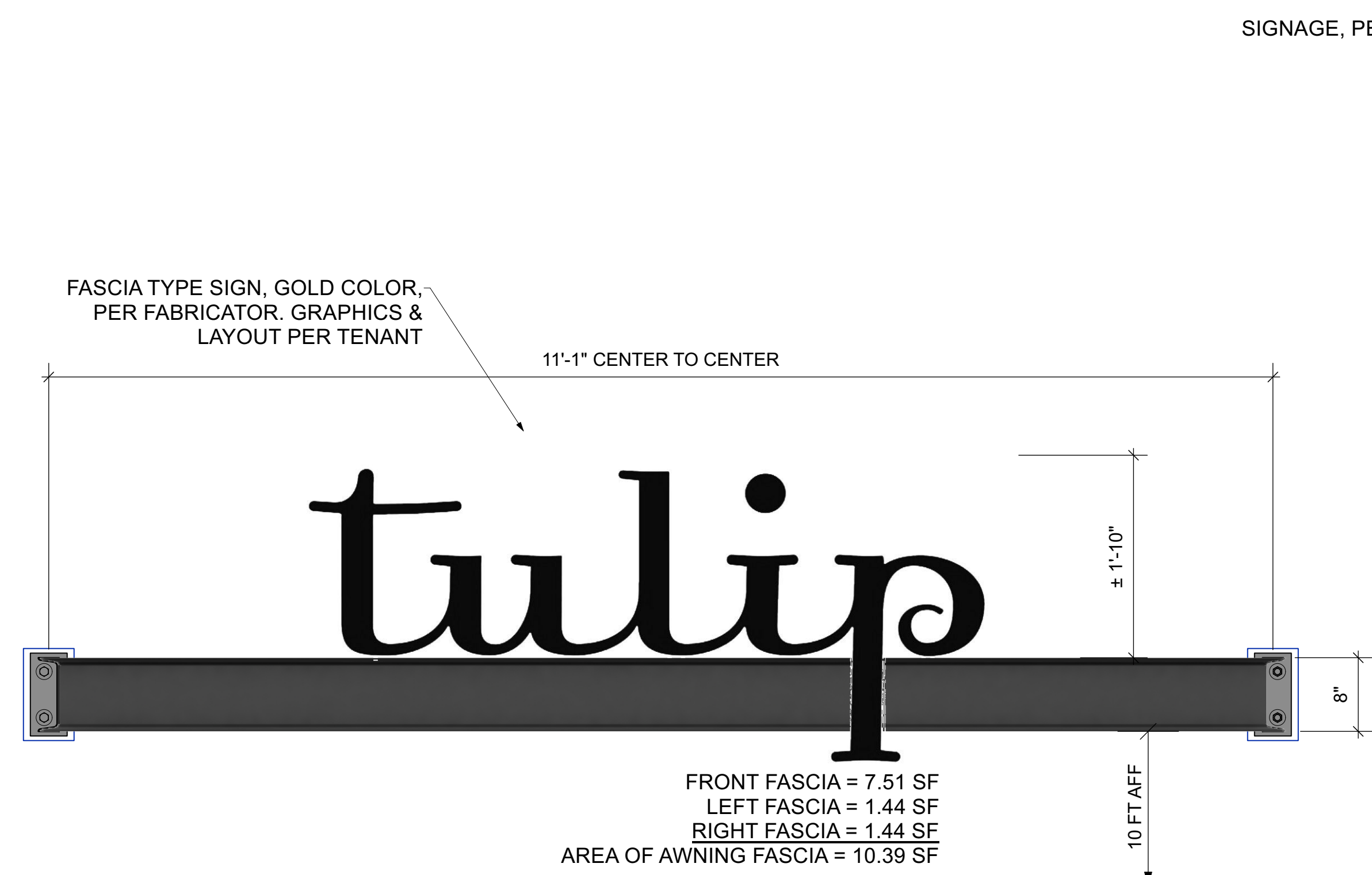

2 FRONT ELEVATION
Scale: 1" = 1'-0"

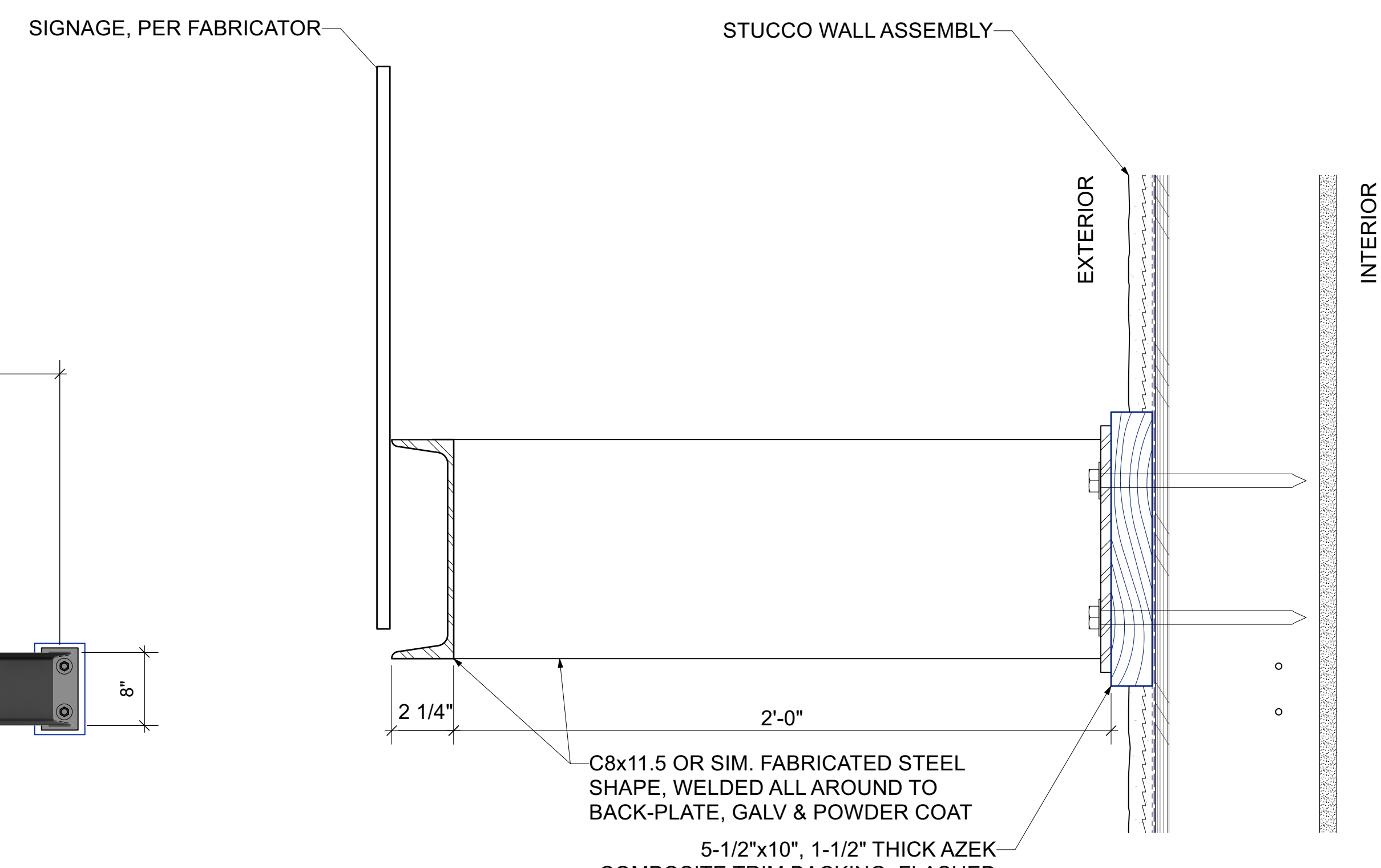

3 SIDE VIEW
Scale: 3" = 1'-0"

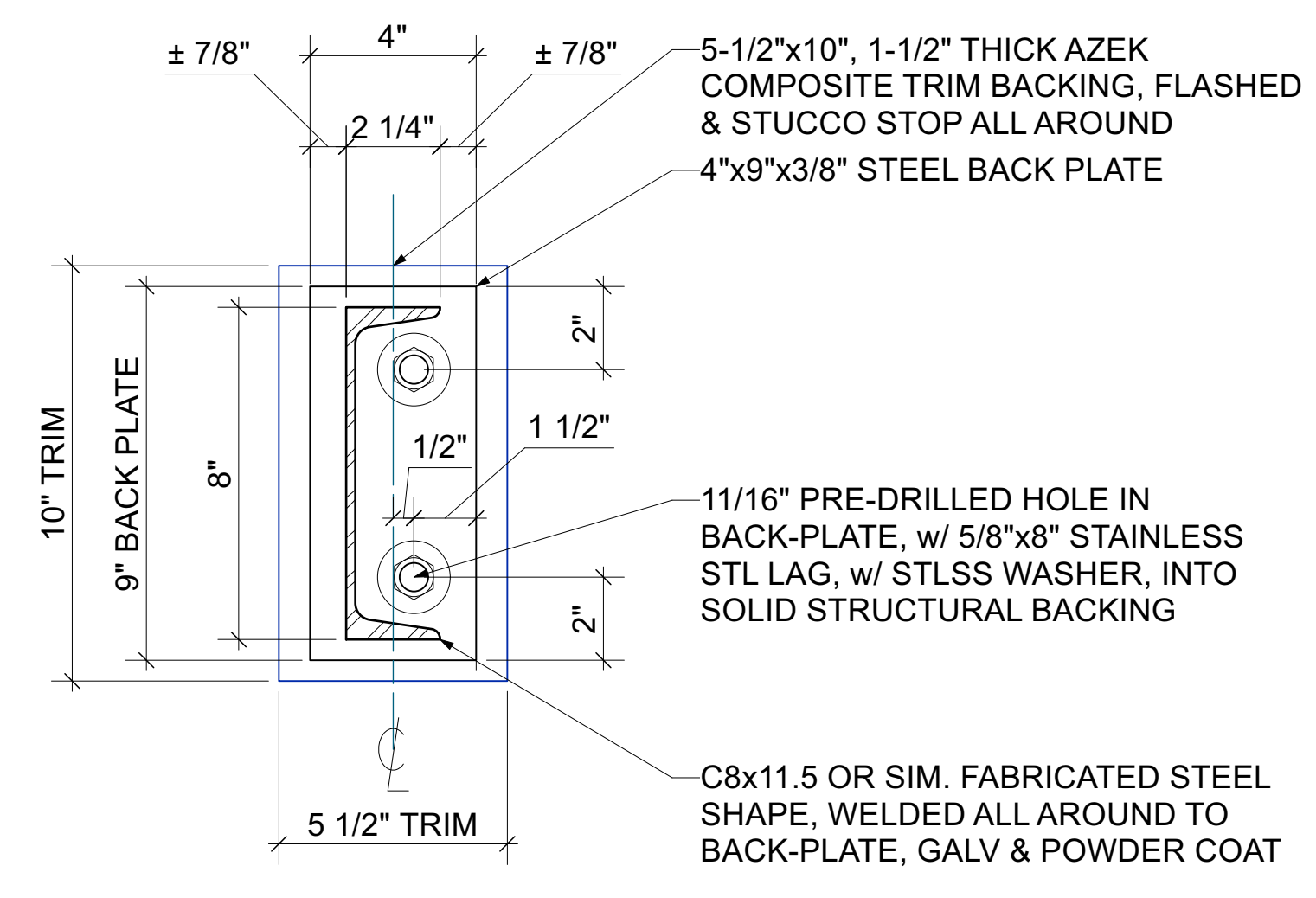

4 BACK PLATE DETAIL
Scale: 3" = 1'-0"



1 PLAN VIEW
Scale: 3" = 1'-0"

NOTE: ALL SIGNS ARE EXTERNALLY ILLUMINATED. NO INTERNAL LIGHTING IS PROPOSED.

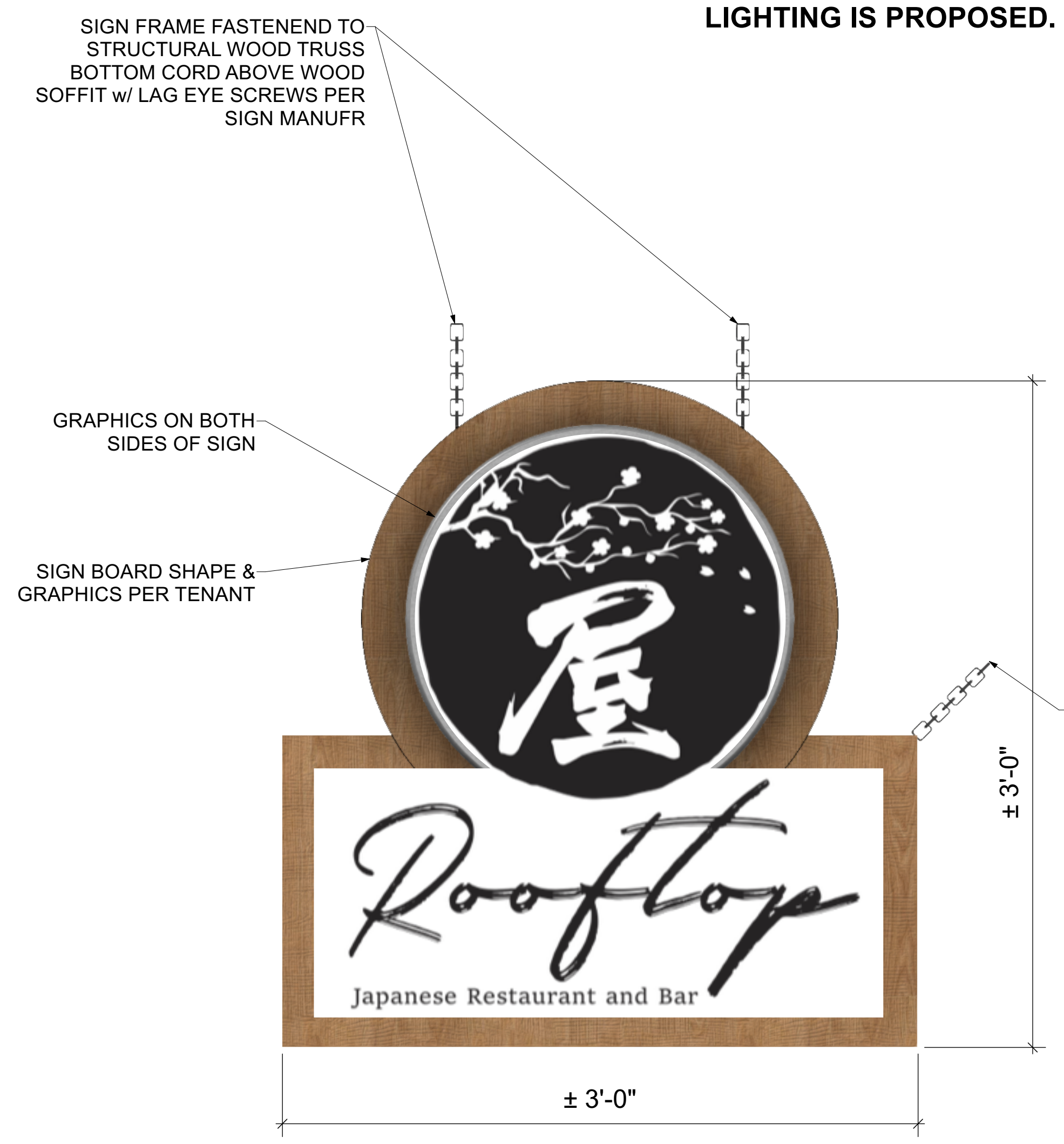

5 BLADE SIGN ELEVATION - ROOFTOP Sign R2
 Scale: ACTUAL SIZE

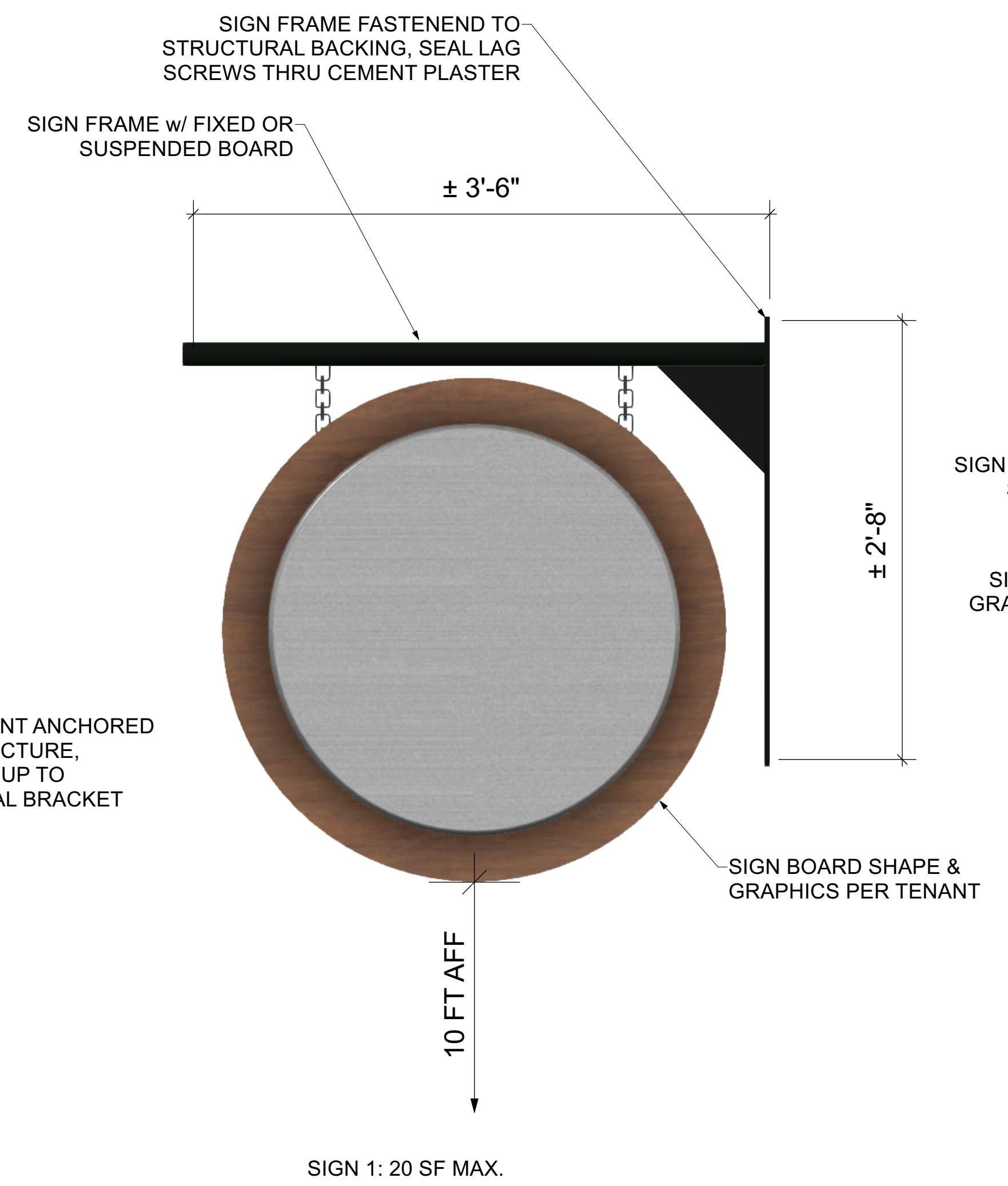

1 BLADE SIGN ELEVATION 1 Sign A2
 Scale: 1 1/2" = 1'-0"

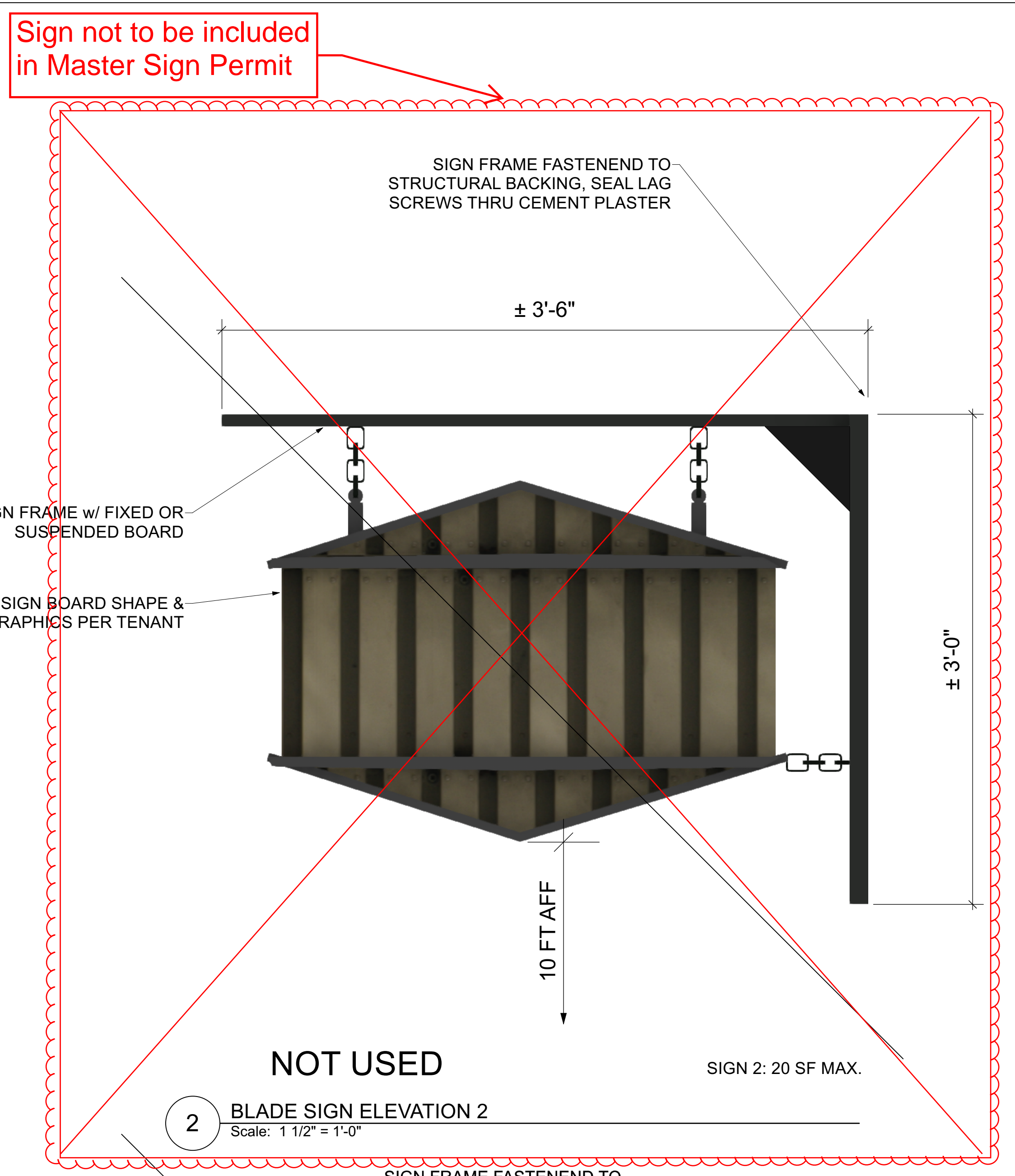

2 BLADE SIGN ELEVATION 2
 Scale: 1 1/2" = 1'-0"

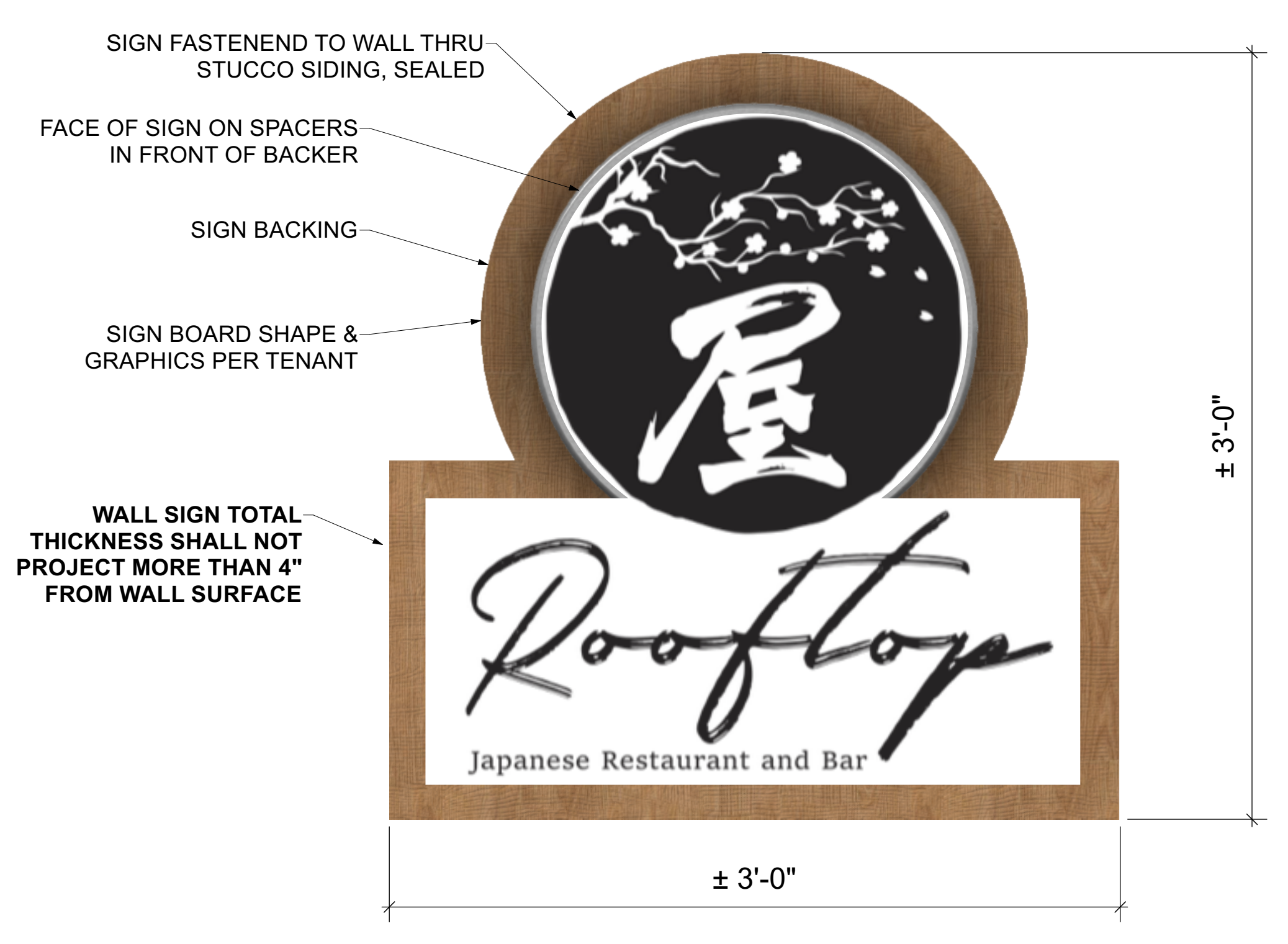

6 WALL SIGN ELEVATION - ROOFTOP Sign R1
 Scale: ACTUAL SIZE

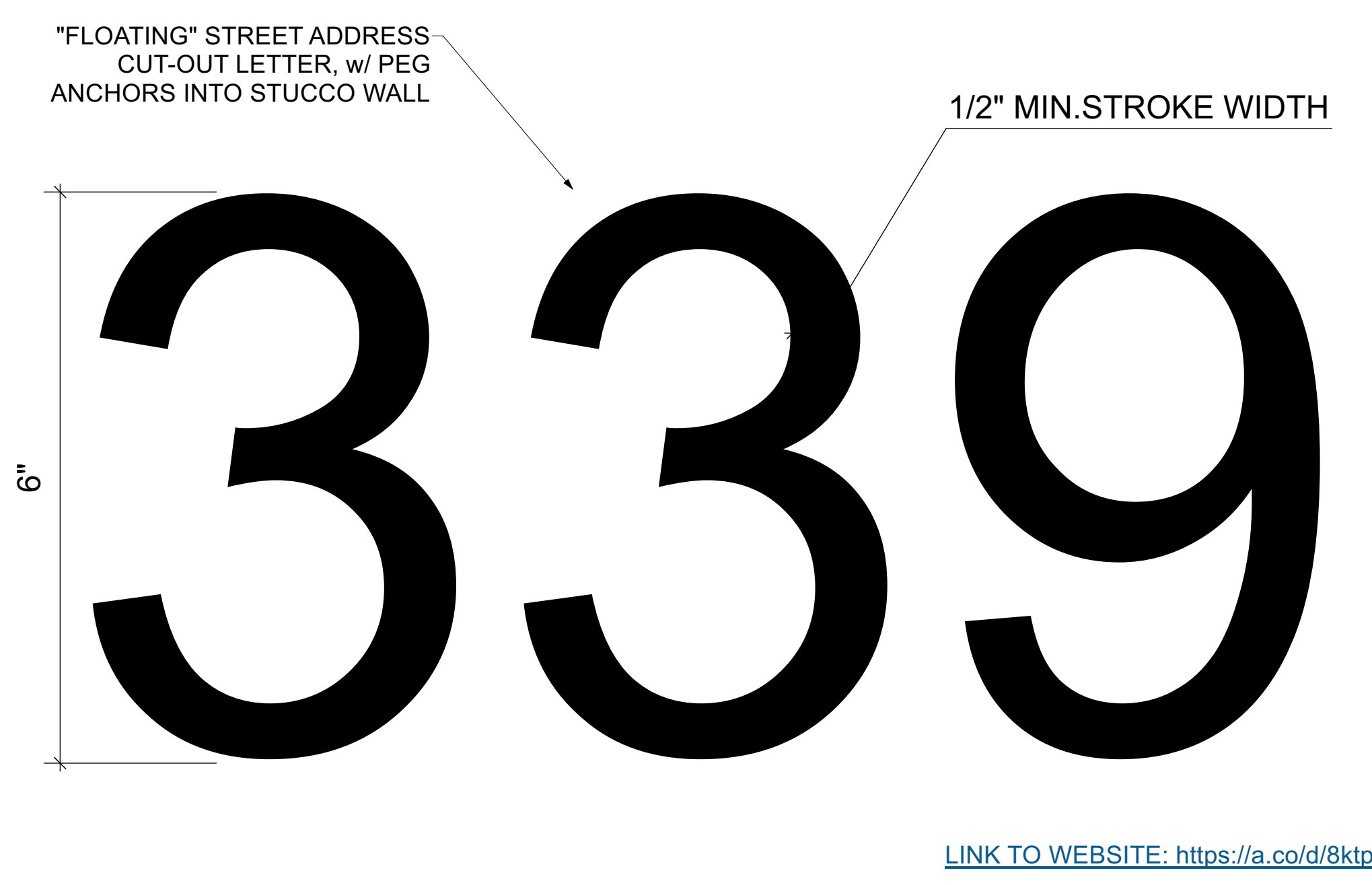

4 SITE ADDRESS LETTER SIGN
 Scale: ACTUAL SIZE

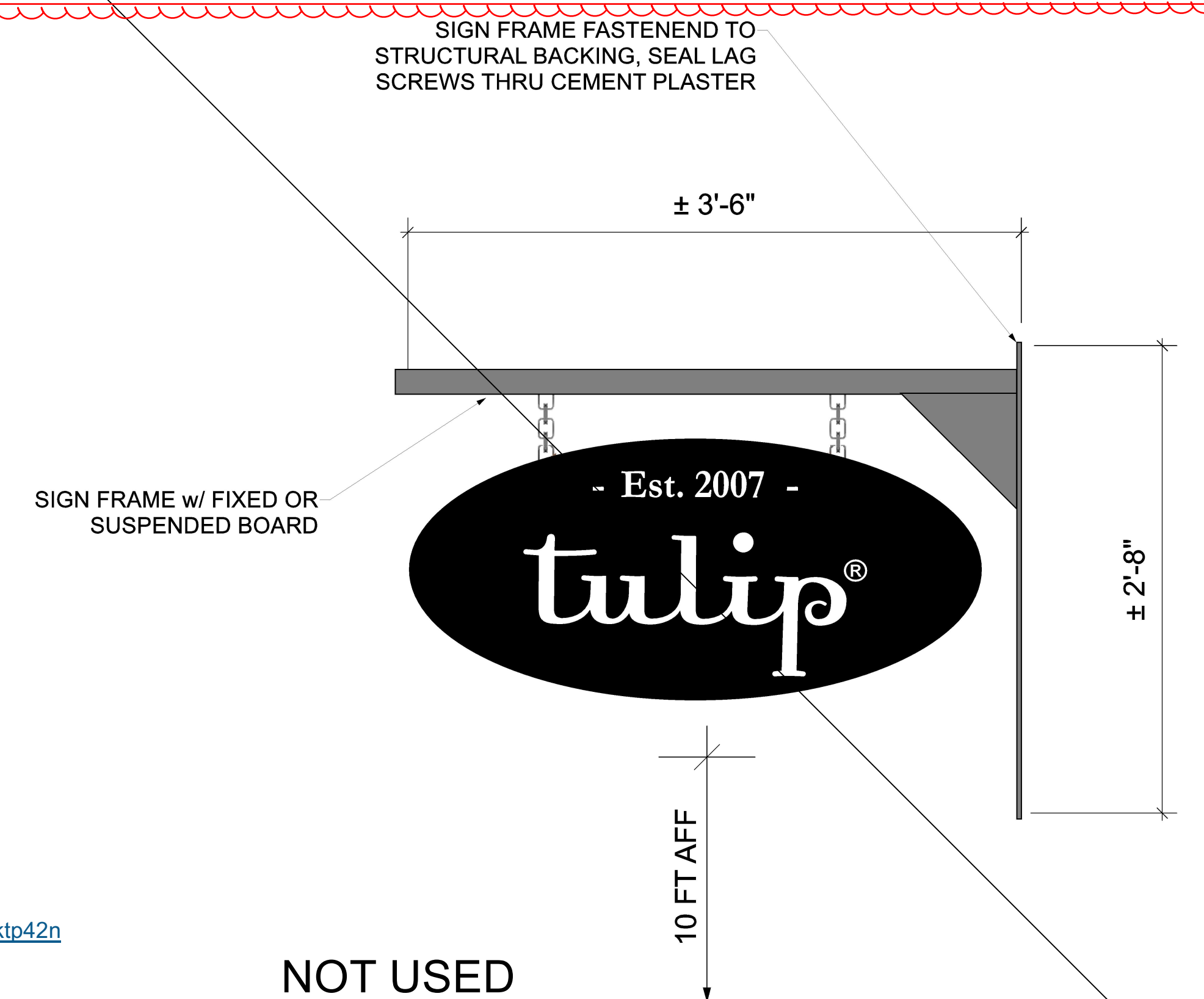

3 BLADE SIGN ELEVATION - TULIP Sign C2
 Scale: 1 1/2" = 1'-0"



Sign R3

Front Elevation (Ground Floor)



Top rail mount for "Gallery" with 2" spacers

Open / Closed Sign hooks into the return channel with swivel bolt in middle to be able to flip easily.

Either HDU or Aluminum substrate painted black with white lettering on either side.

Sign B1

Front Elevation (Ground Floor)

339 2nd Street
Awning Sign

