

RECEIVED

APR 03 2019

\*The free Adobe Reader may be used to view and complete this form. However, software must be purchased to complete, save, and reuse a saved form.

File Original with DWR MAY 19 2014

State of California Well Completion Report

Refer to Instruction Pamphlet

No. e0213421

Page 1 of 2

Owner's Well Number 1

Date Work Began 05/12/2014 Date Work Ended 5/14/2014

Local Permit Agency Humboldt County E.H.D.

Permit Number 11/12-1064 Permit Date 5/15/13

DWR Use Only - Do Not Fill In
Humboldt County Cannabis Svcs.
State Well Number/Site Number
Latitude Longitude
APN/TRS/Other

Geologic Log
Orientation: Vertical
Drilling Method: Direct Rotary
Depth from Surface: 0-160 feet
Description: Clayey Silt W/Rock Reddish, Schist Brown, Tuffs Lt. BROWN, Basalt Black

Well Owner
Well Location
Address: Three Creeks Rd. Parcel #23
City: Blue Lake County: Humboldt
APN Book 522 Page 021 Parcel 009
Township 07N Range 04E Section 08

Location Sketch
(Sketch must be drawn by hand after form is printed.)
North, South, West, East

Activity
New Well
Planned Uses
Water Supply
Domestic, Irrigation, Industrial, etc.

Water Level and Yield of Completed Well
Depth to first water 30
Depth to Static
Water Level 30 (Feet) Date Measured 05/12/2014
Estimated Yield 10 (GPM) Test Type Air Lift
Test Length 4 (Hours) Total Drawdown 150 (Feet)

Casings
Table with columns: Depth from Surface, Borehole Diameter, Type, Material, Wall Thickness, Outside Diameter, Screen Type, Slot Size

Annular Material
Table with columns: Depth from Surface, Fill, Description

Attachments
Geologic Log
Well Construction Diagram
Geophysical Log(s)
Soil/Water Chemical Analyses
Other Location Map

Certification Statement
I, the undersigned, certify that this report is complete and accurate to the best of my knowledge and belief
Name FISCH DRILLING
Address 3150 JOHNSON ROAD HYDESVILLE CA 95547
Signed Date 05/14/2014 License Number 683865

# Supply Creek Tract Land Owners Association

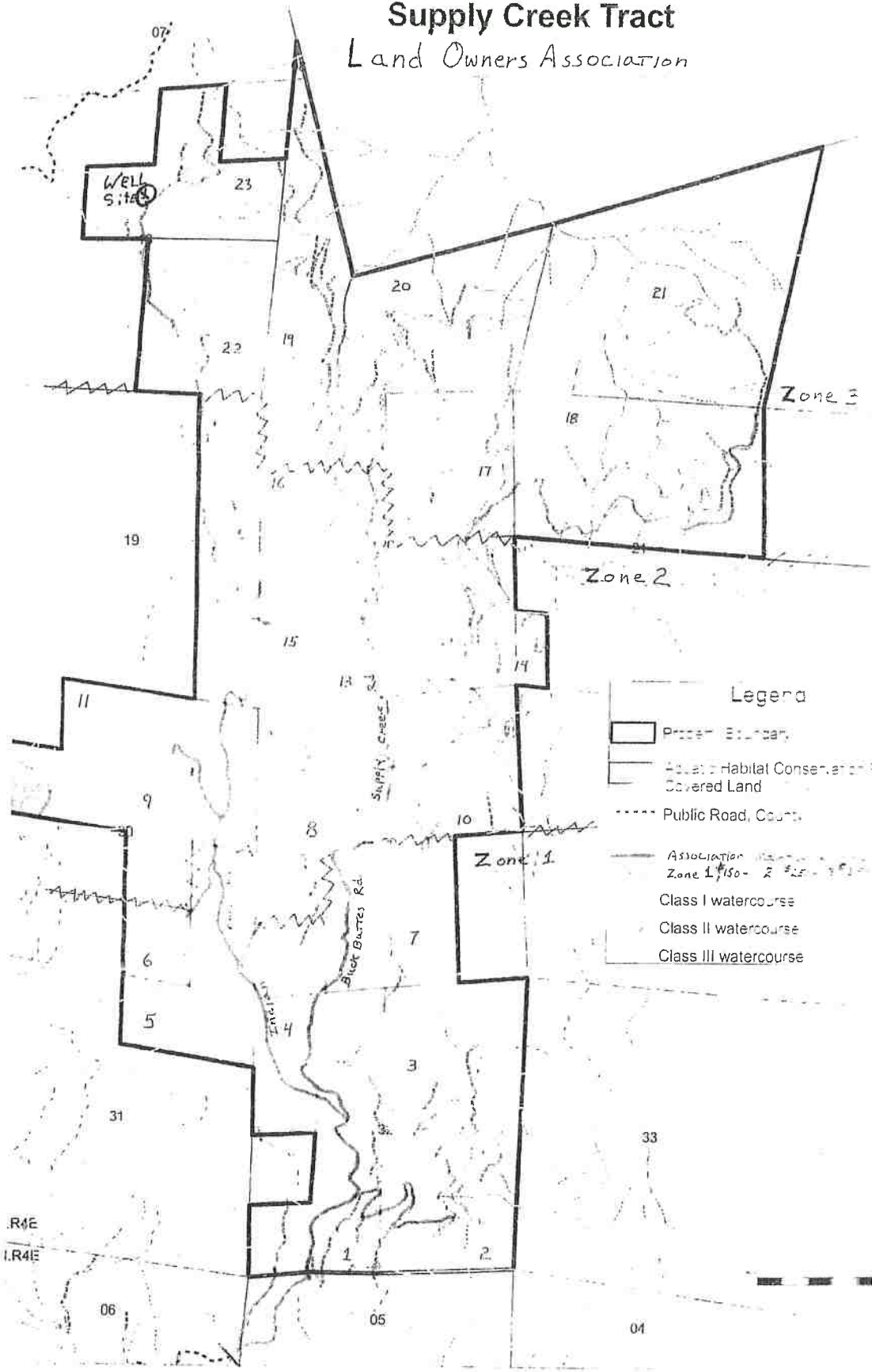

- Legend**
- Property Boundary
  - Habitat Conservation Covered Land
  - Public Road, County
  - Association Boundary
  - Zone 1, 150 - 2 1/2" - 3"
  - Class I watercourse
  - Class II watercourse
  - Class III watercourse

