

ACKNOWLEDGEMENT

A notary public or other officer completing this certificate verifies only the identity of the individual who signed the document to which this certificate is attached, and not the truthfulness, accuracy, or validity of that document.

State of California
County of Humboldt

On December 29, 2020 before me, Danielle Allred, a notary public, personally appeared Karen Diemer, who proved to me on the basis of satisfactory evidence to be the person(s) whose name(s) is/~~are~~ subscribed to the within instrument and acknowledged to me that ~~he~~/she/~~they~~ executed the same in ~~his~~/her/~~their~~ authorized capacity(~~ies~~) and that by ~~his~~/her/~~their~~ signature on the instrument the person(s), or the entity(~~ies~~) upon behalf of which the person(s) acted, executed the instrument.

I certify under PENALTY OF PERJURY under the laws of the State of California that the foregoing paragraph is true and correct.

WITNESS my hand and official seal.

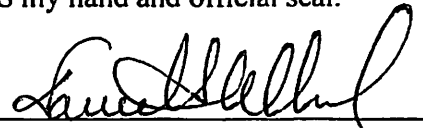
Signature 

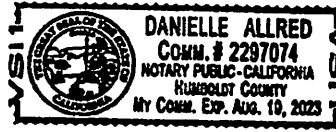

(Seal)

ACKNOWLEDGEMENT

A notary public or other officer completing this certificate verifies only the identity of the individual who signed the document to which this certificate is attached, and not the truthfulness, accuracy, or validity of that document.

State of California
County of Humboldt

On January 5, 2021 before me, Danielle Allred, a notary public, personally appeared Dean Hunt, who proved to me on the basis of satisfactory evidence to be the person~~(s)~~ whose name~~(s)~~ is/~~are~~ subscribed to the within instrument and acknowledged to me that he/~~she~~/~~they~~ executed the same in his/~~her~~/~~their~~ authorized capacity~~(ies)~~ and that by his/~~her~~/~~their~~ signature on the instrument the person~~(s)~~, or the entity~~(ies)~~ upon behalf of which the person~~(s)~~ acted, executed the instrument.

I certify under PENALTY OF PERJURY under the laws of the State of California that the foregoing paragraph is true and correct.

WITNESS my hand and official seal.

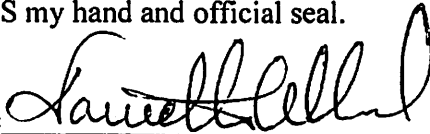
Signature 

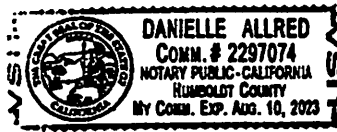

(Seal)

MA CORN REG. AM. 10 1953
HAWKINS COMPANY
HOTARY & SONS
GOMM & SONS
DANIELLE ALBERD



EXHIBIT A – LEGAL DESCRIPTIONS
GRAZING LEASE AGREEMENT BETWEEN A.N. HUNT AND SONS AND CITY OF ARCATA
FOR THE PERIOD JANUARY 1, 2019 TO DECEMBER 31, 2023

Exhibit A

Real Property Description
Bayview Ranch Property, Humboldt County, California

The real property in the City of Arcata, County of Humboldt, State of California, described as follows:

That portion of Section 4, Township 5 North, Range 1 East, Humboldt Meridian, and of Section 33, Township 6 North, Range 1 East, Humboldt Meridian, described as follows:

BEGINNING on the quarter section line at a point located South 0 degrees 05 minutes East, 891.94 feet thereon from the closing quarter corner on the North line of said Section 4;

thence North 30 degrees 21 minutes 04 seconds West, 3120.03 feet to the Westerly line of land conveyed to Chauncey M. Gould by deed recorded April 2, 1964 in Book 781 of Official Records, page 499, under Recorder's Serial No. 5849, Humboldt County Records;

thence South 1 degree East (shown as South 0 degrees 56 minutes 19 seconds East on Record of Survey recorded in Book 18, page 146 of Surveys) along said Westerly line, 1175.20 feet to an angle point in said line being the Easterly line of the land conveyed to Brizard-Matthews Machinery Co., a partnership, by deed dated June 15, 1960 and recorded August 8, 1960 in Book 598 of Official Records, page 223, under Recorder's Serial No. 12906, Humboldt County Records; and

thence South 37 degrees 15 minutes West (shown as South 37 degrees 17 minutes 39 seconds West on said Survey in Book 18 of Surveys, page 146), along said Easterly line 781 feet to the section line between Section 33 of Township 6 North, Range 1 East, and Section 4 of Township 5 North, Range 1 East, Humboldt Meridian, at a point located 447.44 feet Easterly along said division line from the Southwest corner of said Section 33;

thence continuing along said Brizard-Matthews line, South 37 degrees 15 minutes West, 590 feet to most Northerly corner of the parcel of land conveyed to the State of California, by Fredericka Alant Dolson and husband by deed dated February 2, 1953 and recorded February 24, 1953 in Book 240 of Official Records, page 50, under Recorder's Serial No. 2318, Humboldt County Records;

thence Southerly along the Easterly line of said State of California parcel, along a curve to the right, with a radius of 11,100 feet, through an angle of 2 degrees 07 minutes 28 seconds, a distance of 565.31 feet;

thence South 6 degrees 35 minutes 08 seconds East, 136.00 feet to an angle point in said State of California boundary;

thence North 37 degrees 19 minutes 30 seconds East, 39.47 feet to the most Northerly corner of a parcel of land conveyed to the State of California by deed recorded August 5, 1953 in Book 259 of Official Records, page 523, under Recorder's Serial No. 9939, Humboldt County Records;

thence along the Easterly line of said last mentioned State of California land South 4 degrees 14 minutes 55 seconds East, 671.39 feet, South 0 degrees 25 minutes 30 seconds West 959.99 feet, North 89 degrees 34 minutes 30 seconds West, 48 feet and South 0 degrees 25

Exhibit A, Real Property Description
Bayview Ranch Property, Humboldt County, California
Page 2

minutes 30 Seconds West, 1381.49 feet, more or less, to the South line of the Northwest Quarter of the Southwest Quarter of said Section 4;

thence East along said South line, 1038.42 feet, more or less, to the Southwest corner of the Northeast Quarter of the Southwest Quarter of said Section 4;

thence East along the South line of the Northeast Quarter of the Southwest Quarter and the South line of the Northwest Quarter of the Southeast Quarter of said Section 4, a distance of 2443.32 feet;

thence following a division line fence South 43-3/4 degrees East, 660 feet;

thence North 46-1/4 degrees East, 432 feet;

thence South 43-1/4 degrees East, 114.06 feet to the most Westerly corner of the parcel of land conveyed to Bayside Community Presbyterian Church by deed recorded November 21, 1957, under Recorder's Serial No. 17184;

thence North 46-1/4 degrees East, 84.96 feet;

thence South 43-1/4 degrees East, 210 feet to the Northwesterly line of the County Road, as it existed on November 1, 1900;

thence along that line North 47 degrees East, 351.30 feet;

thence at a right angle North 43 degrees West, 436.92 feet;

thence North 72 degrees West, 285.12 feet;

thence North 29 degrees 20 minutes West, 875.82 feet;

thence North 57 degrees West, 277.86 feet;

thence North 60 degrees East to the most Southerly corner of the parcel of land described in deed to Jacoby Creek School District of Humboldt County recorded May 21, 1956, in Book 393 of Official Records, page 109, Humboldt County Records;

thence North 30 degrees 15 minutes West, 492 feet to the most Westerly corner of said school district parcel;

thence along the Northerly line of said parcel North 60 degrees East to the Westerly line of the County Road as it existed on November 1, 1900;

thence along that line North 30 degrees West, 913.8 feet to a division line fence;

thence following said fence line South 89-1/4 degrees West to said quarter section line;

thence North 0 degrees 05 minutes West, along said quarter section line, 569.30 feet to the point of beginning.

EXCEPTING THEREFROM that portion thereof described as follows:

BEGINNING at a point on the Southeasterly boundary line of the parcel of land described and designated Parcel Two in the Judgment dated February 18, 1963, and recorded in the Office of the County Recorder of said County of Humboldt in Book 725, page 318 of Official Records, from which the most Southerly corner of said parcel of land

Exhibit A, Real Property Description
Bayview Ranch Property, Humboldt County, California
Page 3

designated Parcel Two bears South 78 degrees 58-1/2 minutes West, 705.4 feet distant;
and running

thence North 78 degrees 58-1/2 minutes East along the Southeasterly line of said
parcel of land designated Parcel Two, a distance of 305.3 feet;

thence North 0 degrees 20 minutes West, 238.1 feet;

thence South 89 degrees 40 minutes West, 300.00 feet;

thence South 0 degrees 20 minutes East, 294.7 feet, more or less, to the point of
beginning, being a portion of Section 4, Township 5 North, Range 1 East, Humboldt Base
and Meridian.

ALSO EXCEPTING THEREFROM that portion thereof, described as follows:

All that real property situated in the Southeast Quarter of Section 4, Township 5 North,
Range 1 East, Humboldt Meridian, described as follows:

BEGINNING at the most Southwesterly corner of the parcel of land conveyed to
Bayside Community Presbyterian Church by deed recorded November 21, 1957 in Book
467 of Official Records, page 416, under Recorder's Serial No. 17184, Humboldt County
Official Records;

thence North 46 degrees 15 minutes East, along the Westerly line of said Church
parcel, 84.96 feet;

thence North 43 degrees 45 minutes West, 116.94 feet;

thence South 46 degrees 15 minutes West, 84.96 feet;

thence South 43 degrees 45 minutes East, 116.94 feet to the point of beginning.

///
///

Exhibit A, Real Property Description
Brizard Tract, Humboldt County, California

BRIZARD PROPERTY
LEGAL DESCRIPTION

APN 501-042-007
APN 501-042-014

All that real property situated in the City of Arcata, County of Humboldt, State of California, described as follows:

That Portion of the West Half of the Southwest Quarter of Section 33 and the East Half of the Southeast Quarter of Section 34, Township 6 North, Range 1 East and the Northwest Quarter of the Northwest Quarter of Section 4, Township 5 North Range 1 East shown as Parcel 2 of Parcel Map No. 1538 for the Brizard Company, Recorded in Book 13 of Parcel Maps, Page 83 and 84, Humboldt County Recorder's Office.

EXCEPTING THERE FROM that portion thereof conveyed to Arcata Little League and Babe Ruth League, Inc., a corporation, by Deed recorded, November 24, 1986, in Book 1818, Page 694, of Official Records, under Recorder's Serial No: 24978, Humboldt County Records.

Franklin R. Klopp 12/29/05
Franklin R. Klopp, RCE 20758
License expires 09/30/06



Exhibit A - Page 4

C:\WORK\PROG\Agreements\Descriptions\Brizard Property.doc

EXHIBIT B – MAP
GRAZING LEASE AGREEMENT BETWEEN A.N. HUNT AND SONS AND CITY OF
ARCATA FOR THE PERIOD JANUARY 1, 2019 TO DECEMBER 31, 2023

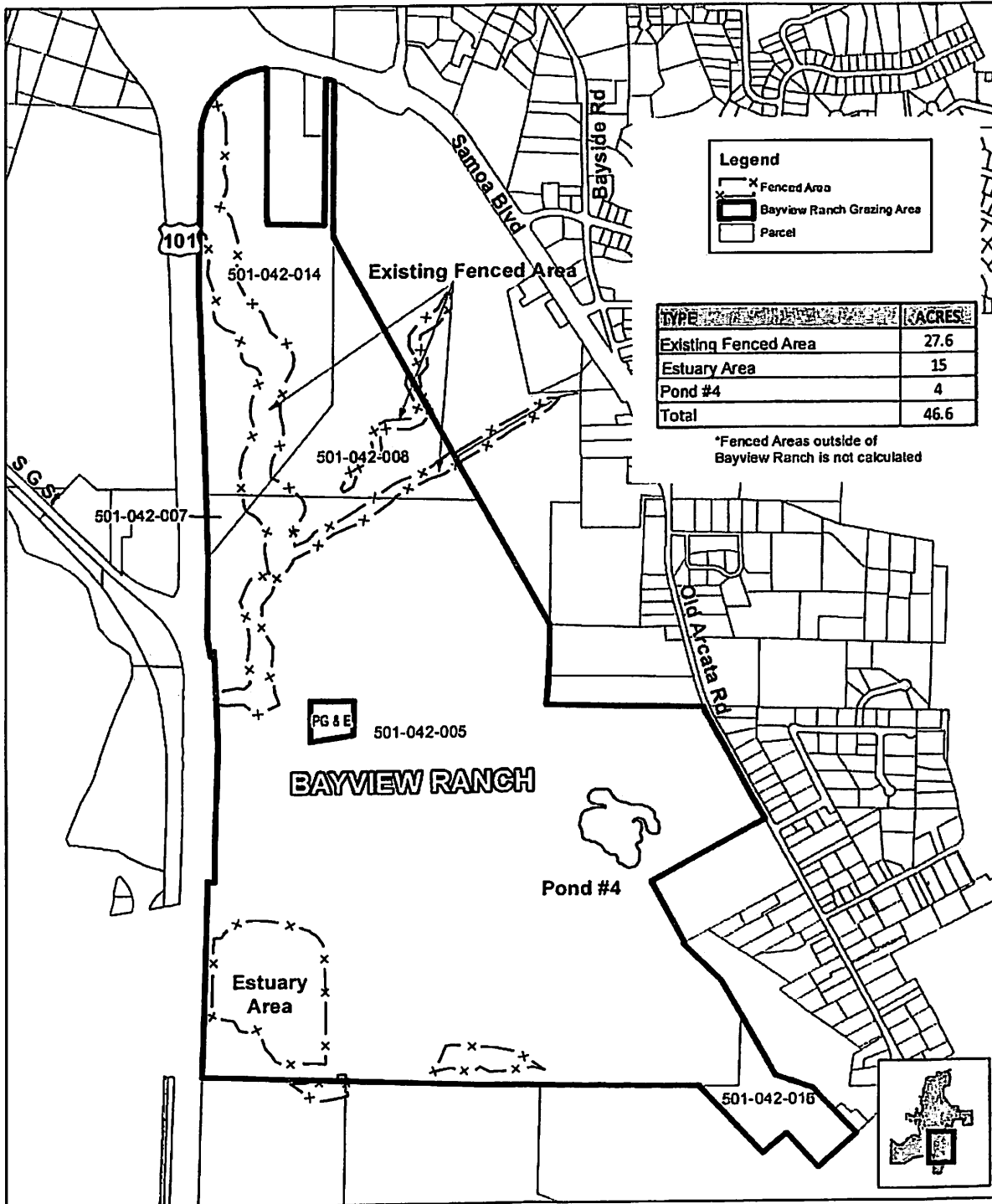

<p>City of Arcata Environmental Services</p>	<p>Bayview Ranch Lease Area 10/24/2018</p>	<p>NORTH 0 250 500 Feet</p>
--	--	---------------------------------