

DIRECTIONS TO SITE:

- FROM EUREKA, CA
- SOUTHBOUND ON US-101 (APPROX. 67 MILES)
- TAKE EXIT 639B REDWAY
- TAKE RIGHT ONTO REDWOOD DRIVE (0.2 MILES)
- TURN RIGHT ONTO ALDER POINT ROAD (8 MI)
- KEEP RIGHT ONTO BELL SPRINGS ROAD (8 MILES)
- KEEP LEFT TO CONTINUE ON ISLAND MOUNTAIN ROAD (0.9 MILES)
- KEEP RIGHT AND CONTINUE ONTO HOG TRAP ROAD (~0.55 MILES TO GATE ON RIGHT)

HOG TRAP FARMS, LLC

CONDITIONAL USE PERMIT APPS# 13336,13356

Revised: 02/28/25

PROJECT DESCRIPTION:

PERMIT EXISTING CANNABIS CULTIVATION ACTIVITIES IN ACCORDANCE WITH THE COUNTY OF HUMBOLDT (COUNTY) COMMERCIAL CANNABIS LAND USE ORDINANCE (CCLUO). THE EXISTING OPERATION INCLUDES 10,000 SQUARE FEET OF OUTDOOR LIGHT DEPRIVATION CULTIVATION ON APN 218-081-003 AND 33,634 SF OF CULTIVATION (12,000 SF MIXED LIGHT, 21,634 SF OUTDOOR) ON APN 218-071-003.

IRRIGATION WATER SOURCE IS RAINWATER CATCHMENT. DRYING OCCURS WITHIN A 30'X60' BARN ON APN 218-081-003

22x34 SHEET: 1"=20'
11x17 SHEET: 1"=40'
0 10 20 40



HOG TRAP FARMS LLC
APN 218-071-003, 218-081-003
PLOT PLAN, VICINITY MAP AND PROJECT NOTES

SHEET
13336
13356
25
CS SHOWN
CO

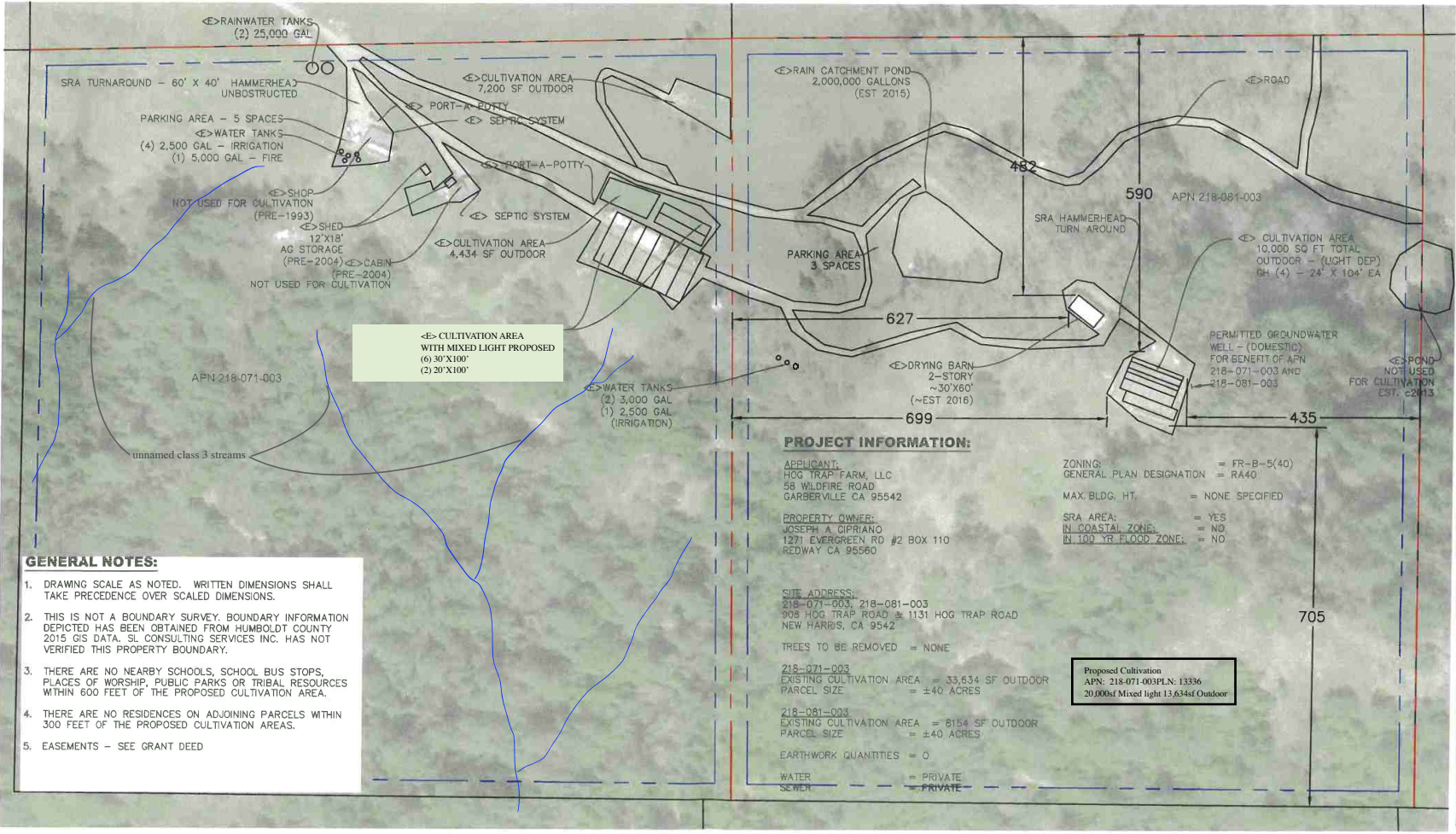

June 23, 2020 - 10:48 Day Name: C:\Users\jacob\Documents\Transfer (3)\County permit files\Hog Trap Farms - Copy.dwg Updated By: jpd

