

GENERAL NOTES

- CONTRACTOR AGREES TO ASSUME SOLE AND COMPLETE CONTROL OF THE JOB SITE DURING THE COURSE OF THE WORK, INCLUDING SAFETY OF ALL PERSONS AND PROPERTY; THAT THIS REQUIREMENT SHALL APPLY CONTINUOUSLY AND NOT BE LIMITED TO NORMAL WORKING HOURS; AND THAT THE CONTRACTOR SHALL DEFEND, INDEMNIFY, AND HOLD THE CITY, AND THEIR REPRESENTATIVES HARMLESS FROM ANY AND ALL LIABILITY, REAL AND / OR ALLEGED, IN CONJUNCTION WITH THEIR PERFORMANCE ON THIS PROJECT.
- ALL WORK SHALL COMPLY WITH THE LATEST CALIFORNIA BUILDING CODE AND LATEST PLUMBING CODE.
- CONTRACTOR COMPLETED PROJECT COMPONENTS REQUIRES A CLASS A GENERAL ENGINEERING CONTRACTORS LICENSE IN THE STATE OF CALIFORNIA.
- A SET OF SIGNED WORKING DRAWINGS AND SPECIFICATIONS SHALL BE KEPT ONSITE AT ALL TIMES ON WHICH ALL CHANGES OR ADJUSTMENTS IN THE WORK ARE RECORDED.
- ANY MATERIAL NOT REUSED ON SITE SHALL BE REMOVED FROM THE PROJECT SITE AND DISPOSED OF IN A MANNER CONSISTENT WITH APPLICABLE REGULATIONS SUCH AS COUNTY GRADING ORDINANCES. CONTRACTOR IS RESPONSIBLE FOR PROPER DISPOSAL OF MATERIALS TAKEN FROM THE SITE.
- THE CONTRACTOR IS RESPONSIBLE FOR COORDINATING APPROVED STAGING AREAS WITH THE CITY.
- THE CONTRACTOR SHALL UPON COMPLETION OF THE PROJECT SHALL LEAVE THE PROJECT AREA FREE OF STOCKPILES, DEBRIS, AND UNSUITABLE MATERIAL.
- CONTRACTOR SHALL BE HELD RESPONSIBLE FOR ANY AND ALL DAMAGES TO EXISTING ROADS, UTILITIES, AND STRUCTURES DURING CONSTRUCTION. ALL DAMAGE SHALL BE RESTORED TO EQUAL OR BETTER CONDITION AT THE CONTRACTOR'S EXPENSE.
- ALL MATERIALS SHALL BE FURNISHED AND INSTALLED BY THE CONTRACTOR UNLESS OTHERWISE NOTED.
- CONTRACTOR SHALL COORDINATE CONSTRUCTION SCHEDULE WITH THE CITY'S REPRESENTATIVE PRIOR TO COMMENCEMENT OF WORK.
- CONTROL POINTS OF PROPOSED IMPROVEMENTS WILL BE PROVIDED BY THE CITY.
- ALL WORK SHALL CONFORM TO THE LINES, GRADES, AND TYPICAL DETAILS AS SHOWN ON THESE PLANS AND DELINEATIONS ON THE GROUND WITH NO VARIATIONS UNLESS OTHERWISE APPROVED BY THE ENGINEER.

UTILITY NOTES

- THE CONTRACTOR SHALL COORDINATE UTILITY CONSTRUCTION WORK WITH THE OWNER OF SAID UTILITY.
- THE LAYOUT OF PIPING MAY BE ADJUSTED AS REQUIRED TO MEET FIELD CONDITIONS WITH THE APPROVAL OF THE CITY'S REPRESENTATIVE.
- ALL TIE-IN CONNECTIONS TO CITY UTILITIES SHALL BE COORDINATED WITH THE CITY'S REPRESENTATIVE.

GRADING NOTES

- ALL GRADING WORK SHALL FOLLOW THE SLOPES AND GRADES SHOWN ON THE GRADING AND DRAINAGE PLAN UNLESS OTHERWISE APPROVED BY THE CITY'S REPRESENTATIVE.
- ALL OFFSITE TRACKING OF MATERIAL SHALL BE SHOVELED AND SWEEPED ON A DAILY BASIS.

TRAFFIC CONTROL NOTES

- CONTRACTOR SHALL PROVIDE ACCESS TO ADJACENT RESIDENCES AT ALL TIMES DURING CONSTRUCTION.
- EXISTING MULTI-USE TRAIL SHALL REMAIN OPEN AT ALL TIMES, UNLESS OTHERWISE APPROVED BY THE CITY. THE CONTRACTOR IS RESPONSIBLE FOR PEDESTRIAN SAFETY OF TRAIL USERS DURING CONSTRUCTION.
- TRAFFIC SAFETY AND CONTROL MEASURES SHALL BE USED AS SET FORTH IN THE CALIFORNIA MANUAL OF UNIFORM TRAFFIC CONTROL DEVICES (CAMUTCD), LATEST EDITION.

EROSION AND SEDIMENT CONTROL NOTES

- EROSION AND SEDIMENT CONTROL WORK SHALL CONFORM AND PROVISIONS SET FORTH IN THE FOLLOWING:
 - SECTION 21 "EROSION CONTROL" OF THE CALTRANS STANDARD SPECIFICATIONS, 2018.
 - CALTRANS CONSTRUCTION SITE BMP (BEST MANAGEMENT PRACTICES) FIELD AND TROUBLESHOOTING MANUAL, LATEST EDITION.
 - HYDROSEED ALL EXPOSED DISTURBED AREAS AS APPROVED BY THE OWNER'S REPRESENTATIVE.
- IT IS THE CONTRACTORS RESPONSIBILITY TO MINIMIZE EROSION AND PREVENT THE MOVEMENT OF SEDIMENT AND / OR HARMFUL MATERIALS OFFSITE.
- THE CONTRACTOR SHALL UTILIZE THE FOLLOWING BMP'S (BEST MANAGEMENT PRACTICES) PER THE CALIFORNIA STORMWATER QUALITY ASSOCIATIONS, CALIFORNIA BMP HANDBOOK, LATEST EDITION, AT A MINIMUM AND AS REQUIRED:

EC-2	PRESERVATION OF EXISTING VEGETATION
EC-4	HYDROSEEDING
SE-1	SILT FENCE
SE-5	FIBER ROLLS
SE-7	STREET SWEEPING AND VACUUMING
NS-2	DEWATERING OPERATIONS
NS-12	CONCRETE CURING
NS-13	CONCRETE FINISHING
WM-1	MATERIALS DELIVERY AND STORAGE
WM-2	MATERIALS USE
WM-3	STOCKPILE MANAGEMENT
WM-4	SPILL PROTECTION AND CONTROL
WM-5	SOLID WASTE MANAGEMENT
WM-8	CONCRETE WASTE MANAGEMENT

UNDERGROUND FACILITIES NOTE







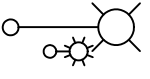
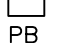

INFORMATION PERTAINING TO EXISTING UNDERGROUND FACILITIES AS SHOWN HEREIN IS FOR INFORMATIONAL PURPOSES ONLY. CONTRACTOR SHALL BE RESPONSIBLE FOR CONTACTING ALL AGENCIES INVOLVED AND SHALL LOCATE ALL FACILITIES PRIOR TO EXCAVATION IN ANY AREA.

CALL USA: 811 (1-800-227-2600)

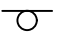
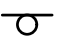
ABBREVIATIONS

AB	AGGREGATE BASE
AC	ASPHALT CONCRETE PAVING
AGG	AGGREGATE
@	AT
BFP	BACK FLOW PREVENTION DEVICE
BM	MARK
CL	CENTERLINE
CLR	CLEAR
CO	CLEANOUT
CONC	CONCRETE
CONT	CONTINUOUS
COR	CORNER
CP	CONTROL POINT
CV	CHECK VALVE
DIA, Ø	DIAMETER
<E>	EXISTING
EA	EACH
EL/ELEV	ELEVATION
E OHD	OVERHEAD ELECTRICAL LINES
FG	FINISH GRADE
FL	FLOW LINE
FT	FOOT OR FEET
FTG	FOOTING
GALV	GALVANIZED
GB	GRADE BREAK
GR	GRADE
GRD	GROUND
GV	GATE VALVE
IE	INVERT ELEVATION
IP	IRON PIPE
NIC	NOT IN CONTRACT
N.T.S.	NOT TO SCALE
O.C.	ON CENTER
PL	PROPERTY LINE
PP	POWER POLE
PSI	POUNDS PER SQUARE INCH
PT	PRESSURE TREATED
PVC	POLYVINYL CHLORIDE PIPE
RW	RIGHT-OF-WAY
SIM	SIMILAR
TC	TOP OF CURB
TYP	TYPICAL
W	WATER
WV	WATER VALVE

LEGEND

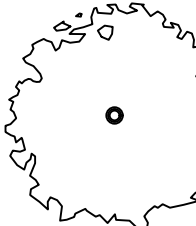
SS	<E> GRAVITY SEWER LINE
⊙	<E> SEWER MANHOLE
⊙	<P> DRAIN CLEANOUT
○ SSCO	<E> SEWER CLEANOUT
● SDCO	<P> STORM DRAIN CLEANOUT
OHE	<E> OVERHEAD ELECTRICAL
UE	<E> UNDERGROUND ELECTRICAL
	<E> LIGHT POLE
	<E> PULL BOX
	SURVEY CONTROL POINT
	SURVEY MONUMENT
	<E> STREET SIGN
	<P> STREET SIGN
W	<E> WATER MAIN / SERVICE
W W	<P> WATER MAIN / SERVICE
IR IR	<P> IRRIGATION MAIN / SERVICE
	<E> WATER METER
	<E> WATER VALVE
	<P> WATER VALVE
	<E> IRRIGATION CONNECTION
QC	<P> IRRIGATION QUICK-COUPLE HOSE CONNECT
	<E> BACK FLOW PREVENTER
* * * * *	<E> FENCE
X X	<P> FENCE
—	<E> ASPHALT PAVING
///	<P> ASPHALT PAVING
—	<E> VEGETATION LINE
---	BOUNDARY RIGHT OF WAY LINES
---	EASEMENTS
---	DRAINAGE FLOW LINES
← ← ← ←	<P> DRAINAGE FLOW LINES
	EXISTING GROUND CONTOURS
	<E> TREE
■■■■■■■■■■	LIMITS OF DISTURBANCE



No.	Revision/Issue	Date

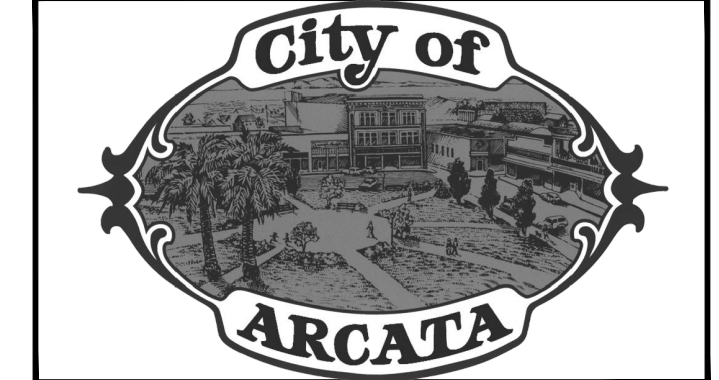

CONSTRUCTION NOTES, LEGENDS & ABBREVIATIONS	BLOOMFIELD PARK IMPROVEMENT PROJECT
---	-------------------------------------

Project Address
ZEHNDNER AVENUE

Designed By
KUSH RAWAL

Drawn By
KUSH RAWAL

Checked By
DAVID CAISSE

Approved By
N. B. KHATRI, RCE #75248

Date 9/28/2022	Sheet G-002
Scale N/A	

*NOTE:
THIS PROJECT IS A SHARED EFFORT BETWEEN THE CONTRACTOR AND CITY STAFF. THE WORK TO BE DONE BY THE CONTRACTOR IS INDICATED BY A BORDER SURROUNDING THE ANNOTATION. ANNOTATIONS WITHOUT BORDER INDICATE THE WORK WILL BE COMPLETED BY CITY STAFF.

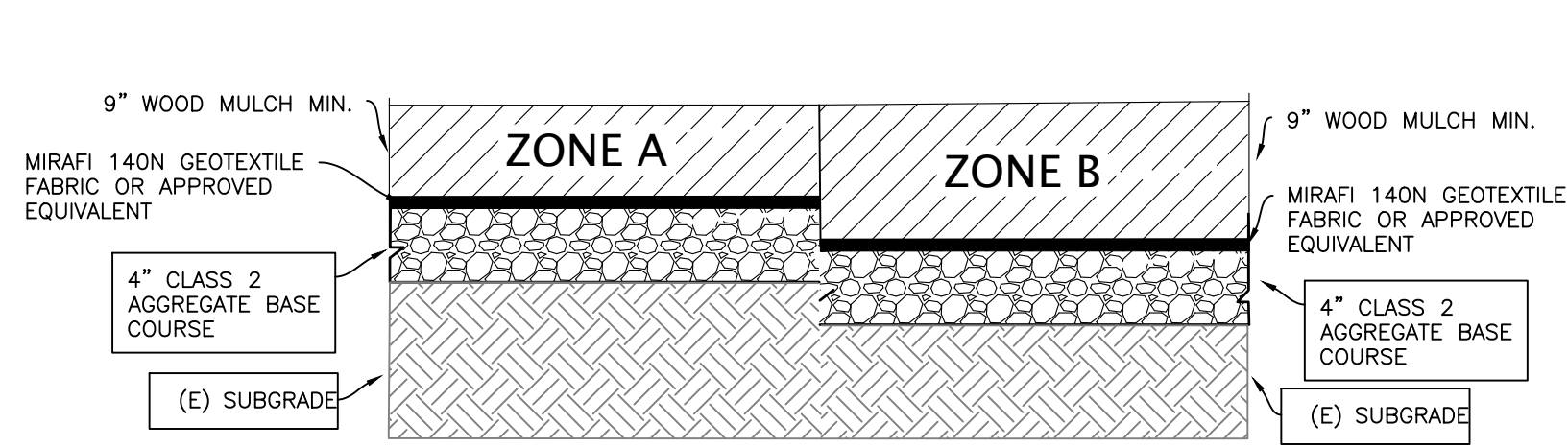
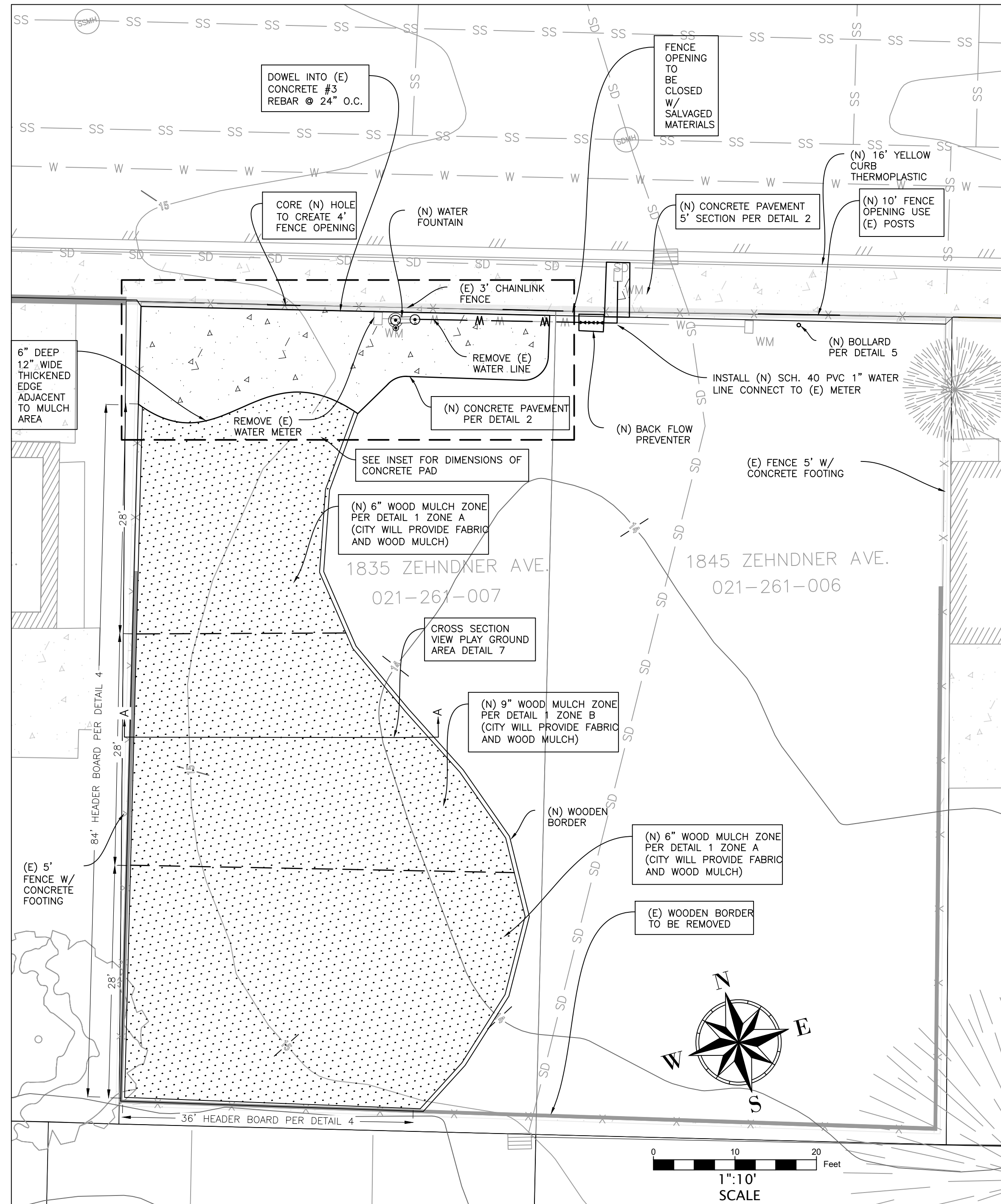

1 TYPICAL MULCH SECTION DETAIL
N.T.S.

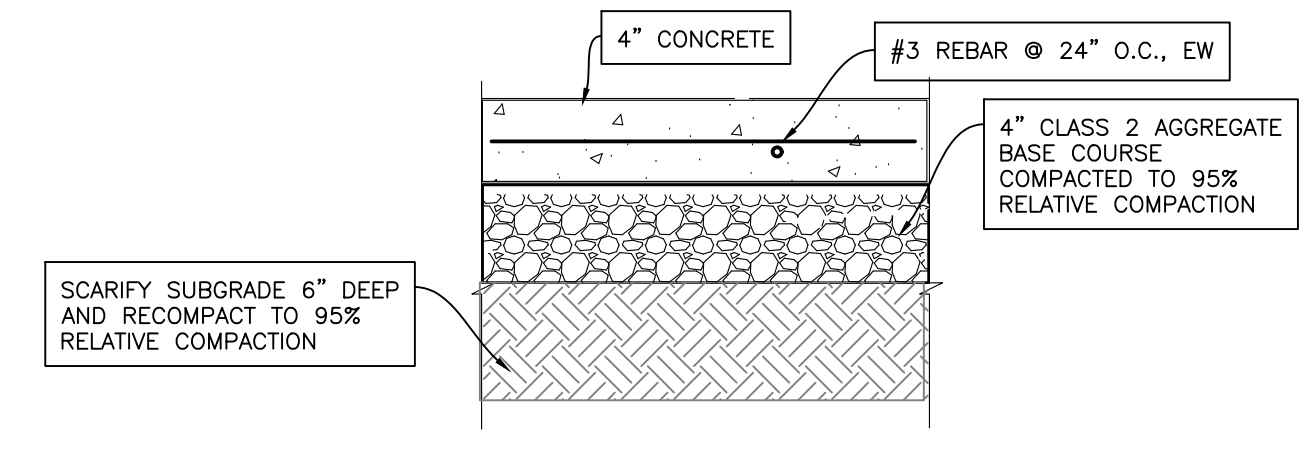

2 TYPICAL CONCRETE PEDESTRIAN PAVING DETAIL
N.T.S.

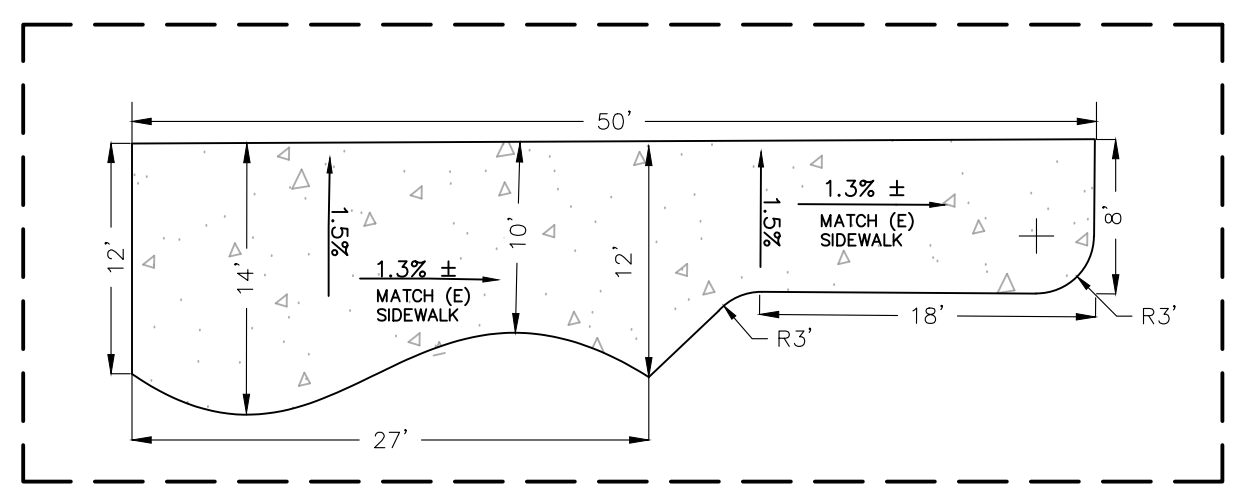

3 CONCRETE PAD DIMENSIONS
1":10' SCALE

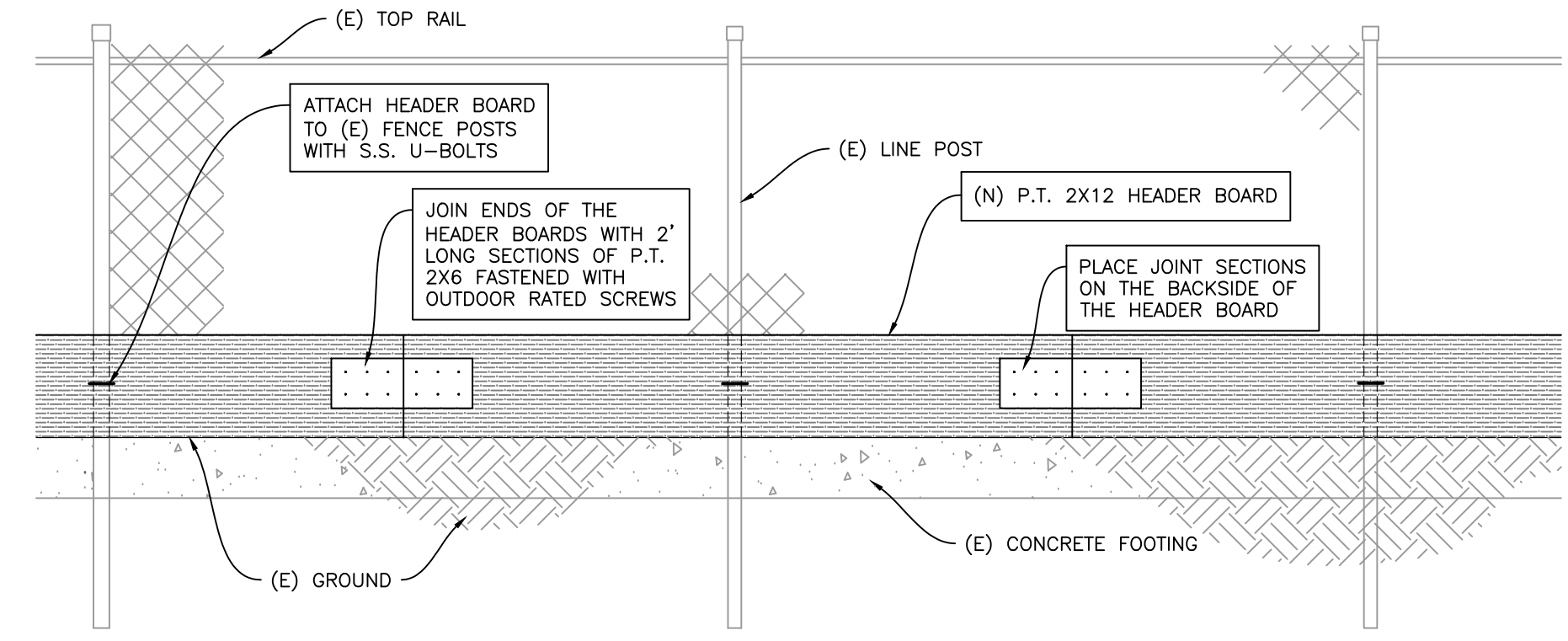

4 TYPICAL HEADER BOARD DETAIL
N.T.S.

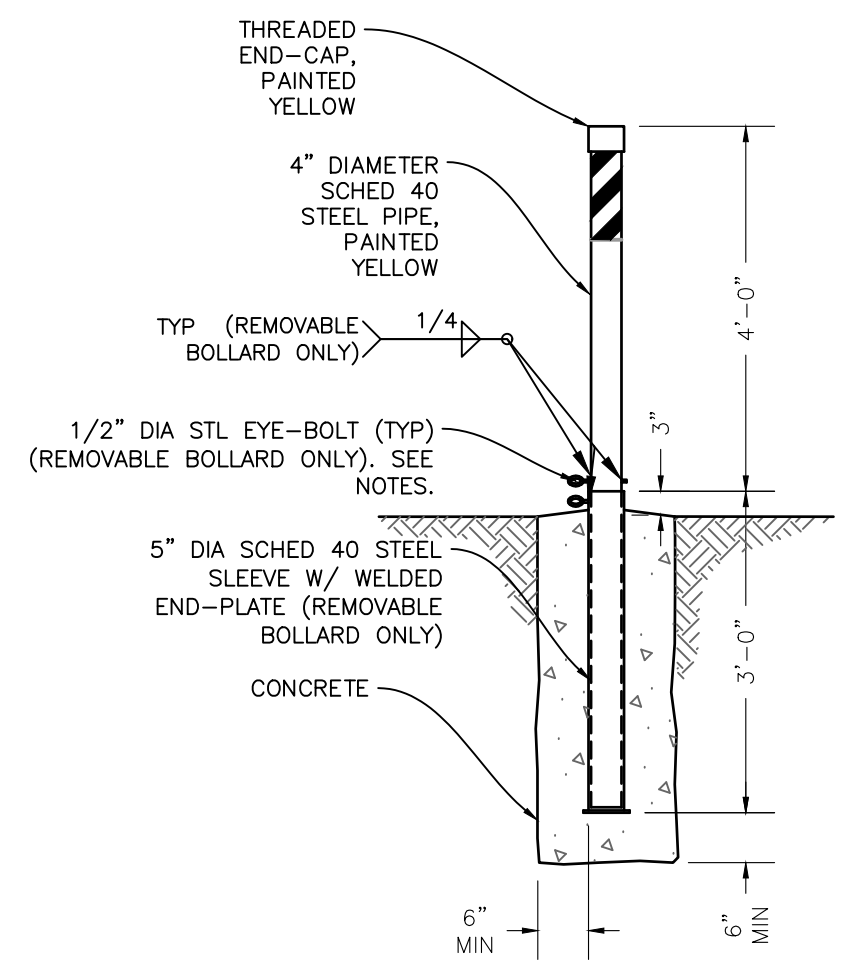

5 BOLLARD DETAIL
N.T.S.

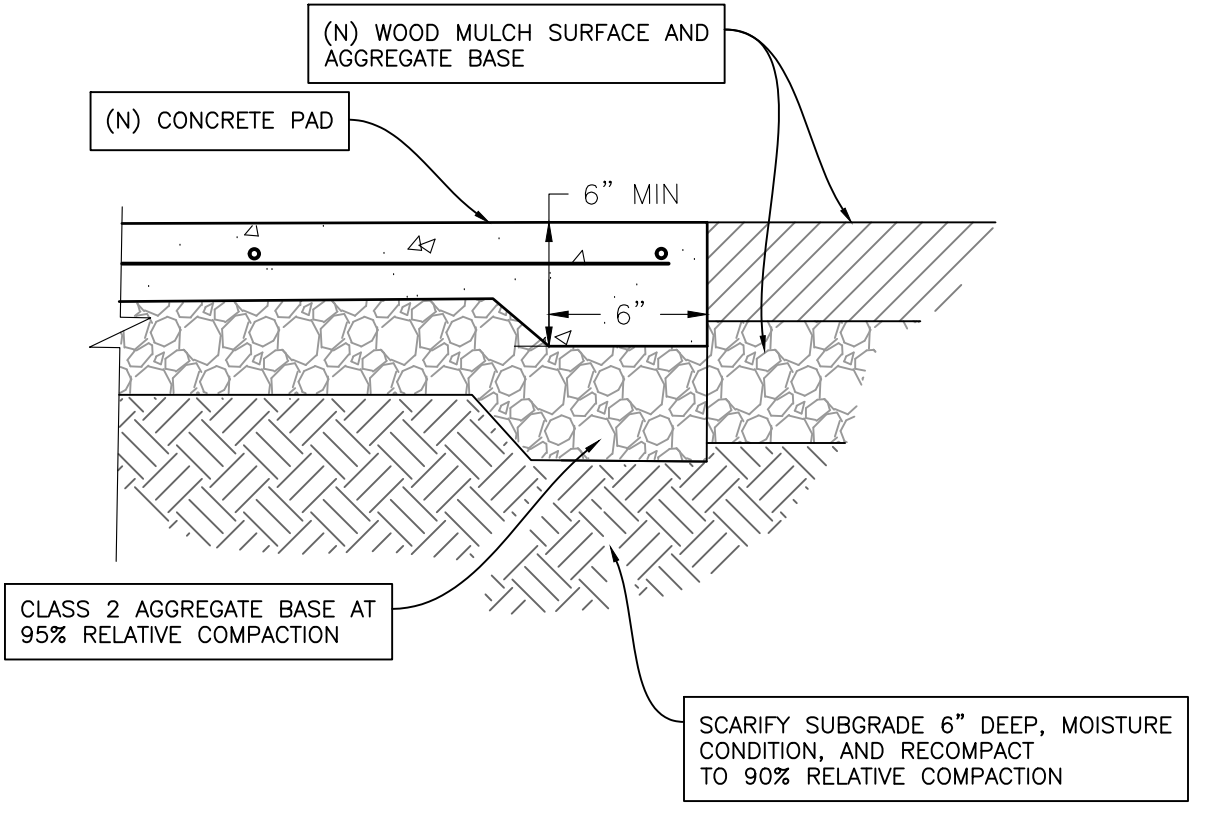

6 THICKENED EDGE DETAIL
N.T.S.

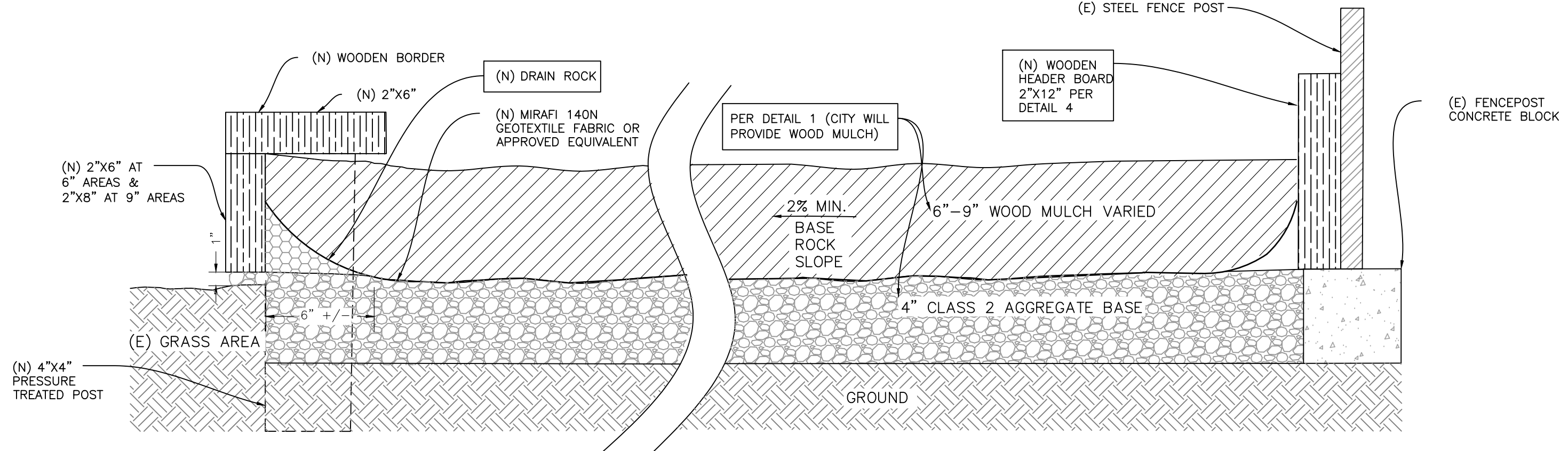

7 PLAYGROUND AREA
N.T.S.

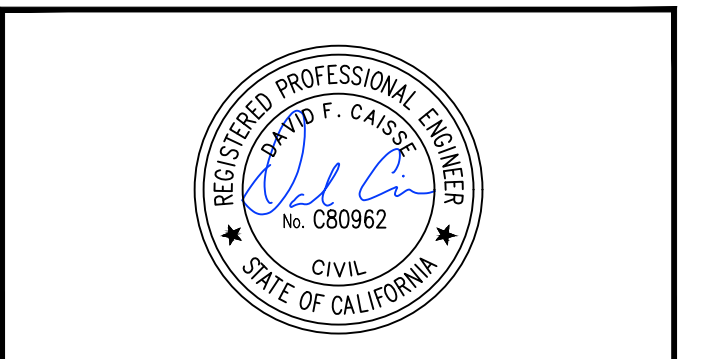

No.	Revision/Issue	Date

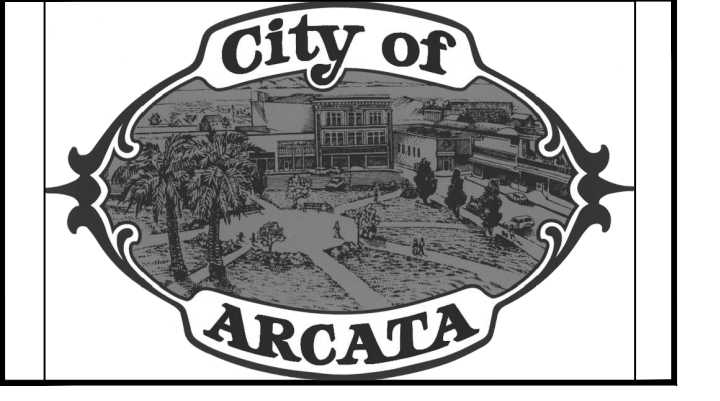

SITE PLAN AND DETAILS
 Project Name
 BLOOMFIELD PARK IMPROVEMENT PROJECT

Project Address
ZEHNDNER AVENUE

Designed By
KUSH RAWAL

Drawn By
KUSH RAWAL

Checked By
DAVID CAISSE

Approved By
N. B. KHATRI, RCE #75248

Date
9/28/2022

Scale
1" = 10'

SHEET 3 OF 3 SHEETS